

FP *FLASHPOINT*



Vertical
Battery Grip
for the Nikon D750

FPBGMBD16

Part Names

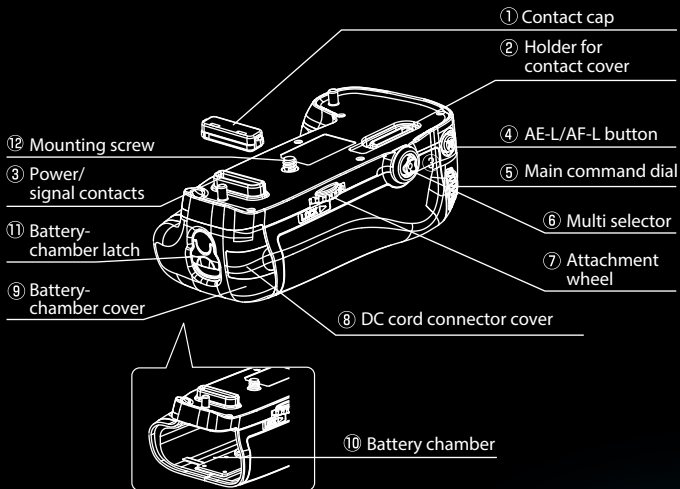

⑬ Shutter-release button

⑭ Control lock

⑮ Sub-command dial

⑯ Tripod socket

⑰ IR receiver (For specified models only)

⑱ IR receiver indicator

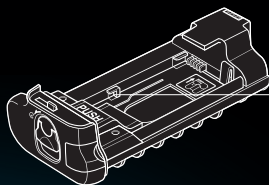
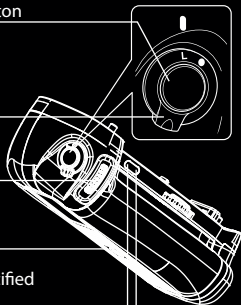

⑰ Li-ion battery holder
for EN-EL15 batteries

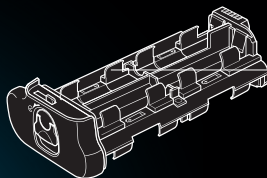

⑱ AA holder for AA batteries

Attaching to the Camera

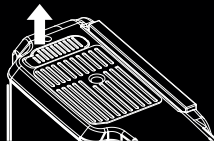
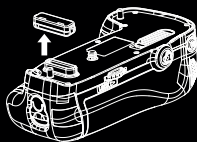
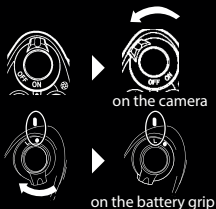

1. Please turn off the switch on the camera and ensure the control lock on the grip is in the "L" position before attaching.

2. Remove the contact cap from the battery grip.

3. The contacts for the battery grip are on the bottom of the camera where they are protected by a contact cover. Remove the contacts cover before mounting the grip.

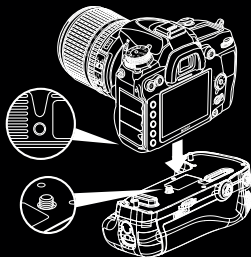
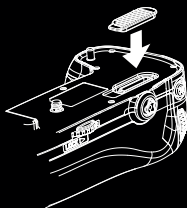

4. To prevent loss, place the camera contact cover in the contact cover holder on the battery grip .

5. Align the attachment screw with the camera's tripod socket.



6. Turn the attachment wheel to tighten securely in the direction of the arrow. If there is some space left, please reattach the battery grip.

Install Batteries

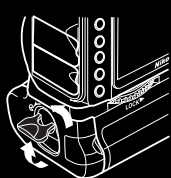

1. Ensure that the power is turned off on the camera and the Control Lock on the battery grip is in the "L" position. Turn the battery-chamber latch counter-clockwise to open the battery chamber door.

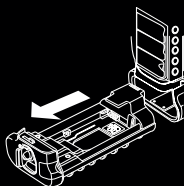

2. Remove the battery holder from the battery grip. The EN-EL15 Li-ion battery holder comes preinstalled when shipped.

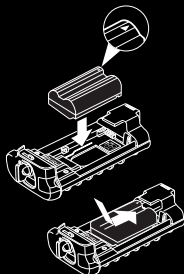

3. For EN-EL15 Li-ion batteries: Matching the indentations on the battery with the EN-EL15 holder, press the battery down and slide it in the direction of the arrow until the power terminals click into place.

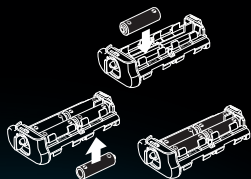

4. For AA batteries: Place six AA batteries of the same type in the AA battery holder, while ensuring that they are in the correct orientation. Mixing old and new batteries may cause accident.

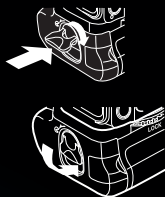

5. Insert the battery holder into the grip. Close the battery chamber and then turn the latch clockwise to lock. Turn on the camera and switch the control lock to be on "•" position and then check the battery level in the control panel or viewfinder.

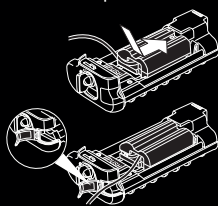

6. To use the DC adapter (sold separately): insert the adapter into the EN-EL15 battery holder in the same manner as a regular battery. Open the latch and pass the cable through.

Specifications Sheet

Type	FPBGMBD16
Power Sources	1 x EN-EL15 or 6 x AA batteries (LR6, HR6, FR6)
Fit Cameras	NIKON D750
Replacement For	MB-D16
Operating Temperature	0~40°C(32~104°F)
Dimensions	Approx. 142.2x51.3x77.9 mm
Weight	About 220g(include EN-EL15 battery holder)