

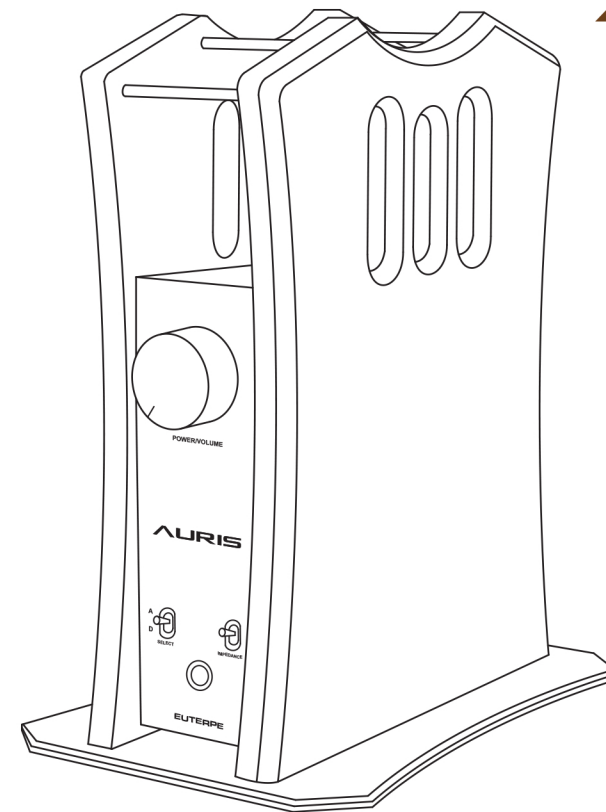

Nake Spasic 1, 11040 Belgrade, Serbia

www.aurisaudio.rs
info@aurisaudio.rs

AURIS



Owner's Manual
EUTERPE HeadAmp/DAC/PreAmp/Stand

1. Read these instructions.
2. Keep these instructions.
3. Heed all warnings.
4. Follow all instructions.
5. Do not use this apparatus near water.
6. Clean only with dry cloth.
7. Do not block any ventilation openings. Install in accordance with the manufacturer's instructions.
8. Do not install near any heat sources such as radiators, heat registers, stoves, or other apparatus (including amplifiers) that produce heat.
9. Do not defeat the safety purpose of the polarized or grounding-type plug. USA and Canada only: A polarized plug has two blades with one wider than the other. A grounding type plug has two blades and a third grounding prong. The wide blade or the third prong are provided for your safety. If the provided plug does not fit into your outlet, consult an electrician for replacement of the obsolete outlet.
10. Protect the power cord from being walked on or pinched, particularly at plugs, convenience receptacles, and the point where they exit the apparatus.
11. Only use attachments/accessories specified by the manufacturer.
12. Unplug this apparatus during lightning storms or when unused for long periods of time.
13. Refer all servicing to qualified service personnel. Servicing is required when the apparatus has been damaged in any way, such as power supply cord or plug is damaged, liquid has been spilled or objects have fallen into the apparatus, the apparatus has been exposed to rain or moisture, does not operate normally, or has been dropped.
14. WARNING: To reduce the risk of fire or electric shock, this apparatus should not be exposed to rain or moisture and objects filled with liquids, such as vases, should not be placed on this apparatus.
15. To completely disconnect this equipment from the mains, disconnect the power supply cord plug from the receptacle.
16. The mains plug of the power supply cord shall remain readily operable.

1. Make sure that you read instructions before attempting to operate your unit.
2. Connect your amplifier to an input source of your own choice.
3. Attach headphones to the amplifier.
4. Make sure your amplifier is properly connected to a high-current power receptacle.
5. At the end of your listening session make sure to turn the amplifier off.

The amplifier should always be turned on and off via its own power on-off switch.

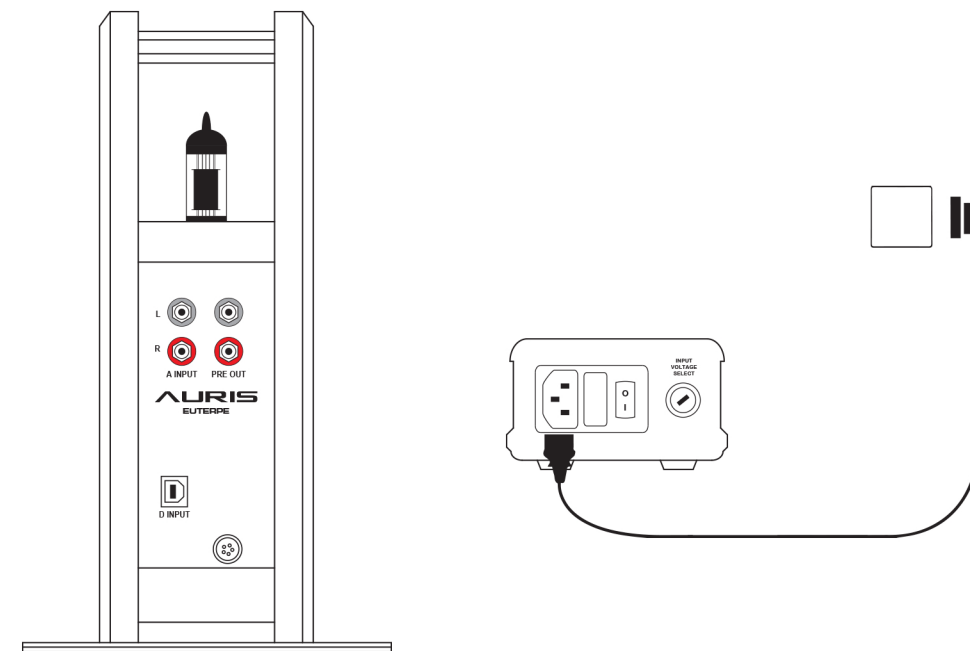

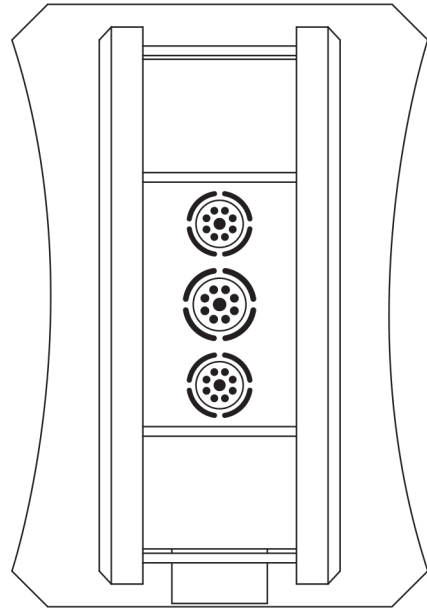

Before inserting the tubes, inspect them for cracks and physical damage. Make sure that the pins are straight. If you need to straighten the pins, be very careful as that may cause the glass envelope to break, causing the tube to lose the vacuum and fail as soon as the amplifier is powered on. Locate correct location for each tube, carefully align the pins with the socket and gently insert the tube.

Never force a tube into a socket!

It is normal for a vacuum tube equipment to run warm if used for prolonged periods. Tubes are operating at much higher temperature and should not be touched for at least ten minutes after the unit is turned off to prevent burns. Always place your amplifier away from children and pets to prevent burns.

Place the EUTERPE upright and Power Supply next to it at the distance of at least 4 inches (10 cm).

Always provide adequate ventilation for EUTERPE. Cool operation ensures the longest possible operating life for any electronic instrument. Do not install EUTERPE directly above a heat generating component such as a high powered amplifier. If all the components are installed in a single cabinet, a quiet running ventilation fan can be a definite asset in maintaining all the system components at the coolest possible operating temperature.

A custom cabinet installation should provide the following minimum spacing dimensions for cool operation.

Allow at least 10 inches (25cm) above the top, 0.4 inch (1.0cm) below the bottom and 4 inch (10.0cm) on each side of the unit, so that airflow is not obstructed.

Feel free to contact the Auris Customer Service department for any further questions or for additional assistance.

support@aurisaudio.rs

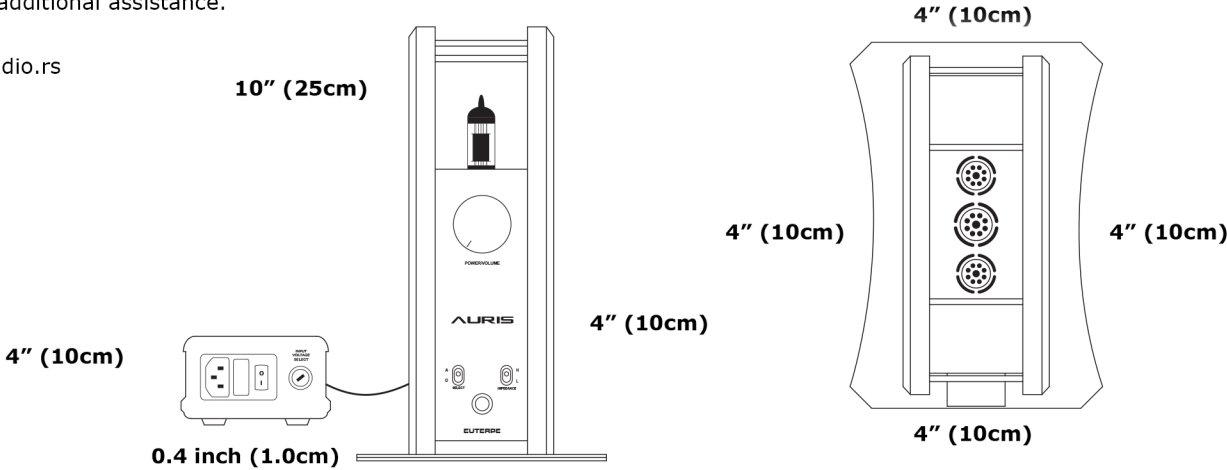

Front panel

- 1. Volume control
- 2. Input selector
- 3. Impedance selector
- 4. Headpone output 6,3mm stereo
- 5. Power supply inlet
- 6. Turn (on/off) switch
- 7. Voltage selector

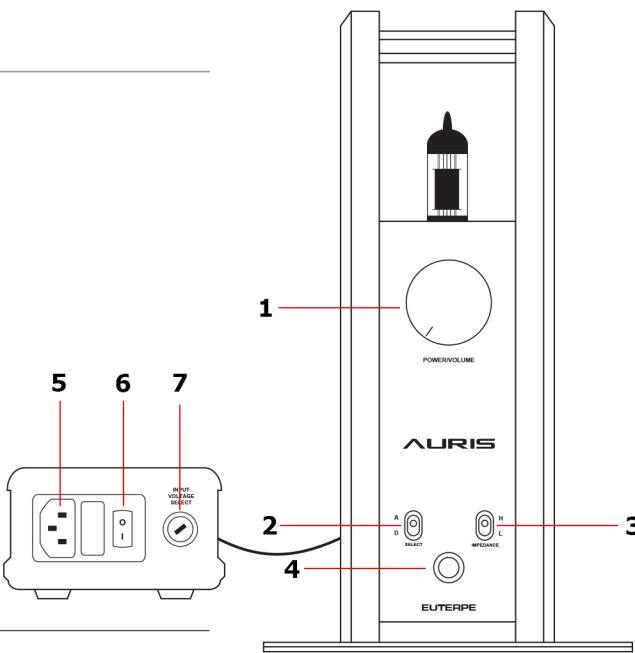

Top panel

- 1. Tube select (PL95 or EL95)

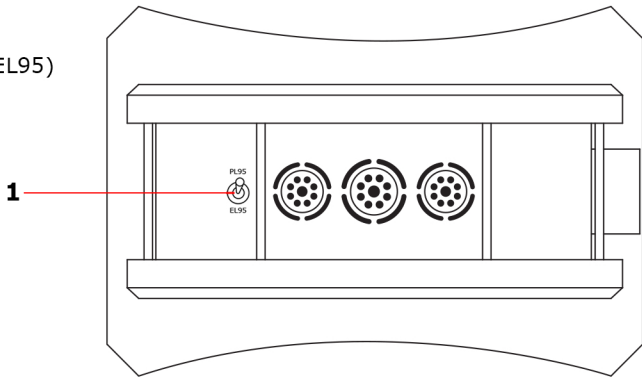

Rear panel

- 1. Input connectors (1 x RCA, 1 x USB)
- 2. Pre-out connectors (1 x RCA)
- 3. Input (DC)

