



behringer Go Cam Wireless Clip On Microphone System User Guide

[Home](#) » [Behringer](#) » behringer Go Cam Wireless Clip On Microphone System User Guide 

Contents

- 1 behringer Go Cam Wireless Clip On Microphone System
- 2 Product Usage Instructions
- 3 FAQ
- 4 Safety Instruction
- 5 LIMITED WARRANTY
- 6 GO CAM WIRELESS
- 7 Accessories Supplied
- 8 Operation
- 9 Specifications
- 10 Other important information
- 11 FCC STATEMENT
- 12 Documents / Resources
 - 12.1 References
- 13 Related Posts



behringer Go Cam Wireless Clip On Microphone System



Product Usage Instructions

- Read and follow all instructions provided.
- Avoid contact with water, except for outdoor products.
- Clean the apparatus only with a dry cloth.
- Do not block any ventilation openings.
- Install the apparatus according to the manufacturer's instructions.
- Avoid placing near heat sources.
- Use only specified attachments and accessories provided by the manufacturer.
- Use caution when moving the cart/apparatus combination to prevent tip-over.

FAQ

- **Q:** How do I charge the device?
- **A:** To charge the device, use the provided USB Type C charging port with a compatible charger.
- **Q:** How do I know the battery status?
- **A:** The battery status is indicated by the red LED – solid red for charging and flashing red for low battery.
- **Q:** How do I adjust the gain level?
- **A:** Press the gain switch to cycle through different gain levels indicated by the Gain LEDs.

Safety Instruction

1. Please read and follow all instructions.
2. Keep the apparatus away from water, except for outdoor products.
3. Clean only with a dry cloth.
4. Do not block any ventilation openings. Install under the manufacturer's instructions.
5. Do not install near any heat sources such as radiators, heat registers, stoves, or other apparatus (including amplifiers) that produce heat.
6. Use only attachments/accessories specified by the manufacturer.



7. Use only specified carts, stands, tripods, brackets, or tables. Use caution to prevent tip-overs when

moving the cart/ apparatus combination.

8. Avoid installing in confined spaces like bookcases.
9. Do not place near naked flame sources, such as lighted candles.
10. Operating temperature range 5° to 45°C (41° to 113°F).

LIMITED WARRANTY

- For the applicable warranty terms and conditions and additional information regarding Music Tribe's Limited Warranty, please see complete details online at community.musictribe.com/support.

GO CAM WIRELESS

- Get professional-grade audio with our wireless microphone system, designed to work seamlessly with your video recorders, DSLRs, mobile devices, tablets, and audio recorders.
- Perfect for interviews, podcasts, live-streaming, vlogs, virtual classrooms, voice-overs, and video production.
- Experience superior performance with Go Cam Wireless's 30 m (100 ft) wireless freedom.
- Keep your hands free with our compact transmitter, featuring a convenient shirt clip and easy on/off switch.
- Capture clear audio with ease using our integrated omnidirectional microphone.
- Eliminate unwanted background noise with our receiver's state-of-the-art 3-level noise reduction switch.
- Easily adjust the gain with our user-friendly 3-level switch that offers -24 dB, -12 dB, and 0 dB options.
- Mount our specially designed receiver on your camera using the built-in camera shoe adapter.
- Enjoy real-time monitoring with our included earphones.
- Connect an external microphone with a transmitter using 3.5 mm (1/8") connector.
- Stay powered up and protected on the go with up to 8 hours of runtime and our camera connection cable, USB charging cables, fur windshield, and protective carry case.

Accessories Supplied

- Fur windshield x 1
- USB charging cable x 1
- TRS to TRS audio cable for Camera x 1
- TRRS to TRS audio cable for Phones x 1
- Type C to Type C audio cable for Phones x 1
- Type C earphones x 1

MICROPHONE CONTROLS

1. External microphone input, 3.5 mm (1/8")
2. Built-in microphone
3. Wireless status LED – blue LED = successful connection to the receiver, flashing blue = not connected
4. Battery status LED – red LED = charging, flashing red = low battery
5. Shirt clip
6. Power On/Off – press for 2 seconds to turn ON, press for 3 seconds to turn OFF
7. USB Type C charging port

8. Mute On/Off – double-click = ON, press once = OFF

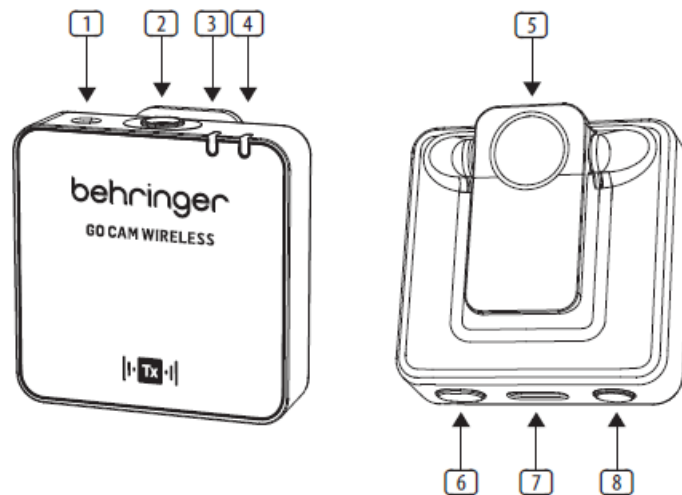

RECEIVER CONTROLS

- 9. Gain LEDs – III = 0 dB, II = -12 dB, I = -24 dB
- 10. Gain switch – press once to select a different gain level
- 11. Battery status LED – red LED = charging, flashing red = low battery
- 12. Wireless status LED – blue LED = successful connection to the receiver, flashing blue = not connected
- 13. Noise reduction LEDs – mild = NC1, medium = NC2, strong = NC3, Dark = No NC
- 14. Audio output, 3.5 mm (1/8")
- 15. Power On/Off – press for 2 seconds to turn ON, press for 3 seconds to turn OFF
- 16. USB Type C charging port and earphones output for real-time monitoring
- 17. Noise reduction switch – press once to select a different level
- 18. Clip/camera shoe adaptor

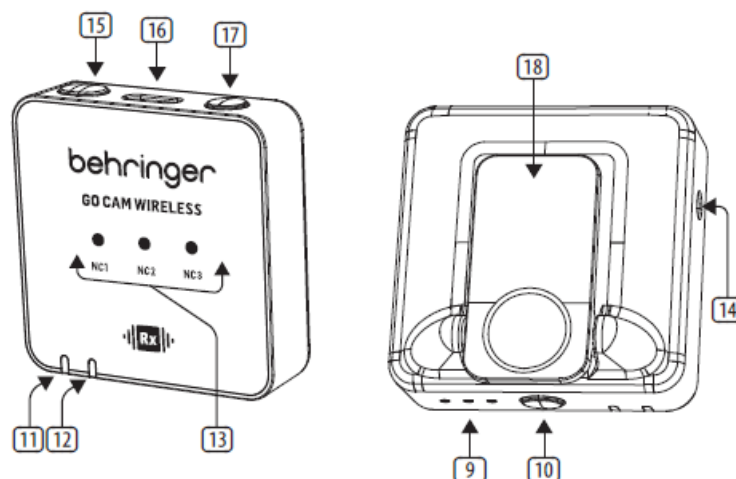

Operation

A charger is not included. The power delivered by the charger must be between 5 V / 32 mA (0.16 W) minimum required by this equipment, and 5 V / 400 mA (2 W) maximum, to achieve the maximum charging speed. This equipment supports the USB Power Delivery charging protocol.

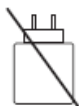

1. Please charge the transmitter and receiver before use.
2. Press the receiver power switch and the transmitter power switch for 2 seconds to power ON.

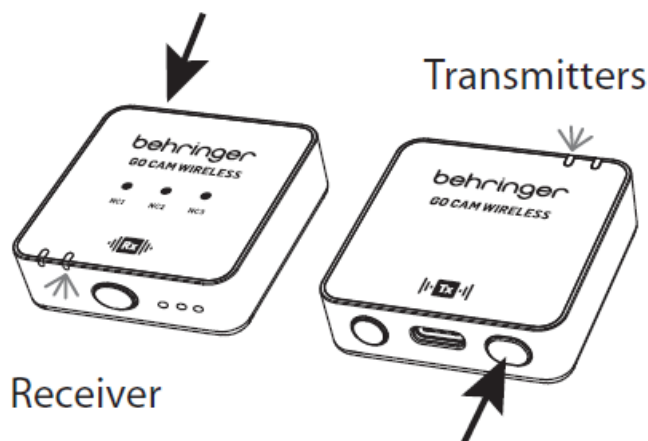

3. A solid Blue LED indicates that the wireless connection between the receiver and transmitter is successful.
4. Clip the transmitter to your shirt, t-shirt, or jacket.
5. Please make sure the built-in microphone is not covered or blocked. For optimum audio recording performance, we recommended the distance between the user's mouth and the transmitter's microphone is 15 to 20 cm.
6. If the audio is too loud, causing distortion – please reduce the microphone gain.
7. In case the environment is noisy – please use the noise reduction feature.
8. Please make sure to check the microphone gain and the noise reduction settings before starting your recording.

Connecting to a Smartphone for video recording

1. **Android Smartphones:** Use the official Type-C to Type-C audio cable to connect the smartphone to the receiver for audio recording. Please ensure that the OTG function and “External Device” option are enabled in the phone settings. For example, OPPO and VIVO phones need to enable the “OTG” function, and OPPO phones also need to enable the “External Device” option. Huawei, Xiaomi, Samsung, and other phones usually plug and play, requiring no additional settings. (As shown in the picture.)
2. **iPhone 14 and earlier models:** Use a 3-section audio head 3.5mm audio cable to plug into the recording output port of the receiver, insert the 4-section audio head (with a phone icon) into a Lightning-certified adapter, and then connect the adapter to the phone's charging port. Please ensure the audio head is inserted correctly and check the audio cable connection. (As shown in the picture.)
3. **iPhone 15 and later models (including iPhone 15):** Support the following two connection methods:
 - **A.** Use a 3-section audio head 3.5mm audio cable to plug into the recording output port of the receiver, insert the 4-section audio head (with a phone icon) into a 3.5mm female to Type-C certified adapter, then connect the adapter to the phone's charging port. Please ensure the audio head is inserted correctly and check the audio cable connection. (As shown in the picture.)
 - **B.** Use the official Type-C to Type-C cable to directly connect the iPhone 15 (or iPhone 15 and later models of smartphones) to the receiver for audio recording.

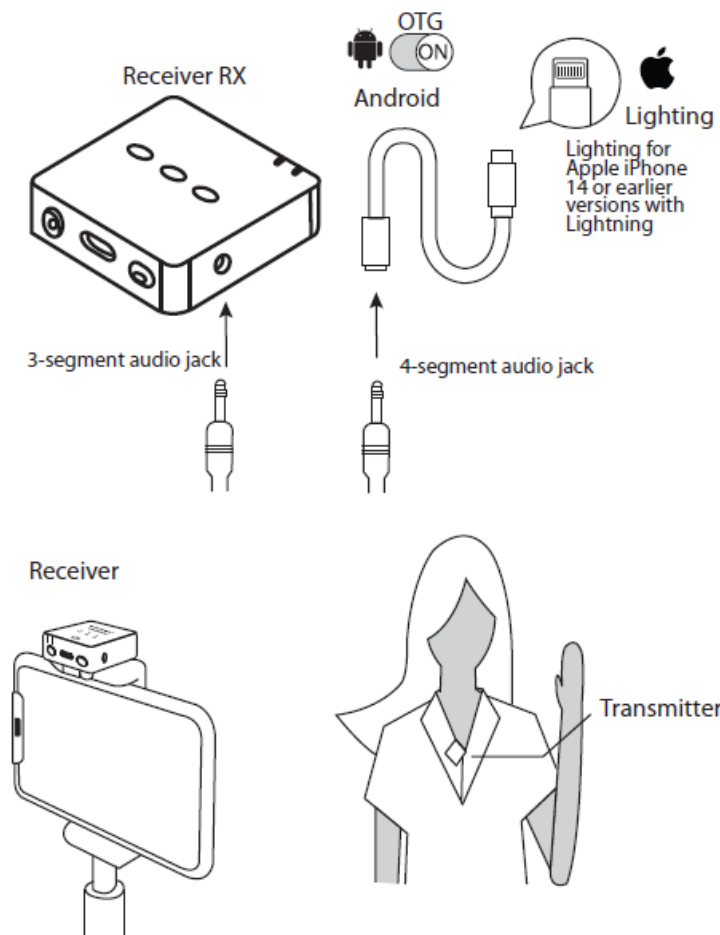

Connecting to a DSLR Camera for video recording

1. Clip the Receiver into the shoe mount of the DSLR camera.
2. Connect the audio output of the receiver to the audio input of the camera, using a 3.5 mm TRS to 3.5 mm TRS audio cable.
3. Please make sure that both 3.5 mm connectors are fully inserted to ensure the proper contact.
4. Turn the camera ON and start video recording.

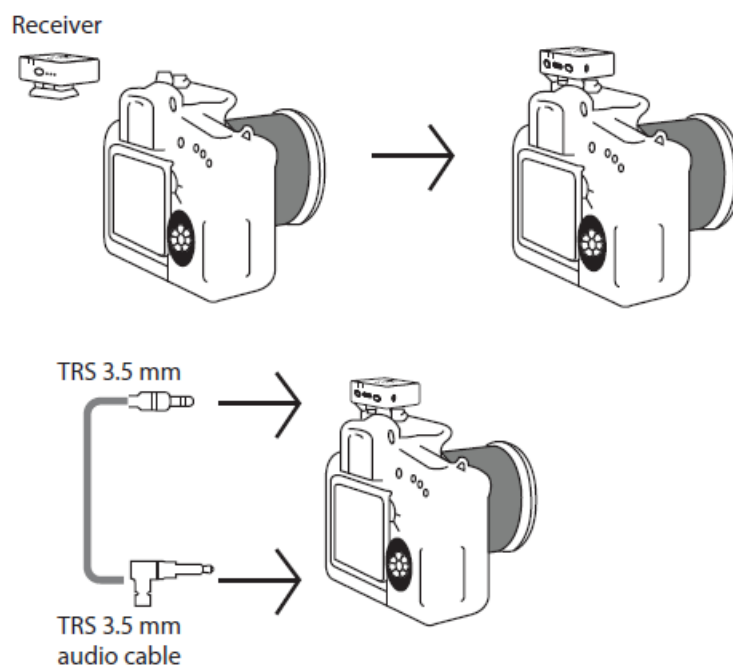

Connecting to earphones for real-time monitoring

1. Please charge the transmitter and receiver before use.
2. Press the receiver and the transmitter Power switch for 2 seconds to power ON. Solid Blue LED indicates the wireless connection between receiver and transmitter is successful.
3. Insert USB C earphones into the USB Type C port of the receiver for real-time monitoring of the recording session.

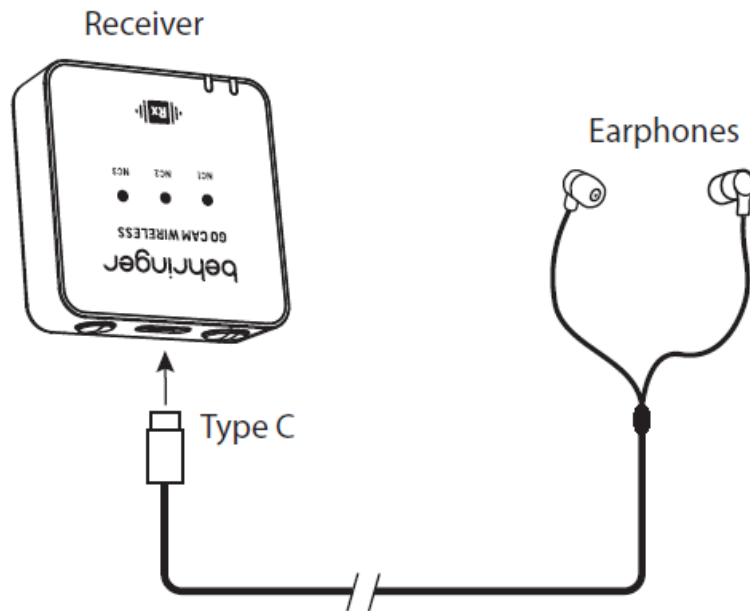

Specifications

Wireless Transmitter

- Connector type 3.5 mm and Type C
- Battery backup Up to 30 hours
- Battery capacity 400 mAh / 3.7 V
- Charging Duration About 1.5 hours
- Weight 30 grams

Wireless Receiver

- Connector type 3.5 mm and Type C
- Battery backup Up to 8 hours
- Battery capacity 400 mAh / 3.7 V
- Charging Duration About 1.5 hours
- Weight 30 grams

Wireless System

- Wireless technology 2.4 GHz ISM
- Modulation GFSK

- Maximum output power 4.01 dBm
- Operating frequency 2.402 GHz – 2.480 GHz
- Channels 79
- Latency Less than 20 mS
- Working distance Up to 30 m

Behringer is constantly striving to maintain the highest professional standards. As a result of these efforts, modifications may be made from time to time to existing products without prior notice. Specifications and appearance may differ from those listed or illustrated.

Other important information

Important information

1. Register online. Please register your new Music Tribe equipment right after you purchase it by visiting musictribe.com. Registering your purchase using our simple online form helps us to process your repair claims more quickly and efficiently. Also, read the terms and conditions of our warranty, if applicable.
2. Malfunction. Should your Music Tribe Authorized Reseller not be located in your vicinity, you may contact the Music Tribe Authorized Fulfiller for your country listed under “Support” at musictribe.com. Should your country not be listed, please check if your problem can be dealt with by our “Online Support” which may also be found under “Support” at musictribe.com. Alternatively, please submit an online warranty claim at musictribe.com BEFORE returning the product.
3. Power Connections. Before plugging the unit into a power socket, please make sure you are using the correct mains voltage for your particular model. Faulty fuses must be replaced with fuses of the same type and rating without exception.

FEDERAL COMMUNICATIONS COMMISSION COMPLIANCE INFORMATION

Behringer

GO CAM WIRELESS

- Responsible Party Name: Music Tribe Commercial NV Inc.
- Address: 122 E. 42nd St.1,
- 8th Floor NY, NY 10168,
- United States
- Email Address: legal@musictribe.com

FCC ID: QWHGOCAM

GO CAM WIRELESS

FCC STATEMENT

This equipment has been tested and found to comply with the limits for a Class B digital device, according to part 15 of the FCC Rules. These limits are designed to provide reasonable protection against harmful interference in a residential installation. This equipment generates, uses, and can radiate radio frequency energy and, if not installed and used under the instructions, may cause harmful interference to radio communications. However,

there is no guarantee that interference will not occur in a particular installation. If this equipment does cause harmful interference to radio or television reception, which can be determined by turning the equipment off and on, the user is encouraged to try to correct the interference by one or more of the following measures:

- Reorient or relocate the receiving antenna.
- Increase the separation between the equipment and the receiver.
- Connect the equipment to an outlet on a circuit different from that to which the receiver is connected.
- Consult the dealer or an experienced radio/TV technician for help.

This equipment complies with Part 15 of the FCC rules. Operation is subject to the following two conditions:

1. this device may not cause harmful interference, and
2. this device must accept any interference received, including interference that may cause undesired operation.

Important information

Changes or modifications to the equipment not expressly approved by Music Tribe can void the user's authority to use the equipment.

Caution!

The manufacturer is not responsible for any radio or TV interference caused by unauthorized modification to this equipment. Such modifications could void the user's authority to operate the equipment.

FCC RF Radiation Exposure Statement

This equipment complies with FCC RF radiation exposure limits set forth for an uncontrolled environment.

CAN ICES-003 (B)/NMB-003(B)

IC RF Radiation Exposure Statement:

Caution!

This device contains license-exempt transmitter(s)/receiver(s) that comply with Innovation, Science, and Economic Development Canada's license-exempt RSS(s).

Operation is subject to the following two conditions:

1. This device may not cause interference.
2. This device must accept any interference, including interference that may cause undesired operation of the device.

This equipment complies with IC radiation exposure limits set forth for an uncontrolled environment.

Hereby, Music Tribe declares that this product complies with Directive 2014/53/EU, Directive 2014/30/EU, Directive 2014/35/EU, Directive 2011/65/EU and Amendment 2015/863/EU, Directive 2012/19/EU, Regulation 519/2012 REACH SVHC and Directive 1907/2006/EC.

- Full text of EU DoC is available at <https://community.musictribe.com/>
- EU Representative: Music Tribe Brands DK A/S
- Address: Gammel Strand 44, DK-1202 København K, Denmark
- UK Representative: Music Tribe Brands UK Ltd.
- Address: 8th Floor, 20 Farringdon Street, London EC4A 4AB, United Kingdom



Correct disposal of this product: This symbol indicates that this product must not be disposed of with household waste, according to the WEEE Directive (2012/19/EU) and your national law. This product should be taken to a collection center licensed for the recycling of waste electrical and electronic equipment (EEE). The mishandling of this type of waste could have a possible negative impact on the environment and human health due to potentially hazardous substances that are generally associated with EEE. At the same time, your cooperation in the correct disposal of this product will contribute to the efficient use of natural resources. For more information about where you can take your waste equipment for recycling, please contact your local city office, or your household waste collection service.



WARNING

- Replacement of a battery with an incorrect type can defeat a safeguard.
- Disposal of a battery into a fire or a hot oven, or mechanically crushing or cutting of a battery can result in an explosion.
- Leaving a battery in an extremely high temperature surrounding environment can result in an explosion or the leakage of flammable liquid or gas.
- A battery subjected to extremely low air pressure may result in an explosion or the leakage of flammable liquid or gas.
- Attention should be drawn to the environmental aspects of battery disposal.
- Batteries (battery packs or batteries installed) shall not be exposed to excessive heat such as sunshine, fire, or the like.

Documents / Resources

	behringer Go Cam Wireless Clip On Microphone System [pdf] User Guide Go Cam Wireless Clip On Microphone System, Wireless Clip On Microphone System, Clip On Microphone System, On Microphone System, Microphone System, System
--	---

References

- [Behringer | Home](#)
- [Music Tribe](#)
- [Music Tribe](#)
- [Music Tribe](#)
- [User Manual](#)

