

Before using this unit, carefully read “USING THE UNIT SAFELY” and “IMPORTANT NOTES” (the leaflet “USING THE UNIT SAFELY” and the Owner’s Manual). After reading, keep the document(s) where it will be available for immediate reference.

Panel Descriptions

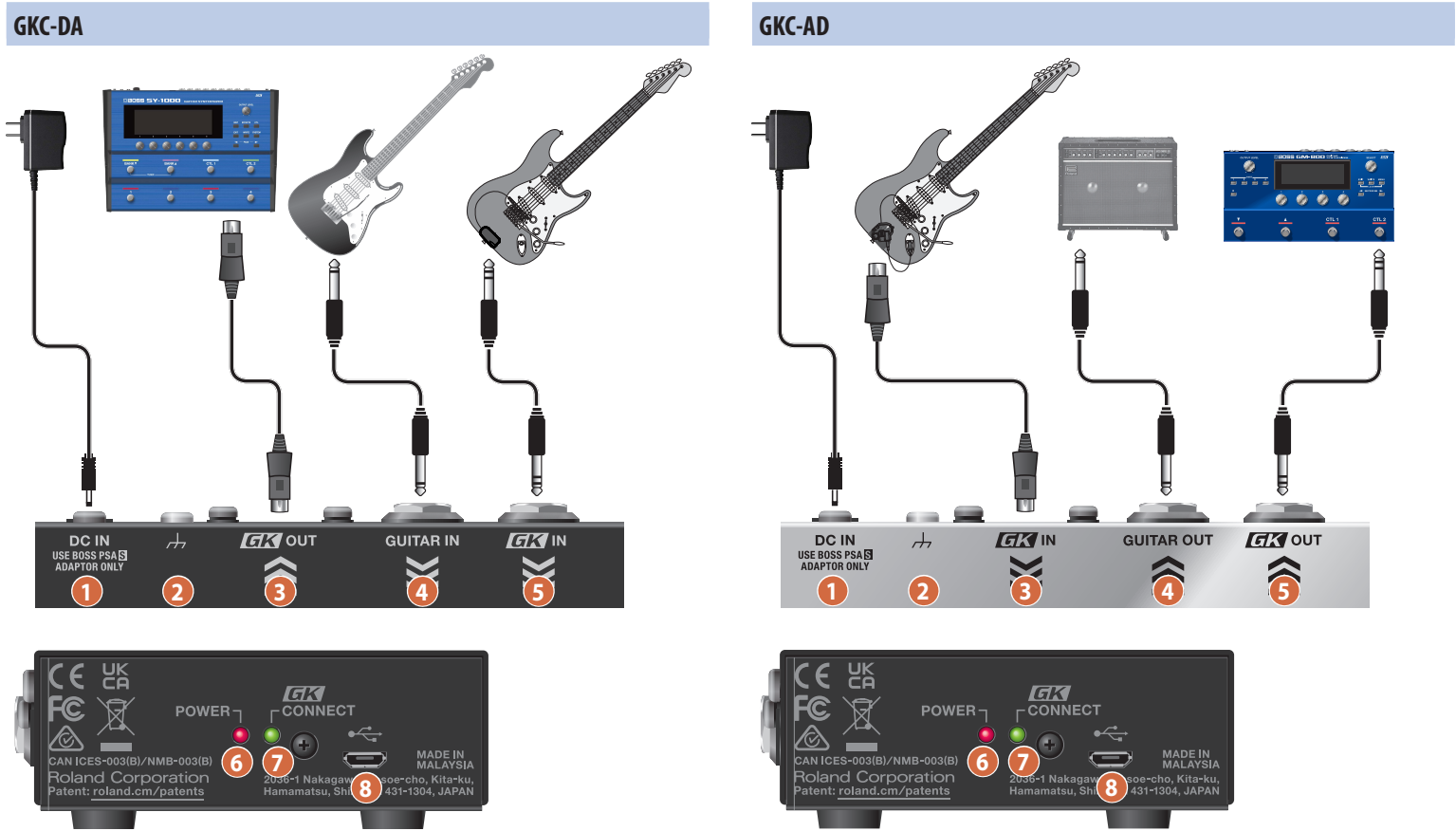

Name	Explanation				
1 DC IN jack	Connect the included AC adaptor to this jack. * The DC IN jack also serves as the power switch. The power turns on when you insert a plug into the DC IN jack, and the power turns off when you unplug the cable.				
2 Ground terminal	Connect this to an external earth or ground if necessary.				
3 GK OUT connector	Connect devices that have a GK IN connector (13-pin DIN type). * Never use a cable other than the dedicated GK cable (13-pin DIN type) for this unit.				
4 GUITAR IN jack	Use this jack to input a normal guitar signal. The signal inputted here is output through the GK OUT connector.				
5 GK IN jack	Connect a guitar or bass guitar that has a BOSS divided pickup such as a GK-5 or GK-5B. * Never use a cable other than the dedicated serial GK cable for this unit.				
6 POWER indicator	This lights up when the unit turns on.				
7 GK CONNECT indicator	Shows the connection status for the GK IN jack (1/4-inch TRS phone type). <table><tr><td>Lit</td><td>Connected</td></tr><tr><td>Blink</td><td>Not connected</td></tr></table>	Lit	Connected	Blink	Not connected
Lit	Connected				
Blink	Not connected				
8 USB port (for program updates only)	Connect your computer using a commercially available USB cable that supports USB 2.0. * Do not use a USB cable that is designed only for charging a device. Charge-only cables cannot transmit data. * This is used only for program updates.				

Name	Explanation				
1 DC IN jack	Connect the included AC adaptor to this jack. * The DC IN jack also serves as the power switch. The power turns on when you insert a plug into the DC IN jack, and the power turns off when you unplug the cable.				
2 Ground terminal	Connect this to an external earth or ground if necessary.				
3 GK IN connector	Connect a guitar or bass guitar that has a Roland divided pickup such as a GK-3 or GK-3B, or a GK-compatible guitar such as the Roland V-Guitar GC-1. * Never use a cable other than the dedicated GK cable (13-pin DIN type) for this unit. * Set the switch on your GK-3/GK-3B or other instrument to the center position (MIX).				
4 GUITAR OUT jack	This jack is for outputting the normal guitar signal input from the GK IN connector.				
5 GK OUT jack	Connect compatible devices that have a GK IN connector (1/4-inch TRS phone type) to this jack. * Never use a cable other than the dedicated serial GK cable for this unit.				
6 POWER indicator	This lights up when the unit turns on.				
7 GK CONNECT indicator	Shows the connection status for the GK OUT jack (1/4-inch TRS phone type). <table><tr><td>Lit</td><td>Connected</td></tr><tr><td>Blink</td><td>Not connected</td></tr></table>	Lit	Connected	Blink	Not connected
Lit	Connected				
Blink	Not connected				
8 USB port (for program updates only)	Connect your computer using a commercially available USB cable that supports USB 2.0. * Do not use a USB cable that is designed only for charging a device. Charge-only cables cannot transmit data. * This is used only for program updates.				

Main Specifications	
Power supply	AC adaptor
Current draw	GKC-DA: 390 mA GKC-AD: 240 mA
Dimensions	115 (W) x 92 (D) x 36 (H) mm 4-17/32 (W) x 3-5/8 (D) x 1-7/16 (H) inches
Weight (excluding AC adaptor)	340 g 12 oz
Accessories	AC adaptor Owner's Manual Leaflet “USING THE UNIT SAFELY”
Options (sold separately)	Serial GK cable: BGK-15 (15 ft./4.5 m), BGK-30 (30 ft./9 m)

* This document explains the specifications of the product at the time that the document was issued. For the latest information, refer to the Roland website.

USING THE UNIT SAFELY

⚠ WARNING

Use only the supplied AC adaptor and the correct voltage

Be sure to use only the AC adaptor supplied with the unit. Also, make sure the line voltage at the installation matches the input voltage specified on the AC adaptor's body. Other AC adaptors may use a different polarity, or be designed for a different voltage, so their use could result in damage, malfunction, or electric shock.

⚠ CAUTION

Handle the ground terminal carefully

If you remove the screw from the ground terminal, be sure to replace it; don't leave it lying around where it could accidentally be swallowed by small children. When refastening the screw, make that it is firmly fastened, so it won't come loose.

IMPORTANT NOTES

Placement

- Depending on the material and temperature of the surface on which you place the unit, its rubber feet may discolor or mar the surface.

Additional Precautions

- Do not use connection cables that contain a built-in resistor.

Intellectual Property Right

- This product includes third party open source software.
Copyright © 2009-2019 Arm Limited. All rights reserved.
Licensed under the Apache License, Version 2.0 (the “License”); You may obtain a copy of the License at <http://www.apache.org/licenses/LICENSE-2.0>
Copyright © 2018 STMicroelectronics. All rights reserved.
This software component is licensed by ST under BSD 3-Clause license, the “License”; You may obtain a copy of the License at <https://opensource.org/licenses/BSD-3-Clause>
- Roland, BOSS are either registered trademarks or trademarks of Roland Corporation in the United States and/or other countries.
- Company names and product names appearing in this document are registered trademarks or trademarks of their respective owners.

* To prevent malfunction and equipment failure, always turn down the volume, and turn off all the units before making any connections.

For the USA

SUPPLIER'S DECLARATION OF CONFORMITY
Compliance Information Statement

Model Name : GKC-DA, GKC-AD
Type of Equipment : GK Converter
Responsible Party : Roland Corporation U.S.
Address : 5100 S. Eastern Avenue Los Angeles, CA 90040-2938
Telephone : (323) 890-3700