

Connecting your devices and operating the top panel

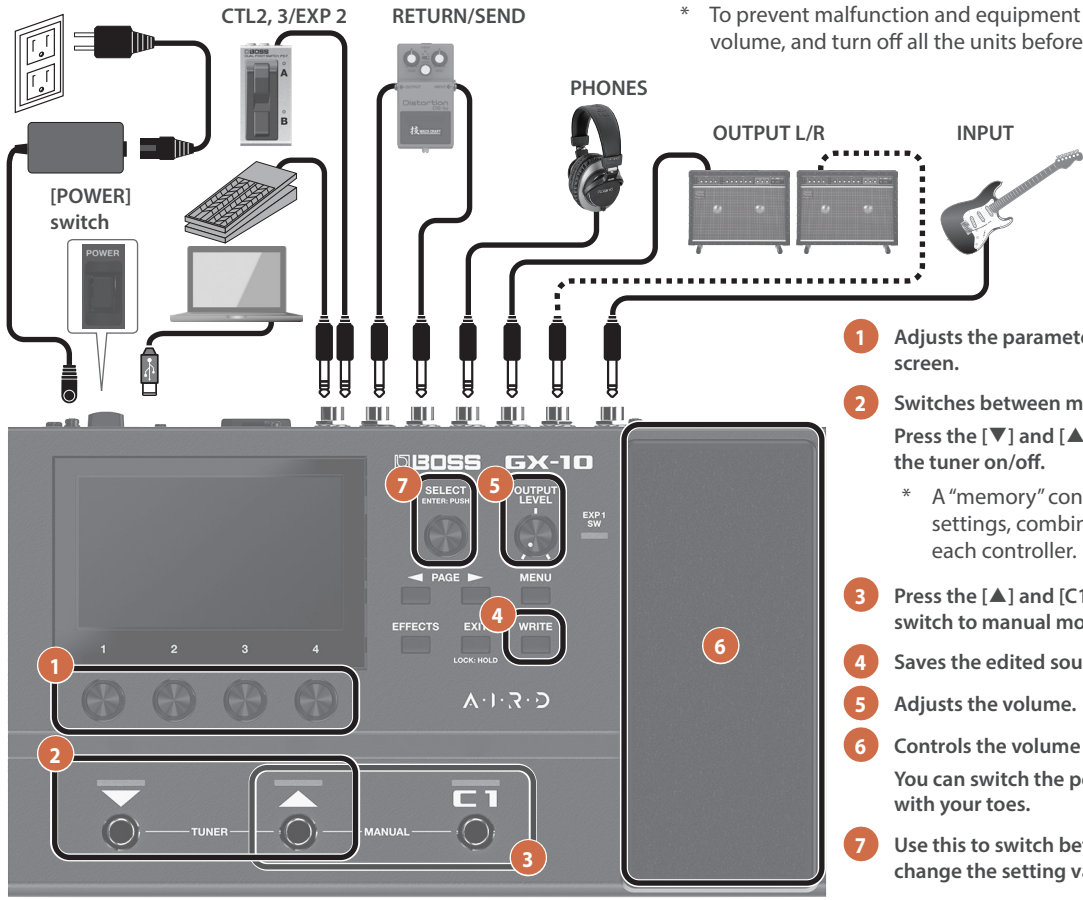

- * When you operate the expression pedal, please be careful not to get your fingers pinched between the movable part and the unit. In places where small children are present, make sure that an adult provides supervision and guidance.
- * Use only the specified expression pedal. By connecting any other expression pedals, you risk causing malfunction and/or damage to the unit. Expression pedals you can use (sold separately): EV-30, FV-500L, FV-500H, Roland EV-5
- * Do not use a USB cable that is designed only for charging a device. Charge-only cables cannot transmit data.
- * Connect this to an external earth or ground if necessary.

Turning the power on

- * Before turning the unit on/off, always be sure to turn the volume down. Even with the volume turned down, you might hear some sound when switching the unit on/off. However, this is normal and does not indicate a malfunction.
- * Once everything is properly connected, be sure to follow the procedure below to turn on their power. If you turn on equipment in the wrong order, you risk causing malfunction or equipment failure.

1. Turn on the [POWER] switch of this unit first, and then turn on any devices connected to this unit. Turn on your amps and speakers last.
2. Adjust the volume of the connected devices.
3. Use the [OUTPUT LEVEL] knob to adjust the volume of this unit.

Auto Off function

The power to this unit turns off automatically to save energy after a certain amount of time (20 minutes by default) has passed since it was last used or since its buttons or controls were operated.

- If the power automatically turns off, any unsaved data is lost. Before the power turns off, save the data that you want to keep.
- If you don't want the unit to turn off automatically, turn this setting off. Note that when the setting is turned off, the unit may consume more power.
- You can simply turn the power back on after it has turned off automatically.

* For details, refer to “Reference Manual” (BOSS website).

Basic screen operations

Play screen

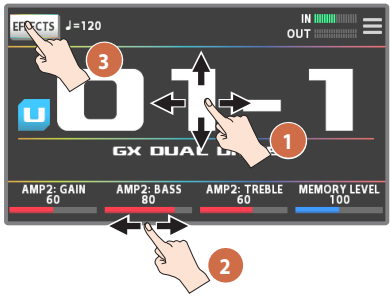

- 1 Swipe the memory number up and down or left and right to switch between memories.
- 2 Drag the respective parameters in the lower part of the screen to the left or right to change their values.
- 3 Touch <EFFECTS> to switch to the chain screen, where you can edit the sound.

Chain screen

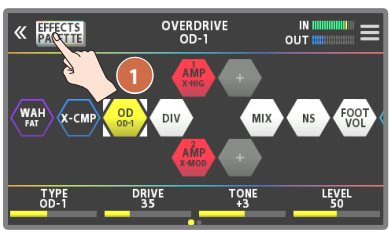

- 1 Touch <EFFECTS PALETTE> to show all the effects as icons in the top row of the screen that you can use on the GX-10.
- 2 Drag the effect icons from the top row of the screen to where you want to place them in the effects chain.
- 3 Drag the icons from left to right to change their order in the effects chain.
- 4 Touch an effect icon to switch the effect on/off.

Using the built-in footswitches

You can choose how the built-in footswitches operate, by changing the control mode according to how you use them.
For details on how to make the settings, refer to “Reference Manual” (BOSS website).

MEMO

A group of three memories is called a “bank”.

Control mode	Explanation	[▼] switch	[▲] switch	[C1] switch
UP/DOWN (up/down mode)	In this mode, the memories switch in sequential order. This is the factory setting.	Switches to the previous memory.	Switches to the next memory.	Operates the assigned function.
BANK/NUM (bank/number mode)	This mode switches between memories 1–3 for each bank. You can switch to the previous bank by pressing the [▼] and [▲] switches at the same time, or to the next bank by pressing the [▲] and [C1] switches at the same time.	Switches to the first memory in the same bank.	Switches to the second memory in the same bank.	Switches to the third memory in the same bank.
MANUAL (manual mode)	This mode is for operating the functions assigned to each switch.	Operates the assigned function.	Operates the assigned function.	Operates the assigned function.

Reference Manual (BOSS website)

Refer to the website listed below for detailed documentation on how to operate this unit.

https://roland.cm/gx10_om



BOSS TONE EXCHANGE

You can download memories for this unit from our dedicated BOSS TONE EXCHANGE website.

<https://bosstoneexchange.com/>

