

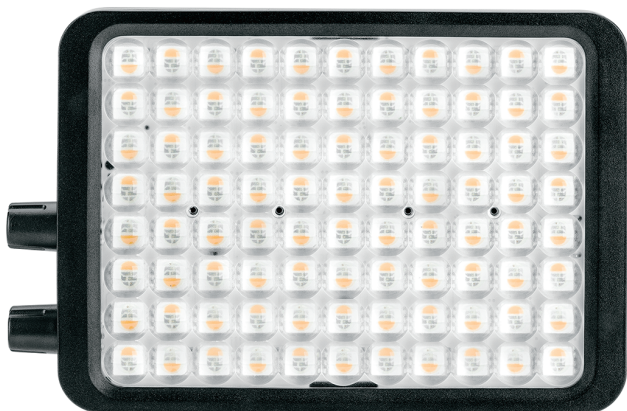

## Solar series

VENUS  
5" On-Camera  
RGB LED Light



## Celebrate the Light!

The CLAR Galaxy Series of LED lights break through the limitations of traditional one- or two-color LED panels and opens into the world of virtually limitless color illumination. RGBAW diodes produce a stunning array of lighting effects and spectrum of colors from a blend of Red, Blue, Green, Amber, and White. Conform to any environment, preexisting installed bulb color balance or natural ambient sources by sifting through the myriad of brightness, hue and saturation combinations.

Synchronize with lights of all sizes and sources, choose from millions of possible colors, apply effects animated lighting effects, and control them instantly with the CLAR SOLAR mobile app.

Say goodbye to single color temperature and Bi-Color lights, and enjoy the unbridled luxury of the CLAR Galaxy of boundless color!

The Venus Multi-color LED Light marks a new beginning in the possibility color lighting with a single LED light panel.

With its highly accurate and versatile RGBW LED panel and the addition of Bluetooth 4.0 LE connectivity, the Venus is the perfect light for all occasions.

## Specifications

Attribute	Detail
DC power input	12-15V
USB-C input	12V
Battery	NP-F style battery. minimum 2200mAh
Bluetooth	Low Energy version 4.0
Dimensions	5" × 1" × 3" / 12.7 × 2.5 × 7.6 cm
Weight	.75 lb. / 340 g

Each CLAR Venus light is individually checked and calibrated. Refer to the calibration sheet for the photometric specs.

## Safety Warnings

- The environment should be kept dry and ventilated when using the light. The unit should never be exposed to water and moisture. Take heed when operating outdoors in precipitation.
- Don't use the light near flammable liquids or vapors, like gasoline.
- Don't attempt to modify the unit yourself. If it becomes damaged, please contact your vendor or take it to an authorized repair service. In the event of a malfunction, the product should be repaired only by a qualified technician.
- Make sure you only use the correct proper voltage.
- Don't let children play with the unit. Keep the light out of reach from children.
- Should smoke come from the unit, disconnect the power immediately and place it in a safe location. It is normal for the fixture to become warm when working.
- After using the light for extended periods, allow it to cool before storing, to avoid damage to the electronic components.

## Overview

### Back

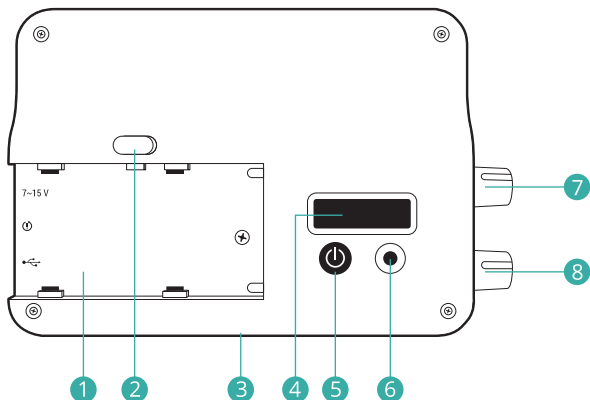

1. Battery slot (use Sony L-Series-compatible battery)
2. Battery release switch
3. 1/4"-20 mount
4. LCD display
5. Power button
6. CCT (correlated color temperature) and color wheel mode toggle button
7. Brightness dial
8. CCT and color wheel dial

## Overview

### Side

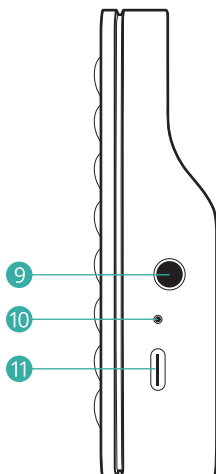

- 9. DC power input  
(use a 2.1mm 7-15 V power adapter-not included)
- 10. Reset button
- 11. USB C Port for Power and Firmware upgrades

## User Interface

### General

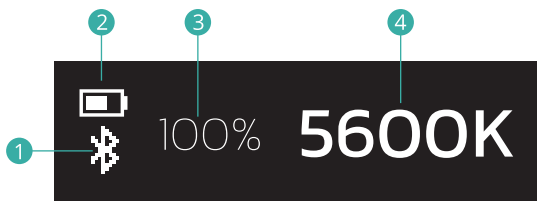

1. Bluetooth indicator

2. Battery indicator

3. Brightness percentage

4. Color Temperature

### Bluetooth Status Indicators

✱ Disconnected   ✱ Searching   ✱ Connected

## CCT Mode

1. Color temperature preset
2. Color temperature in Kelvin(3000-10,000 K)

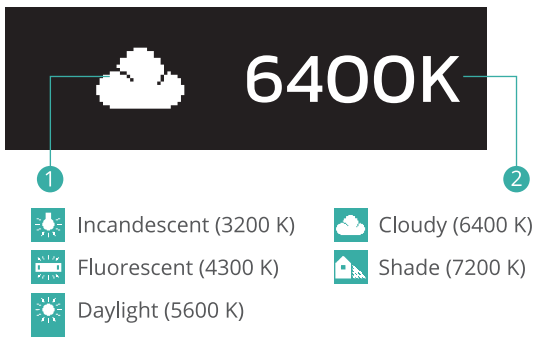

## Color Wheel Mode

1. Hue preset
2. Numerical indicator of hue setting (0°-360°)

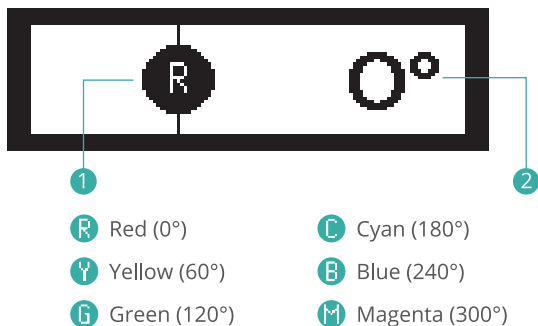



## Filter Mode

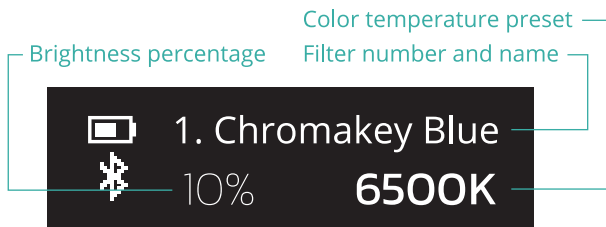

⚙ Scroll: Scrolls through all installed gels.

⚙ Press: Switches between 3200, 5600, and 6500 K white balance color temperatures.

## Effects Mode

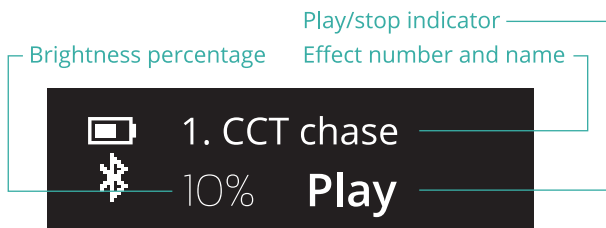

⚙ Scroll: Scrolls through available effects.

⚙ Press: Runs and stops the effects.

## Using the Clar Venus

### **ON/OFF button**

This button is used to turn the Clar Venus on or off, as you would expect. When you turn the Clar Venus off, it will preserve its current settings for brightness, color, etc. When you turn it on again, it starts up with the settings it had when you turned it off. A long press on the ON/OFF button will clear any PRESETs you have saved previously.

### **Mode button**

Press the mode button to alternate between white mode and color mode. In white mode you can adjust the color temperature. In color mode, you can select a hue.

### **Brightness knob**

Used to adjust the brightness between 0 and 100%.

If you press and hold this knob for a few seconds, it will store the current brightness and color/CCT as a PRESET. If you press the knob briefly, it will call up your stored PRESET.

### **CCT/Color knob**

When in white mode this knob will adjust your color temperature. Turn the knob slowly for fine adjustment or fast to jump between common color temperatures like tungsten, fluorescent, daylight, etc.

When in color mode this knob will adjust the color hue.

## Presets / Custom Presets

The unit will come pre-programmed with two default presets in CCT mode.

When in CCT mode, press the CCT/Color knob it will jump between 3000 tungsten and 5600 Kelvin.

You can add eight additional custom presets in CCT mode, and ten custom presets in Color mode.

To set a custom preset, first choose the desired mode (Color or CCT), set the color temperature or color hue and long press the CCT/Color knob for >3 seconds and message will come up on the screen asking to save as a preset, short press again the CCT/Color knob and the setting will be saved.

To clear the presets, first choose the mode (Color or CCT) then press the power button for >3 seconds, a message will come asking if you want to clear the Color/CCT presets, short press the power button and the presets in that mode will clear.

**Note:** the default presets cannot be cleared.

## Firmware Upgrades

To upgrade the firmware, please visit [adorama.com/g/clar](http://adorama.com/g/clar) and download the latest firmware.

Turn off the Venus, plug in the DC power supply or the battery. Connect a USB C cable to the light and a PC or Mac computer. Hold in the mode button while turning on the light, the light should say Bootloader running.

A Clar Venus folder will turn up on the computer. Open it, delete the old firmware file, and copy the new firmware file into the folder.

Disconnect the light from the computer and the new firmware should be running on the light.

## Display

Displays brightness, color/CCT, power source, and Bluetooth status.

## Battery Bay

This is where you plug in the battery. The Clar Venus can charge your battery while you are using the light. Provided you have power plugged into the DC barrel of the USB-C port of course.

This is how it works: Power to the light is prioritized. If you run on full blast, the Clar Venus will take whatever it needs, and any remaining power is used to charge the battery. If you dim the light, more power may be available to charge the battery. The Clar Venus will never draw more than 3A at 12 volts.

## **DC barrel input**

You can use an AC adapter to power the light through the DC barrel connector. Make sure your AC adapter is 2 amp or MORE and 15 volts or LESS. We recommend a 12V, 3A AC adapter. Check that the label reads minimum 2A. It may state watts instead of amperes, in that case, look for 24W (or more).

## **USB-C input**

You can power the light from the USB-C connector provided your USB-C power adapter can provide enough juice. If it cannot - the Clar Venus will display “Not enough power” in the display.

USB-C adapters come in many varieties, and not all can power the Clar Venus. You want to use a USB-C power adapter that can provide minimum 12V and 2A. Some USB-C power adapters only provide 5V, and that will not be enough.

For your safety and comfort, be wary of cheap mystery brand power adapters. Spring for decent quality adapters and stay safe.

The USB-C connector can also be used for firmware updates via a PC or Mac.

You can switch between DC barrel, USB-C and battery power without interrupting the light.



## Connecting to the App

1. Make sure that Bluetooth has been enabled on your device before opening the app.
2. Power on the Unit and the Bluetooth indicator should be visible.(Bluetooth is always on when the light has power.)
3. Open the app.
4. The app will detect the Unit upon startup, and you will notice the Bluetooth icon changing on the light itself.
5. The app will prompt you to connect the Unit to the app. Once you do, the light is connected and ready to use with the app.
6. To disconnect, exit the app.

## FCC Compliance Statement

This device complies with part 15 of the FCC rules. Operation is subject to the following two conditions: (1) This device may not cause harmful interference, and (2) this device must accept any interference received, including interference that may cause undesired operation.

**Note:** This equipment has been tested and found to comply with the limits for a Class B digital device, pursuant to part 15 of the FCC Rules. These limits are designed to provide reasonable protection against harmful interference in a residential installation. This equipment generates, uses, and can radiate radio frequency energy and, if not installed and used in accordance with the instructions may cause harmful interference to radio communications. However, there is no guarantee that interference will not occur in a particular installation. If this equipment does cause harmful interference to radio or television reception, which can be determined by turning the equipment off and on, the user is encouraged to try to correct the interference by one or more of the following measures:

- Reorient or relocate the receiving antenna.
- Increase the separation between the equipment and receiver.
- Connect the equipment to an outlet on a circuit different from that to which the receiver is connected.
- Consult the dealer or an experienced radio/TV technician for help.

**Important:** Changes or modifications to this product not authorized by Adorama could void the electromagnetic compatibility (EMC) and wireless compliance and negate your authority to operate the product. This product has demonstrated EMC compliance under conditions that included the use of compliant peripheral devices and shielded cables between system components. It is important that you use compliant peripheral devices and shielded cables between system components to reduce the possibility of causing interference to radios, televisions, and other electronic devices.

## One Year CLAR Limited Warranty

CLAR warrants to the original purchaser that your CLAR product shall be free from defects in material and workmanship for the period of one (1) year from the date of purchase (or delivery as may be required in certain jurisdictions), or thirty (30) days after replacement, whichever comes later.

CLAR's entire liability and your exclusive remedy for any breach of warranty shall be, at CLAR's option, to repair or replace the hardware, provided that the hardware is returned to the point of purchase or such other place as CLAR may direct with a copy of the sales receipt or dated itemized receipt. CLAR may, at its option, replace your product, offer to provide a functionally equivalent product, or repair any product with new, refurbished or used parts as long as such parts are in compliance with the product's technical specifications. Any replacement hardware product will be warranted for the remainder of the original warranty period or thirty (30) days, whichever is longer, or for any additional period of time that may be applicable in your jurisdiction. If the product has been discontinued, the warranty provider reserves the right to replace it with a model of equivalent quality and function.

This warranty does not cover problems or damage resulting from accident, abuse, misapplication, or any unauthorized repair, modification or disassembly, improper operation or maintenance, normal wear and tear, or usage not in accordance with product instructions or connection to improper voltage supply, use of consumables, such as replacement batteries, not supplied by CLAR, except where such restriction is prohibited by applicable law.



Except where prohibited by applicable law, this warranty is nontransferable and is limited to the original purchaser and the country in which the product was purchased. This warranty gives you specific legal rights, and you may also have other rights, including a longer warranty duration that may vary under local laws.

To start a warranty claim, contact the CLAR Customer Service Department to obtain a return merchandise authorization ("RMA") number, and return the defective product to CLAR, along with the RMA number and proof of purchase.

### **Question about our product line? Need Product Support?**

We are proud of our products and celebrate our customers. We are with you, from product selection to everyday use. Be secure with your purchase and reach us as you need.

**Email us:** [brands@adorama.com](mailto:brands@adorama.com)    **Call:** 212-647-9300

#### **Address:**

Adorama Brands, 42 West 18th Street, New York, NY 10011

You can always contact us at [BRANDS@ADORAMA.COM](mailto:BRANDS@ADORAMA.COM) for personal technical support. Our web site contains a wide range of Support and FAQ pages with valuable technical assistance.

CLAR is a registered trademark of ADORAMA CAMERA.

© 2018 Adorama Camera, Corp. All Rights Reserved.

CLVENUS5

Adorama Inc., New York, NY  
[www.adorama.com/ourbrands](http://www.adorama.com/ourbrands)