

Cineroid[®]

Cinema & Broadcasting Equipment

CL800



LED LIGHT

Safety Instructions / User's Manual

RGBW full range with white light / Light weight metal panel
Metal Ballast / CRI 95 or above / Ball mount bracket with 16mm spigot
Color temperature 2700°K ~ 6500°K / Extension up to 10 meter
100% dimming / DMX Built-in / Battery charging / Real time synchro
Custom effect / 6 Preset reserve / USB 5V output / USB Firmware update

www.cineroid.com

Thank you for purchasing the Cineroid CL800.

The Cineroid CL800 is high quality RGBW soft light with portable size. Light weight and thin panel makes easy to use and getting around any type, environment. Please thoroughly read the user manual for best operation and understanding of all of the functions of the CL800.

| Test Before Operating

It is recommended to test the CL800 before operating. Check if the CL800 can be turned on once powered, and check if the information/menu is being properly displayed on the LCD.

Safety Precautions

Please observe the following safety precautions as they are meant for the safe and proper use of the product to reduce the risk of accidents. Upon reading the user manual, keep it in a safe and available place.

- Ⓢ Do not use any batteries, power cord, or accessories that are not specified in this document.
when your hands are wet. When unplugging the power cord, grasp the plug body or adapter instead of the cord.
- Ⓢ Power cords that are scratched, heavily bent or twisted can potentially be hazardous and a source of electric shock and/or fire.
- Ⓢ Do not insert foreign objects into the product's electric or cable components.
- Ⓢ Do not place the power cord near sources of heat as this may melt or cause damage to the cord potentially causing fire or electric shock.
- Ⓢ Do not disassemble or modify the product. This may damage the product and cause danger due to a malfunction.
- Ⓢ Please keep the product out of reach of young children. Injuries may occur due to damage to the product.
- Ⓢ When using the product in an airplane or hospital setting, it is recommended to acquire authorization first as signals or electro-magnetic waves from the product may cause other equipment to malfunction.
- Ⓢ Do not store the product in a dusty or humid environment as damage may occur.
- Ⓢ When the product is mounted on a camera, do not lift or move the camera by grabbing the product. This may cause damage to the product or the camera mount.
- Ⓢ Do not clean the product with paint thinner, benzene, or other volatile solvents. This may cause damage to the product and become a fire hazard.
- Ⓢ This product is not waterproof. If the product is dropped in water, contact the service center immediately.

Table of Contents

Safety Precautions	3
Table of Contents	4
Package Contents	6
Components of each Models	7
Name of each part	8

Before Using CL800

Connect LED Panel to the Ballast	11
Input the Power by DC	12
Input the Power by Battery	12
Power On / Off	13
Charging the Battery	13
USB and D-Tap Output	13
Set the Soft Box	14

Operating CL800

Basic Operation	15
CCT Mode (White Color)	16
RGB Mode	17
Hue/Sat Mode	18
Preset	19
Effect Mode	20
User Effect Mode	20

System

Firmware Update	21
Color Unit	21
Master / Slave	22
DMX	22
Specifications	23
Optional Accessoires	23

Package Contents

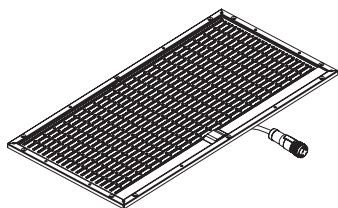

LED Panel

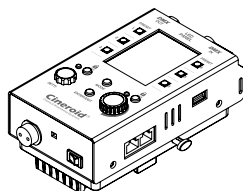

Ballast

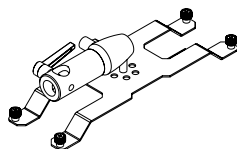

H-Bracket

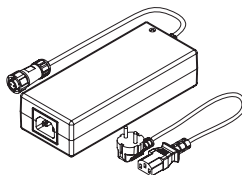

AC Adapter

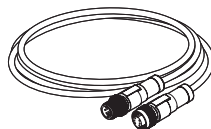

Extension Cable

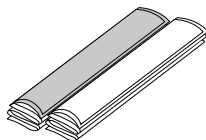

Soft Diffuser

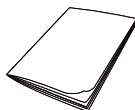

Manual

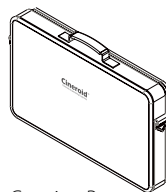

Carrying Bag

Components of each Models

Please ensure all parts are present after opening the box.

CL800 Single Set

CL800V

LED Panel, Ballast(V-Battery Mount), Soft Diffuser, Bracket with spigot, AC Adapter, Carrying Bag, Manual

CL800G

LED Panel, Ballast(G-Battery Mount), Soft Diffuser, Bracket with spigot, AC Adapter, Carrying Bag, Manual

CL800N

LED Panel, Ballast(without Battery Mount), Soft Diffuser, Bracket with spigot, AC Adapter, Carrying Bag, Manual

CL800 3 Set

CL800-3V

LED Panel x3, Ballast(V-Battery Mount) x3, Soft Diffuser x3, Bracket with spigot x3, AC Adapter x3, Carrying Bag, Manual

CL800-3G

LED Panel x3, Ballast(G-Battery Mount) x3, Soft Diffuser x3, Bracket with spigot x3, AC Adapter x3, Carrying Bag, Manual

CL800N-3N

LED Panel x3, Ballast(without Battery Mount) x3, Soft Diffuser x3, Bracket with spigot x3, AC Adapter x3, Carrying Bag, Manual

Name of each part

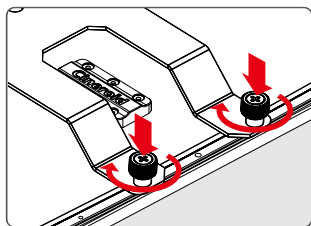
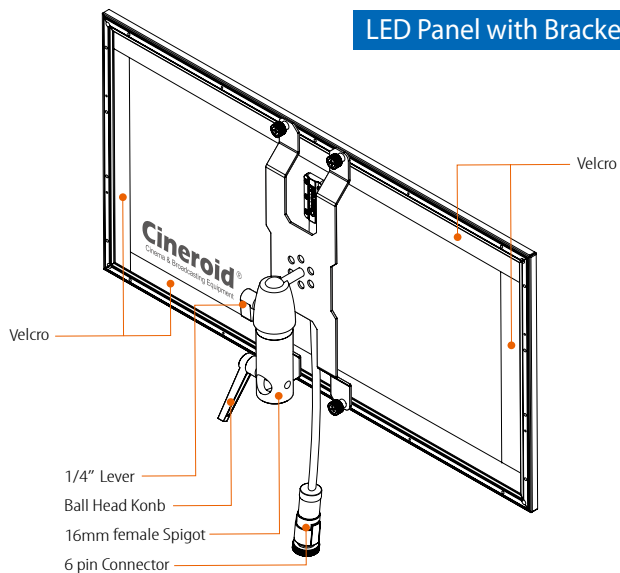
**Set LED Panel on the Bracket**

To combine the LED panel with the bracket, rotate the 4 screws of the bracket by pressing and screwing them together.

Name of each part

Ballast

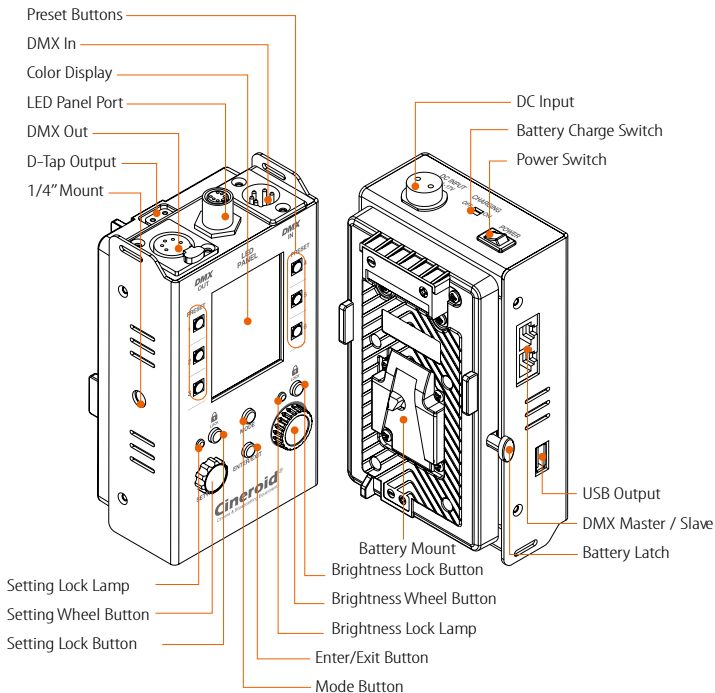

Before Using CL800

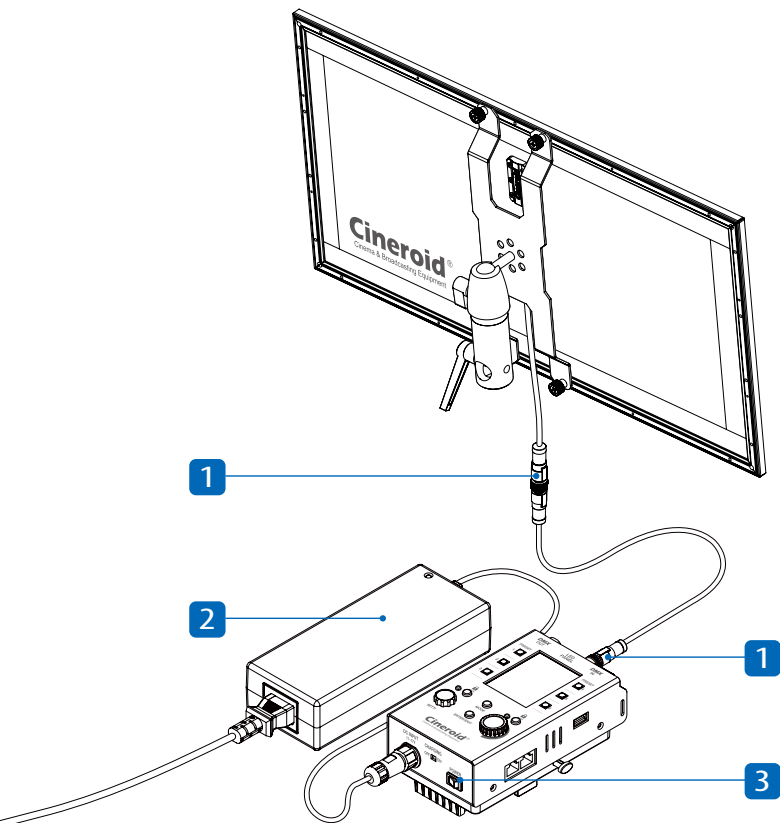

Before Using CL800

1 Connect LED Panel to the Ballast

Connect the LED panel and ballast connectors.
And then screw the nut to tight. It can be used
extension cable between connectors.(optional)

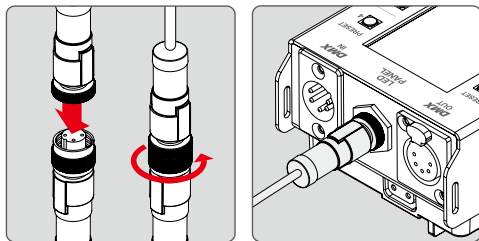

2 Input the Power by DC

Connect the LED panel and ballast connectors.
And then screw the nut to tight.

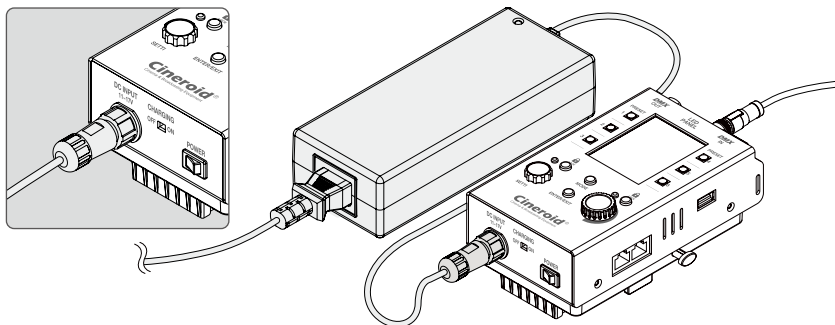

Before Using CL800

2 Input the Power by Battery (FL-DV/FL-DG)

Insert the correct type battery to the battery port.

Turn on the power button to check the LCD.

When removing the battery, press the detach latch and remove the battery in reverse order of mounting.

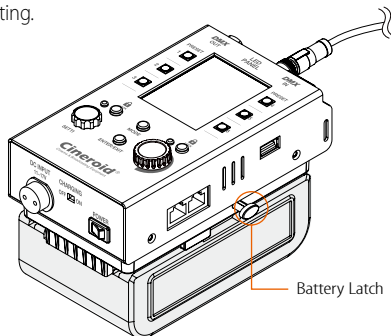
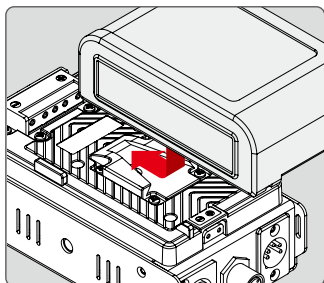

Battery Latch

3 Power On / Off

Press the button to turn on the controller.

The CINEROID logo appears briefly on the controller screen.

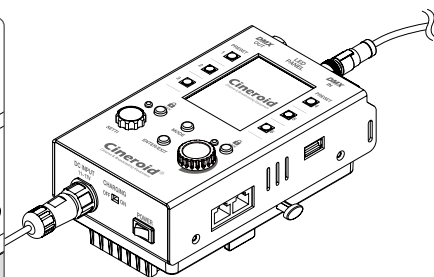
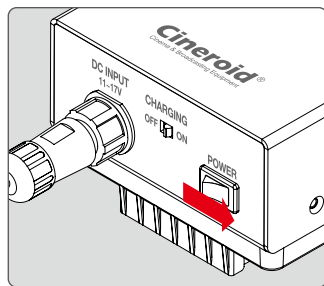

Before Using CL800

4 Charging the Battery

Connect the battery to the ballast, turn off the power switch while DC power is connected, and turn on the Charging switch. When the battery is charging, a red battery icon appears on the display. When charging is complete, the green battery icon is displayed.

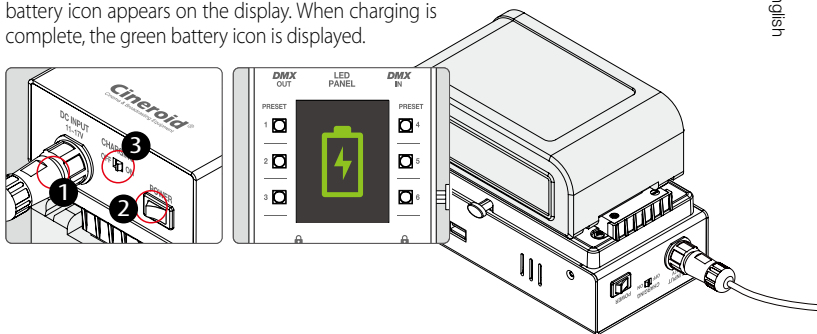

5 USB and D-Tap Output

The controller can be used as USB or D tap output. Connect the power to the controller and use it with the switch turned on.

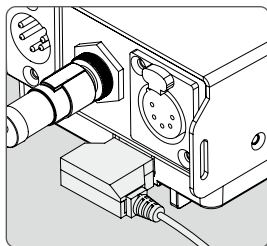

D-Tap Output

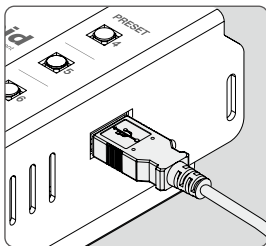

USB 5V Output

Before Using CL800

6 Set the Soft Box

Install the Soft Box Body first. Open Soft Box Body and attach it to the Velcro on the back of the LED panel. After installing the Soft Box Body, cover the Soft Diffuser to the Velcro outside Soft Box Body.

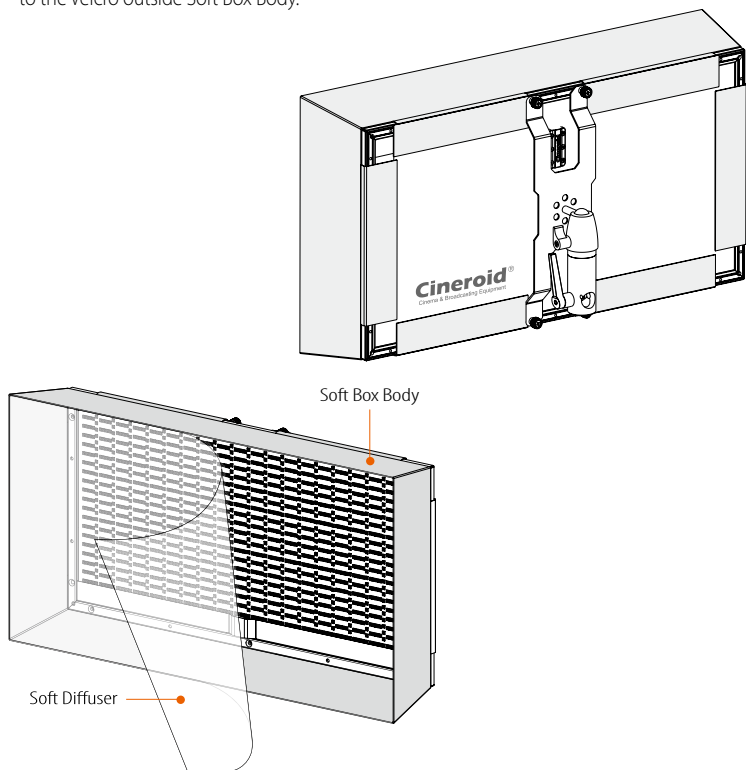

Operating CL800

1 Basic Operation

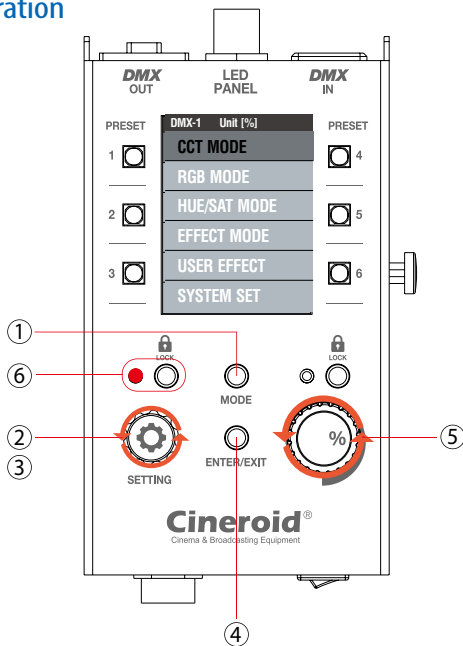

1. Access the LED mode menu by pressing the mode button on Ballast.
2. Turn the Setting Button to set the value and press the Setting Button to complete the setting.
3. Press Exit Button to return to the previous screen.
4. Brightness Wheel is only used to adjust the brightness.
5. You can lock the setting button and brightness respectively. When the button is pressed, the corresponding Lock Button Lamp lights and the button can not be operated. Press it again to release the lock.

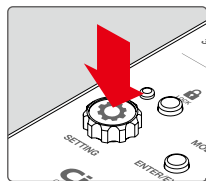

Pressing Setting button

Operating CL800

2 CCT Mode (White Color)

① Brightness

Turning the brightness wheel button to the right to increase brightness. Turn to the left to decrease brightness. You can adjust the Brightness by 0~100% dimming.

② Color Temperature

Turn the Setting Button to the right increases Color temperature and left decreases Color temperature. You can adjust color temperature from 2700°K to 6500°K by Setting Wheel Button in CCT mode.

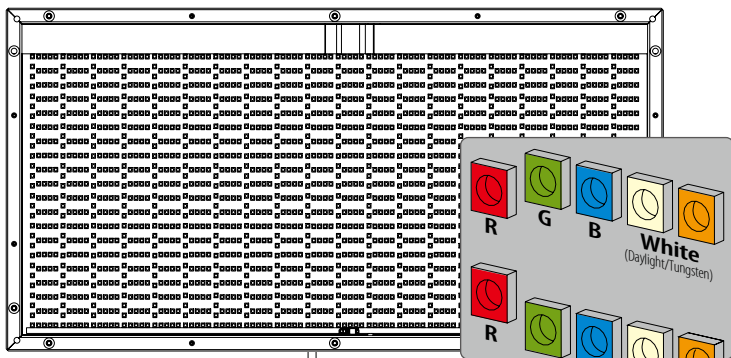
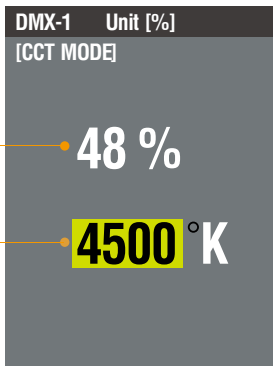

PN-CL800

Operating CL800

3 RGB Mode

① Brightness

Turn the Brightness Wheel to adjust the brightness. Brightness can be set from 0 to 100%. The current color is displayed next to the brightness indicator.

② Internal Preset Color

Select Internal Preset Color. The information of the 12 internal preset color values is displayed in the lower RGB boxes respectively.

③ Color manual setting

You can specify RGB color values manually. Red, Green, Blue Specify a value for each color.

④ White Color intensify

White color can be added to or subtracted from the RGB color value. White Color Intensify Sets the ratio values of RGB and White Color in the graph.

⑤ White Color temperature

Sets the Color Temperature of the White Color. It can be set from 2700 to 6500K.

⑥ Color History

Please refer to ④ on next page.

Current Color

The image displays two screenshots of the DMX-1 control interface in RGB Mode. The top screenshot shows the 'Current Color' screen with a red color selected and a brightness of 31%. The bottom screenshot shows the manual color setting screen with RGB values of R:255, G:105, B:0 and a white color intensify of 75%.

English

DMX-1 Unit [RGB]
[RGB MODE]
31 %
R 255
G 105
B 0
RGB 50 % W 50 %
CCT 3300 K
>>Color History

DMX-1 Unit [RGB]
[RGB MODE]
31 %
R 255
G 105
B 0
RGB 75 % W 25 %
CCT 3300 K
>>Color History

Operating CL800

4 Hue/Sat Mode

① Brightness

Turn the Brightness Wheel to adjust the brightness. Brightness can be set from 0 to 100%. The current color is displayed next to the brightness indicator.

② Internal Preset Color

Select Internal Preset Color. Information on the 12 internal Preset Color values is displayed in the lower HUE and SAT boxes respectively.

③ Hue / Saturation

Set HUE and SAT values.
HUE can be set from 0° to 359°,
and SAT can be set from 0 to 100%.

④ Color History

Color values executed for more than 30 seconds in RGB and HUE/SAT modes are automatically saved up to 36 Color History. You can check the color and information of the saved values in Color History. You can also select and re-use it.

Current Color

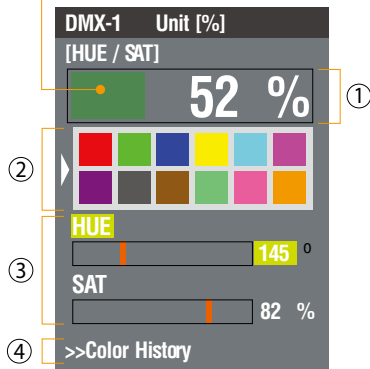

Selected Color

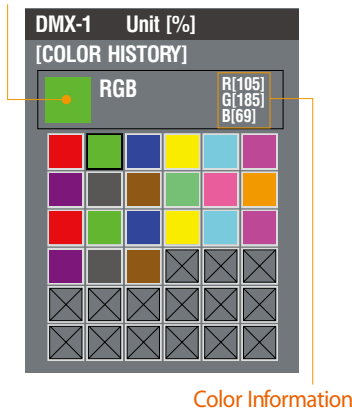

Operating CL800

* Tip Preset

Preset 6 of the RGB colors that you use often, you can conveniently use.

1 ~ 6 Press Preset Button for 1 sec. And the current value will be set in the preset.
Press briefly to run.

① Preset CCT

Mode - CCT Mode - Save or Run

② Preset RGB

Mode -RGB Mode - Save or Run

③ Preset HUE/SAT

Mode -HUE/SAT Mode - Save or Run

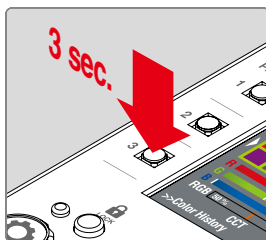

Save Preset

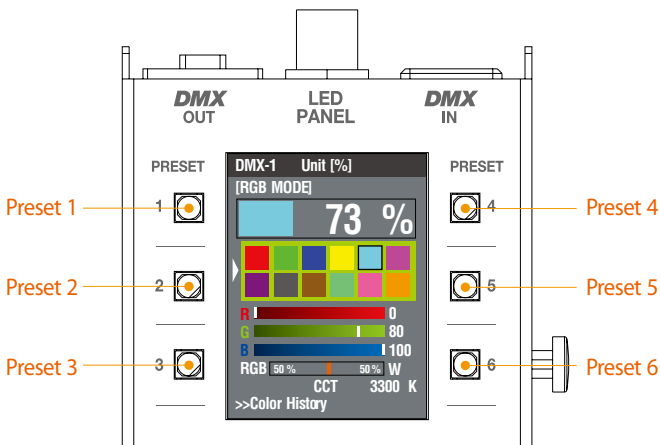

Operating CL800

5 Effect Mode

Indicates lighting effects according to the situation.
Repeat with a certain pattern.

① Select the Effect

Green cursor appears under the effect name you are selecting.
You can select the arrow to move to the next or previous page.

② Repeat Rate

Sets the repetition rate of the effect.

③ Brightness

You can adjust the brightness of the effect by using the Brightness Wheel.

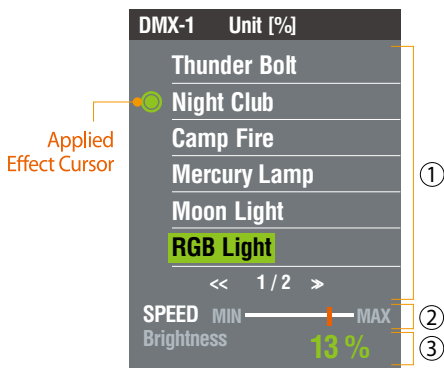

6 User Effect Mode

Use the user-created effect manually.

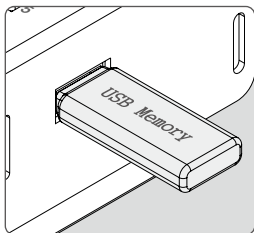

Connecting USB Memory

Save the set file to USB memory.
Connect to USB port and save to Ballast.
(Access : Mode-System set-Custom Data Update)

System

1 Firmware Update

- ① Download new firmware data to USB memory through Cineroid homepage.
- ② Connect USB memory that contains firmware data to Ballast.
- ③ If you click F/W Update in System, the update will start automatically. When the update is finished, ballast restarts.

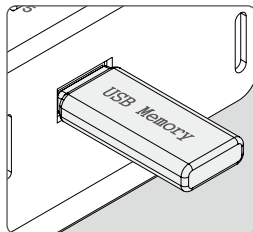

2 Color Unit

The value of RGB mode, you can display and change the percentage values or RGB values. (Access : Mode - System set - Color Unit)

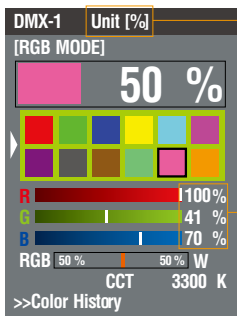

Color Unit [%]

Color Value [0~100 %]

Percentage Mode

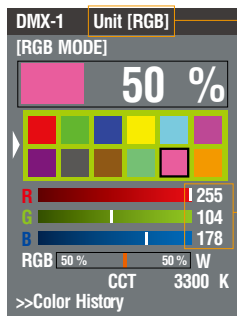

Color Unit [RGB]

Color Value [0~255]

Numeric Mode

System

3 Master / Slave

You can control multiple CL800 simultaneously by operating one CL800.

- 1 Connect the ballast to be used as master and the ballast to be used as slave by using RJ45 cable.
- 2 In mode, specify master ballast and slave ballast.
(Access : Mode - System set - DMX Set - Sync Maseter or Sync Slave)
- 3 When master ballast is operated, slave ballast is operated together. The current mode is displayed at the top of the screen.



4 DMX

DMX 512 channels and DMX controllers can be used to control multiple CL800s simultaneously.

- 1 Connect the DMX controller to the CL800 Ballast using an XLR 5pin cable.
- 2 Set the DMX channel you want to use.
(Access : Mode - System set - DMX Set - DMX)
- 3 Set the DMX mode. The functions of the selected mode from the selected channel are sequentially assigned to the channel. The current mode is displayed at the top of the screen.

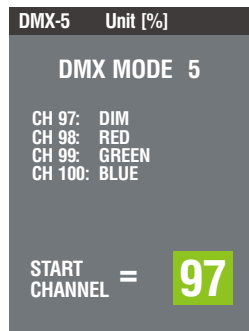

Specifications

LED Panel

Dimension	460 x 240 mm
Weight	600 g
Dimming	0~100%
Photometric	3400 lux
Color Temperature	2700°K ~ 6500°K
LED Cells	2080
CRI	95 or above
Power	120W

Metal Ballast

Dimension	170 x 86 x 70 mm
Weight	500 g
Dimming	0~100%
CCT	2700°K ~ 6500°K
Display	Color LCD
Cable Length	2m (can be extended)
Control Lock	Yes
DMX	512 Channel
DC Input	11~17 V

Optional Accessoires

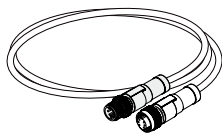

ECF603

Extension Cable (3m)

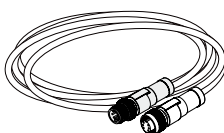

ECF605

Extension Cable (5m)

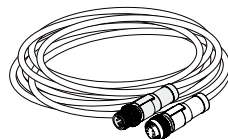

ECF610

Extension Cable (10m)

Cineroid[®]

Cinema & Broadcasting Equipment

Customer Support Center

SECULINE CO., Ltd

Tel. +82.70.4347.4901 **Fax.** +82.70.4347.4999 **E-mail.** support@secu-line.com

Rm 1105, Ace techno tower 8th, 11, Digital-ro 33-gil, Guro-gu, Seoul, Republic of Korea 08380

Made in Korea

CL800_1.0