

D) 技术参数 Specifications:

型号 Model No.	RX-18TDX III	RX-24TDX III
数量 No. of LED bulbs LED	黄 Yellow: 320pcs, 白 White: 320pcs	黄 Yellow: 440pcs, 白 White: 440pcs
功率 Power	130W	220W
色温 Color Temperature	3000K-5600K	3000K-5600K
照度 LUX (LUX)	5600K:0.5M(15900)/1M(4590)/2M(1220)	5600K:0.5M(22800)/1M(6990)/2M(1920)
电压 Voltage	AC-100V-240V	
支撑座 Lamp Base	X支架 X-Frame + 万向接头 Bracket CLD-14	
尺寸 Dimesion(L×W×H)	布灯 Light: 621×470mm 控制盒 Control Box: 210×171×105mm	布灯 Light: 621×614mm 控制盒 Control Box: 210×171×105mm
照射角度 Beam Angle	64°	66°
净重 Net Weight	布灯 Light: 1.04kg, 控制盒 Control Box: 1.52kg	布灯 Light: 1.25kg, 控制盒 Control Box: 1.6kg
配件 Accessories Included	控制盒 Control Box, X支架X-Frame + 万向接头Bracket CLD-14, 电源线 Power line	
选购配件 Optional Accessories	Light Stand 灯架	

E) 使用注意事项 Attention !

- 1.使用本产品前请仔细阅读说明书，并遵循使用说明。
- 2.接入电源电压要与灯具本身所标定的电压相符，插入电源前请确保电源开关处于关闭状态；不使用时请拔掉电源连接插头。
- 3.使用环境应保持通风干燥，注意防尘防水，远离易燃物品。
- 4.请使用柔软及干的无尘布料清洁。
- 5.请勿撞击、重压或折叠，避免硬物划伤而影响使用效果。
- 6.设备故障时切勿尝试自行拆卸维修本机，不正确的安装在重启设备后可能会烧坏设备或发生电击的危险，应联系专业的技术人员。
- 7.请根据电池座后面板标注的型号选用锂离子摄像机电池。
- 8.使用过程中请勿在灯体上放置任何物品。切勿直视、触摸灯珠，因故走开前请关闭电源。
- 9.使用结束后待设备完全冷却再放置收纳箱对应位置，置于阴凉干燥处，避免阳光直射。

1. Please read this manual before using this product and follow the instructions
2. Should be used with the appropriate voltage labeled on the product. Make sure the power is off before the power connection. Please remove the power connection if the light is not using.
3. Keep the environment dry and ventilated when using the product. Do not leave or use the product in a humid or dusty environment. And keep it away from the fire.
4. Clean this product with only a soft and dry cloth.
5. Do NOT apply pressure and drop the product.
6. Improper installation may damage the light, and there can be high voltage inside the unit. Please Do NOT open or repair the unit yourself. If there is any defect, please contact an experienced technician.
- 7.Only use the specific Li-ion camcorder batteries according to the model of the battery holder on the rear panel
- 8.Please turn off the unit if there is no one to look after.
9. Please make sure the product cools down and put it back in the case after being used. Don't store the product in a humid environment and avoid direct sunshine.



RX-TDX III 布灯系列说明书 ROLL-FLEX-SERIES Instruction Manual



RX-18TDX III



RX-24TDX III

感谢您选购锐鹰公司的产品！

如欲了解更多相关产品的信息，请联系您当地的经销商或访问我们的网页。使用产品之前，请先仔细阅读说明书。

Thank you for purchasing FalconEyes' products.

For further details of our related products, please contact your local distributor or visit our webpage at www.falconeyes.com.hk
Thank you.

Please read this manual carefully before using this product.

E-mail: info@falconeyes.com.hk

Website: www.falconeyes.com.hk



I、灯光无线控制APP Lighting Remote Control APP



DeSal Lite+



iOS

搜索“DeSal Lite+”下载安装
Search "DeSal Lite+" on APP
Store to download



Android

手机浏览器扫描二维码下载安装
Use your scan tool scan the QR code
to download

APP connected lamps APP连接灯具



打开灯具,打开手机蓝牙,打开“DESAL Lite+”app
Turn on the device, turn on Bluetooth of the phone, and open the “DESAL Lite+” app

1 导航栏选择“设备”
Select "Device" in the navigation bar

2 点击“添加设备”
click "Add Device"

3 自动扫描到可连接灯具,点击扫描到的灯具右侧 ⊕ 连接
Automatically scan devices, click on the right side of the scanned device ⊕ connect

★ 如 APP 未找到需连接的灯具,请重置灯具的蓝牙连接。
If the APP does not find the lamp to be connected, please reset the Bluetooth connection of the lamp.

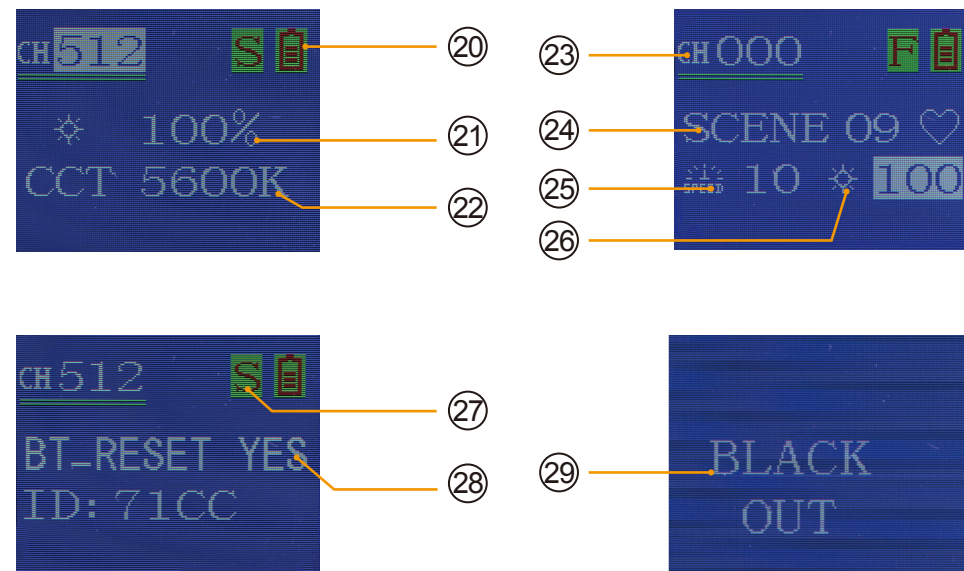

显示屏Display

- | | |
|---|--|
| 1.支撑架包角 Corner holder | 16.DC输出 DC output |
| 2.LED灯泡 LED blubs | 17.电源开关 Power switch |
| 3.X支架 X-Frame | 18.DMX输出DMX output |
| 4.灯体 Light body | 19.DMX输入DMX input |
| 5.万向接头 CLD-14 | 20.电量显示Power display |
| 6.魔术带连接 Velcro connection | 21.亮度显示 Dimming display |
| 7.升级口 Firmware | 22.色温显示 Color temperature display |
| 8.主菜单 Menu button | 23.频道显示 Channel display |
| 9.确认键 Enter button | 24.特效显示 Special Display |
| 10.显示屏 LCD Display | 25.特效速度 Special effects speed |
| 11.频道模式Channel mode | 26.特效亮度 Special effect dimming |
| 12.黑场按键 Blackout button | 27.F/S(快调/慢调)
Fast adjustment & slow adjustment F/S |
| 13.调节旋钮/ F&S切换按钮
Adjustment Knob/F&S Switch Button | 28.蓝牙复位与识别码
Bluetooth reset/ identifier |
| 14.把手 Handle | 29.黑场显示Black out display |
| 15.电源插座 Power socket | |

C) 操作说明 Operating Instructions

I、LED灯使用 LED lighting operation

1. 打开电源开关后液晶屏会显示上一次关机前所显示的界面如图1所示，按“CH”键选中频道显示，旋转“调节旋钮/ F&S切换按钮”改变灯的频道，频道可调节范围1-512。按“ENTER”确认键选中亮度显示，旋转“调节旋钮/ F&S切换按钮”改变灯的亮度，亮度可调节范围0%-100%。再按“ENTER”确认键选中色温显示，旋转“调节旋钮/ F&S切换按钮”改变灯的色温，色温可调节范围（3000K-5600K）。

2. 按“MENU”主菜单键切换到下一界面为特效模式，液晶屏显示如图2，旋转“调节旋钮/ F&S切换按钮”可切换到下一个特效场景。按一下“ENTER”确认键选中特效速度，旋转“调节旋钮/ F&S切换按钮”可调节特效速度，特效速度可调节范围0-10；再按一下“ENTER”确认键选中特效亮度，旋转“调节旋钮/ F&S切换按钮”可调节特效亮度，特效亮度可调节范围0-100。

（特效模式一共有九种场景：闪电1、闪电2、屏幕、烛光、狗仔队、频闪、远光近光灯、双闪灯、暖白呼吸、）。

3. 按“MENU”主菜单键进入蓝牙复位与识别码界面，液晶屏显示如图3，旋转“调节旋钮/ F&S切换按钮”屏幕显示“YES”即重置了蓝牙设备，重置后请在APP上点击添加设备(请参照第5、6页)。

4. 黑场模式：按“BLACKOUT”黑场按键进入黑场模式界面，液晶屏显示如图4、此时灯的所有功能暂停，再按“BLACKOUT”黑场按键恢复功能。

5. 此灯设有快速调节/慢速调节功能，按一下“调节旋钮/ F&S切换按钮”即可切换F:快速调节/S:慢速调节。

1. DMX Channel setting and Bi-Color mode:

After you turn on the light, the display will show the last display before turn off as Figure 1.

To adjust Channel:

Press “CHANNEL” button and adjust the channel by turning the adjustment knob (1-512).

To adjust Output:

Press “ENTER” button, select Dimming mode and adjust the dimming by turning the adjustment knob (0-100%)

To adjust Color temperature

Press the “ENTER” button again, select Color temperature mode and adjust the color temperature by turning the adjustment knob (3000K-5600K).

2. Special Effects Mode:

Switch to effects mode by pressing “MENU” as Figure 2.

User can switch between special effects by turning the adjustment knob.

To adjust the speed of special effects, press “ENTER” to select the speed of the special effect and adjust it by turning the adjustment knob (1-10).

To adjust the brightness of special effects, press “ENTER” again to select the dimming of the special effect and adjust the dimming by turning the adjustment knob (0-100%).

(Nine special effects which are Lightning1, Lightning2, TV Screen, Candle, Paparazzi, Double flash, Distance light, Warning light, Breathing).

3. Bluetooth reset and identifier

Press the “MENU” button to the Bluetooth reset and identifier page as Figure 3.

Twisting the knob switch to “YES” then the Bluetooth signal of the device will be reset. After that, please open the app and tap “Add the device” to search the device again. Once the device was searched by the app and reconnected, it means the Bluetooth Reset is completed. (Figure 5,6)

4. Blackout Mode

Press the “BLACKOUT” button to the Blackout page as Figure 4. All the functions will be suspended, and press the Blackout button to restore the function.

5. Users can press the adjustment knob to switch between Fast and Slow adjustment (F&S)



Figure 1



Figure 2

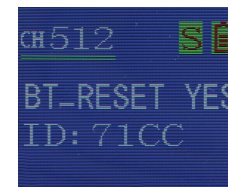

Figure 3

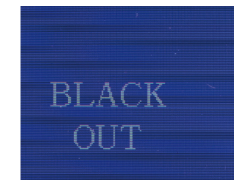

Figure 4

A) 产品概述 Product Overview

RX-18TDXⅢ、RX-24TDXⅢ是锐鹰新升级的可卷曲LED布灯，采用最新的薄片LED科技使灯板的厚度仅有10mm，灯体柔软、质高、重量轻便于携带。RX-18TDXⅢ功率为130W，RX-24TDXⅢ功率为220W，3000K-5600K可细致调节色温，适合各种细节的勾画。一体智能控制盒设计，供电调控于一体，双通道供电系统即插即用，轻松应对场地变化，灯光始终在线。支持无线DMX专业调控台控光、智能手机APP控制，实现远程控光，提高工作效率。附有9种预设场景光效，每一种光效可自由调节亮度及速率，更好的融入环境氛围，高效拍摄。

RX-18TDXⅢ and RX-24TDXⅢ are using the latest LED technology to perform roll-able and flexible movement through slim panel housing 10mm. It is handy lightweight and easy to carry around which is great to use as both outdoor & indoor light source. The RX-18TDXⅢ is 130W and RX-24TDXⅢ is 220W with bi-color setting 3000K-5600K, as well as DMX control systems, Bluetooth APP control feature and scene effect mode.

B) 功能示意图 Panel Diagram

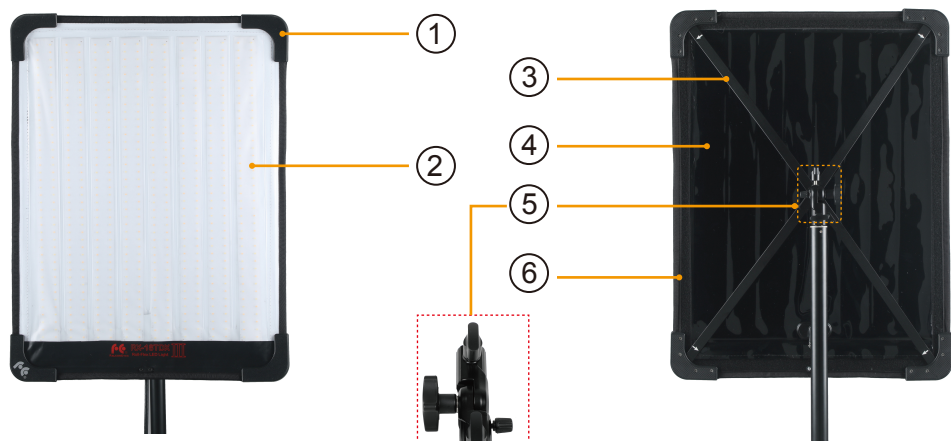

万向接头 CLD-14
Bracket CLD-14



控制盒Control unit

Brightness control 亮度控制

在“最近”、“设备”、“群组”页选择需要使用的设备或群组
Select the device or group to be used on the "Recent", "Device" and "Group" pages

- 1 导航栏选择“亮度”进入亮度控制页
Select "Brightness" in the navigation bar to enter the brightness control page
- 2 点击或滑动亮度控制条调节灯光亮度
Click or slide the brightness control bar to adjust the brightness
- 3 点击打开 / 关闭灯光
Click to turn on/off the light

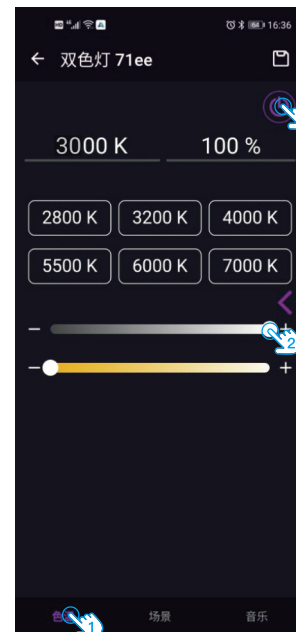

Light Scene Effect 灯光场景特效

在“最近”、“设备”、“群组”页选择需要使用的设备或群组
Select the device or group to be used on the "Recent", "Device" and "Group" pages

- 1 导航栏选择“场景”进入亮度控制页
Select "Scene" in the navigation bar to enter the brightness control page
- 2 点击或滑动亮度控制条调节灯光亮度
Click or slide the brightness control bar to adjust the brightness
- 3 点击速度控制条调节灯光变化速度
Click the speed control bar to adjust the speed of light changes
- 4 点击灯光特效
Click on lighting scene effects
- 5 点击打开 / 关闭灯光
Click to turn on/off the light

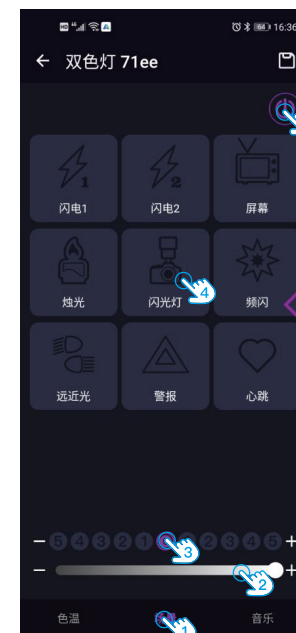

★ APP 仅能控制关闭灯光亮度，灯具电源开关需在机身控制
APP can only turn off the light, switching off the lamp will need to turn off physically on the power switch.