

# FLASHPOINT



**STUDIO-V SERIES**

**BLAZ 200V/300V MONOLIGHT** 

**BOWENS MOUNT**

**WITH 10W COB LED MODELING LAMP**

# Foreword

The **FLASHPOINT BLAZ STUDIO-V 200/300 R2 MONOLIGHT** are manual monolights designed to be compact non-TTL AC studio members of the R2 Family of wireless radio-controlled flashes. The small units deliver an impressive GN 190ft/58m (Studio-V 300) and 174ft/53m (Studio-V 200), accepting standard Bowens S-Type reflectors and modifiers. The pro-COB LED modeling light makes lighting setups easy to achieve precise results. The incredible power and control in these compact and lightweight flashes make this design the first choice of all photographers, with an eye for flexible multiple lights set up in a studio or home environment for everything from portraiture to product photography without the fear of blowing circuits. The R2 Monolight has a max recycle time of 1.8 seconds at full power and an eye-popping 0.1 seconds at 1/32<sup>nd</sup>/5.0 output, with reliability only AC can guarantee.

**R2 Wireless** is the world-famous 2.4GHz Radio system that binds the Flashpoint R2 Wireless Family in total harmony. The incorporated R2 radio links to transmitter signals up to over a 100m/328ft range with channels and individual groups. Of course, you can simply fire with a cable directly connected to the standard PC port.

Flashpoint, innovators at the cutting edge of studio and location lighting with a wide selection of flash solutions addressing every lighting challenge, now offer light supremacy even further, with the **Flashpoint BLAZ Studio-V R2 Monolights** joining The R2 Family, the new proven standard in wireless radio flash.

## Features

- Compact and lightweight AC reliability.
- Impressively consistent GN 190ft/58m output (300ws) or 174ft/53m (200ws).
- Built-in extended Flashpoint R2 2.4GHz wireless system.
- Senses and operates under 32 Channels and 16 non-TTL Groups.
- Recycles in less than 1.8s at full power and 0.1s at 1/32.
- Precise output displayed on the LCD panel.
- Wide range of 50 flash power steps from 1/32 to 1/1 (or 5.0 to 10.0).
- Optional R2 triggers control power ratio, modeling lamp, an audio tone, as well as remote flash triggering.
- Bowens Type-S mount for a flood of almost any light shaper.
- COB LEB modeling lamp adjusts in 5% to 100% power levels in 3 modes.
- Outstanding output stability, no more than 2% shifts when under the same output.
- Anti-preflash Receiver modes enable synchronization with cameras that have a one-preflash firing system using the S1 & S2 Optic Receiver Modes.
- Auto memory and recovery of previous values and settings.
- Supports Flashpoint R2, R2T-32, and R2T-16 Transmitter Units.
- Supports Legacy R1-16 Remote Manual Trigger System.
- Rich color spectrum with flash duration (t.01) of 1/800s – 1/2000s.
- Stable Color Temperature 5600±200K throughout the flash range.
- Auto Memory feature retains last use settings.
- USB Communication Port (For R2TR-16 & R2TR-16 Receivers).
- 3.5mm Sync Port for direct to camera cable link.

# Important Safety Instructions

When using your photographic equipment, basic safety precautions should always be followed, including the following:

1. Read and understand all instructions before using.
2. Close supervision is necessary when any appliance is used by or near children. Do not leave appliance unattended while in use.
3. Care must be taken as burns can occur from touching hot parts.
4. The appliance switch is provided with the symbols 0 indicating off and 1 indicating on. The symbols and may be used for this purpose.
5. Do not operate appliance with a damaged cord or if the appliance has been dropped or damaged - until it has been examined by a qualified serviceman.
6. Position the cord so that it will not be tripped over, pulled, or contact hot surfaces.
7. If an extension cord is necessary, a cord with a current rating at least equal to that of the appliance should be used. Cords rated for less amperage than the appliance may overheat.
8. Always unplug appliance from electrical outlet before cleaning and servicing and when not in use. Never yank cord to pull plug from outlet. Grasp plug and pull to disconnect.
9. Let appliance cool completely before putting away. Loop cord loosely around appliance when storing.
10. To reduce the risk of electric shock, do not immerse this appliance in water or other liquids.
11. To reduce the risk of electric shock, do not disassemble this appliance, but take it to a qualified serviceman when service or repair work is required. Incorrect reassembly can cause electric shock when the appliance is used subsequently.
12. The use of an accessory attachment not recommended by the manufacturer may cause a risk of fire, electric shock, or injury to persons.
13. Connect this appliance to a grounded outlet.
14. Disconnect this unit from its source of supply before replacing the projection lamp.

**SAVE THESE INSTRUCTIONS.**

## Warning

To prevent damage to the product or injury to you or to others, read the following warnings in their entirety before using this product. Keep these safety instructions where users can read them for ready reference.

- Do not disassemble or modify. Should the product break down, send the defective back to the authorized service center for inspection and maintenance.
- Keep dry. Do not handle with wet hands, immerse in water, or expose to rain.
- Keep out of reach of children.
- Please put the device in a ventilation environment and keep the parts of lighting and heat dissipation holes are unobstructed. Do not use in flammable environment.
- Do not touch the heating parts of this product.
- Please turn off the power and wear insulated gloves before installing and connecting accessories. When replacing the tube or modeling lamp, please make sure that the tube is cool and wear insulated gloves to prevent burns.
- Do not flash directly towards naked eyes (especially those of babies), otherwise it may lead to visual impairment.
- Disconnect from the power supply when it will not be used for an extended period.
- For continued protection against risk of fire replace only with same Type F5AL 250V fuse.
- After 30 continuous flashes at full power, the flash should be cooled down for about 3 minutes. Overheating will occur if it is used continuously without cooling down.
- Avoid sudden impacts as this can damage the flash tube and/or internal element.

# Names of Parts

## Body

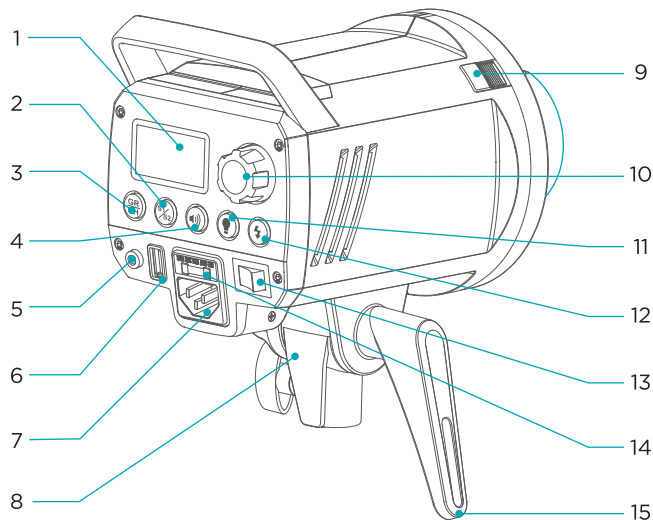

- |   |                                |
|---|--------------------------------|
| 1. LCD Display                                | 9. Accessory Locking Ring      |
| 2. <b>&lt; S1/S2 &gt;</b> Optical Mode Button | 10. SET Dial                   |
| 3. <b>&lt; GR/CH &gt;</b> Button              | 11. Modeling Lamp Button       |
| 4. BUZZ Button                                | 12. Test Button                |
| 5. Sync Cord Jack                             | 13. Power Switch               |
| 6. Wireless Control Port                      | 14. Fuse                       |
| 7. AC Power Socket                            | 15. Direction Adjusting Handle |
| 8. Mounting Bracket                           |                                |

## LCD Panel

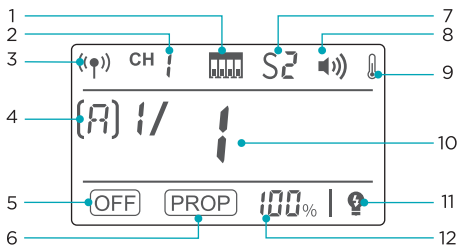

1. Built-in Wireless Channel Dial
2. Built-in Wireless Channel
3. Built-in 2.4G Wireless Transmission
4. Built-in Wireless Group
5. Modeling Lamp is off
6. Modeling Lamp is in the PROP mode
7. Optical Model Indicator
8. Beep
9. Temperature Alarm Display
10. Flash Output
11. Modeling Lamp is off when triggering the flash
12. Modeling Lamp shows the power in percentage

## Accessories

1. Power Cord
2. Lamp Cover
3. Instruction Manual

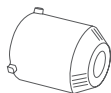

## Separately Sold Accessories

The product can be used in combination with the following accessories sold separately:

1. R2 TTL
2. R2 Pro TTL
3. R2 Pro Mark II TTL / R2 Mark II TTL remote control
4. Softbox
5. Photographic Umbrella
6. Light Stand
7. Honey Comb
8. Beauty Dish
9. Snoot, etc.



# Operations

## Flash Preparation

Attach the flash unit onto an appropriate light stand. Adjust the mounting bracket and make sure it is tightened and fixed.

## Power Connection

Use the power cord to connect the flash to an AC power source and turn on the power switch.

## Modeling Lamp

Short press the Modeling Lamp Button to change among OFF, PROP and percentage mode.

1. When **< OFF >** is displayed, the modeling light is off.
2. When **< PROP >** is displayed, the modeling light is in auto status and its power changes with the flash's power.
3. When percentage is displayed, the brightness of modeling light can be adjusted from 5% to 100%. Short press the SET Dial and then turn it to adjust the brightness, short press to exit.

When the modeling light is on, long press the Modeling Lamp Button for 2 seconds to switch on the function that the modeling is off when triggering the flash, and the LCD panel shows **< Q >**. Long press the Modeling Lamp Button again to turn off the function.

**Safety Setting:** Modeling lamp will turn off automatically after 4 hours, avoiding overheat.

## Power Output Control

SET controls power output, according to user selection. The power is adjustable freely from 1/64 to 1/1. The set power value shows on the LED Display. **"OFF"** on the display indicates that the flash triggering function is turned off. **Press the test button to discharge power when the flash output is adjusted from high to low.**

## Test Button

To fire the flash without taking a picture, press the test button. It can also help adjust the flash brightness when combined with the SET dial.

**Tip:** Long press the SET button and turn on the flash to view its version.



## Sync Triggering

The sync cord jack is a  $\Phi 3.5\text{mm}$  plug. Insert a trigger plug and the flash will be fired synchronously with the camera shutter. Simultaneously press the S1/S2 button and BUZZ button to recover factory settings.

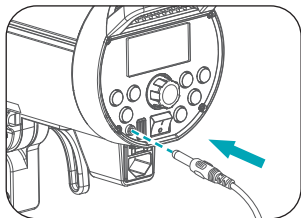

## GR/CH Button

Short press the **< GR/CH >** button can adjust the built-in wireless group. When the group indicator on the LCD panel is blinking, turn the SET dial to change. And long press the **< GR/CH >** button can adjust the built-in wireless channel. When the channel indicator on the LCD panel is blinking, turn the SET dial to change.

## Optical Trigger Receiver Modes

Three optical triggering modes are available and can be set by short pressing **< S1/S2 >** optical receiver button.

- **No Optical Control:** S1 or S2 is not displayed on the LCD panel, indicating the optical triggering function is off.
- **Optical S1 Secondary Unit Setting:** In M manual flash mode, press **< S1/S2 >** optical mode button so that this flash can function as an optic S1 secondary flash with optic sensor. With this function, the flash will fire synchronously when the main flash fires, the same effect as that by the use of radio triggers. This helps create multiple lighting effects.
- **Optical S2 Secondary Unit Setting:** Short press **< S1/S2 >** optical button so that this flash can also function as an optic S2 secondary flash with optic sensor in M manual flash mode. This is useful when cameras have pre-flash function. With this function, the flash will ignore a single **"preflash"** from the main flash and will only fire in response to the second, actual flash from the main unit.

## Buzz Function

The BUZZ button is used for deciding whether there is sound reminder for ready flash after recharging. Short press the **BUZZ** button, when the buzz indicator is on the LCD panel, the buzz function is working; when it is disappear, the buzz function is not working. A **"BI"** sound will be heard when it's fully charged.

## Key Combination

Simultaneously press the **GR/CH** button and the **S1/S2** optical button on/off the built-in wireless transmission. If there are no wireless and channel indicators displayed on the LCD panel, the built-in wireless transmission is off. Simultaneously press the **S1/S2** optical button and **BUZZ** button to recover factory settings.

## Alarm Display

Display	Content
E0	The temperature sensor is in error.
E3	The inner capacitance and voltage are too high.

**Note:** If E0 or E3 alarm occurs, sounds like BIBI and rings per 0.5 second, please send the flash to the professional maintenance point.

## Memory Function

The device is equipped with memory function for the panel setting. It will help remember the panel setting 3 seconds after you set it. When starting up the flash next time, the panel setting will be the same as that before powering it off.

## Over-Temperature Protection Function

The flash will auto off its firing function and the temperature alarm display **< 🔧 >** will be blinking when the flash's inner temperature is over high. When the flash's temperature is below 50, all the flash functions will be normal.

## Wireless Control Function

The flash unit has built-in 2.4GHz R2 wireless receiver, which can be used together with R2 and R2T flash trigger. Synchronously press the **< GR/CH >** Button and the **< S1/S2 >** Optical Button can turn on the built-in wireless transmission and the **< (📶) >** is displayed. If there are other wireless flash systems nearby, you can change the channel IDs to prevent signal interference. The channel IDs of the master unit and the Optical unit(s) must be set to the same value.

## Setting the Communication Channel

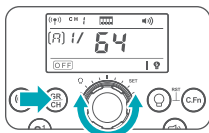

- 1** Long press the **< GR/CH >** Button for 2 seconds until the channel IDs is blinking.

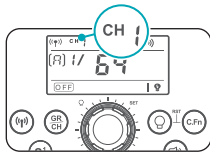

- 2** Turn the SET Dial to choose the channel from 1 to 32.

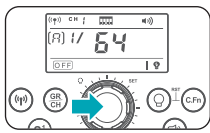

- 3** Press the **< SET >** Dial to confirm.

## Setting the Communication Group

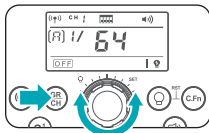

- 1** Short press the **< GR/CH >** Button for 2 seconds until the group IDs is blinking.

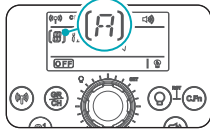

- 2** Turn the SET Dial to choose the group from 0 to F.

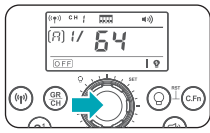

- 3** Press the **< SET >** Dial to confirm.

## External Wireless Control Function

The flash unit is built in with a Wireless Control Port so that you can wirelessly adjust the power level of the flash and the flash triggering.

To control the flash wirelessly, you need a FT-16 remote control set (on-camera and on-flash). Insert its receive end into the Wireless Control Port on the flash and insert the transmit end into the camera hot shoe. Settings made on the hotshoe-mounted transmit and receive ends will be wirelessly communicated to the flash. Then you can press the camera shutter release button to trigger the flash. You can also hold the transmit end at hand to control your off-camera flash.

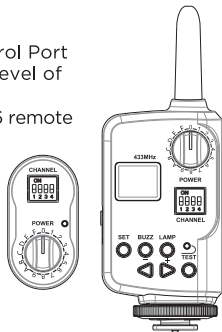

For full instructions on the use of FT series remote control, see its user manual.

## ! Troubleshooting R2 Wireless

1. Interference of the 2.4GHz R2 signal in outer environment (e.g. wireless base station, 2.4GHz wifi router, Bluetooth, etc.)
  - To adjust the channel CH setting on the flash trigger (add 10+ channels) and use the channel which is not interfering. Turn off the other 2.4GHz devices.
2. Make sure that whether the flash has finished its recycle or caught up with the continuous shooting speed (the flash ready indicator is lighten) and the flash is not under the state of over-heat protection or other abnormal situation.
  - Please lower the flash power output. If the flash is in TTL mode, please try to change it to M mode (a preflash is needed in TTL mode).
3. The distance between the flash trigger and the flash is too close or not.
  - Please turn on the "close distance wireless mode" on the flash trigger (<0.5m):  
**R2 and R2 Pro:** press the test button and hold on, then turning it on until the flash ready indicator blinks for 2 times.  
**R2 Mark II Pro:** Set the C.Fn-DIST to 0-30m.
4. The flash trigger and the receiver end equipment are in the low battery states or not.
  - Please replace the battery (the flash trigger is recommended to use 1.5V disposable alkaline battery).

## Tube Replacement

Shut down the power and remove the power cord before replacing the flash tube. Wear insulated gloves to loosen the iron wire on the tube, keep a balanced hold on the two feet of the flash tube and pull out the old tube gently. Take off the feet casing from the old tube and put it on the new one. Hold two feet of the new tube, and insert directly towards the two copper outlets, then push them slightly in. Twine the iron wire on the stainless steel sheet to fix the flash tube.

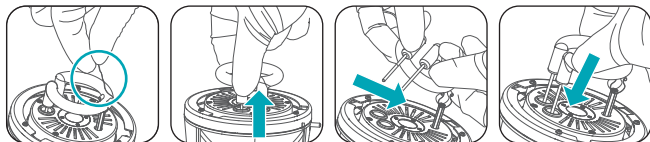

## Technical Data

Model	FPLFBL200V	FPLFBL300V
Max Power (Ws)	200Ws	300Ws
Guide Number (ISO 100) (With high effective reflector)	174ft/53m	190ft/58m
Color Temperature	5800±200K	
Operating Voltage	100-120V ~ 50/60Hz or 200-240V ~ 50/60Hz	
Modeling Lamp Level	5% ~ 100%	
Power Output Control	(OFF, 1/32 ~ 1/1)	
Modeling Lamp (W)	10W	
Triggering Method	Sync cord, Test button, Optical triggering, Wireless control port	
Flash Duration	1/2000 ~ 1/800s	
Parameters Output from the Sync Cord Jack	5V	
Parameters Output from the USB Port	5V/200mA	
Fuse	F5AL 250V	
Recycle Time	220V (0.1 ~ 1.3s) / 110V (0.1 ~ 1.8s)	
Dimension	Flash diameter Φ5in/12.6cm, height of flash with handle 6.6in/16.7cm, length of flash with lamp cover 11in/28.3cm.	
Net Weight	Approx. 2.8lb/1.3kg	Approx. 2.8lb/1.3kg

# Maintenance

- Shut down the device immediately when it works abnormally.
- Avoid sudden impacts and the lamp should be cleaned regularly.
- It is normal for the lamp to be warm when in use. Avoid continuous flashes if unnecessary.
- Maintenance of the flash must be performed by our authorized maintenance department which can provide original accessories. The flash-tube and the modeling lamp are user-replaceable. Replacement tubes and lamps can be obtained from the manufacturer.
- This product, except consumables e.g. flash tube and modeling lamp, is supported with a one-year warranty.
- Unauthorized service will void the warranty.
- If the product fails or was exposed to moisture, do not use it until it is repaired by professionals.
- Disconnect the power when cleaning the flash or when changing the flashtube / modeling lamp.
- Changes made to the specifications or designs may not be reflected in this manual.

## FCC Statement

This device complies with part 15 of the FCC Rules, Operation is subject to the following two conditions: (1) This device may not cause harmful interference, and (2) this device must accept any interference received, including interference that may cause undesired operation.

Any Changes or modifications not expressly approved by the party responsible for compliance could void the user's authority to operate the equipment.

**Note:** This equipment has been tested and found to comply with the limits for a Class B digital device, pursuant to part 15 of the FCC Rules. These limits are designed to provide reasonable protection against harmful interference in a residential installation. This equipment generates uses and can radiate radio frequency energy and, if not installed and used in accordance with the instructions, may cause harmful interference to radio communications. However, there is no guarantee that interference will not occur in a particular installation. If this equipment does cause harmful interference to radio or television reception, which can be determined by turning the equipment off and on, the user is encouraged to try to correct the interference by one or more of the following measures:

- ▶ Reorient or relocate the receiving antenna.
- ▶ Increase the separation between the equipment and receiver.
- ▶ Connect the equipment into an outlet on a circuit different from that to which the receiver is connected.
- ▶ Consult the dealer or an experienced radio/TV technician for help.

The device has been evaluated to meet general RF exposure requirement. The device can be used in portable exposure condition without restriction.

# One Year Flashpoint Limited Warranty

Flashpoint warrants to the original purchaser that your Flashpoint Blaz Studio-V 200/300 R2 Monolight shall be free from defects in material and workmanship for one (1) year from the date of purchase (or delivery as may be required in certain jurisdictions) or thirty (30) days after replacement, whichever comes later.

Flashpoint's entire liability and your exclusive remedy for any breach of warranty shall be, at Flashpoint's option, to repair or replace the hardware, provided that the hardware is returned to the point of purchase or such other place as Flashpoint may direct with a copy of the sales receipt or dated itemized receipt. Flashpoint may, at its option, replace your product, offer to provide a functionally equivalent product, or repair any product with new, refurbished, or used parts as long as such parts are in compliance with the product's technical specifications. Any replacement hardware product will be warranted for the remainder of the original warranty period or thirty (30) days, whichever is longer, or for any additional period that may be applicable in your jurisdiction. If the product has been discontinued, the warranty provider reserves the right to replace it with a model of equivalent quality and function.

This warranty does not cover problems or damage resulting from accident, abuse, misapplication, or any unauthorized repair, modification or disassembly, improper operation or maintenance, normal wear and tear, or usage not in accordance with product instructions or connection to an improper voltage supply, use of consumables, such as replacement batteries, not supplied by Flashpoint, except where such restriction is prohibited by applicable law.

Except where prohibited by applicable law, this warranty is nontransferable and is limited to the original purchaser and the country in which the product was purchased. This warranty gives you specific legal rights, and you may also have other rights, including a more extended warranty duration that may vary under local laws.

To start a warranty claim, contact the Flashpoint Customer Service Department to obtain a return merchandise authorization ("RMA") number, and return the defective product to Flashpoint, along with the RMA number and proof of purchase.

## Question about our product line? Need Product Support?

We are proud of our products and celebrate our customers.

We are with you, from product selection to everyday use.

Be secure with your purchase and reach us as you need.

 212-647-9300

 [support@flashpointlighting.com](mailto:support@flashpointlighting.com)

 Flashpoint,  
42 West 18th Street,  
New York, NY 10011

You can always contact us at [BRANDS@ADORAMA.COM](mailto:BRANDS@ADORAMA.COM) for personal technical support. Our website contains a wide range of Support and FAQ pages with valuable technical assistance.

Flashpoint is a registered trademark of ADORAMA CAMERA.

© 2022 Adorama Camera, Corp.

All Rights Reserved.

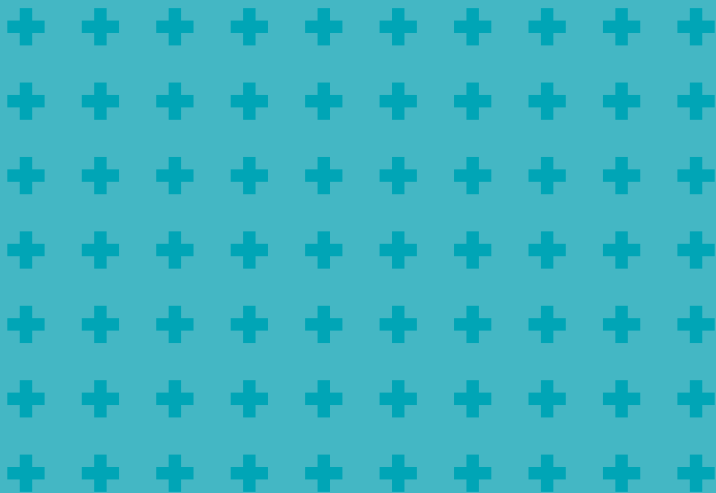

FLASHPOINTLIGHTING

**WWW.FLASHPOINTLIGHTING.COM**

Scan to follow our  
official instagram