

FLASHPOINT



FPLFIM22

iM22 MINI FLASH

Important Safety Instructions

This product is a professional photographic equipment, to be operated by professional personnel only.

All transport protective materials and packaging on the product must be removed before use.

The following basic safety precautions must be followed when using this product:

1. Carefully read and fully understand the instruction manual before use and strictly follow the safety instructions. Failure to do so may result in death, serious injury, damage to the product, or other property damage.
2. This product is a professional lighting fixture, children are prohibited from using it. Children must be closely supervised by adults when approaching the fixture, to prevent collisions with the fixture or unauthorized use that could cause personal injury.
3. This is not an ordinary lighting fixture and must not be used for general illumination. Anyone with a history of eye damage or sensitivity should avoid using this fixture or looking directly at it.

4. Extreme caution must be exercised when using it, do not touch high-temperature parts such as flash tubes to avoid burns.
5. Do not point the flash directly at the eyes (especially baby's eyes) under any circumstances, as this could impair vision in a short time. Turn off immediately if discomfort occurs, stop using, and seek medical attention promptly.
6. If the flash tube is damaged, stop using it immediately and contact the manufacturer, service agent, or qualified repair personnel for a replacement to prevent accidents.
7. Do not use damaged equipment or accessories. Allow professional repair technicians to inspect and confirm normal operation before continuing use after repairs.
8. Stop using immediately if the product shell is cracked due to falling, squeezing, or strong impact, to avoid touching the internal electronic components and getting an electric shock.

9. This device is not waterproof. Keep it dry and avoid immersing it in water or other liquids. It should be installed in a ventilated and dry location and avoid using in rainy, humid, dusty, or overheated environments. Do not place items above the device or allow liquids to flow into it to prevent danger.
10. Do not disassemble without authorization. If the product malfunctions, it must be inspected and repaired by our company or authorized repair personnel.
11. Before storing the device, ensure it has completely cooled down and the power cord is unplugged, then put it in the protective case or a ventilated dry location.
12. Do not place the device near alcohol, gasoline, or other flammable volatile solvents or gases such as methane and ethane.
13. Do not use or store this device in potentially explosive environments.
14. Do not cover the heat dissipation port!
15. Do not use accessories not been approved by our company, as this may cause fire, electric shock or personal injury.

16. Clean gently with a dry cloth. Do not use a wet cloth as it may damage the device.
17. This instruction manual is based on rigorous testing. Changes in design and specifications are subject to change without notice. Check official website for latest instruction manual and product updates.
18. Confirm and comply with all relevant local laws and regulations when handling any batteries.
19. The warranty period for this device as a whole is one year. Consumables (such as batteries), adapters, power cords, and other accessories are not covered by the warranty.
20. Unauthorized repairs will void the warranty and will incur charges.
21. Failures from improper operation is not covered under warranty.

Foreword

Thank you for choosing **FLASHPOINT!**

The **iM22 Mini Flash** redefines portable lighting solutions with its compact, palm-sized design, ensuring seamless integration into your camera without added bulk.

Designed for photographers who prioritize convenience and versatility, the **iM22** delivers top-tier performance in an incredibly lightweight form.

The **Flashpoint iM22** is your perfect partner for achieving consistent, professional lighting while maintaining portability. This manual will guide you through setting up and utilizing your new mini flash, ensuring a smooth and rewarding experience.

Names of Parts

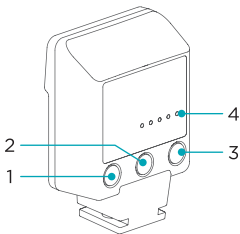

- 1. Power Switch / Test Button
- 2. Power - Button
- 3. Power + Button
- 4. Indicator

- 5. USB-C Charging Port
- 6. Hot Shoe
- 7. Flash Tube

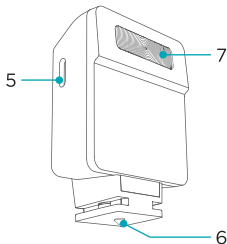

What's Inside



Flash Body



USB-C
Charging Cable



Storage Bag



Instruction
Manual

Power Switch/Test Button

Power On: Press and hold the button until the indicators turn on, the flash is switched on.

Test: After powering on, the green light blinks to indicate that the flash is recycling, which cannot be tested. After a few seconds, the green light is constant on to indicate recycle done, then press the button once to fire a testing flash.

Power Off: Press and hold the button until the indicators turn off, the flash is switched off.

Power - Button/Power + Button

Press the power - button or power + button can adjust the flash power in 5 levels. Press the power - button and power + button at the same time can check the battery level. One grid of green light means one grid of battery level, full battery level is five grids, so please charge the device in time if it only has one grid of battery level.

No Power Prompt

When the five grids of indicator flash green at the same time, it means that the device is in a state of no power, unable to flash and recycle, and will automatically shut down after 30 seconds.

Auto Power Off

The flash will shut down automatically after 1 hour of idle use.

Technical Data

Model	iM22
Built-in Lithium Battery	3.8V, 470mAh
Input	5V = 0.5A
Charging Time	≈ 1h 10min
Flash Time (at full power)	≈ 440
Recycle Time (at full power)	≈ 3s
Flash Power Steps	5
Working Environment Temperature	-10°C ~ +35°C
Sync Trigger	Hot Shoe
Dimension	2.24" x 1.57" x 0.87"
Net Weight	≈ 34g

Specifications and data may subject to changes without notice.

FCC Statement

This device complies with part 15 of the FCC Rules. Operation is subject to the following two conditions:

(1) This device may not cause harmful interference, and
(2) this device must accept any interference received, including interference that may cause undesired operation.

Any Changes or modifications not expressly approved by the party responsible for compliance could void the user's authority to operate the equipment.

Note: This equipment has been tested and found to comply with the limits for a Class B digital device, pursuant to part 15 of the FCC Rules. These limits are designed to provide reasonable protection against harmful interference in a residential installation. This equipment generates uses and can radiate radio frequency energy and, if not installed and used in accordance with the instructions, may cause harmful interference to radio communications. However, there is no guarantee that interference will not occur in a particular installation. If this equipment does cause harmful interference to radio or television reception, which can be determined by turning the equipment off and on, the user is encouraged to try to correct the interference by one or more of the following measures:

- ▶ Reorient or relocate the receiving antenna.
- ▶ Increase the separation between the equipment and receiver.
- ▶ Connect the equipment into an outlet on a circuit different from that to which the receiver is connected.
- ▶ Consult the dealer or an experienced radio / TV technician for help.

Applicable Products

Applicable Products The document applies to the products listed on the Product Maintenance Information (see below for further information). Other products or accessories (e.g. promotional items, giveaways and additional accessories attached,etc.) are not included in this warranty scope.

Warranty Period

The warranty period of products and accessories is implemented according to the relevant Product Maintenance Information. The warranty period is calculated from the day (purchase date) when the product is bought for the first time, And the purchase date is considered as the date registered on the warranty card when buying the product.

How to Get the Maintenance Service

If maintenance service is needed, you can directly contact the product distributor or authorized service institutions. You can also contact the Adorama after-sale service call and we will offer you service. When applying for maintenance service, you should provide valid warranty card. If you cannot provide valid warranty card, we may offer you maintenance service once confirmed that the product or accessory is involved in the maintenance scope, but that shall not be considered as our obligation.

Inapplicable Cases

The guarantee and service offered by this document are not applicable in the following cases:

1. The product or accessory has expired its warranty period.
2. Breakage or damage caused by inappropriate usage, maintenance or preservation, such as improper packing, improper usage, improper plugging in/out external equipment, falling off or squeezing by external force, contacting or exposing to the improper temperature, solvent, acid, base, flooding and damp environments, etc.
3. Breakage or damage caused by non-authorized institution or staff in the process of installation, maintenance, alternation, addition and detachment.
4. The original identifying information of product or accessory is modified, alternated, or removed.
5. No valid warranty card.
6. Breakage or damage caused by using illegally authorized, nonstandard or non-public released software.

7. Breakage or damage caused by force majeure or accident.
8. Breakage or damage that could not be attributed to the product itself. Once met these situations above, you should seek solutions from the related responsible parties and Adorama assumes no responsibility. The damage caused by parts, accessories and software that beyond the warranty period or scope is not included in our maintenance scope. The normal discoloration, abrasion and consumption are not the breakage within the maintenance scope.

Maintenance and Service Support Information

The warranty period and service types of products are implemented according to the following Product Maintenance Information:

Product Type	Name	Maintenance Period (month)	Warranty Service Type
Parts	Circuit board	12	Customer sends the product to designated site.
	Battery	3	Customer sends the product to designated site.
	Electrical parts e.g.battery charger, etc.	12	Customer sends the product to designated site.
Other Items	Flash tube, modeling lamp, lamp body, lamp cover, locking device, package, etc.	No	Without warranty

One Year Flashpoint Limited Warranty

Flashpoint warrants to the original purchaser that your Flashpoint product shall be free from defects in material and workmanship for the period of one (1) years from the date of purchase (or delivery as may be required in certain jurisdictions), or thirty (30) days after replacement, whichever comes later.

Flashpoint's entire liability and your exclusive remedy for any breach of warranty shall be, at Flashpoint's option, to repair or replace the hardware, provided that the hardware is returned to the point of purchase or such other place as Flashpoint may direct with a copy of the sales receipt or dated itemized receipt. Flashpoint may, at its option, replace your product, offer to provide a functionally equivalent product, or repair any product with new, refurbished or used parts as long as such parts are in compliance with the product's technical specifications. Any replacement hardware product will be warranted for the remainder of the original warranty period or thirty (30) days, whichever is longer, or for any additional period of time that may be applicable in your jurisdiction. If the product has been discontinued, the warranty provider reserves the right to replace it with a model of equivalent quality and function.

This warranty does not cover problems or damage resulting from accident, abuse, misapplication, or any unauthorized repair, modification or disassembly, improper operation or maintenance, normal wear and tear, or usage not in accordance with product instructions or connection to improper voltage supply, use of consumables, such as replacement batteries, not supplied by Flashpoint, except where such restriction is prohibited by applicable law. Except where prohibited by applicable law, this warranty is nontransferable and is limited to the original purchaser and the country in which the product was purchased. This warranty gives you specific legal rights, and you may also have other rights, including a longer warranty duration that may vary under local laws. To start a warranty claim contact the Flashpoint Customer Service Department to obtain a return merchandise authorization ("RMA") number, and return the defective product to Flashpoint, along with the RMA number and proof of purchase.

Question about our product line? Need Product Support?

We are proud of our products and celebrate our customers. We are with you, from product selection to everyday use. Be secure with your purchase and reach us as you need.

 212-647-9300

 support@flashpointlighting.com

 Flashpoint,
42 West 18th Street,
New York, NY 10011

You can always contact us at BRANDS@ADORAMA.COM for personal technical support. Our website contains a wide range of Support and FAQ pages with valuable technical assistance.

Flashpoint is a registered trademark of ADORAMA CAMERA.

© 2024 Adorama Camera, Corp.

All Rights Reserved.



WWW.FLASHPOINTLIGHTING.COM

Scan to join our Instagram community
for product tips, Inspirations, and more.