

FLASHPOINT



STUDIO II SERIES 300IIV/400IIV MONOLIGHT

WITH BUILT-IN R2 2.4GHz RADIO REMOTE
SYSTEM AND COB LED MODELING LAMP

Foreword

The new **Flashpoint Studio400 II V and Studio300 II V R2** are manual, non-TTL 400, and 300-watt second monolights. Compact AC studio members of the R2 Family of wireless radio-controlled flashes. The small units deliver GN 2568ft / 65m (Studio400 II-V 300) and 228ft / 58m (Studio300 II-V 300), with standard Bowens reflectors and modifiers. Add the pro 10W COB LED modeling light feature, complete the picture. The incredible power and control of these compact and lightweight units make this design the first choice of all photographers, with an eye for flexible multiple lights set up in a studio or home environment. You can use many of them on household circuits without blowing fuses. And the same R2 Wireless Remotes that command the enormous Flashpoint R2 Family of Flash work in total harmony with the Studio Series. The Studio 400II-V and 300II-V R2 have a max recycle times of 1.5 seconds and reliability that only AC mains can guarantee. And in these impressive Studio models, the professional specs don't end with power and speed. Exacting digital details with a complete Power, Sync, Channel, and Group menu clearly displayed on the rear graphical LCD panel. The onboard Manual controls are in a Tenth (0.1) of a stop increment. Throughout the 4-stop range, color and flash duration is spot on. The incorporated R2 radio receiver links to transmitter signals up to over a 100m/328ft range with 32 channels and 16 individual groups. Of course, you can confidently fire connected to the standard PC port. AC power means there is no limit on modeling lamp use, with an adjustable 5-100% bright and cool COB LED lamp. The replaceable flashtubes are surrounded by the standard Bowens S-Type 60-degree high-efficiency reflector.

R2 Wireless is the world-famous 2.4GHz Radio system that binds the Flashpoint R2 Wireless Family in total harmony. The incorporated R2 radio links to transmitter signals up to over a 100m/328ft range with channels and individual groups. Of course, you can fire with a cable directly connected to the standard PC port.

Flashpoint, innovators at the cutting edge of studio and location lighting with a wide selection of flash solutions addressing every lighting challenge, now offer light supremacy even further, with the **Flashpoint Studio300 and 400 II-V R2 Monolights** joining The R2 Family, the new proven standard in wireless radio flash. We bring the R2 ease of control to the studio-based photography world.

Contents

- 1 Foreword
- 3 Features
- 4 Warning
- 5 Name of Parts
 - Body
- 6 LCD Panel
 - Accessories
 - Separately Sold Accessories
- 7 Operations
 - Flash Preparation
 - Power Connection
 - Modeling Lamp
 - Power Output Control
- 8 Test Button
 - Sync Triggering
 - < **GR/CH** > Group/Channel Button
 - Optical Trigger Receiver Modes
- 9 Buzz Function
 - Key Combination
 - Alarm Display
 - Memory Function
- 10 Wireless Control Function
 - Setting the Communication Channel
 - Setting the Communication Group
- 11 Tube Replacement
- 12 Technical Data
- 13 Maintenance
 - FCC Statement
- 14 Flashpoint Limited Warranty

Features

- Compact and lightweight AC reliability.
- Impressively consistent GN 2568ft/65m output (400ws) or 228ft/58m (300ws).
- Built-in extended Flashpoint R2 2.4GHz wireless system.
- Senses and operates under 32 Channels and 16 non-TTL Groups.
- Recycles in less than 1.5s at full power and 0.1s at 1/32.
- Precise output displayed on the LCD panel.
- Wide range of 50 flash power steps from 1/32 to 1/1 (or 5.0 to 10.0).
- Optional R2 triggers control power ratio, modeling lamp, an audio tone, as well as remote flash triggering.
- Bowens Type-S mount for a flood of almost any light shaper.
- COB LEB modeling lamp adjusts in 5% to 100% power levels in 3 modes.
- Outstanding output stability, no more than 2% shifts when under the same output.
- Anti-preflash Receiver modes enable synchronization with cameras that have a one-preflash firing system using the S1 & S2 Optic Receiver Modes.
- Auto memory and recovery of previous values and settings
- Supports Flashpoint R2, R2T-32, and R2T-16 Transmitter Units.
- Supports Legacy R1-16 Remote Manual Trigger System.
- Rich color spectrum with flash duration (t.01) of 1/800s – 1/2000s.
- Stable Color Temperature 5600±200K throughout the flash range.
- Auto Memory feature retains last use settings.
- USB Communication Port (For R2TR-16 & R2TR-16 Receivers).
- 3.5mm Sync Port for direct to camera cable link.

Warning

To prevent damage to the product or injury to you or to others, read the following warnings in their entirety before using this product. Keep these safety instructions where users can read them for ready reference.

- Do not disassemble or modify. Should the product break down, send the defective back to the authorized service center for inspection and maintenance.
- Keep dry. Do not handle with wet hands, immerse in water, or expose to rain.
- Keep out of reach of children.
- Please put the device in a ventilation environment and keep the parts of lighting and heat dissipation holes are unobstructed. Do not use in flammable environment.
- Do not touch the heating parts of this product.
- Please turn off the power and wear insulated gloves before installing and connecting accessories. When replacing the tube or modeling lamp, please make sure that the tube is cool and wear insulated gloves to prevent burns.
- Do not flash directly towards naked eyes (especially those of babies), otherwise it may lead to visual impairment.
- Disconnect from the power supply when it will not be used for an extended period.
- For continued protection against risk of fire replace only with same Type F8AL 250V fuse.
- After 30 continuous flashes at full power, the flash should be cooled down for about 3 minutes. Overheating will occur if it is used continuously without cooling down.
- Avoid sudden impacts as this can damage the flash tube or internal elements.

 Do not touch the area around this symbol.

Names of Parts

Body

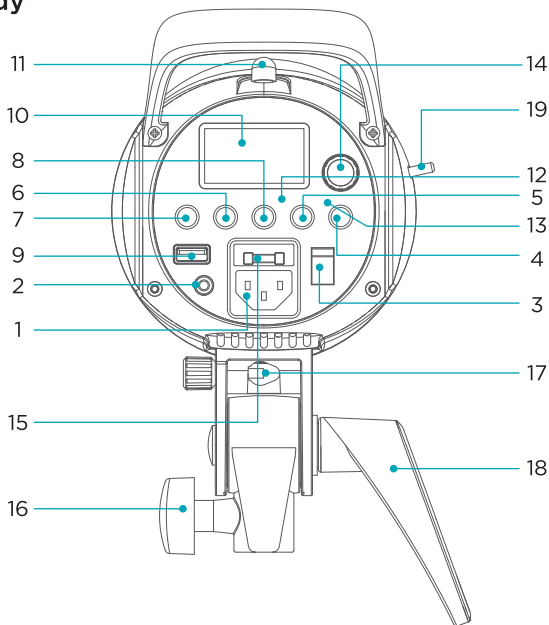

- | | |
|-------------------------------------|--------------------------------|
| 1. AC Power Socket | 11. Light Sensor |
| 2. Sync Cord Jack | 12. Modeling Lamp Indicator |
| 3. Power Switch Button | 13. Test Indicator |
| 4. Test Button | 14. SET Dial |
| 5. < MOD/OFF > Modeling Lamp Button | 15. Fuse |
| 6. < S1/S2 > Optical Model Button | 16. Mounting Bracket |
| 7. < GR/CH > Group/Channel Button | 17. Umbrella Input |
| 8. BUZZ Button | 18. Direction Adjusting Handle |
| 9. Wireless Control Port | 19. Modifier Lock Lever |
| 10. LCD Display | |

LCD Panel

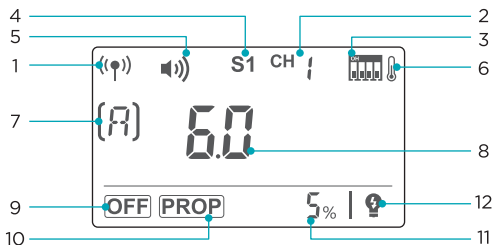

1. Built-in 2.4G Wireless Transmission
2. Built-in Wireless Channel
3. Built-in Wireless Channel Dial
4. Optical Model Indicator
5. Beep
6. Temperature Alarm Display
7. Built-in Wireless Group
8. Flash Output
9. Modeling Lamp is Off
10. Modeling Lamp is in the PROP Mode
11. Modeling Lamp Shows the Power in Percentage
12. Modeling Lamp is Off When Triggering the Flash

Accessories

1. Power Cord
2. Lamp Cover
3. Instruction Manual

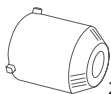
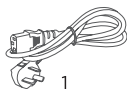

Separately Sold Accessories

The product can be used in combination with the following accessories sold separately:

1. R2 TTL
2. R2 Pro TTL
3. R2 MarkII Pro
4. XT16 or FT-16 remote control
5. Power Inverter
6. Softbox
7. Photographic Umbrella
8. Barndoor
9. Snoot, etc.



1



2



3



4



5



6



7



8



9



Operations

Flash Preparation

Attach the flash unit onto an appropriate light stand. Adjust the mounting bracket and make sure it is tightened and fixed.

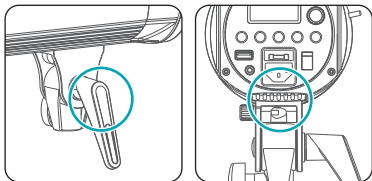

Power Connection

Use the power cord to connect the flash to an AC power source and press the power switch button to power on and off.

Modeling Lamp

Short press the **< MOD/OFF >** Button to change among OFF, PROP and percentage mode.

1. When **< OFF >** is displayed, the modeling light is off.
2. When **< PROP >** is displayed, the modeling light is in auto status and its power changes with the flash's power.
3. When percentage is displayed, the brightness of modeling light can be adjusted from 5% to 100%. Short press the SET Dial and the percentage value is blinking, turn the SET Dial to adjust the brightness and short press to exit.

When the modeling light is on, long press the **< MOD/OFF >** Button for 2 seconds to switch on the function that the modeling is off when triggering the flash, and the LCD panel shows **< ? >**. Long press the **< MOD/OFF >** Button again to turn off the function.

Safety Setting: Modeling lamp will turn off automatically after 4 hours, avoiding overheat.

Power Output Control

SET controls the power output, according to user selection. The power is adjustable from 1/16 to 1/1. The set power shows on the LCD display. **"--"** on the display indicates that the flash triggering function is turned off. **Press the Test button to discharge power when the flash output is adjusted from high to low.**

Test Button

To fire the flash without taking a picture, press the test button. It can also help adjust the flash brightness when combined with the select dial.

Tip: Press the SET dial and turn on the flash to view its version.

Sync Triggering

The sync cord jack (2) is a $\Phi 3.5\text{mm}$ plug. Insert a trigger plug and the flash will be fired synchronously with the camera shutter.

<GR/CH> Group/Channel Button

Short press the < GR/CH > Group/Channel Button can adjust the built-in wireless group. When the group indicator on the LCD panel is blinking, turn the SET dial to change. And long press the < GR/CH > Group/Channel Button can adjust the built-in wireless channel. When the channel indicator on the LCD panel is blinking, turn the SET dial to change.

Optical Trigger Receiver Modes

Three optical triggering models are available and can be set by pressing the receiver button.

- **No Optical Control:** S1 or S2 is not displayed on the LCD panel, indicating the optical triggering function is off.
- **Optical S1 Secondary Unit Setting:** In M manual flash mode, press < S1/S2 > optical button so that this flash can function as an optic S1 secondary flash with optic sensor. With this function, the flash will fire synchronously when the main flash fires, the same effect as that by the use of radio triggers. This helps create multiple lighting effects.
- **Optical S2 Secondary Unit Setting:** Press < S1/S2 > optical button so that this flash can also function as an optic S2 secondary flash with optic sensor in M manual flash mode. This is useful when cameras have pre-flash function. With this function, the flash will ignore a single "preflash" from the main flash and will only fire in response to the second, actual flash from the main unit.

Buzz Function

The sound button is used for deciding whether there is sound reminder for ready flash after recharging. Short press the **BUZZ** button, when the buzz indicator is on the LCD panel, the buzz function is working; when it is disappear, the buzz function is not working. A **"BI"** sound will be heard when it's fully charged.

Key Combination

Simultaneously press the **< GR/CH >** group/channel button and the **< S1/S2 >** optical button to turn on/off the built-in wireless R2 receiver. If there are no wireless and channel indicators displayed on the LCD panel, the built-in wireless R2 receiver is off. Simultaneously press the **< S1/S2 >** optical button and **BUZZ** button to recover factory settings.

Alarm Display

Display	Warning
E0	The temperature sensor is not connected.
E1	When charging, the capacitance and voltage are not rising within 1 second.
E2	An internal component is over the acceptable temperature.
E3	Discharged capacitance and voltage > rating +10%

Alarm sounds, BIBI, ringing per 0.5 second. Press SET dial to stop alarming.

Memory Function

The device is equipped with memory function for the panel setting. It will help remember the panel setting 3 seconds after you set it. When starting up the flash next time, the panel setting will be the same as that before powering it off.

Wireless Control Function

The flash unit has built-in 2.4GHz wireless R2 receiver, which can be used together with R2 and older RT32 flash triggers. Simultaneously press the **< GR/CH >** group/channel button and the **< S1/S2 >** optical button turns on the built-in wireless the **< (P) >** is displayed. If there are other wireless flash systems nearby, you can change the channel IDs to prevent signal interference. The channel IDs of the transmitter unit and the receiver unit(s) must be set to the same.

Setting the Communication Channel

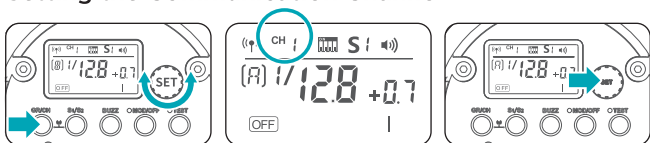

- 1 Long press the **< GR/CH >** group / channel button for 2 seconds until the channel IDs is blinking.
- 2 Turn the SET Dial to choose the channel from 1 to 32.
- 3 Press the **< SET >** Dial to confirm.

Setting the Communication Group

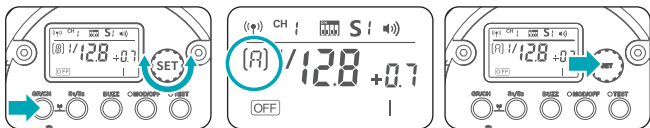

- 1 Short press the **< GR/CH >** group / channel button for 2 seconds until the group IDs is blinking.
- 2 Turn the SET Dial to choose the group from 0 to F.
- 3 Press the **< SET >** Dial to confirm.

The flash unit is built in with a Wireless Control Port so that you can wirelessly adjust the power level of the flash and the flash triggering.

To control the flash wirelessly, you need a FT-16 remote control set (on-camera and on-flash). Insert its receive end into the Wireless Control Port on the flash and insert the transmit end into the camera hot shoe. Settings made on the hotshoe-mounted transmit and receive ends will be wirelessly communicated to the flash. Then you can press the camera shutter release button to trigger the flash. You can also hold the transmit end at hand to control your off-camera flash.

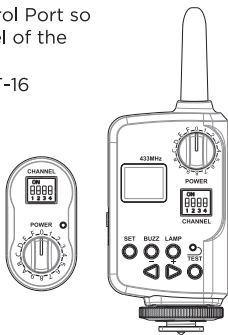

For full instructions on the use of FT series remote control, see its user manual.

Tube Replacement

Shut down the power and remove the power cord before replacing the flash tube. Wear insulated gloves to loosen the iron wire on the tube, keep a balanced hold on the two feet of the flash tube and pull out the old tube gently. Take off the feet casing from the old tube and put it on the new one. Hold two feet of the new tube, and insert directly towards the two copper outlets, then push them slightly in. Twine the iron wire on the stainless steel sheet to fix the flash tube.

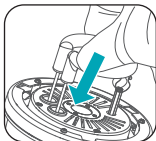
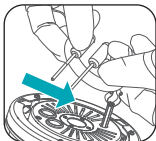
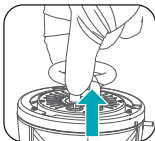
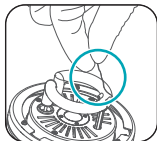

Technical Data

Model	FPLFS300IIV	FPLFS400IIV
Max Power (Ws)	300Ws	400Ws
Guide Number (ISO 100)	228ft/58m	256ft/65m
Operating Voltage	AC100V-120V ~ 60Hz or AC220V-240V ~ 50Hz	
Power Output Control	OFF, 6.0 ~ 10.0 (1/16 ~ 1/1)	
Modeling Lamp Power (W)	10W	
Modeling Lamp Level	5% ~ 100%	
LED Modeling Lamp CCT	5700±200K	
Recycle Time	0.1 ~ 1.5s	
Triggering Method	Sync cord, Optical triggering, Test button, Wireless control port	
Flash Duration	1/2000 ~ 1/800s	
Parameters Output from the Sync Cord Jack	5V	
Parameters Output from the USB Port	5V/200mA	
Fuse	AC220V-240V ~ 50Hz: 5A AC100V-120V ~ 60Hz: 8A	
Dimension	Flash diameter Φ5.4in/13.7cm, Height of flash with handle 8.1in/20.6cm. Length of flash with lamp cover 13.8in/35cm.	Flash diameter Φ5.4in/13.7cm, Height of flash with handle 9.1in/23.2cm. Length of flash with lamp cover 15.4in/39cm.
Net Weight	Approx. 4.4lb/2.0kg	Approx. 4.6lb/2.1kg

Maintenance

- Shut down the device immediately when it works abnormally.
- Avoid sudden impacts and the lamp should be cleaned regularly.
- It is normal for the lamp to be warm when in use. Avoid continuous flashes if unnecessary.
- Maintenance of the flash must be performed by our authorized maintenance department which can provide original accessories. The flash-tube and the modeling lamp are user-replaceable. Replacement tubes and lamps can be obtained from the manufacturer.
- This product, except consumables e.g. flash tube and modeling lamp, is supported with a one-year warranty.
- Unauthorized service will void the warranty.
- If the product fails or was exposed to moisture, do not use it until it is repaired by professional.
- Disconnect the power when cleaning the flash or when changing the flashtube / modeling lamp.
- Changes made to the specifications or designs may not be reflected in this manual.

FCC Statement

This device complies with part 15 of the FCC Rules, Operation is subject to the following two conditions: (1) This device may not cause harmful interference, and (2) this device must accept any interference received, including interference that may cause undesired operation.

Any Changes or modifications not expressly approved by the party responsible for compliance could void the user's authority to operate the equipment.

Note: This equipment has been tested and found to comply with the limits for a Class B digital device, pursuant to part 15 of the FCC Rules. These limits are designed to provide reasonable protection against harmful interference in a residential installation. This equipment generates uses and can radiate radio frequency energy and, if not installed and used in accordance with the instructions, may cause harmful interference to radio communications. However, there is no guarantee that interference will not occur in a particular installation. If this equipment does cause harmful interference to radio or television reception, which can be determined by turning the equipment off and on, the user is encouraged to try to correct the interference by one or more of the following measures:

- ▶ Reorient or relocate the receiving antenna.
- ▶ Increase the separation between the equipment and receiver.
- ▶ Connect the equipment into an outlet on a circuit different from that to which the receiver is connected.
- ▶ Consult the dealer or an experienced radio/TV technician for help.

The device has been evaluated to meet general RF exposure requirement. The device can be used in portable exposure condition without restriction.

One Year Flashpoint Limited Warranty

Flashpoint warrants to the original purchaser that your Flashpoint Blaz Studio-V 200/300 R2 Monolight shall be free from defects in material and workmanship for one (1) year from the date of purchase (or delivery as may be required in certain jurisdictions) or thirty (30) days after replacement, whichever comes later.

Flashpoint's entire liability and your exclusive remedy for any breach of warranty shall be, at Flashpoint's option, to repair or replace the hardware, provided that the hardware is returned to the point of purchase or such other place as Flashpoint may direct with a copy of the sales receipt or dated itemized receipt. Flashpoint may, at its option, replace your product, offer to provide a functionally equivalent product, or repair any product with new, refurbished, or used parts as long as such parts are in compliance with the product's technical specifications. Any replacement hardware product will be warranted for the remainder of the original warranty period or thirty (30) days, whichever is longer, or for any additional period that may be applicable in your jurisdiction. If the product has been discontinued, the warranty provider reserves the right to replace it with a model of equivalent quality and function.

This warranty does not cover problems or damage resulting from accident, abuse, misapplication, or any unauthorized repair, modification or disassembly, improper operation or maintenance, normal wear and tear, or usage not in accordance with product instructions or connection to an improper voltage supply, use of consumables, such as replacement batteries, not supplied by Flashpoint, except where such restriction is prohibited by applicable law.

Except where prohibited by applicable law, this warranty is nontransferable and is limited to the original purchaser and the country in which the product was purchased. This warranty gives you specific legal rights, and you may also have other rights, including a more extended warranty duration that may vary under local laws.

To start a warranty claim, contact the Flashpoint Customer Service Department to obtain a return merchandise authorization ("RMA") number, and return the defective product to Flashpoint, along with the RMA number and proof of purchase.

Question about our product line? Need Product Support?

We are proud of our products and celebrate our customers.

We are with you, from product selection to everyday use.

Be secure with your purchase and reach us as you need.

 212-647-9300

 support@flashpointlighting.com

 Flashpoint,
42 West 18th Street,
New York, NY 10011

You can always contact us at BRANDS@ADORAMA.COM for personal technical support. Our website contains a wide range of Support and FAQ pages with valuable technical assistance.

Flashpoint is a registered trademark of ADORAMA CAMERA.

© 2022 Adorama Camera, Corp.

All Rights Reserved.

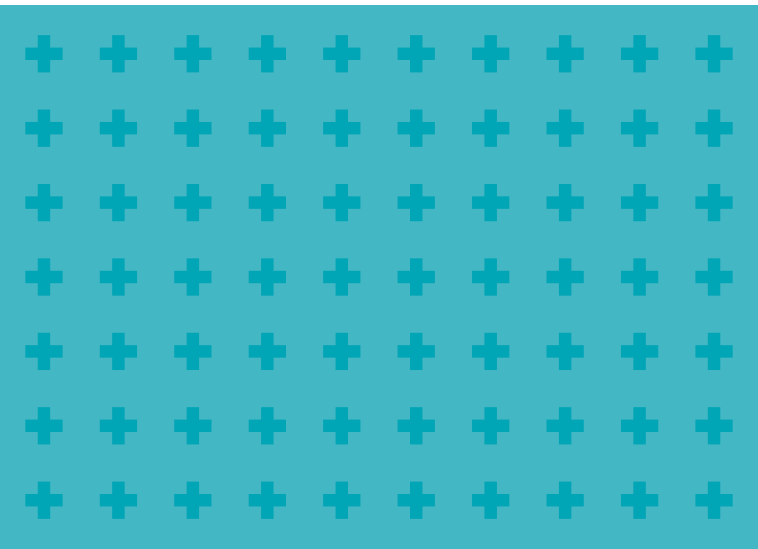

FLASHPOINTLIGHTING

Scan to follow our
official instagram

WWW.FLASHPOINTLIGHTING.COM