

FLASHPOINT



FPLFSP400III/FPLFSP600III/FPLFSP800III/FPLFSP1KIII

STUDIO PRO 400/600/800/1000III
V MONOLIGHT 

BOWENS MOUNT WITH BUILT-IN R2 & 30W LED

Foreword

Thanks for choosing Studio Pro series studio flash.

Studio Pro series studio flash provides a functional and durable lighting solution for studio and workshop shooting. It is equipped with a wireless control port so that an optional remote power control and flash triggering system is available. With a solid build, it adopts Bowens-style mount to add various studio light shaping accessories. The flash performs excellently in portrait and product shooting, wedding photography, advertising and fashion commercial photography. The Studio Pro series flash offers:

Main Features

- Built-in Flashpoint 2.4Ghz R2 radio system.
- 1/2000 to 1/800 second short flash duration and fast recycling with 30W modeling lamp.
- Wireless control of the flash power ratio (needed a receiver), modeling lamp and buzzer, as well as flash triggering.
- Anti-preflash function, enabling synchronization with cameras having a one-pre-flash firing system.
- Precise output control, 61 steps from 1/64-1/1.
- 30W modeling lamp with adjustable light brightness.
- Compatible Bowens mount adds various accessories to give multiple lighting effects.
- Adjusted settings are remembered after 3 seconds and recovered after a restart.

Caution

- After 50 continuous flashes at full power, the flash should be cooled down before usage. Overheating will occur if it is used continuously without cooling down.
- Do not keep using the modeling lamp for a long time; otherwise flammable accessories attaching to flash head, e.g. softbox will get burnt. A 10-minute time is recommended in this case. After 10 minutes, cool it down before usage.
- When using a snoot, do not keep the modeling lamp on for a long time or fire too frequently (not over six times for one minute). Overheating will result in damages for strobe housing and/or studio light.
- Avoid sudden impacts as this can damage the flash tube and/or modeling lamp.
- The luminaire is intended for professional use only.
- The lamp shall be changed if it has become damaged or thermally deformed.
- Shields shall be changed if they have become visibly damaged to such an extent that their effectiveness is impaired, for example by cracks or deep scratches.

Warning

To prevent damage to the product or injury to you or to others, read the following warnings in their entirety before using this product. Keep these Warning where users can read them for ready reference.

- Do not disassemble or modify. Should the product break down, send the defective back to the authorized service center for inspection and maintenance.
- Keep dry. Do not handle with wet hands, immerse in water, or expose to rain.
- Keep out of reach of children.
- Please put the device in a ventilation environment and keep the parts of lighting and heat dissipation holes are unobstructed. Do not use in flammable environment.
- As this product adopts make and break device, please keep it easy to be used.
- No touching the heating parts of this product.
- Please turn off the power and wear insulated gloves before installing and connecting accessories. When replacing the tube or modeling lamp, please make sure that the tube is cool and wear insulated gloves to prevent burns. Do not flash directly towards naked eyes (especially those of babies), otherwise it may lead to visual impairment.
- Disconnect from the power supply when it will not be used for an extended period.
- The equipment shall connect to a socket-outlet with earthing connection.

 **CAUTION:** Hot parts! Do not touch the inside of the flash head and the silver metal part of the product head when the Modeling light and flash are working. When replacing the flash accessory, please turn off the flash first to cold cut.

Names of Parts

Body

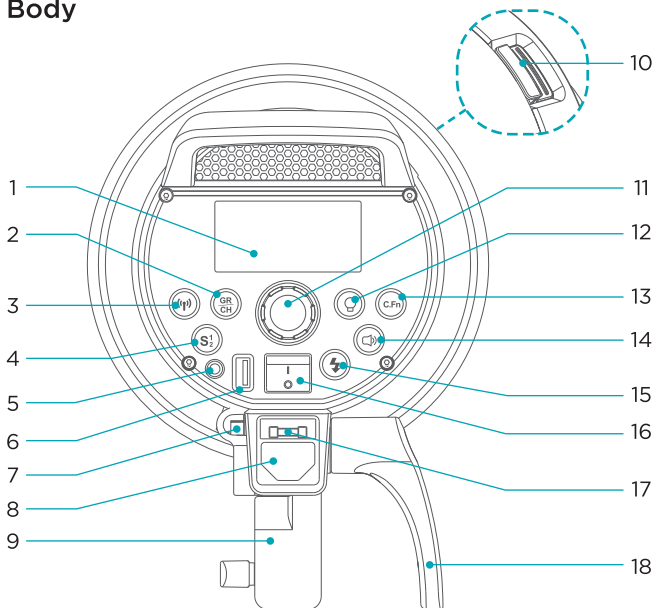

- | | |
|-------------------------------|--------------------------------|
| 1. LCD Display | 10. Locking Pusher |
| 2. GR/CH Button | 11. SET Dial |
| 3. Wireless Button | 12. Modeling Lamp Button |
| 4. S1/S2 Receiver Mode Button | 13. C.Fn Custom Button |
| 5. Sync Cord Jack | 14. Beep Button |
| 6. Wireless Control Port | 15. Test Button |
| 7. Umbrella Input | 16. Power Switch |
| 8. AC Power Socket | 17. Fuse |
| 9. Mounting Bracket | 18. Direction Adjusting Handle |

LCD Panel

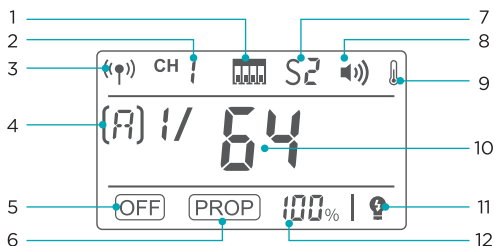

- | | |
|--|--|
| 1. Built-in Wireless Channel Dial | 8. Beep |
| 2. Built-in Wireless Channel | 9. Temperature Alarm Display |
| 3. Built-in 2.4G Wireless Transmission | 10. Flash Output |
| 4. Built-in Wireless Group | 11. Modeling Lamp is off when triggering the flash |
| 5. Modeling Lamp is off | 12. Modeling Lamp shows the power in percentage |
| 6. Modeling Lamp is in the DROP mode | |
| 7. Receiver Model Indicator | |

Accessories

1. Power Cord
2. Lamp Cover
3. Instruction Manual

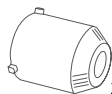

Separately sold accessories

The product can be used in combination with the following accessories sold separately, so as to achieve best photography effects:

- | | | |
|---------------|--------------------------|----------------|
| 1. R2 Radios | 4. Softbox | 7. Honey comb |
| 2. R2 mark II | 5. Photographic Umbrella | 8. Beauty Dish |
| 3. R2 PRO | 6. Light Stand | 9. Snoot, etc. |

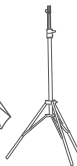

Operations

Flash Preparation

Attach the flash unit onto an appropriate light stand. Adjust the mounting bracket for a good angle and make sure it is tightened and fixed. Use the direction adjusting handle to adjust the flash to a desired direction. Umbrella input is for different photo umbrellas to put in.

Power Connection

Use the power cord to connect the flash to an AC power source and turn on the power switch.

Modeling Lamp

Short press the Modeling Lamp Button to change among OFF, PROP and percentage mode.

1. When **< OFF >** is displayed, the modeling light is off.
2. When **< PROP >** is displayed, the modeling light is in auto status and its power changes with the flash's power.
3. When percentage is displayed, the brightness of modeling light can be adjusted from 5% to 100%. Short press the SET Dial and then turn it to adjust the brightness, short press to exit.

When the modeling light is on, long press the Modeling Lamp Button for 2 seconds to switch on the function that the modeling is off when triggering the flash, and the LCD panel shows **< 🔦 >**. Long press the Modeling Lamp Button again to turn off the function.

Safety Setting: Modeling lamp will be off automatically after lighting for 4 hours, avoiding overheat due to long-time lighting when the user is not nearby.



When there is flammable accessory on the flash unit, do not keep the modeling lamp on for a long time. It is recommended to cool it down for one minute after 10 minutes' working.

Power Output Control

SET controls the power output, according to user selection. The power is adjustable from 1/16 to 1/1. The set power shows on the LCD display. "--" on the display indicates that the flash triggering function is turned off. **Press the Test button to discharge power when the flash output is adjusted from high to low.**

Test Button

To fire the flash without taking a picture, press the test button. It can also help adjust the flash brightness when combined with the SET dial.

Tip: Long press the SET dial and turn on the flash to view its version.

Sync Triggering

The sync cord jack is a $\Phi 3.5\text{mm}$ plug. Insert a trigger plug here and the flash will be fired synchronously with the camera shutter. Synchronously press the **S1/S2** button and **BUZZ** button to recover factory settings.

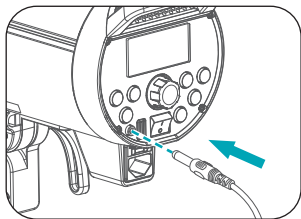

GR/CH Button

Short press the **GR/CH** button can adjust the built-in wireless group. When the group indicator on the LCD panel is blinking, turn the SET dial to change. And long press the **GR/CH** button can adjust the built-in wireless channel. When the channel indicator on the LCD panel is blinking, turn the **SET** dial to change.

Receiver Trigger Mode

Three receiver triggering modes are available and can be set by pressing < S1/S2 > receiver model button.

- **No Optical Control:** S1 or S2 is not displayed on the LCD panel, indicating the receiver triggering function is shut down.
- **Optical S1 Secondary Unit Setting:** In M manual flash mode, press < S1/S2 > receiver mode button so that this flash can function as an optic S1 secondary flash with optic sensor. With this function, the flash will fire synchronously when the main flash fires, the same effect as that by the use of radio triggers. This helps create multiple lighting effects.
- **Optical S2 Secondary Unit Setting:** Press < S1/S2 > receiver mode button so that this flash can also function as an optic S2 secondary flash with optic sensor in M manual flash mode. This is useful when cameras have pre-flash function. With this function, the flash will ignore a single "preflash" from the main flash and will only fire in response to the second, actual flash from the main unit.

Buzz Function

The BUZZ button is used for deciding whether there is sound reminder for ready flash after recharging. Short press the BUZZ button, when the buzz indicator is on the LCD panel, the buzz function is working; when it disappears, the buzz function is not working. A "BI" sound will be heard when it's fully charged.

Wireless Button

Press the < (W) > Button can turn on/off the built-in wireless transmission. If there are no wireless and channel indicators displayed on the LCD panel, the built-in wireless transmission is off. On the contrary, the built-in wireless transmission is on. When turning the flash on, press the BUZZ button and S1/S2 receiver mode button simultaneously, and factory setting can be restored.

C.Fn

F1	Wireless ID setting	Set it to OF or choose any figure from 01 to 99. When setting to OF, wireless ID will be turned off. And 01 to 99 means the wireless ID is turned on.
F2	Flash power display	It can be displayed in 1/P or P.P.

Alarm Display

E0	The temperature sensor is not connected.
E3	Discharged capacitance and voltage > rating +10%
Alarm sounds	BIBI, ringing per 0.5 second. Press SET button to stop alarming.

Memory Function

The device is equipped with memory function for the panel setting. It will help remember the panel setting 3 seconds after you set it. When starting up the flash next time, the panel setting will be the same as that before powering it off.

Wireless Control Function

The flash unit has built-in 2.4GHz wireless R2 receiver, which can be used together with R2 and older RT32 flash triggers. Simultaneously press the **< GR/CH >** group/channel button and the **< S1/S2 >** optical button turns on the built-in wireless the **< (P) >** is displayed. If there are other wireless flash systems nearby, you can change the channel IDs to prevent signal interference. The channel IDs of the transmitter unit and the receiver unit(s) must be set to the same.

Setting the Communication Channel

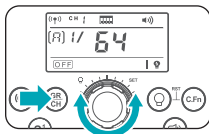

- 1 Long press the **< GR/CH >** Button for 2 seconds until the channel IDs is blinking.



- 2 Turn the SET Dial to choose the channel from 1 to 32.



- 3 Press the **< SET >** Dial to confirm.

Setting the Communication Group

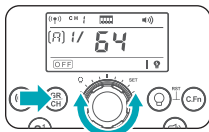

- 1 Short press the **< GR/CH >** Button for 2 seconds until the group IDs is blinking.

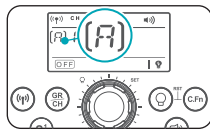

- 2 Turn the SET Dial to choose the group from 0 to F.

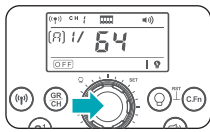

- 3 Press the **< SET >** Dial to confirm.

The flash unit is built in with a Wireless Control Port so that you can wirelessly adjust the power level of the flash and the flash triggering.

To control the flash wirelessly, you need a FPRSL remote control set (on-camera and on-flash). Insert its receive end into the Wireless Control Port on the flash and insert the transmit end into the camera hot shoe. Settings made on the hotshoe-mounted transmit and receive ends will be wirelessly communicated to the flash. Then you can press the camera shutter release button to trigger the flash. You can also hold the transmit end at hand to control your off-camera flash.

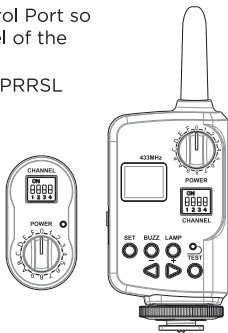

For full instructions on the use of FPRSL remote control, see its user manual.

⚠ Troubleshooting R2 Wireless

1. Interference of the 2.4GHz R2 signal in outer environment (e.g. wireless base station, 2.4GHz wifi router, Bluetooth, etc.)
 - To adjust the channel CH setting on the flash trigger (add 10+ channels) and use the channel which is not interfering. Turn off the other 2.4GHz devices.
2. Make sure that whether the flash has finished its recycle or caught up with the continuous shooting speed (the flash ready indicator is lighten) and the flash is not under the state of over-heat protection or other abnormal situation.
 - Please lower the flash power output. If the flash is in TTL mode, please try to change it to M mode (a preflash is needed in TTL mode).
3. The distance between the flash trigger and the flash is too close or not.
 - Please turn on the "close distance wireless mode" on the flash trigger (<0.5m):
R2 and R2 Pro: Press the test button and hold on, then turning it on until the flash ready indicator blinks for 2 times.
R2 Mark II Pro: Set the C.Fn-DIST to 0-30m.
4. The flash trigger and the receiver end equipment are in the low battery states or not.
 - Please replace the battery (the flash trigger is recommended to use 1.5V disposable alkaline battery).

Tube Replacement

Shut down the power and remove the power cord before replacing the flash tube and wear insulated gloves. Then, loosen the iron wire on the tube, keep a balanced hold on the two feet of the flash tube and pull out the old tube gently. Take down the feet casing from the old tube and put it on the new one. Hold two feet of the new tube, and target directly towards the two copper outlets, then push them slightly in. Twine the iron wire on the stainless steel sheet to fix the flash tube.

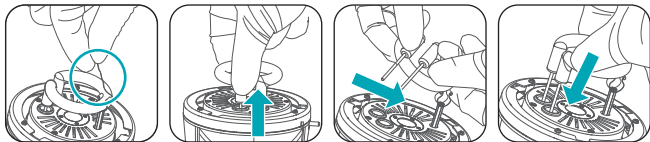

Technical Data

Model	FPLFSP400III	FPLFSP600III	FPLFSP800III	FPLFSP1KIII
Max Power (Ws)	400Ws	600Ws	800Ws	1000Ws
Guide Number (ISO 100, in meters) (With high effective reflector)	87	106	126	140
Color Temperature	5800±200K			
Operating Voltage	100-240V - 50/60Hz			
Power Output Control	OFF, 4.0 ~ 10.0 (1/64 ~ 1/1)			
Modeling Lamp (W)	30W			
Triggering Method	Sync cord, Test button, Receiver triggering, Wireless control port			
Flash Duration	1/2000 - 1/800s			
Parameters Output from the Sync Cord Jack	5V			
Parameters Output from the USB Port	5V/200mA (only for Godox receiver)			
Fuse	8A			
Recycle Time	0.1 ~ 1.0s			
Dimension	Flash diameter 12.5cm, height of flash with handle 21.5cm			
	length of flash with lamp cover 38cm		length of flash with lamp cover 41cm	
Net Weight (Excluding cover)	Approx. 2.8kg	Approx. 2.8kg	Approx. 2.8kg	Approx. 3.4kg

Maintenance

- Shut down the device immediately when it works abnormally and find out the reason.
- Avoid sudden impacts and the lamp should be dedusted regularly.
- It is normal for the lamp to be warm when in use. Avoid continuous flashes if unnecessary.
- Maintenance of the flash must be performed by our authorized maintenance department which can provide original accessories. The flash-tube and the modeling lamp are user-replaceable. Replacement tubes and lamps can be obtained from the manufacturer.
- This product, except consumables e.g. flash tube and modeling lamp, is supported with a one-year warranty.
- Unauthorized service will void the warranty.
- If the product had failures or was wetted, do not use it until it is repaired by professionals.
- Disconnect the power when cleaning the flash or when changing the flashtube / modeling lamp.
- Changes made to the specifications or designs may not be reflected in this manual.

FCC Statement

This device complies with part 15 of the FCC Rules. Operation is subject to the following two conditions: (1) This device may not cause harmful interference, and (2) this device must accept any interference received, including interference that may cause undesired operation.

Any Changes or modifications not expressly approved by the party responsible for compliance could void the user's authority to operate the equipment.

Note: This equipment has been tested and found to comply with the limits for a Class B digital device, pursuant to part 15 of the FCC Rules. These limits are designed to provide reasonable protection against harmful interference in a residential installation. This equipment generates uses and can radiate radio frequency energy and, if not installed and used in accordance with the instructions, may cause harmful interference to radio communications. However, there is no guarantee that interference will not occur in a particular installation. If this equipment does cause harmful interference to radio or television reception, which can be determined by turning the equipment off and on, the user is encouraged to try to correct the interference by one or more of the following measures:

- ▶ Reorient or relocate the receiving antenna.
- ▶ Increase the separation between the equipment and receiver.
- ▶ Connect the equipment into an outlet on a circuit different from that to which the receiver is connected.
- ▶ Consult the dealer or an experienced radio/TV technician for help.

The device has been evaluated to meet general RF exposure requirement. The device can be used in portable exposure condition without restriction.

One Year Flashpoint Limited Warranty

Flashpoint warrants to the original purchaser that your Flashpoint product shall be free from defects in material and workmanship for the period of one (1) year from the date of purchase (or delivery as may be required in certain jurisdictions), or thirty (30) days after replacement, whichever comes later.

Flashpoint's entire liability and your exclusive remedy for any breach of warranty shall be, at Flashpoint's option, to repair or replace the hardware, provided that the hardware is returned to the point of purchase or such other place as Flashpoint may direct with a copy of the sales receipt or dated itemized receipt. Flashpoint may, at its option, replace your product, offer to provide a functionally equivalent product, or repair any product with new, refurbished or used parts as long as such parts are in compliance with the product's technical specifications. Any replacement hardware product will be warranted for the remainder of the original warranty period or thirty (30) days, whichever is longer, or for any additional period of time that may be applicable in your jurisdiction. If the product has been discontinued, the warranty provider reserves the right to replace it with a model of equivalent quality and function. This warranty does not cover problems or damage resulting from accident, abuse, misapplication, or any unauthorized repair, modification or disassembly, improper operation or maintenance, normal wear and tear, or usage not in accordance with product instructions or connection to improper voltage supply, use of consumables, such as replacement batteries, not supplied by Flashpoint, except where such restriction is prohibited by applicable law.

Except where prohibited by applicable law, this warranty is nontransferable and is limited to the original purchaser and the country in which the product was purchased. This warranty gives you specific legal rights, and you may also have other rights, including a longer warranty duration that may vary under local laws.

To start a warranty claim contact the Flashpoint Customer Service Department to obtain a return merchandise authorization ("RMA") number, and return the defective product to Flashpoint, along with the RMA number and proof of purchase.

Question about our product line? Need Product Support?

We are proud of our products and celebrate our customers.
We are with you, from product selection to everyday use.
Be secure with your purchase and reach us as you need.

 212-647-9300

 support@flashpointlighting.com

 Flashpoint,
42 West 18th Street,
New York, NY 10011

You can always contact us at BRANDS@ADORAMA.COM for personal technical support. Our website contains a wide range of Support and FAQ pages with valuable technical assistance.

Flashpoint is a registered trademark of ADORAMA CAMERA.

© 2022 Adorama Camera, Corp.

All Rights Reserved.

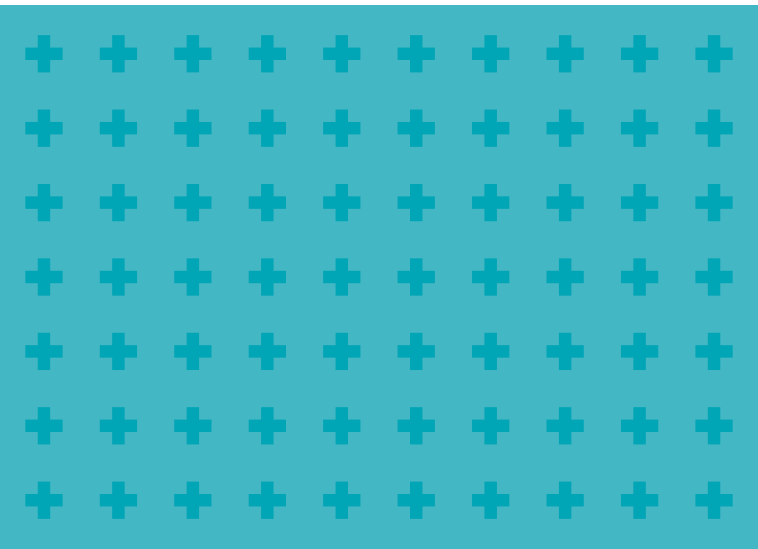

FLASHPOINTLIGHTING

Scan to follow our
official instagram

WWW.FLASHPOINTLIGHTING.COM