

*FP* FLASHPOINT



XPLOR 300 PRO TTL <sup>P2</sup>  
Battery-Powered Monolight

FPLFX300PTB

# Thank you for purchasing this Flashpoint XPLO300 Pro. The picture-perfect bridge between monolight and pocket flash.

Smaller is better.

Compact is sweet.

Power is honey.

**Yes, you can believe it.** The ingenious, freshest member of our world renowned R2 Family of Wireless Flash. 300WS in a cylindrical futuristic body featuring R2 Wireless triggering, High Speed Sync on demand, 2600WAh Lithium-Ion rechargeability, intense Bi-Color LED guided modeling, enhanced Custom Functions. TTL, Manual, and MultiStrobe modes. All in a sleek, restyled, profile that a Swede would appreciate.

**Travel-friendly.** All the power and utility of a monolight at the size of a dream. Touch the controls, and you know you're in command. From Full Power down to a 1/256th in user-selected increments of Tenth's or Thirds of a stop. A redesigned select wheel to sail through values and punch it in.

The flash is just a hair over 3 pounds. Pack it all in. Go explore with several of these and light the way imaging was meant to be. Worry-free. Cordless. To your custom preferences. With the focus on portable lighting, the R2 Family liberates you from the hassle and tangle of hot, wired monolights - whether you are a wedding or event photographer, environmental portraiture shooter, freelance commercial studio illustrator, eager photojournalist, a wandering backpack adventurer, or fast action sports snapper.

**Round About.** Charge through the mire and stand tall. Eight Custom Functions that include Masking sequencing, Delay and Timer clocks, Slave and Modeling options, plus.

**You can't resist this beauty.** The battery cell is reminiscent of the eVOLV200 interchangeable packs, slipping unobtrusively into a rear port for hundreds of pops. Exchange a depleted bat-pack in a matter of seconds for keeping pace with whatever you're tracking. The sun is no match to this exceptional performer with superior HSS, up to 1/8000s. The newly integrated Godox reflector makes the flash ready to serve up some dazzling imagery without add-ons, speeding the way to the finish line.

**It's a Flashpoint, after all.**

## Enjoy all of the advantages

- 300ws in the most well thought out sleek design
- Ready for shot after shot with 0.01-1 Second Recycle Time
- Reliable and brilliant Flashpoint R2 2.4GHz Radio System
- Auto-Sensing and Switching Radio Slave Modes for Canon, Sony, Nikon, Fujifilm, Pentax and Panasonic/Olympus
- 328 feet/100 meter R2 signal reception range
- Rear port interchangeable 14.4V/2600mAh Lithium-ion Battery
- Manual Flash over 9 Stops: 1/256-1/1 Output (1/3rd or 1/10th Increments)
- Flash Modes-TTL/M/Multi
- 5 Groups keep the pace and the peace-A/B/C/D/E
- 32 Channels protect the isolation of the signal
- High Speed Sync to 1/8000th second
- Advanced IGBT circuitry for stable and precise flash duration
- Last Shot Auto Memory Function
- Second Curtain Sync
- FEC/FEB-1/3rd Increments ( $\pm 3$  Stops)
- FEL (Flash Exposure Lock)
- S1 Standard & S2 'Smart' Optical Slave Modes
- Professional balanced Color Temperature at  $5600^{\circ}\text{K} \pm 200^{\circ}\text{K}$
- Stable Color Mode narrows to variable down to  $\pm 75^{\circ}\text{K}$
- Bi-Color LED Modelling Light ( $3000^{\circ}\text{K} \sim 6000^{\circ}\text{K}$ ) (M/Prop)
- Optional Bowens Mount Adapter or Native Godox Mount friendly
- Quiet Fan Cooled mechanism
- Large Dot Matrix LCD Display
- An Abundance of Custom Functions
- Type C USB Port for Firmware Upgrades

## Safety Instructions

- ⚠ Turn off the flash unit immediately in the event of a malfunction.
- ⚠ Always keep this product dry. Do not use in rain or in damp conditions.
- ⚠ This product contains high-voltage electronic parts. Touching the high-voltage circuit inside it may result in electric shock. Do not disassemble. Should repairs become necessary, this product must be sent to an authorized maintenance center.
- ⚠ Stop using this product if it breaks open due to impact or force. Electric shock may occur if you touch the internal parts.
- ⚠ Do not insert metal parts into any lighting equipment.
- ⚠ Do not touch the electrical contacts on the strobe or battery or contact them with any conductive materials.
- ⚠ Do not use the flash unit in the presence of flammable gases, chemicals and ignitable materials. In certain circumstances, these materials may be sensitive to the strong light or electromagnetic interference emitted from this flash unit.
- ⚠ Maintain a minimum distance of 4 inches or 10 cm from flammable materials.
- ⚠ Do not leave or store the flash unit if the ambient temperature reaches over 120°F/50°C (e.g. in a sun-bathed automobile). Electronic parts may be permanently damaged.
- ⚠ Do not use any power supply to charge the battery, other than the one included.
- ⚠ The LED module of this unit is not user replaceable. Refer to the authorized service center for replacement.

## Conventions used in this Manual

- This manual is based on the assumption that both the camera and camera flash's power switches are powered on.
- The following alert symbols are used in this manual:
  - ⚠ The Caution symbol indicates a warning to prevent shooting problem.
  - 📌 The Note symbol gives supplemental information.



## Contents

- 1 Foreword
- 2 Safety Instructions
- 5 Name of Parts
  - Body
  - LCD Panel
  - Included Accessories
  - Separately Sold Accessories
  - Replacing Adapter Rings and Accessories
  - Attaching and Detaching Flash Tube
- 10 Battery
- 10 Power Management
- 11 Modeling Lamp
- 11 Wireless Flash Mode
- 11 Flash Mode -- TTL Autoflash
- 11 TTL Mode
  -  High-Speed Sync
- 12 Flash Mode - M: Manual Flash
- 14 Flash Mode - Multi/Stroboscopic Flash
- 15 Wireless Flash Shooting: Radio (2.4G) Transmission
- 17 C.Fn: Setting Custom Functions
- 18 Other Applications
  - Sync Triggering
- 19 Protection Function
- 20 Technical Data
- 21 FCC Statement
- 22 Warranty

Name of Parts

Body:

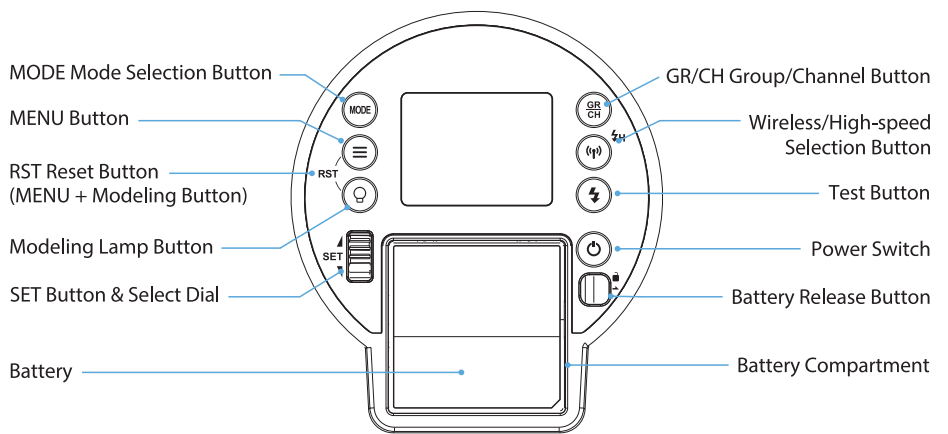
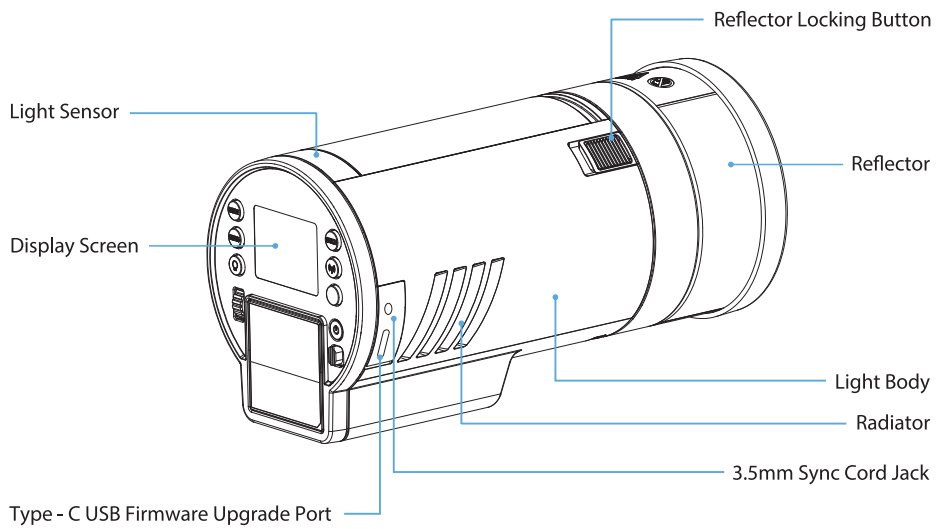

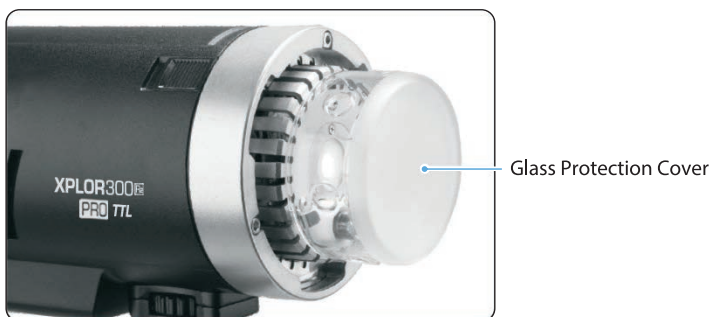
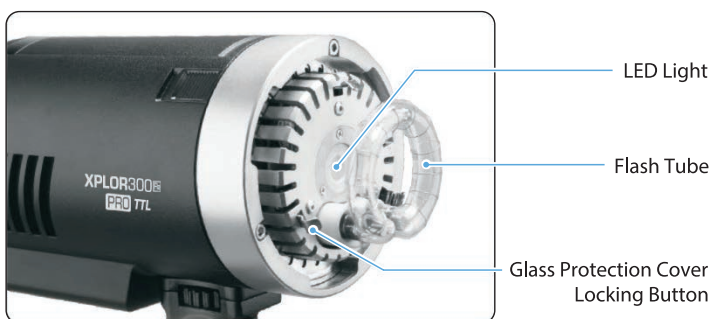
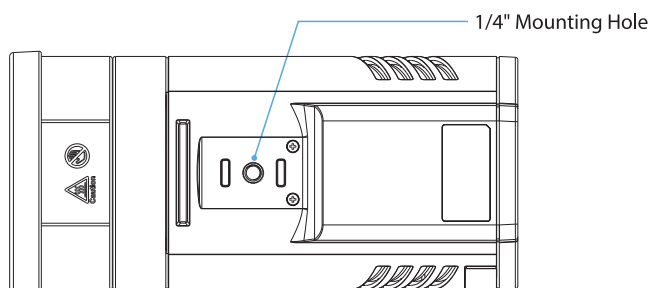

Name of Parts

LCD Panel

(1) LCD Panel

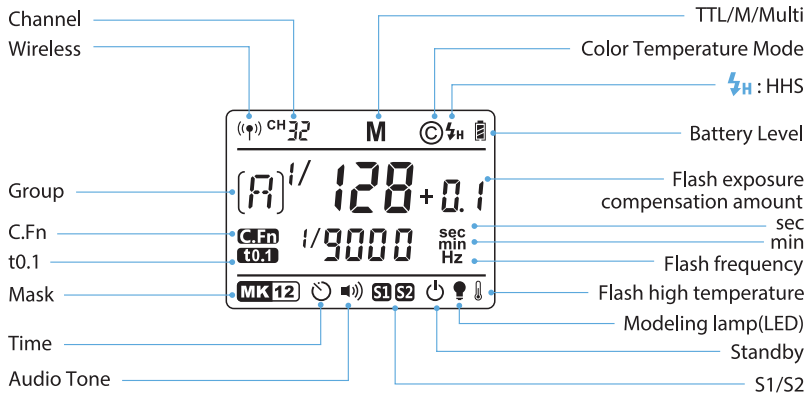

- The display will only show the settings currently applied.
- The functions displayed above function buttons 1 to 4, such as **SYNC** and **±**, change according to settings' status.
- When a button or dial is operated, the LCD panel illuminates.

(2) M Manual Flash

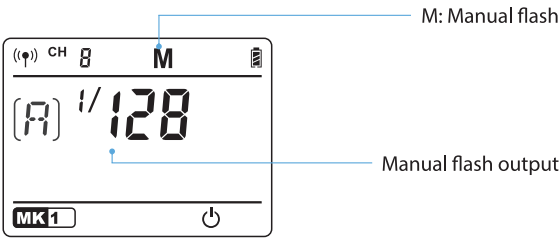

(3) Multi Flash

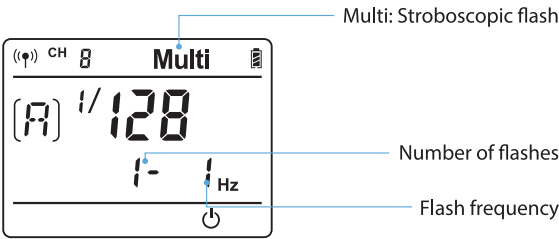



(4) R2 Radio Transmission Shooting

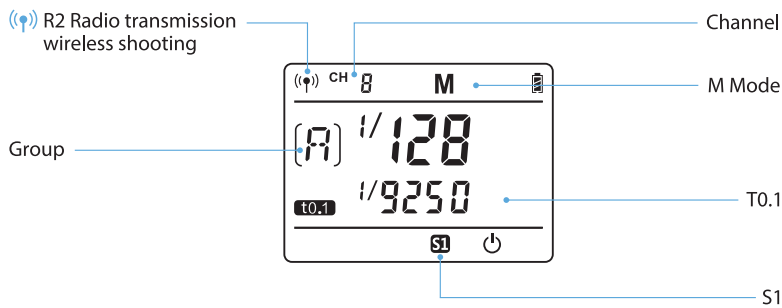

• S1/S2 Optical Slave

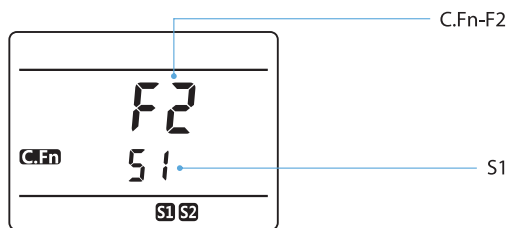

Included Accessories

1. Light body 2. Flash tube 3. Glass protection cover 4. Reflector 5. AD-E2 bracket 6. Charger 7. Battery 8. Portable bag 9. Instruction manual



Separately Sold Accessories

Flashpoint R2 wireless remote transmitters are the key to this system control The Bowens S-type mount adapter accepts reflectors, softboxes, snoots and beauty dishes, and all compatible light shaping tools from Glow, to expand your light shaping skills. See them all at [adorama.com](http://adorama.com).



## Name of Parts

### Optional Modifier Solutions

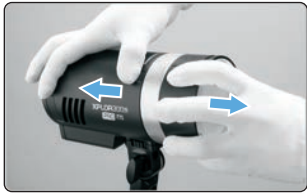

**1** Remove the reflector or other accessories from the flash head.



**2** Install the first half of the mount adapter holder into the fixing slot. Then, install the other half of the adapter to form the modifier according to the mount.



**3** Select and match the adapter ring to the adapter holder.



**4** Complete the installation by tightening the four screws.



**5** Install the light modifier of your choice from the range of mounts from Bowens and others, Godox light shapers fit directly on the XPLOR300 Pro without the adapter.

### Flash Tube Maintenance



**1** Remove the reflector or other accessories from the flash head.



**2** Match the flash tube in the Tube Socket. Push the flash tube in until it is securely seated into the socket.



**3** Place an edge of the Glass Protector outside of Spring 1. Simultaneously press down the rim onto Spring 2 and 3. The Glass should surround the clips and hold in place.

### Detach Flash Tube



**1** Pull out the glass protection cover from the spring 2 and 3 before 1.



**2** Pinch the flash tube holder with your thumb and forefinger and pull out the tube upwards.

# Lithium Battery

## Features

1. The Flashpoint XPLORE 300 Pro uses an advanced 14.4v/2600mAh Li-ion polymer battery with exceptional 37.44Wh performance. The charge-and-discharge times are 500.
2. The battery pack is reliable and safe with circuitry to prevent overcharge, deep discharge, excess current, and short circuits.
3. The battery only requires 2.5 hours to fully charge, using the supplied standard charger.

## Cautions:

- Do not short circuit.
- Do not expose to rain or immerse into water. This battery is not water proof.
- Keep out of reach of children.
- Avoid more than 24 hours of continuous charging.
- Store in dry, cool, ventilated places.
- Do not dispose into fire or incinerate.
- Dead batteries should be disposed according to local regulations.
- Charge the battery to approximately 60% of capacity before storing for extended periods.
- It is recommended to fully recharge the battery every three months.

## Battery Level Indication

Make sure the battery pack is securely attached to the flash. Check the battery level indication on the LCD Panel to see the remaining battery level.

| Battery Level Indication on the LCD Panel | Meaning  |
|---|--|
| 3 grids                                   | Full battery   |
| 2 grids                                   | Middle battery   |
| 1 grid                                    | Low battery  |
| Blank grid                                | Lower battery, please recharge it.   |
| Blinking                                  | The battery level is depleted and shut down is imminent. Flash will power off in 1 minute.<br><b>Note:</b> Please recharge the battery as soon as possible (within 10 days). |

## Power Management

The Power Switch controls the power status of the flash unit. Turn off the power pack if the flash unit will not be used for an extended period. This flash has an Auto Power Off function that will trigger after 30 to 120 minutes of inactivity, set in the C.Fn - STANDBY setting.



C.Fn

Disabling Auto Power standby function is recommended when the flash is used off camera. (C.Fn-F3, Page 17)

# Modeling Lamp

- 1. **Power on/off the modeling lamp:** short press the <💡> to control the modeling lamp status.
- 2. **Setting:** long press the <💡> to enter modeling lamp setting.
  - 2.1 **Brightness setting:** press the SET button and the brightness value blinks. Turn the select dial to change the brightness value from 1 to 10.
  - 2.2 **Color temperature setting:** press the SET button and the color temperature value blinks. Turn the select dial to change the color temperature value from 3000K to 6000K(±500K).

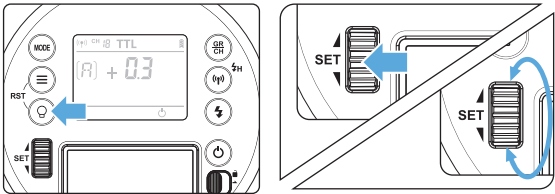

# Wireless Flash Mode

The XPLOR300 Pro can only be set as slave unit (receiver end). Short press the wireless selection button to switch the radio transmission function.

| Wireless Mode      | Flash Mode      |
|--------------------|-----------------|
| OFF                | M / Multi       |
| Radio Transmission | TTL / M / Multi |

# Flash Mode -- TTL Autoflash

The XPLOR300 Pro has three flash modes: TTL, Manual(M), and Multi(Stroboscopic). In TTL mode, the camera and the flash will work together to calculate the correct exposure for the subject and the background. In this mode, multiple TTL functions are available: FEC, FEB, FEL, HSS, second curtain sync, modeling flash, controlled with the camera's menu screen.

\* Press <MODE> Mode Selection Button and three flash modes will display on the LCD Panel in sequence.



# TTL Mode

Press <MODE> Mode Selection Button to enter TTL mode. The LCD Panel displays <TTL> indicating that exposure is controlled automatically through the camera sensors.

## High-Speed Sync

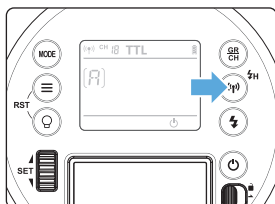
High Speed Sync(HSS) enables the flash to synchronize with all camera shutter speeds. The sun is no longer an impediment to masterful lighting outdoors. By being able to utilize shutter speeds as well as f-stops, to control exposure, the power of the flash can overcome the presence of too much sunlight or the impact of ambient light when shooting in bright environments. This is also convenient when you want to use aperture priority for fill-flash portraits.



**1** Long Press Wireless Button  for 2 seconds so that  is displayed.

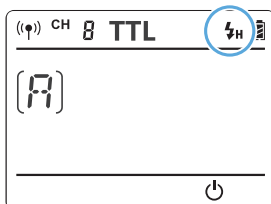

**2** Please use an R2 series transmitter to trigger.

- With high-speed sync, the faster the shutter speed, the shorter the effective flash range.
- Multi flash mode cannot be set in high-speed sync mode.
- Over-temperature protection may be activated after 20 consecutive high-speed sync flashes.

## Flash Mode -- M: Manual Flash

The flash output is adjustable from 1/1 full power to 1/256th power in 1/10th step or 1 step increments. To obtain a correct flash exposure, use a hand-held flash meter to determine the required flash output.

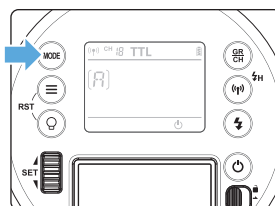

**1** Press <MODE> button so that <M> is displayed.

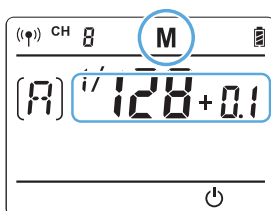

**2** Turn the Select Dial or press the SET button and turn the Select Dial simultaneously to set the flash output. The flash output will be adjustable from 1/10th increment or 1 step increment by turning the Select Dial directly or pressing the SET button and turn the Select Dial simultaneously.

## S1 Optical Slave Mode

In M manual flash mode, press the **<MENU>** button to enter C.FN-F2 to choose S1 function, so that this flash can function as an secondary flash through the optical sensor. The flash will fire synchronously when the main flash fires, the same effect as that by the use of radio triggers. This helps create multiple lighting effects.

## S2 Optical Slave Mode

Press the **<MENU>** button to enter C.FN-F2 to choose S2 function, so that this flash can also function as an secondary flash through the optical sensor in M manual flash mode. This is useful when cameras have pre-flash function. With this function, the flash will ignore the first single “preflash” from the main flash and will only fire in response to the second, actual flash from the main unit.

 • S1 and S2 optic triggering is only available in M manual flash mode.

## Display Flash Duration

Flash duration refers to the length of time that from flash’s firing to reach the half peak at maximum. The half peak at maximum is usually expressed as  $t=0.5$ . In order to provide the photographer with more concrete data, this product adopts  $t=0.1$ . The difference between  $t=0.5$  and  $t=0.1$  is shown in the following picture.

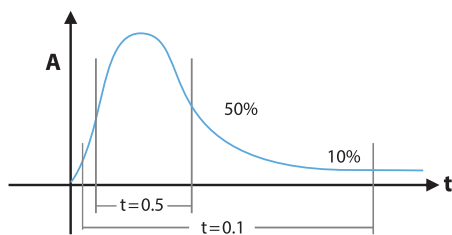

### Display Flash Duration Operation:

1. Press the **<MENU>** button to enter C.FN function.
2. Adjust the Select Dial to F6, the  $t0.1$  icon will be displayed on the LCD Panel.
3. Press **<SET>** button to change with the select dial.
4. Turn the Select Dial.

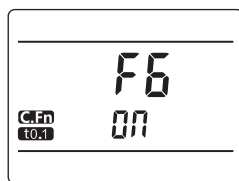
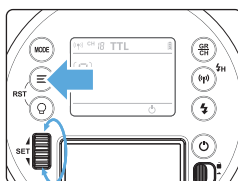

 • The flash duration will only be displayed on the LCD panel in M mode.

## Stable Color Temperature Function

When use this function, the color temperature stable within +100K over the entire power range: enter MENU C.Fn-08 and set it as ON. When adjusting the power output from high to low in M mode, the Flash Ready Indicator will blink (an audio warning will sound for 1 minute). Now press the Test Button to discharge, and the flash can be used as normal.

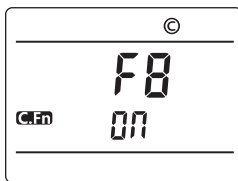

 • This function only operates in M, non-High Speed Sync mode.

## Flash Mode -- Multi: Stroboscopic Flash

With stroboscopic flash, a rapid series of flashes are fired, capturing dramatic sequences of a multiple images of moving subjects in a single photograph. You can set the firing frequency (number of flashes per sec. expressed as Hz), the number of flashes, and the flash output.

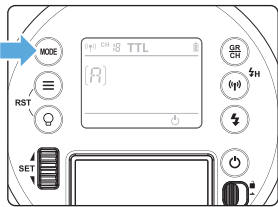

1 Press **<MODE>** button so that **<MULTI>** is displayed.

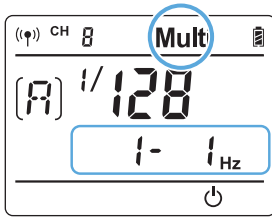

2 Turn the Select Dial to choose a desired flash output.

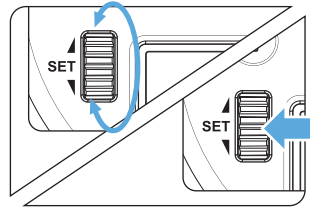

3 Set the flash frequency and flash times.

- Press **<SET>** button to select the flash frequency. Turn the Select Dial to set the number.
- Press **<SET>** button to select the flash times. Turn the Select Dial to set the number.
- After finish the setting, press **<SET>** button and all the settings will be displayed.

## Calculating the Shutter Speed

During stroboscopic flash, the shutter remains open until the firing stops. Use the formula below to calculate the shutter speed and set it with the camera.

$$\text{Number of Flashes} / \text{Flash Frequency} = \text{Shutter Speed}$$

For example, if the number of flashes is 10 and the firing frequency is 5 Hz, the shutter speed should be at least 2 seconds.



To Avoid overheating and deteriorating the flash head, do not use stroboscopic flash more than 10 times in succession. After 10 times, allow the camera flash to rest for at least 15 minutes. If you try to use the stroboscopic flash more than 10 times in succession, the firing might stop automatically to protect the flash head. If this happens, allow at least 15 minutes' rest for the camera flash.



- Stroboscopic flash is most effective with a highly reflective subject against a dark background.
- Using a tripod and a remote control is recommended.
- A flash output of 1/1 and 1/2 cannot be set for stroboscopic flash.
- Stroboscopic flash can be used with "bulb".
- If the number of flashes is displayed as "--", the firing will continue until the shutter closes or the battery is exhausted. The number of flashes will be limited as shown by the following table.

## Maximum Stroboscopic Flashes:

| Flash Output \ Hz | 1  | 2  | 3  | 4  | 5  | 6-7 | 8-9 | 10 | 11 | 12-14 | 15-19 | 20-50 | 60-99 |
|-------------------|----|----|----|----|----|-----|-----|----|----|-------|-------|-------|-------|
| 1/4               | 7  | 6  | 5  | 4  | 4  | 3   | 3   | 2  | 2  | 2     | 2     | 2     | 2     |
| 1/8               | 14 | 14 | 12 | 10 | 8  | 6   | 5   | 4  | 4  | 4     | 4     | 4     | 4     |
| 1/16              | 30 | 30 | 30 | 20 | 20 | 20  | 10  | 8  | 8  | 8     | 8     | 8     | 8     |
| 1/32              | 60 | 60 | 60 | 50 | 50 | 40  | 30  | 20 | 20 | 20    | 18    | 16    | 12    |
| 1/64              | 90 | 90 | 90 | 80 | 80 | 70  | 60  | 50 | 40 | 40    | 35    | 30    | 20    |
| 1/128<br>1/256    | 90 | 90 | 90 | 90 | 90 | 90  | 80  | 70 | 70 | 60    | 50    | 40    | 40    |

# Wireless Flash Shooting: R2 Radio(2.4GHz) Transmission

The XPLOR 300 Pro 2.4G Wireless R2 system monolight, connects to the whole family of R2 transmitters and speedlights for R2 Canon E-TTLII, Nikon iTTL, Sony, Fujifilm, Pentax and Olympus/Panasonic TTL systems. The flash responds instantly to match the various transmitter' camera system without user intervention. Different camera systems signals can be used on the same channel simultaneously without failing to sync TTL properly.

## 1. Wireless Settings

Press the wireless selection button to switch wireless function ON/ OFF.  
Turn the wireless function on, the <(P)> icon will be displayed on the LCD Panel.  
When using a non R2 remote control attached to the wired sync port, turn off the wireless function.

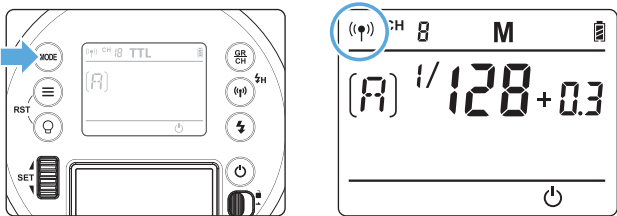

## 2. Setting the Communication Channel

If there are other wireless flash systems nearby, you can change the channel value to prevent signal interference. The channel value of the master unit and the Slave unit(s) must be set to the same.

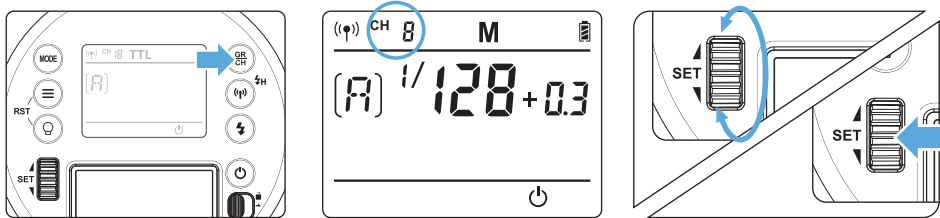

- 1 Long press the <GR/CH> Button for 2 seconds, so that the icon will be displayed on the LCD panel.
- 2 Turn the Select Dial to choose a channel value from 1 to 32.
- 3 Press the <SET> button to confirm.

## 3. Setting the Communication Group

Short press the <GR/CH> button to choose group from A to E.

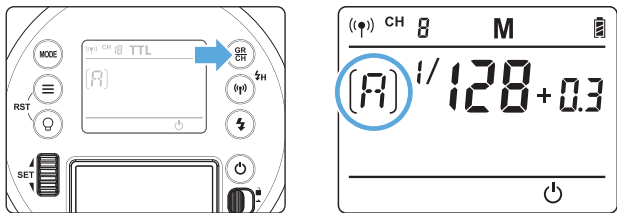



# 4. Wireless ID Settings

Press the MENU button to enter C.Fn to choose OFF or any figure from 01-99. Note: This can only be used when the master unit possesses the wireless ID function.

## Positioning and Operation Range

(Example of wireless flash shooting)

- Autoflash Shooting with One Slave Unit

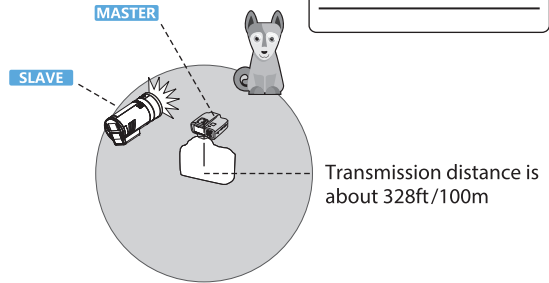

- Perform a test flash and test shooting.
- The transmission distance might be shorter depending on the conditions such as positioning of Slave units, the surrounding environment and weather conditions.
- As may be common with wireless signal interference conditions, if flash misfires are frequent, change the wireless communication channel.

## Wireless Multiple Flash Shooting

You can divide the Slave units into two or three groups and perform TTL autoflash while changing the flash ratio (factor). In addition, you can set and shoot with a different flash mode for each firing group, for up to 5 groups.

- Auto Shooting with Two Slave Groups

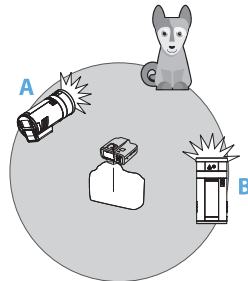

- Auto Shooting with Three Slave Groups

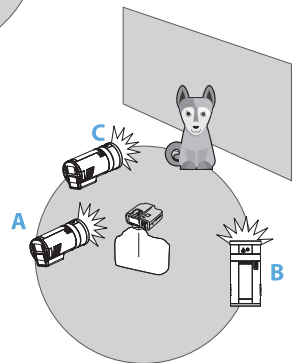

**When using the XPLOR 300 Pro and an Flashpoint R2 series trigger together, the R2 remote can control the flash function such as:**

- Flash Mode: TTL, M, Multi
- Sync Mode: First-curtain sync, second-curtain sync and High-speed sync
- Control the power level
- Modeling Lamp
- Audio Tone

## Troubleshooting Flashpoint R2 2.4GHz Wireless Radio

### 1. Interference by the 2.4G signal from local devices(e.g. wireless base station, 2.4G wifi router, Bluetooth, etc.)

→ Adjust the channel CH setting on the flash trigger and select the channel which has no interference. Turn off the other 2.4G equipment or offending devices.

### 2. Make sure that whether the flash has finished its recycle or caught up with the continuous shooting speed(the flash ready indicator is lit) and the flash is not under the state of over-heat protection or other abnormal situation.

→ Lower the flash power output. If the flash is in TTL mode, change it to M mode.

### 3. The distance between the flash trigger and the flash is too close

→ Turn on the "close distance wireless mode" on the flash trigger(<20in/0.5m)

R2 series: press the test button and hold. While pressing, turn on and hold until the flash ready indicator blinks for 2 times.

R2 Pro series: Set the C.Fn-DIST to 0-98ft/1-30m.

### 4. The flash trigger or the receiver end device have insufficient battery power.

→ Replace the battery. Use 1.5V disposable alkaline batteries for the best results.

## C.Fn: Setting Custom Functions

The following table lists the custom functions of this flash.

| Custom Function Signs | Function                      | Setting Signs | Settings & Descriptions                                 | Restrictions          |
|-----------------------|-------------------------------|---------------|---|-----------------------|
| F1                    | Beeper                        | ON            | ON  | ON                    |
|                       |                               | OFF           | OFF   |                       |
| F2                    | S1/S2 mode selection          | OFF           | OFF   | M mode                |
|                       |                               | S1            | S1 mode   |                       |
|                       |                               | S2            | S2 mode   |                       |
| F3                    | Auto standby                  | OFF           | OFF   | ON                    |
|                       |                               | 30 min        | Auto standby without any operation                      |                       |
|                       |                               | 60 min        |   |                       |
|                       |                               | 90 min        |   |                       |
| F4                    | Delay flash                   | OFF, 0.01-30s | Can be triggered as second curtain                      | M/Multi mode          |
| F5                    | Mask                          | OFF           | OFF   | M mode                |
|                       |                               | n1            | ON: Trigger 2 times for 1 cycles, 1th flash of trigger. |                       |
|                       |                               | n2            | ON: Trigger 2 times for 1 cycles, 2th flash of trigger. |                       |
| F6                    | t0.1 display                  | ON            | Display   | M mode                |
|                       |                               | OFF           | Not display   |                       |
| F7                    | ID Setting                    | OFF           | OFF   | Wireless mode         |
|                       |                               | 01-99         | Choose any figure from 01-99                            |                       |
| F8                    | Stable Color Temperature Mode | OFF           | OFF   | M non-high-speed mode |
|                       |                               | ON            | ON  |                       |

**1. Press the <MENU> button to enter the C.Fn menu.**

**2. Select the custom function No.**

- Turn the SET Selection Dial to select the custom function No.

**3. Change the Setting.**

- Press <SET> button and the Setting No. blinks.
- Turn the SET Select Dial to set the desired number. Pressing <SET> button will confirm the settings.

**4. Exit C.Fn menu**

- Press <MENU> button to exit.

---

A Glow S2 Round Flash S-type Bowens Mount Bracket for Round Head Flashes (GLBDSM02PRO) transforms the XPLOR300 Pro to the popular Bowens modifier mount, with limitless products from softboxes to focusing spot lenses. See them all at [ADORAMA.COM](http://ADORAMA.COM)



### Sync Triggering

The Sync Cord Jack is a Ø3.5mm plug. Insert a trigger plug here and the flash will be fired synchronously with the camera shutter.

# Protection Function

## 1. Overheat Protection

- To Avoid overheating and deteriorating the flash head, the internal thermal overheat protection function will be activated. When the overheat protection is started,  is shown on the LCD Panel.
- When the recycle time is over 10 seconds in protection, please allow a rest time of at least 10 minutes and the flash will then return to normal.

## 2. Other Protections

- The system provides real-time protection to secure the device and your safety. The following lists prompts for your reference:

| Prompts on LCD Panel | Meaning  |
|----------------------|--|
| E1                   | An error is present on the recycling system so that the flash cannot fire. Please restart the flash unit. If the problem still exists, please send this product to a maintenance center. |
| E2                   | The system is excessively hot. Please allow a rest time of 10 minutes.   |
| E3                   | The flash tube circuitry has malfunctioned. Please send this product to a maintenance center.  |
| E9                   | Errors occurred during the upgrading process. Please using the correct firmware upgrade method.  |

# Technical Data

| Model   | Flashpoint XPLOR300 Pro   |             |
|---|---|-------------|
| Wireless Slave Unit Mode                                      | Radio transmission mode(compatible with Nikon, Canon,Sony, Fujifilm, Olympus, Panasonic and Pentax) |             |
| Flash Mode  | Wireless off  | M/Multi     |
|   | Slave unit of radio transmission  | TTL/M/Multi |
| Compatible Cameras with R2 Radio Transmission (as Slave unit) | Nikon cameras(R2T-N as trigger)   |             |
|   | Canon EOS cameras(R2T-C as trigger)   |             |
|   | Sony cameras(R2T-S as trigger)  |             |
|   | Fujifilm cameras(R2T-F as trigger)  |             |
|   | Olympus cameras(R2T-O as trigger)   |             |
| Flash Duration t.01 (approx.)                                 | 1/220 to 1/10200 seconds  |             |
| Power Joules  | 300Ws   |             |
| Power Output  | 9 steps: 1/256~1/1  |             |
| Stroboscopic Flash  | Provided (up to 90 times, 99Hz)   |             |
| Flash Exposure Compensation (FEC)                             | Adjust the parameters in the 2.4G remote control  |             |
| Sync mode   | High-speed sync (up to 1/8000 seconds), first-curtain sync, and second-curtain sync                 |             |
| Delay Flash   | 0.01~30 seconds   |             |
| Mask  | √   |             |
| Beeper  | √   |             |
| Modeling Lamp (LED)   | 12W; Color temperature: 3000-6000K+500K; Light brightness: 1 to 10 levels                           |             |
| Optical Slave Flash   | S1/S2   |             |
| Flash Duration Indication                                     | √   |             |
| Wireless Flash (2.4G transmission)                            |   |             |
| Wireless flash function                                       | Slave, Off  |             |
| Controllable Slave groups                                     | 5 (A, B, C, D, and E)   |             |
| Transmission range  | approx. 328ft / 100m  |             |
| Channels  | 32 (1-32)   |             |
| ID  | 01-99   |             |
| Power Supply  |   |             |
| Power Supply  | Lithium battery pack (14.4V/2600mAh)  |             |
| Full Power Flashes  | Approx. 300   |             |
| Recycle Time  | Approx. 0.01-1.5s   |             |
| Battery Indicator   | √   |             |
| Power Indication  | Power standby automatically after approx. 30 minutes of idle operation.                             |             |
| Sync Triggering Mode  | 3.5mm sync line, Wireless control port  |             |
| Color Temperature   | 5600±200k   |             |
| Stable Color Temperature                                      | Change within ±100K over the entire power range in color temperature mode.                          |             |
| Dimensions  |   |             |
| Dimension   | 7.5 × 3.9 × 3.5in / 190 × 100 × 90mm  |             |
| Net Weight  | 2lb 12oz / 1.25kg (battery included)  |             |

## FCC

This device complies with part 15 of the FCC Rules. Operation is subject to the following two conditions: (1) This device may not cause harmful interference, and (2) this device must accept any interference received, including interference that may cause undesired operation.

Any Changes or modifications not expressly approved by the party responsible for compliance could void the user's authority to operate the equipment.

**Note:** This equipment has been tested and found to comply with the limits for a Class B digital device, pursuant to part 15 of the FCC Rules. These limits are designed to provide reasonable protection against harmful interference in a residential installation. This equipment generates uses and can radiate radio frequency energy and, if not installed and used in accordance with the instructions, may cause harmful interference to radio communications. However, there is no guarantee that interference will not occur in a particular installation. If this equipment does cause harmful interference to radio or television reception, which can be determined by turning the equipment off and on, the user is encouraged to try to correct the interference by one or more of the following measures:

- ▶ Reorient or relocate the receiving antenna.
- ▶ Increase the separation between the equipment and receiver.
- ▶ Connect the equipment into an outlet on a circuit different from that to which the receiver is connected.
- ▶ Consult the dealer or an experienced radio/TV technician for help.

## One Year Flashpoint Limited Warranty

Flashpoint warrants to the original purchaser that your Flashpoint XPLO300 Pro shall be free from defects in material and workmanship for the period of one (1) year from the date of purchase (or delivery as may be required in certain jurisdictions), or thirty (30) days after replacement, whichever comes later.

Flashpoint's entire liability and your exclusive remedy for any breach of warranty shall be, at Flashpoint's option, to repair or replace the hardware, provided that the hardware is returned to the point of purchase or such other place as Flashpoint may direct with a copy of the sales receipt or dated itemized receipt. Flashpoint may, at its option, replace your product, offer to provide a functionally equivalent product, or repair any product with new, refurbished or used parts as long as such parts are in compliance with the product's technical specifications. Any replacement hardware product will be warranted for the remainder of the original warranty period or thirty (30) days, whichever is longer, or for any additional period of time that may be applicable in your jurisdiction. If the product has been discontinued, the warranty provider reserves the right to replace it with a model of equivalent quality and function.

This warranty does not cover problems or damage resulting from accident, abuse, misapplication, or any unauthorized repair, modification or disassembly, improper operation or maintenance, normal wear and tear, or usage not in accordance with product instructions or connection to improper voltage supply, use of consumables, such as replacement batteries, not supplied by Flashpoint, except where such restriction is prohibited by applicable law.

Except where prohibited by applicable law, this warranty is nontransferable and is limited to the original purchaser and the country in which the product was purchased. This warranty gives you specific legal rights, and you may also have other rights, including a longer warranty duration that may vary under local laws.

To start a warranty claim contact the Flashpoint Customer Service Department to obtain a return merchandise authorization ("RMA") number, and return the defective product to Flashpoint, along with the RMA number and proof of purchase.

### Question about our product line? Need Product Support?

We are proud of our products and celebrate our customers.  
We are with you, from product selection to everyday use.  
Be secure with your purchase and reach us as you need.

 **212-647-9300**

 **brands@adorama.com**

 **Adorama Brands,  
42 West 18th Street,  
New York, NY 10011**

You can always contact us at BRANDS@ADORAMA.COM for personal technical support.  
Our website contains a wide range of Support and FAQ pages with valuable technical assistance.

Flashpoint is a registered trademark of ADORAMA CAMERA.

© 2020 Adorama Camera, Corp.

All Rights Reserved.

