

FP FLASHPOINT



Nikon/Canon
Off Camera TTL Shoe Cord

Thank you for purchasing this **FLASHPOINT** product !
Before using the product, please read this manual, as well as the user manual of your camera and speedlight, to ensure correct operation.

Features

The FPOCC cord is compatible with the full line of (Nikon/Canon) Cameras and flashes, to offer you the best off-camera speedlight experience.

Cable length	80 cm
Extended lenght	150cm
Weight	102g

Parts illustration

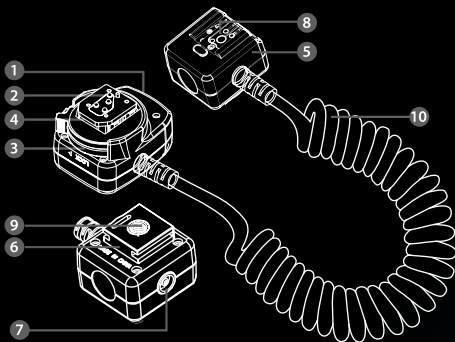

1. AF assist lamp
2. Electronic pins
3. Hot shoe locking lever
4. Locking Ring
5. Sync Controlled end

6. Cold shoe mount
7. PC socket
8. Hot shoe mount
9. Tripod screw mount hole
10. Extendable cord

Installation and Removal

Attach the FPOCC hot shoe onto the hot shoe of your camera, then tighten the lock knob to secure it to your camera. (A)

If you want to remove the FPOCC cable, loosen and open the lock knob, then slide the hot shoe smoothly off your camera. (B)

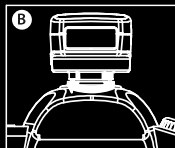
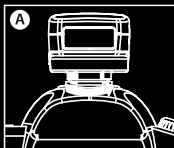

Attaching your speedlight

Slide your speedlight into the hot shoe end of the FPOCC cable, then tighten the locking mechanism on your speedlight. Power on your speedlight after it is attached to the FPOCC cable.

This cable can be used:

1. On an accessory bracket: When using an accessory bracket ensure that the cold shoe will lock firmly to the FPOCC cable.

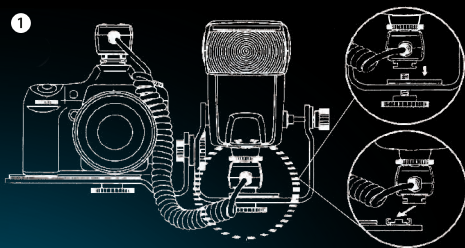

2. Handheld: keep a firm grip on your speedlight, and do not allow it to hang by the FPOCC cable. If it does fall, try to catch it on the first bounce.
3. Attached to a tripod or stand: the FPOCC cable can be attached to a tripod, light stand, or light pole (some excellent options are available from **FLASHPOINT**).

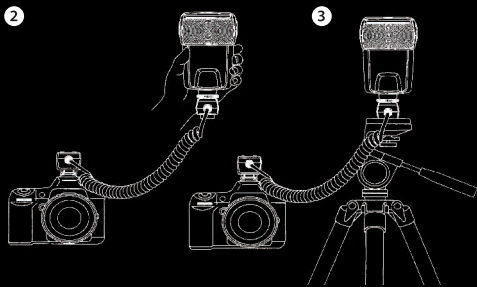

Warning

- This product is not waterproof. Avoid exposing it to water, rain, or moisture.
- Clean it with a soft, dry cloth. Do not expose this product to extreme temperatures or heat.