



GREEN  
EXTREME™

# Triple Battery Charger

GXGPTBC

for GoPro Hero 9/10/11/12 Batteries  
Manual

## Thank You for Choosing Green Extreme

Welcome to the user manual for the exceptional Green Extreme Triple Battery Charger. It is with genuine appreciation that we extend our thanks for choosing a product that transcends the ordinary. As you dive into this manual, you step into a realm where excellence, precision, and safety converge to elevate your charging experience.

Your journey with the Triple Battery Charger is about to unfold, promising a thrilling adventure where superior performance meets your aspirations. Your support means everything to us, and we're eager to witness the incredible feats you'll accomplish with this tool by your side.

Rest assured, our commitment to the enduring performance of this charger remains steadfast. We believe it will be a faithful companion on your creative journey for years to come.

# Unpacking and Inspection

Prepare for an exceptional experience by commencing with the unpacking and inspection of your shipment. This pivotal step ensures that your system is primed for peak performance and assures that no compromise is made on the quality of your equipment.

1. **Unveiling the Item:** With anticipation, open the shipping carton to reveal the item within. Take a moment to appreciate the attention to detail that has gone into curating your package.
2. **Comprehensive Verification:** Diligently verify that all the item parts is essential for operating the system is present and accounted for. It's not just about having the right tools; it's about having the right tools intact. We're committed to your satisfaction, and this step ensures that no vital element is overlooked.

**3. Scrutinizing Transport Effects:** In your quest for perfection, examine the item for any signs of transportation-induced damage. Our journey to you is not without its challenges, but your equipment should arrive unscathed and ready to perform flawlessly. Should you spot any damage, it's imperative to act promptly.

This meticulous Unpacking and Inspection process guarantees that your system's journey starts on the right foot, and your quest for excellence begins with confidence. Thank you for choosing us as your partner on this journey, and rest assured, we're with you every step of the way.

## Introduction

Introducing the "Green Extreme Triple Battery Charger for GoPro Hero 9/10/11/12 Batteries" - a game - changer and offering unparalleled convenience and efficiency, this charger is tailored to enhance your filming experience by ensuring a constant and reliable power source for your GoPro camera.

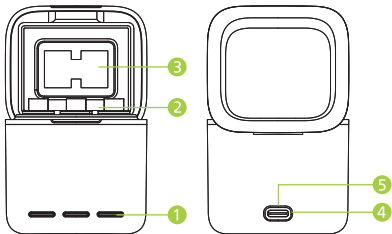

- 1. Charge Status Indicator
- 2. Battery Ports
- 3. TF Card Slots

- 4. Type-C Port
- 5. Power Indicator

## 1. Charge Status Indicator:

The charge status indicator on the Green Extreme Triple Battery Charger provides real-time updates on the charging process. This LED indicator displays different colors to signify the charging status:

Status	LED Indicators
No Battery	Blue power indicator is always on/using
Charging	Red LED is on
Full	Green LED is on

## 2. Battery Ports:

The charger features three dedicated battery ports designed specifically for GoPro Hero 9/10/11/12 batteries. These ports are conveniently labeled and provide secure slots to insert and charge the batteries simultaneously.

## 3. TF Card Slots:

Integrated TF card slots allow for convenient storage of TF cards, offering a secure space to safeguard your data. These slots ensure easy access and safekeeping of your TF cards while the charger is in use or during storage.

## **4. Type-C Port:**

The Type-C port serves as the primary input for the charger. It accepts a 5V-3A power supply, allowing quick and efficient charging. The Type-C port facilitates a reliable connection for powering up the charger.

## **5. Power Indicator:**

The power indicator on the charger serves as a visual cue to confirm that the charger is connected to a power source. This indicator light ensures that the charger is ready for operation, providing users with a clear indication of its power status.

## Charger Specifications

Mode	GP-910
Supported Battery	Hero 9/10/11/12
Operating Temperature	5°C ~ 45°C
Input	5V 3A
Output	4.4V 900mAh × 3
Charging Time	2 ~ 3 h

### Caution:

- Output Specifications:** The three-channel battery charging box delivers an output of 4.4V 900mAh. It is strongly recommended to utilize a power adapter with a parameter of 5V 3A for safe and efficient charging operations.
- Compatibility Limitation:** This charging box is exclusively designed to charge batteries compatible with GoPro Hero 9/10/11 models. Charging batteries from other camera models or series is strictly prohibited and may cause damage to both the charger and the batteries.



3. **Stable Position:** It is essential to keep the charging box in a stable and level position while in use. Avoid tilting or leaning the charger during the charging process to prevent any potential hazards or disruption of the charging cycle.
4. **Caution with Terminals:** Refrain from touching the metal terminals of the charging box while it is powered on. This precautionary measure minimizes the risk of electrical shock or damage to the charger and batteries.
5. **Avoid Moisture Exposure:** It is crucial to avoid wiping the charging box with wet or damp materials. Exposure to moisture may cause malfunction or damage to the internal components of the charger, compromising its functionality and safety.

# Operating Instructions

## Step 1:

Place the charger on a flat and stable surface. Place the battery into battery ports then connect the provided USB adapter to the type-C port.

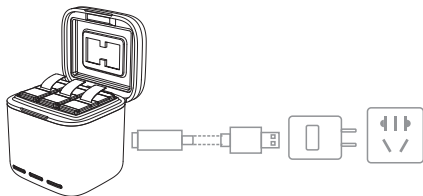

## Step 2:

Plug the other end of the Type-C power cable into a suitable power source that delivers 5V-3A for optimal performance. The power indicator should illuminate, indicating that the charger is receiving power.

### Step 3:

Identify the battery ports labeled for GoPro Hero 9/10/11/12 batteries. Gently align the batteries with their respective ports and insert them securely into the charger.

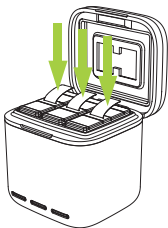

### Step 4:

Monitor the LED indicator, as they will change when the batteries are fully charged - Refer to the LED indicator status.

### Step 5:

Once the LED indicators turn green, carefully remove the fully charged batteries from the charger. Unplug the charger from the power source.

## Step 6:

If not in use, unplug the charger and store it in a safe, dry place. Ensure the charger is disconnected from any power sources when not in operation.

- We express our sincere appreciation for choosing the Green Extreme Triple Battery Charger for GoPro Hero 9/10/11/12 Batteries as your trusted partner in your creative endeavors. Your pursuit of excellence is our inspiration, and we are honored to be a part of your journey. Should you ever need assistance or have any questions, our dedicated support team is here to help.
- Thank you for placing your trust in us. We look forward to witnessing the remarkable feats you will achieve with your new Telepole Support System. Your success is our success, and we are here to support you every step of the way.

## One Year Green Extreme Limited Warranty

GREEN EXTREME warrants to the original purchaser that your GREEN EXTREME product shall be free from defects in material and workmanship for the period of one (1) year from the date of purchase (or delivery as may be required in certain jurisdictions), or thirty (30) days after replacement, whichever comes later.

GREEN EXTREME's entire liability and your exclusive remedy for any breach of warranty shall be, at GREEN EXTREME's option, to repair or replace the hardware, provided that the hardware is returned to the point of purchase or such other place as GREEN EXTREME may direct with a copy of the sales receipt or dated itemized receipt. GREEN EXTREME may, at its option, replace your product, offer to provide a functionally equivalent product, or repair any product with new, refurbished or used parts as long as such parts are in compliance with the product's technical specifications. Any replacement hardware product will be warranted for the remainder of the original warranty period or thirty(30) days, whichever is longer, or for any additional period of time that may be applicable in your jurisdiction. If the product has been discontinued, the warranty provider reserves the right to replace it with a model of equivalent quality and function.

This warranty does not cover problems or damage resulting from accident, abuse, misapplication, or any unauthorized repair, modification or disassembly, improper operation or maintenance, normal wear and tear, or usage not in accordance with product instructions or connection to improper voltage supply, use of consumables, such as replacement batteries, not supplied by GREEN EXTREME, except where such restriction is prohibited by applicable law.

Except where prohibited by applicable law, this warranty is nontransferable and is limited to the original purchaser and the country in which the product was purchased. This warranty gives you specific legal rights, and you may also have other rights, including a longer warranty duration that may vary under local laws.

To start a warranty claim contact the GREEN EXTREME Customer Service Department to obtain a return merchandise authorization (“RMA”) number, and return the defective product to GREEN EXTREME, along with the RMA number and proof of purchase.

## Question about our product line? Need Product Support?

We are proud of our products and celebrate our customers. We are with you, from product selection to everyday use. Be secure with your purchase and reach us as you need.

📞 212-647-9300

✉ brands@adorama.com

📍 Adorama Brands,  
42 West 18th Street,  
New York, NY 10011

You can always contact us at [BRANDS@ADORAMA.COM](mailto:BRANDS@ADORAMA.COM) for personal technical support. Our website contains a wide range of Support and FAQ pages with valuable technical assistance.

Green Extreme is a registered trademark of ADORAMA CAMERA.

© 2024 Adorama Camera, Corp.

All Rights Reserved.

