



GREEN
EXTREME™

Compact

Battery Grip

**CB-12
for Flashes
Manual**



Thank You for Purchasing an Green Extreme Product

Green Extreme CB-12 is a professional power supply for flashes with an external power port. It operates with 12 AA-type batteries, which is 4 batteries more than the traditional battery pack, to ensure a more stable power supply for the flash, and to get a greatly increased number of flashes and a shortened recycling time. With P12, you can shoot faster, miss fewer shots and catch every wonderful moment.

Please read this user manual as well as the user manual provided with your flash which works with CB-12 before use.

For Your Safety

Before using your product, please read the following safety precaution carefully to ensure correct and safe use.

	<ul style="list-style-type: none">• The battery pack contains high voltage electronic parts. Do not disassemble or attempt to repair it.• Keep the product out of the reach of children.• Do not use the product in the presence of flammable or explosive gas.
	<ul style="list-style-type: none">• Do not expose the battery pack to high temperature over 45°C(e.g. left in a car trunk)• The product is not waterproof. Please keep away from rain, snow and high humidity conditions.• Do not clean either the battery pack or any accessories with organic solvent or alcohol-based liquid.• The fast recycling time made possible when using the battery pack could damage your flash if continuously shooting at high power settings. Some flashes have overheating protection settings, some do not. Consult your flash manual and use cautiously.
	<ul style="list-style-type: none">• Consult local authorities on the proper disposal or recycling of a battery.

FCC Interference Statement

This device complies with part 15 of the FCC Rules. Operation is subject to the following two conditions: (1) This device may not cause harmful interference, and (2) this device must accept any interference received, including interference that may cause undesired operation.

Part Names

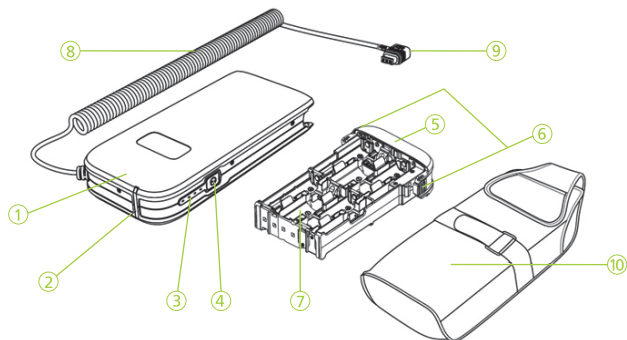

- | | |
|----------------------------------|---------------------------------------|
| 1. Battery Pack Unit | 6. Lock Release Buttons |
| 2. High Voltage Output Indicator | 7. Battery Slot |
| 3. Battery Level Indicators | 8. Power Cord |
| 4. Power Button | 9. Output Plug (Canon version shown)* |
| 5. Battery Holder | 10. Soft Case |

* Different version comes with different output plug; the plug shown in the above figure may be inconsistent with the actual plug of CB-12 you bought. For details, please refer to the description of Output Plug.

Installing the Batteries

1. Install batteries in accordance with the illustrated direction inside the battery slot.

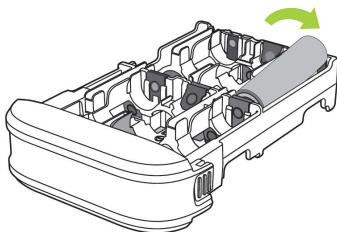

2. Install 12 batteries.

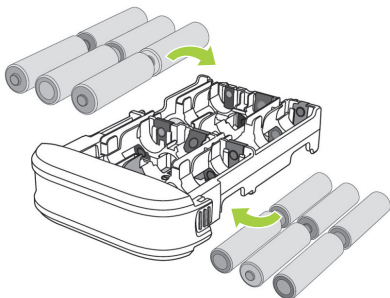

3. Push the battery holder into the unit until it stops with a click.

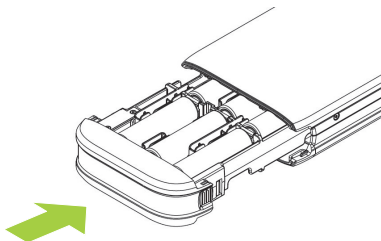

4. To remove the battery holder, slide the battery holder while pressing the lock release buttons at the edge of the battery holder.

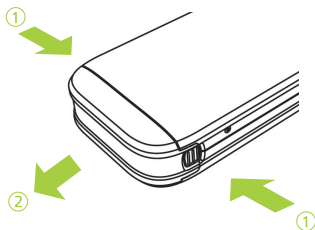

Precautions for Use

- If the battery contact shrapnel become soiled, remove dirt and smudges before use, as this may cause contact failure.
- Never reverse the polarity when installing batteries.
- Do not mix battery models or brands or use old with new batteries, replace all 12 batteries at the same time when replacing batteries.
- When working with an on-camera flash, please use AA-type Ni-MH rechargeable batteries or AA-type alkaline batteries.
- (Operating with other types of battery may cause a slow recycling and the CB-12 to be overheated easily.)
- When working with a high-powered flash, please use AA-type Ni-MH rechargeable batteries.
- (Operating with other types of battery may cause a slow recycling and the CB-12 to be overheated easily.)
- Remove the batteries when transporting the CB-12 or not using it for long periods.

Connecting the CB-12 to the Corresponding Flash

1. Install batteries for the flash.*
2. Plug the output plug of CB-12 into the corresponding flash's external power port.

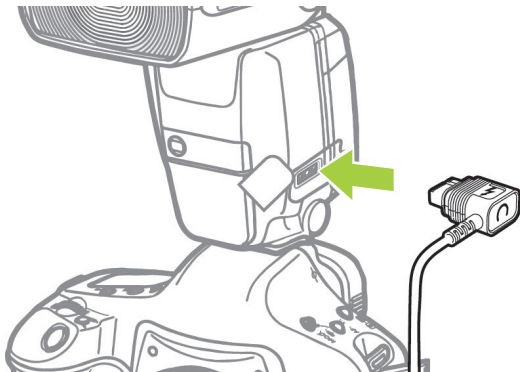

(Canon version shown)

3. Press and hold the power button for 2 seconds, the power level indicators will light red, the CB-12 is turned on.

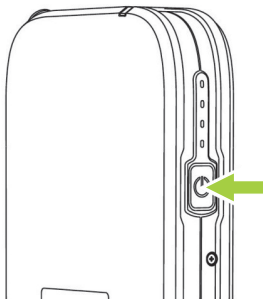

4. Turn on the power of the flash.
5. Set the flash custom function to choose external power as the power source.
(Some flash models come without the setting, but with auto recognition function.)
6. The high voltage output indicator on the CB-12 lights up; the CB-12 is now ready to power the flash.

* When CB-12 is working with a Canon® / Nikon® or Sony® flash, it only provides high voltage output when the flash is firing and doesn't power the flash's operation and display. So batteries are required in the flash itself, otherwise the flash will not work when connecting to CB-12.

Using with the Soft Case

1. Insert the CB-12 with batteries installed into the soft case.

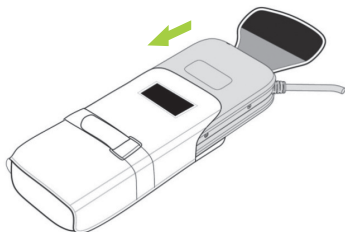

2. Close the cover.

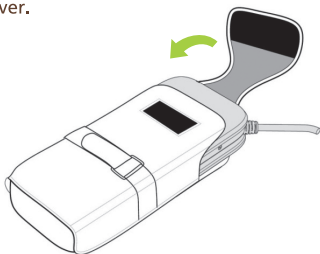



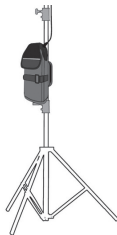
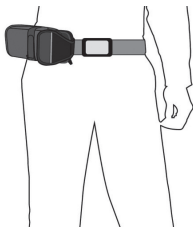
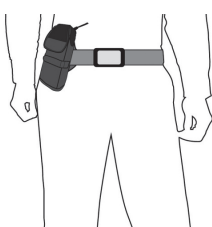



3. Tie up the soft case to the belt or light stand for convenient use.

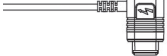

Output Plug and Compatibility

There are 4 versions for CB-12 according to its different output plug, please refer to following table for the corresponding plug of each version and the flash models it is compatible with.

Verison & Compatibility	Output Plug
CB-12 for Canon® 550EX/580EX/580EX II /600EX/600EX-RT/600EX II -RT Flashes	 
CB-12 for Nikon® SB5000/SB900/SB910 Flashes	 
CB-12 for Sony® HVL-F56AM/HVL-F58AM /HVL-F60M Flashes	 

Precaution for Use

Use only with the flash in brand and model listed in this manual. If there are other or third party products which fit the output plug of CB-12, do not connect to use as the input definitions of power port may vary depending on the manufacturer. Failure to observe this precaution could result in the CB-12 and its connected product to be unusable or damaged.

High Voltage Output Indicator

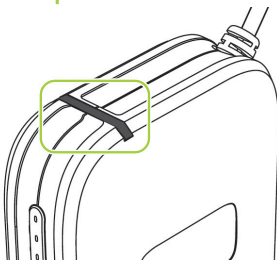

- **Light up:** The high voltage output is normal; the CB-12 is powering the connected flash.
- **Off:** There is no high voltage output; the CB-12 will turn off automatically after approx. 30 minutes.
- **Blinks continuously:** The protection is activated in the P 12, please stop using.

Power Button and Battery Level Indicators

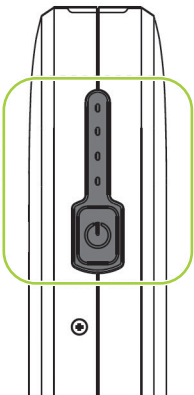

Power Button: Press and hold it for 2 seconds to turn on the P12; press and hold it for 2 seconds to turn off the P12.

Battery Level Indicators: There are 4 LEDs to indicate P12's current battery level as shown in following table.

The number of lighted up LED indicators	4	3	2	1	1 Blinking
Battery Level (%) (approx.)	100-80	79-60	59-40	39-20	19-10

- For reference only, the data is based on AA-type Ni-MH rechargeable batteries.
- Please replace to new batteries if 1 LED blinking.
- When the battery level is less than 10%, CB-12 stops output and turns off automatically. Please replace to new batteries.

Specifications

Major specifications when working with a variety of flashes

Batteries	Flash	Min. recycling time (approx)	Min. number of flashes (approx)
AA-type Ni-MH rechargeable battery ×12 (Panasonic® BK-3HCCA 1.2V 2450mAh)	Canon® 600EX II-RT	0.9 sec	900
	Nikon® SB-910	1.0 sec.	900
	Sony® HVL-F60M	1.0 sec.	900
AA-type alkaline battery ×12(Maxell® LR6(GD)1.5V)	Canon® 600EX II-RT	2.0 sec.	500
	Nikon® SB-910	1.8 sec.	500
	Sony® HVL-F60M	2.0 sec.	500

Notes

- Set the flash to full output. The interval between two flashes is 15 seconds.
- Use the same type of batteries with both the CB-12 and the flash.
- With fresh batteries at normal temperature (25°C). The performance may vary depending on the battery’s freshness or change of battery specifications.
- If the recycling time is longer, please check the battery level and see whether the batteries need to be replaced with fresh ones.

Dimensions(L × W × H): Approx. 86×195×33mm (3.4×7.7×1.3 in.)(Body Only)

Weight: Approx. 400g (14.1 oz)(without batteries)

Specifications and design are subject to change without notice.

Canon®, Nikon®, Sony®, Panasonic® and Maxell® mentioned in the manual are protected trademarks which do not belong to Green Extreme.

Troubleshooting

Having this problem?	Please check the following points
The unit cannot be turned on	<ul style="list-style-type: none">• Remove the Battery Holder, check whether the polarity of each battery is correct and whether there is any contact failure caused by soiled battery contact shrapnel.• When using non-rechargeable batteries, check whether one of or multi batteries' capacity has been depleted, which results in a high impedance state in the battery pack and the current conduction is blocked.
No power charging to the connected flash	<ul style="list-style-type: none">• Check whether the output plug is plugged in place.• Check whether the power of the flash itself is turned on.• Check whether external power has been chosen as the power source in the flash's custom function (if this option is available).• Check whether the protection is activated in the CB-12 (the High Voltage Output Indicator blinks continuously) or any protection is activated in the flash itself.



One Year Limited Warranty

Green Extreme warrants to the original purchaser that your Green Extreme product shall be free from defects in material and workmanship for the period of one(1) years from the date of purchase(or delivery as may be required in certain jurisdictions), or thirty(30) days after replacement, whichever comes later.

Green Extreme's entire liability and your exclusive remedy for any breach of warranty shall be, at Green Extreme's option, to repair or replace the hardware, provided that the hardware is returned to the point of purchase or such other place as Green Extreme may direct with a copy of the sales receipt or dated itemized receipt. Green Extreme may, at its option, replace your product, offer to provide a functionally equivalent product, or repair any product with new, refurbished or used parts as long as such parts are in compliance with the product's technical specifications. Any replacement hardware product will be warranted for the remainder of the original warranty period or thirty(30) days, whichever is longer, or for any additional period of time that may be applicable in your jurisdiction. If the product has been discontinued, the warranty provider reserves the right to replace it with a model of equivalent quality and function.

This warranty does not cover problems or damage resulting from accident, abuse, misapplication, or any unauthorized repair, modification or disassembly, improper operation or maintenance, normal wear and tear, or usage not in accordance with product instructions or connection to improper voltage supply, use of consumables, such as replacement batteries, not supplied by Green Extreme, except where such restriction is prohibited by applicable law.

Except where prohibited by applicable law, this warranty is nontransferable and is limited to the original purchaser and the country in which the product was purchased. This warranty gives you specific legal rights, and you may also have other rights, including a longer warranty duration that may vary under local laws.

To start a warranty claim contact the Green Extreme Customer Service Department to obtain a return merchandise authorization("RMA") number, and return the defective product to Green Extreme, along with the RMA number and proof of purchase.

Question about our product line? Need Product Support?

We are proud of our products and celebrate our customers. We are with you from product selection to everyday use. Be secure with your purchase and reach us as you need.

Email us: brands@adorama.com Call: 212-647-9300

Address: Adorama Brands, 42 West 18th Street, New York, NY 10011

You can always contact us at BRANDS@ADORAMA.COM for personal technical support. Our web site contains a wide range of Support and FAQ pages with valuable technical assistance.

Green Extreme is a registered trademark of ADORAMA CAMERA.

© 2016 Adorama Camera, Corp. All Rights Reserved.