

PT-ELITE-PRO

QUICKSTART GUIDE

Elite Universal Large Tablet, Surface Pro, & iPad Pro Teleprompter



What's Included

- ☐ 1 x Glass Assembly
- ☐ 1 x Magnetic Hood
- ☐ 2 x 12-Inch Rods
- ☐ 1 x Baseplate Assembly
- ☐ 1 x Large Tablet Holder
- ☐ 1 x Large Tablet Holder Extension Mount & D-Ring

ikan

www.ikancorp.com

support@ikancorp.com

713.272.8822

© 2016 ikan Corporation. All rights Reserved

PT-ELITE-PRO

What's Included

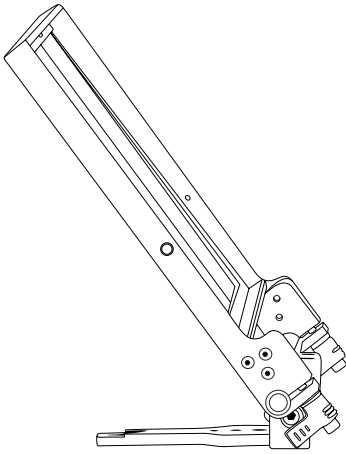

☐ Glass Frame Assembly

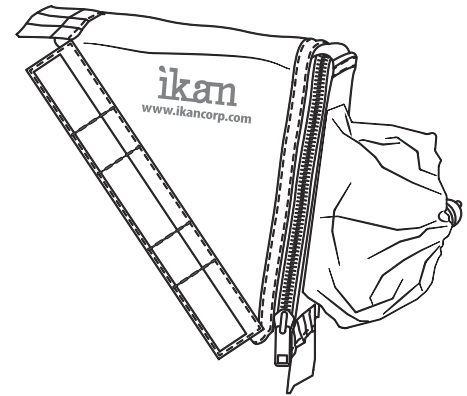

☐ Magnetic Sunhood

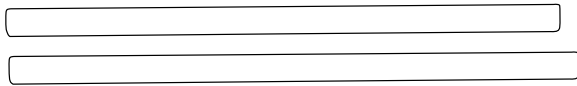

☐ 2 x 12-Inch Rods

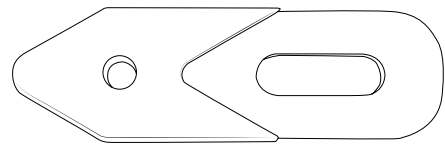

☐ Large Tablet Holder Extension & D-Ring

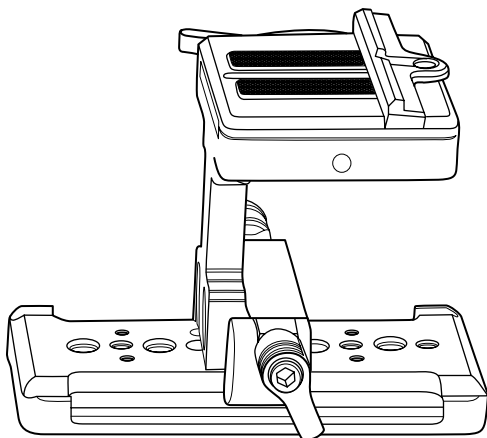

☐ Baseplate Assembly

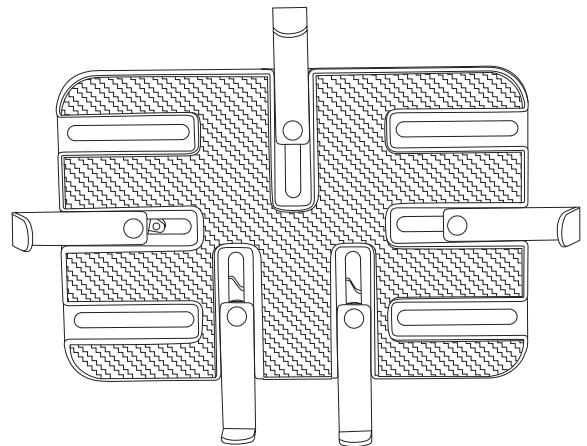

☐ Tablet Holder

PT-ELITE-PRO

How to Assemble

1. Attach tablet mount to glass frame assembly. **Figures 1a, 1b, 1c.**

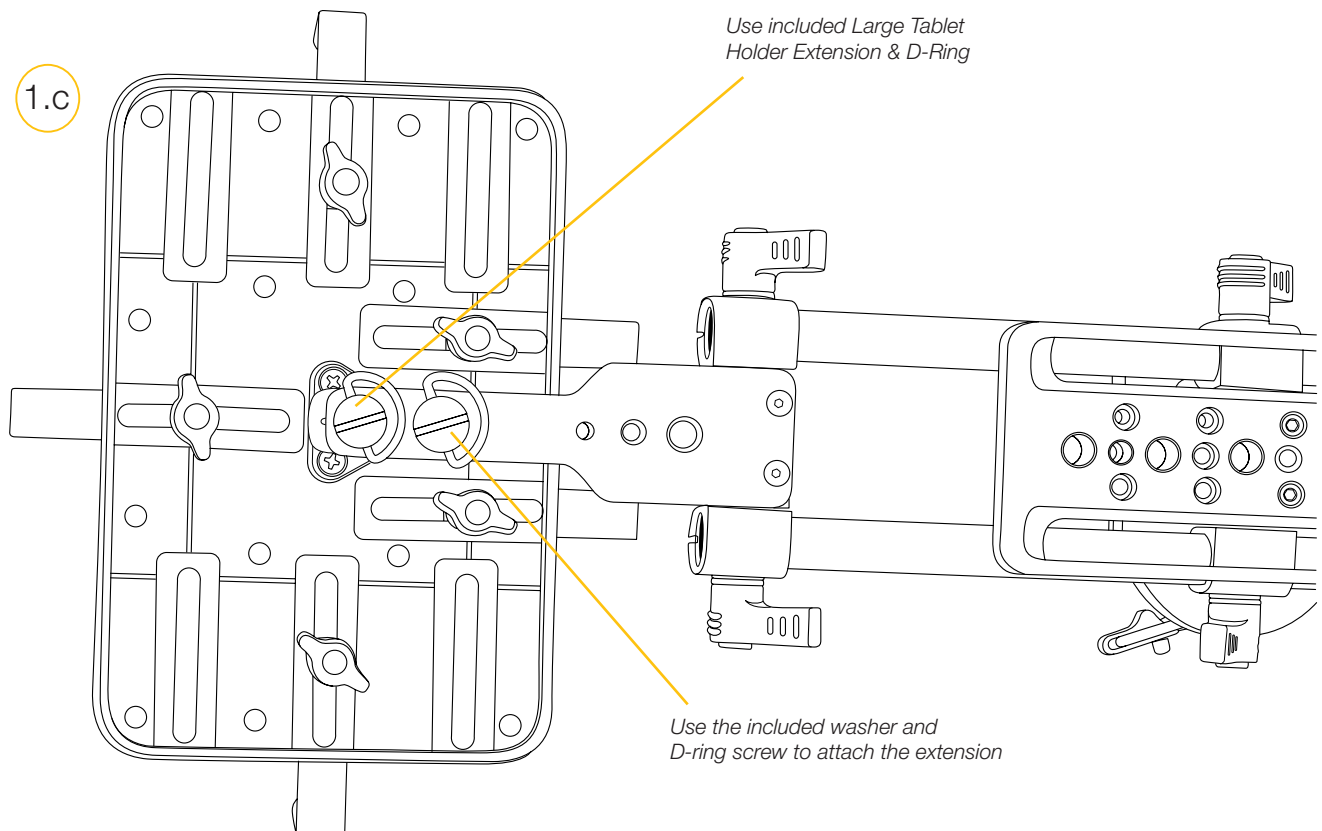
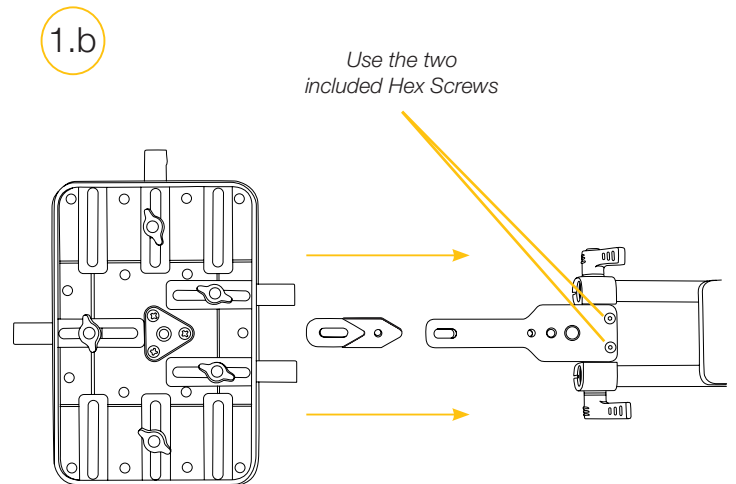
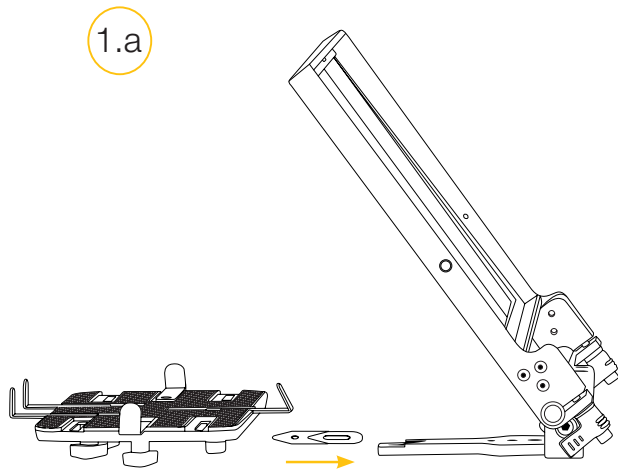

PT-ELITE-PRO

2. Insert rods into rail mount on glass frame assembly.
3. Slide baseplate onto rods.
4. Adjust spacing for your camera.
5. Tighten & loosen thumb screws to adjust glass frame. *Ideal angle is 45 degrees.*

NOTE: Glass can be removed by unscrewing the three (3) screws around glass frame.

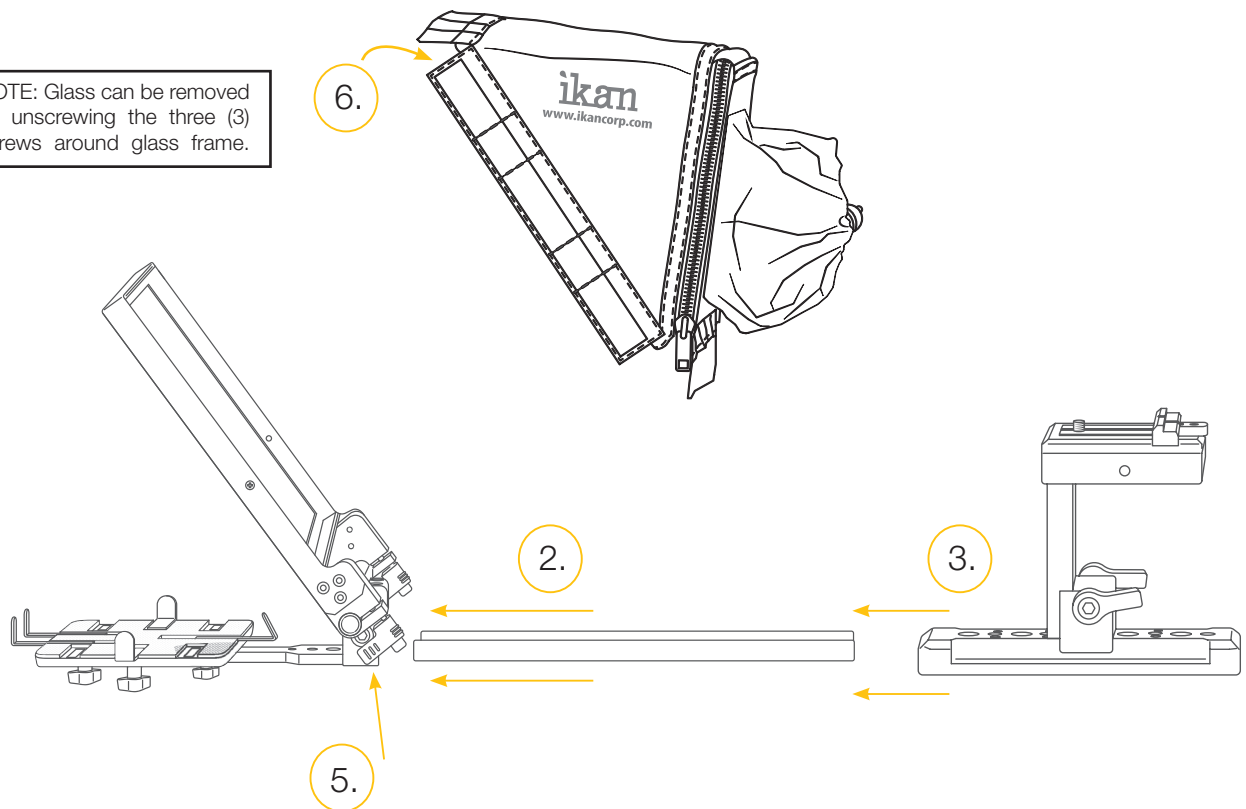

6. Attach magnetic hood to glass frame.
7. Remove quick release plate & attach your camera. Reattach.

DO NOT THROW AWAY FOAM INSERT.

8. The PT-ELITE-PRO comes packaged in high quality custom-cut foam. It is sized perfectly to fit inside an SKB-i Series 1914-8 waterproof case.

Software Options

Windows: Choose from PrompterPro from Ikan, or from multiple third party options in the Windows Store or on the Web.

iOS: Download Ikan Elite Prompter App from App Store

Android: Choose from multiple 3rd party options on Google Play Store

Learn More

More dynamic information at official website: www.ikancorp.com

Support

Contact email: support@ikancorp.com

Conditions of warranty service

Free service for one year from the day of purchase if the problem is caused by manufacturing errors.

- The components and maintenance service fee will be charged if the warranty period is expired.

Free Service will not be Provided in the Following Situations: (*Even if the product is still within the warranty period.)

- Damage caused by abuse or misuse, dismantling, or changes to the product not made by the company.
- Damage caused by natural disaster, abnormal voltage, and environmental factors, etc.



Quick Start Guide

ELITE-REMOTE



Quick Start Guide

Thank you for purchasing the ELITE-REMOTE – Bluetooth iPad teleprompter remote. Please follow these simple instructions to get started.

Downloading Compatible Apps

1. Go to the App Store on your tablet



2. Locate the search bar at the top right corner and key in the name of one of our compatible apps.



Teleprompter Premium



Teleprompt+ 3

3. Select the app and install it.

Inserting battery into ELITE-REMOTE

1. Remove the cover on the back of the remote
2. Insert 2 AAA batteries into the battery compartment
3. Re-install the battery cover

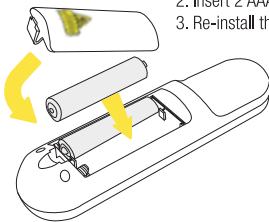

Syncing ELITE-REMOTE to your iPad

1. Go to the "Settings" app on your iPad
2. Select the Bluetooth tab on the left side and confirm the Bluetooth option is on (switch will toggle green).
3. Turn on the remote by inserting 2 AAA batteries into the battery compartment. A red light should blink momentarily on the front side of the remote.

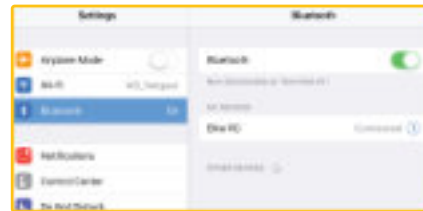

4. Press and hold the "Rewind & Forward" buttons (above the "Laser Pointer Button") for 3 seconds to sync the remote. A blue light should blink momentarily on the front side of the remote.
5. The words "Elite RC" should appear on your iPad. Select it.
6. Once connection between the iPad and the remote has been established, the status message next to "Elite RC" should change to Connected.

Re-establishing connection with your iPad

Once you sync your iPad and ELITE-REMOTE, your iPad will always remember the ELITE-REMOTE. To re-establish connection, simply turn on the remote, press any button, and wait a few seconds. The remote will automatically re-establish connection with your iPad.

Troubleshooting

If you have any issues with the ELITE-REMOTE, please call us at 1.713.272.8822 Monday through Friday 9:00 am to 6:00 pm CST. Or you can email us at support@ikancorp.com.

Ikan International 2022. All Rights Reserved.



Controlling your iPad with ELITE-REMOTE

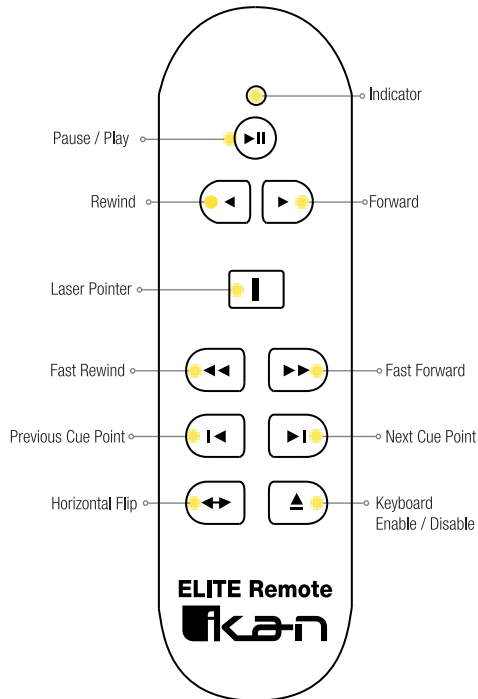

PrompterPro4 Control

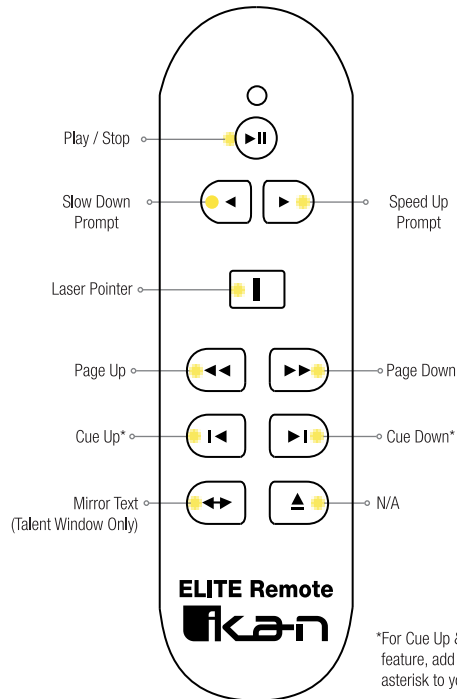

*For Cue Up & Down feature, add an asterisk to your script