

plustek

Scanner User's Guide

OpticFilm 8300i

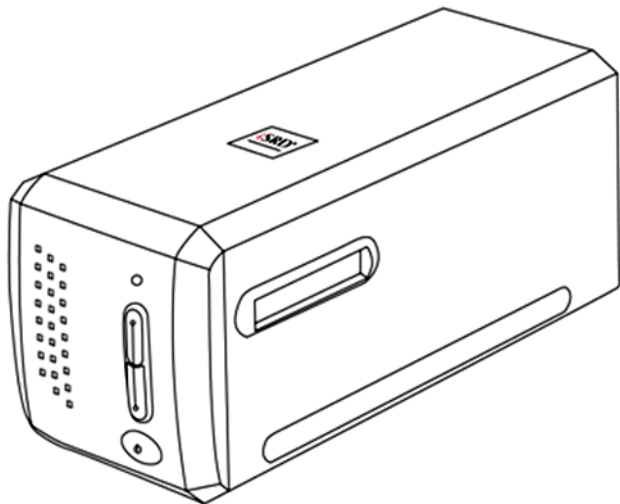

Trademarks

© 2025 Plustek Inc. All rights are reserved. No portion of this document may be reproduced without permission.

All trademarks and brand names mentioned in this publication are property of their respective owners.

Liability

While all efforts have been made to ensure the accuracy of all contents in this manual, we assume no liability for errors or omissions or by statements of any kind in this manual, whether such errors are omissions or statements resulting from negligence, accidents, or any other cause. The contents of this manual are subject to change without notice. We will not shoulder any legal liability, if users failed to follow the operation instructions in this manual.

Copyright

The scanning of certain documents, for example checks, bank notes, I.D. cards, government bonds, or public documents, may be prohibited by law and/or subject to criminal prosecution. We recommend you to be responsible and respectful of the copyrights laws when you are scanning books, magazines, journals and other materials.

Environmental Information

Recycle or disposal at end-of-life information, please ask local distributors or suppliers for recycle and disposal information. The product is designed and produced to achieve sustainable environmental improvement. We strive to produce products in compliance with global environmental standards. Please consult your local authorities for proper disposal.

The product packaging is recyclable.

Attention for recycling (For EU country only)

Protect your environment! This product should not be thrown into the household waste container. Please give it to the free collecting center in your community.

Table of Contents

INTRODUCTION	1
A NOTE ABOUT ICONS	1
SAFETY PRECAUTIONS	2
MAINTENANCE.....	3
PRODUCT OVERVIEW	4
BOX CONTENTS	4
SCANNER OVERVIEW	5
BEFORE INSTALLING THE SCANNER	6
CONNECTING THE SCANNER TO YOUR COMPUTER.....	6
INSTALLING THE SCANNER	7
INSTALLING SCANNER DRIVER	8
POWER ON THE SCANNER.....	9
FILM HOLDERS	10
MOUNTED SLIDE HOLDER	11
USING FILMSTRIP HOLDER.....	12
INSERT THE FILM HOLDER.....	13
SCAN WITH QUICKSCAN PLUS APPLICATION	14
THE MAIN SCREEN.....	15
THE [SCAN] SCREEN	16
THE [VIEW] SCREEN	18
THE [EDIT] SCREEN	20
[PREFERENCE] SETTINGS	22
SILVERFAST SOFTWARE	25
REQUEST FOR SILVERFAST LICENSE.....	26
INSTALLING SILVERFAST SOFTWARE.....	29
SCAN WITH THE SILVERFAST APPLICATION.....	31
OPERATING THE SCANNER	32
❶ USING [INTELLISCAN] BUTTON.....	33
❷ USING [QUICKSCAN] BUTTON	34
APPENDIX A: TROUBLESHOOTING	35
SCANNER CONNECTION	35
SCANNING PROBLEMS	36
APPENDIX B: SPECIFICATIONS	39
APPENDIX C: CUSTOMER SERVICE AND WARRANTY	41
SERVICE & SUPPORT INFORMATION (FOR EU COUNTRY ONLY)	41
STATEMENT OF LIMITED WARRANTY	41
FCC RADIO FREQUENCY STATEMENT.....	43

Introduction

Welcome to the world of Plustek scanners – the ultimate in computer imaging. Your new scanner will improve the professionalism of your day-to-day computing tasks by allowing you to input images into your computer system.

Like all of our products, your new scanner is thoroughly tested and backed by our reputation for unsurpassed dependability and customer satisfaction.

Thank you for choosing us as your scanner supplier. We hope you will continue to turn to us for additional quality products as your computing needs and interests grow.

A Note about Icons

This guide uses the following icons to point out information that deserves special attention.

Danger	Danger: A procedure that must be followed carefully to prevent injury, or accidents.
Caution	Caution: Information that, if not followed, may result in data loss or damage to the product.
Attention	Pay Special Attention: Instructions that are important to remember and may prevent mistakes.

Safety Precautions

Before using this device, please read the following important information to eliminate or reduce any possibility of causing damage and personal injury.

1. Usage, the product is for indoor use in dry locations. Moisture condensation may occur inside this device and cause malfunction at these conditions:
 - when this device is moved directly from a cold to a warm location;
 - after a cold room is heated;
 - when this device is placed in a damp room.

To avoid the moisture condensation, you are recommended to follow the procedure:

- i. Seal this device in a plastic bag for it to adapt to room conditions.
 - ii. Wait for 1-2 hours before removing this device from the bag.
2. Do not use the power adapter and USB cable provided with the scanner. Use of other power adapter and cables may lead to malfunction.
3. Keep the space around the AC adapter clear in case you need to quickly unplug the AC adapter during emergencies.
4. Damaged wire could cause fire or electrical shock. Keep the power cord straight and without being twisted, bended, or scraped.
5. Unplug this device if you don't need to use for a certain period of time, such as, during night or long weekend, to avoid any risks of causing fire.
6. Do not attempt to disassemble the scanner. There is danger of an electrical shock and opening your scanner will void your warranty.
7. Be sure not to bump or knock the scanner as it is fragile and could break.
8. Before installing the device drivers, please disconnect all other imaging devices (other scanners, printers, digital cameras, web cameras) from the PC.
9. Save the Setup/Application USB stick. You may need to reinstall the driver and software in the future.
10. Please make sure your hands are clean before handling slides and negatives. If there is dust on your film material, please clean it by blowing it off or wiping with non-abrasive cloth.
11. Please keep your slides and negatives in a cool, dry place out of direct sunlight. Handle with care as improper storage and handling can lead to deterioration and ultimately affect your scan results.

Maintenance

Caution

To keep your scanner working smoothly, take a moment to review the following maintenance tips.

- Avoid using the scanner in a dusty environment. When it is not in use, keep the scanner covered. Dust particles and other foreign objects may damage the unit.
- Do not attempt to disassemble the scanner. There is danger of an electrical shock and opening your scanner will void your warranty.
- Do not subject the scanner to excessive vibration. It may damage the internal components.
- Your scanner operates best in temperatures between 10° C to 40° C (50° F to 104° F).

Product Overview

Box Contents¹

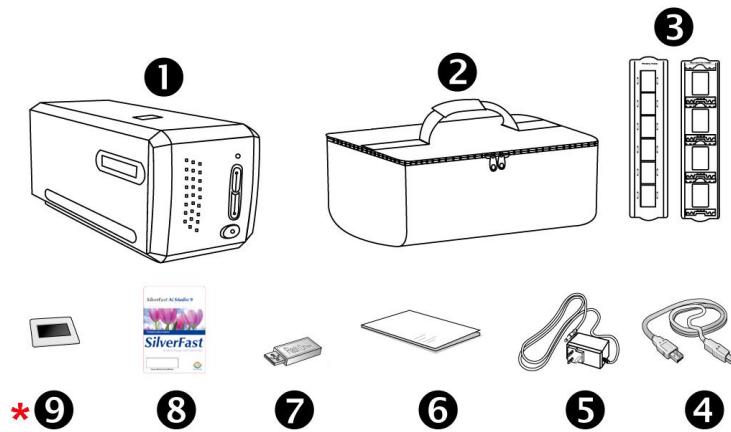

- ❶ Scanner
- ❷ Padded carrying bag
- ❸ Mounted Slide Holder and Filmstrip Holder
- ❹ USB Cable
- ❺ Power Adapter
- ❻ Quick Guide
- ❼ Setup / Application USB stick
- ❽ Activation card
- * ❾ 35 mm IT-8 Target (35 mm IT-8 Target is not included in all scanner models)

Attention

You may find the scanner hardware serial number on the activation card, please keep the card in a safe place.



¹ Save the box and packing materials in case you need to transport this scanner in the future.

Box contents may change at any time without prior notice.

Scanner Overview

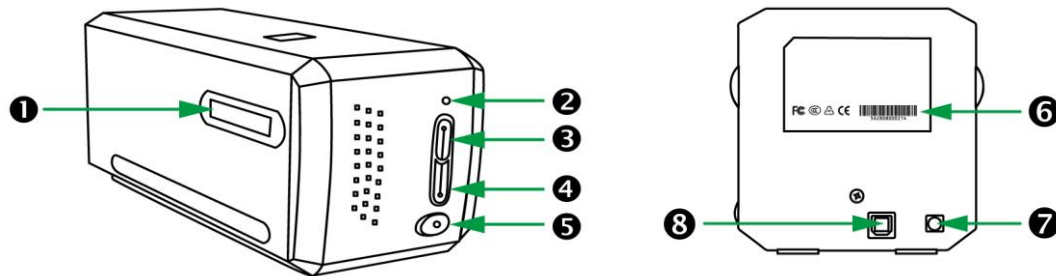

- ❶ **Film Holder Slot:** Insert the film holder into the scanner through dust cover. The film holder can be inserted from either side. The film holder will index at each frame using the notches on its side rails.
- ❷ **Power LED:** It indicates the scanner status.

Light	Status
On	The scanner is turned on, ready to scan images.
Off	The scanner is off, either because the power is not turned on, or because the power cord is not properly plugged into an AC power outlet.

- ❸ **IntelliScan Button:** You may press the button to launch the SilverFast application.
- ❹ **QuickScan Button:** You may press the button to launch the QuickScan Plus application.
- ❺ **Power Button:** Use this to turn the scanner ON or OFF.
- ❻ **Serial Number Sticker:** Located at the rear of the scanner.
- ❼ **Power Receptor**
- ❽ **USB Port**

Attention

You will need the **15 digits Serial Number** for SilverFast software activation. You will also need it when you contact your dealer or our service center in the future.

Before Installing the Scanner

Connecting the Scanner to Your Computer

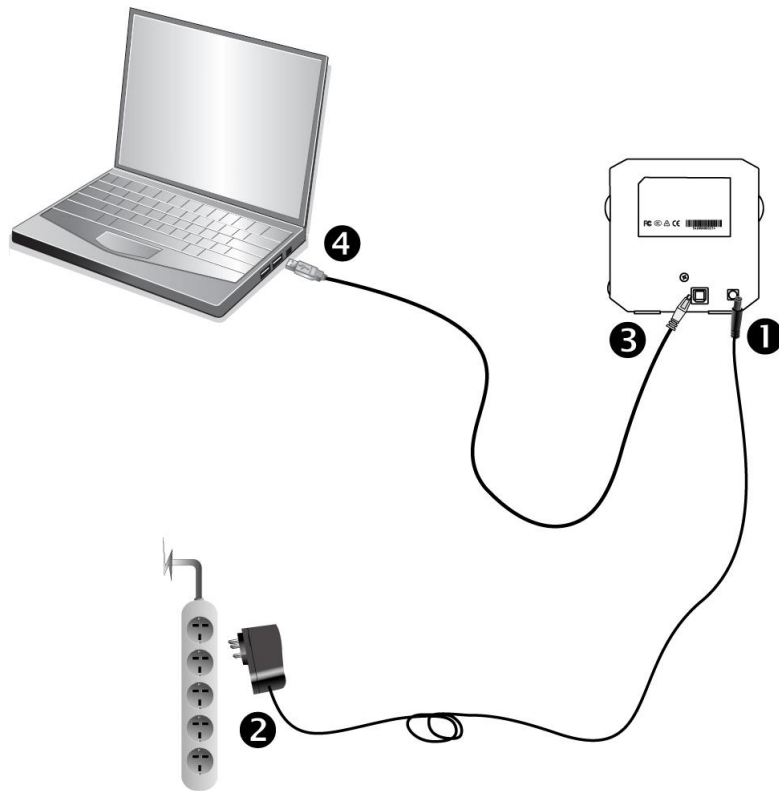

- ❶ Plug the power adapter into the scanner's power receptor.
- ❷ Plug the other end of the power adapter into a standard AC power outlet.
- ❸ Plug the square end of the included USB cable to the USB port at the rear of the scanner.
- ❹ Plug the rectangular end of the USB cable to the USB port on the back of your computer.

Note: If there is another USB device connected to the computer, connect the scanner to an available USB port.

Attention

Please **DO NOT** power on the scanner now.

Installing the Scanner

Please follow the step-by-step procedures described below to install the USB scanner.

*You may find the latest driver on our official website www.plustek.com -> Support & Download -> Drivers and Downloads

- [Installing Scanner Driver](#)
- [Power on the Scanner](#)

Installing Scanner Driver

1. Insert the Setup / Application USB stick into your computer.
2. Install the scanner driver by the following path:
Mac OS X: **OPTICFILM > Mac > Plustek OpticFilm 8300i > Setup.dmg**
Windows OS: **OPTICFILM > Windows > Plustek OpticFilm 8300i > Setup.exe**

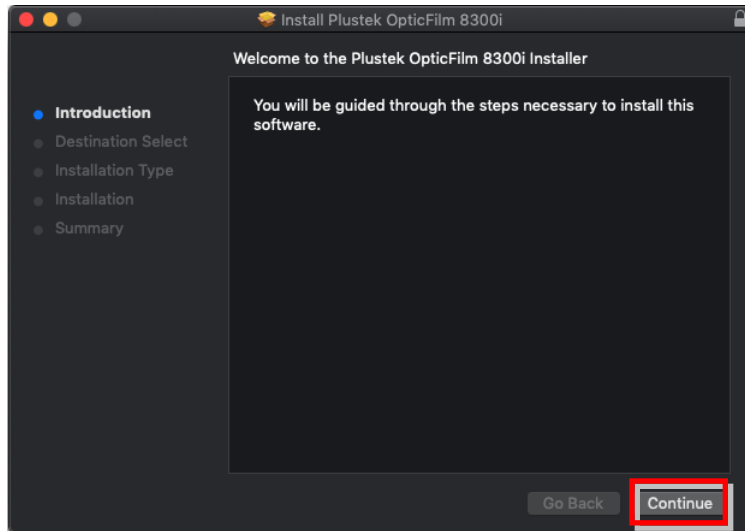

3. Follow the on-screen instructions to complete the installation.

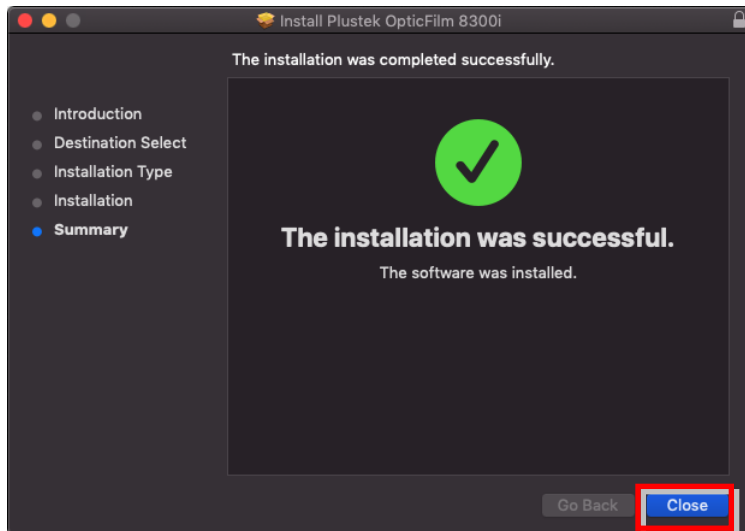

Attention

You may download the latest version driver from our official website plustek.com/of8300i.

Power on the Scanner

Press the Power button to turn the scanner ON.

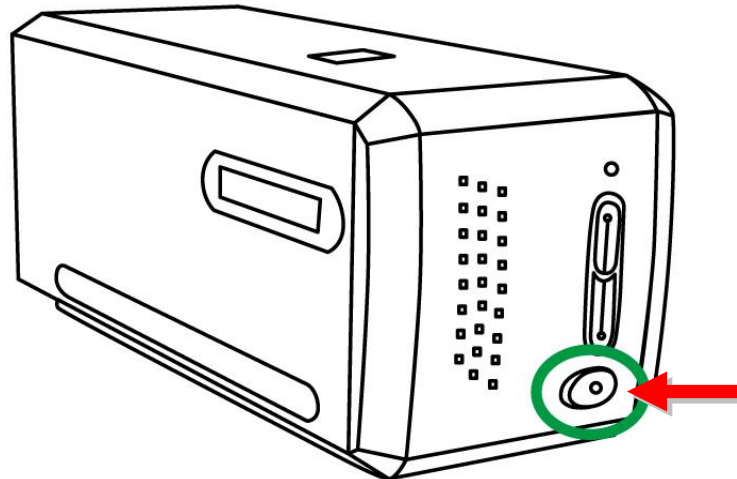

Attention

Press the Power button again to turn the scanner OFF.

Film Holders

Two film holders are included in the package. They guarantee correct scanning results.

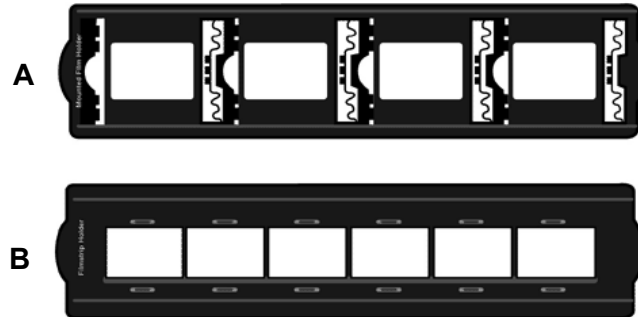

- A. For scanning 35mm mounted slides (max. 4 slides)
- B. For scanning 35mm filmstrips (max. 6 frames)

- [Using Mounted Slide Holder](#)
- [Using filmstrip holder](#)
- [Insert the Film Holder](#)

Mounted Slide Holder

Insert mounted slides into slots with emulsion (non-glossy) side down.

There are arrows and illustrations on the frame of each slot. Please follow illustrations to insert mounted slides.

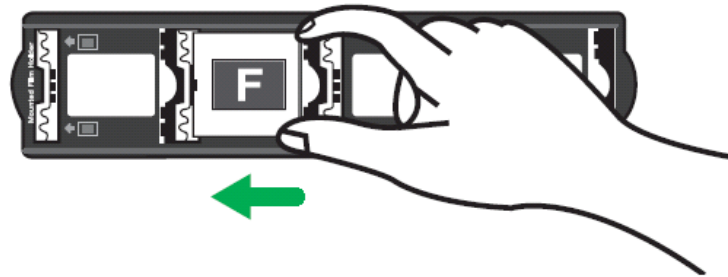

Using filmstrip holder

Place filmstrip in the film holder with emulsion (non-glossy) side down, then snap the film holder cover closed.

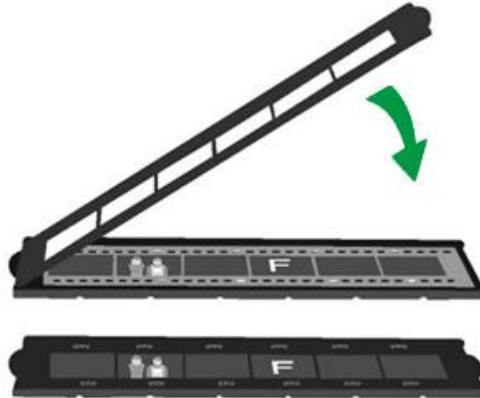

- For correct scan results, always turn the film with the top of the image facing towards the back of the scanner (where power cord and USB cord are located) and keep emulsion (non-glossy) side down.
- There is text on the top and bottom of the film, such as manufacturer, frame numbers, film codes, batch numbers...etc. With the film oriented correctly as described above, this text should be read clearly (i.e., not backwards or up-side-down).

Attention

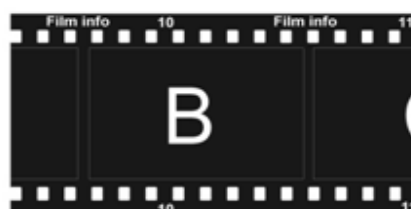

Insert the Film Holder

Insert the film holder into the scanner through dust cover. The film holder can be inserted from either side. The film holder will index at each frame using the notches on its side rails.

Please allow about 40 cm of space on both sides of the scanner to insert and remove the film holder.



Attention

- You can feel the film holder stop in its index position. However, before performing scan, please gently push and pull the film holder to make sure the film holder is in correct position.
- On up side of the film holder you can see 'Mounted Slide Holder' or 'Filmstrip Holder'. Always keep this side up for correct scan results.



- The film holder should be able to be inserted in to the scanner smoothly. Do not push the film holder hard.

Scan with QuickScan Plus Application

Launch QuickScan Plus using the QuickScan Plus shortcut on your Desktop. Adjust the scan settings. Please refer to the QuickScan Plus on-line help for more information about available scan settings.

Mac OS X



Windows OS



The Main Screen

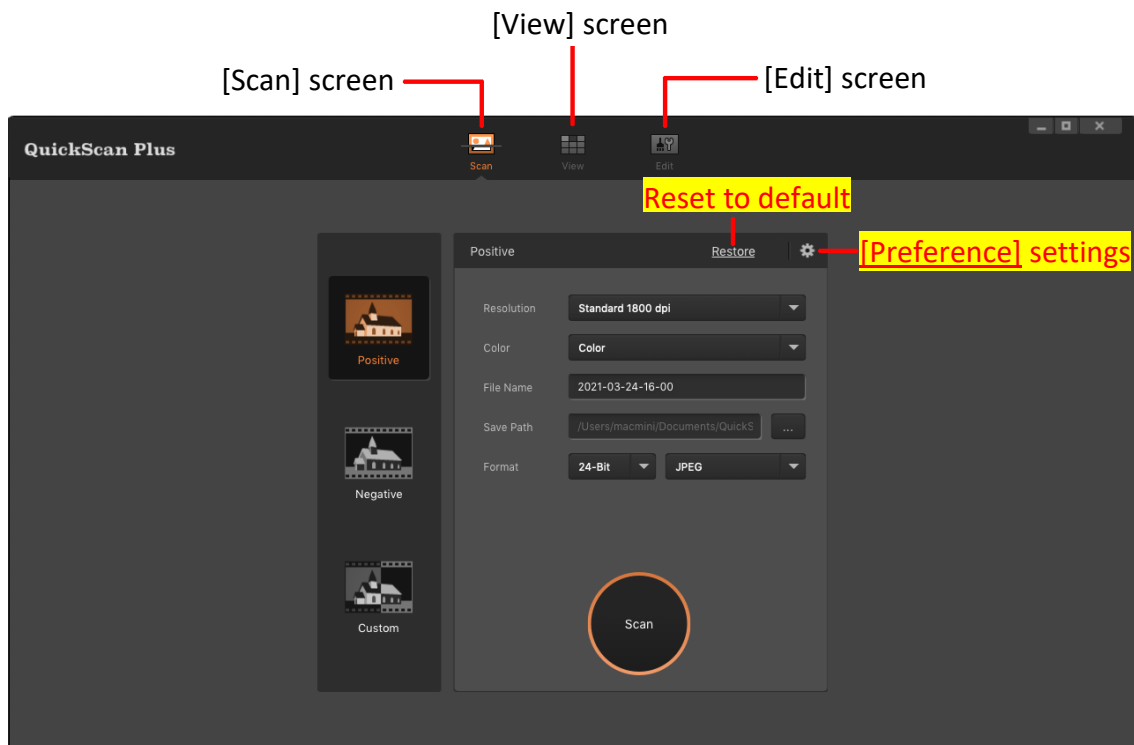

The user interface contains the following components:

- The [\[Scan\]](#) screen: The **[Scan]** screen is where you set your scanning parameters.
- The [\[View\]](#) screen: The **[View]** screen is where you select one or multiple images to edit, share or delete.
- The [\[Edit\]](#) screen: The **[Edit]** screen is where you can apply various filter effects and make more detailed adjustments to your images.

The [Scan] Screen

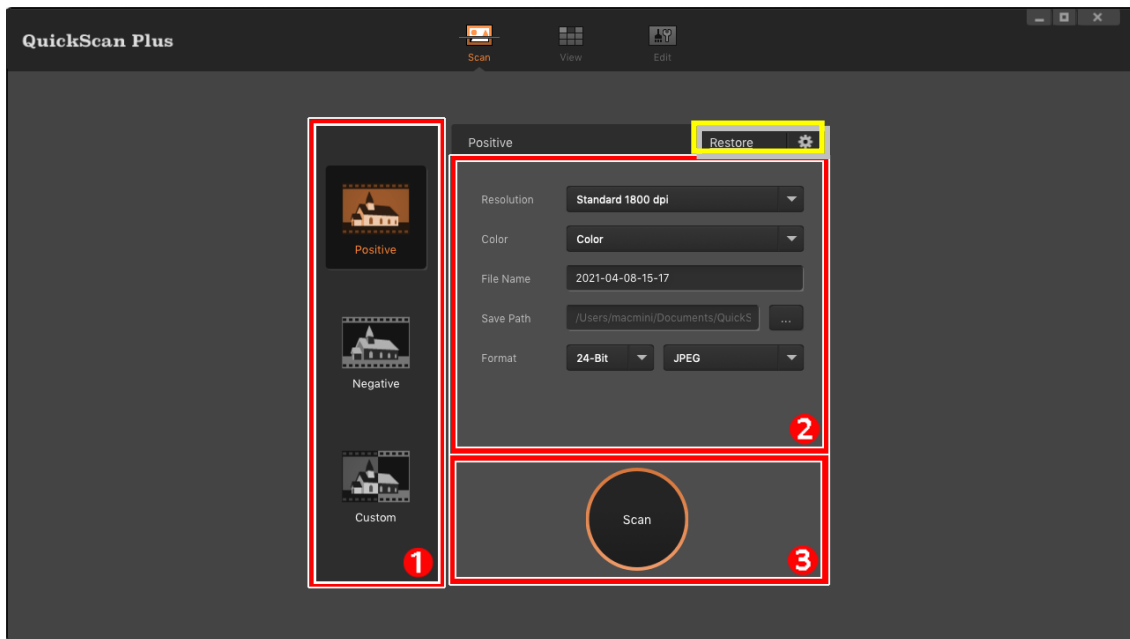

The [Scan] screen is where you set your scanning parameters. These scanning parameters will also be used when you initiate a scan using the physical button on your scanner.

1 Scan mode

Selected by clicking on the respective button on the left side, you can choose between [Positive], [Negative] and [Custom]. Basically this allows you to create 3 scan profiles; one for positives, one for negatives and one for either positives or negatives.

Attention	<p>You may click [Restore] button to reset all settings to default.</p> <p>Click on  button to access online help and adjust Preference settings.</p>
------------------	--

2 Scan settings

- [Resolution]: Select a desired resolution from the drop-down list. The higher the resolution, the more detailed the scan and the resulting file will be.

Resolution	Windows & Mac
7200 dpi	Approx. 9000 x 6200 dots
3600 dpi	Approx. 4500 x 3100 dots
2400 dpi	Approx. 3000 x 2000 dots
1800 dpi	Approx. 2250 x 1500 dots
1200 dpi	Approx. 1500 x 1000 dots
600 dpi	Approx. 750 x 500 dots

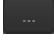
- **[Color]**: Select a desired color mode from the drop-down list.
- **[File name]**: Enter the desired file name into the field. The default uses your computer's date and time.
- **[Save path]**: Click on the **[Browse]** button  and use the dialog to select the folder where you wish to store your scanned images.

The default saving path:

Mac OS X: **Users > UserName > Document > QuickScanPlus_Doc.**

Windows OS: **Users > Public > Pictures > Plustek Photo.**

- **[Format]**: Select the desired bit rate and file format you wish to use from the drop-down lists. The higher the bit rate, the more detailed the scan and the larger the resulting file will be. Available format options are: **JPEG, TIFF, PNG, Windows Bitmap.**
*If you select 48-bit, the output format can only be **TIFF.**
- **[Film]** (Custom mode only): Select the desired film type from the drop-down list.

③ Scan button

Insert your film tray and click on the **[Scan]** button when you are ready to scan.

The [View] Screen

After the scan is completed, the [View] screen will be shown. You may click [ Scan] button to scan more images.

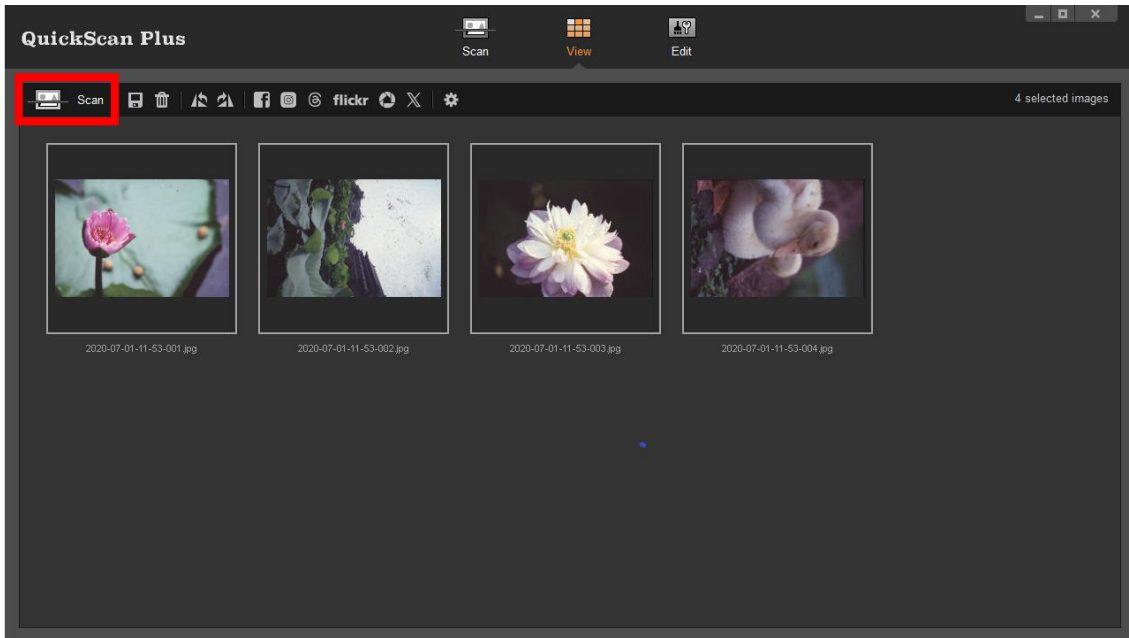









Attention

You may select one or multiple images to delete, rotate or share at the same time. Selected images will be highlighted with a gray rectangle around the images. Simply click an image to remove a picture from your selection.

Click on the [ Save] button, your images are already saved and can be found in the folder you set under [Save path] on the [Scan] screen.

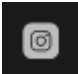
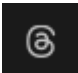
Other function buttons on the toolbar are as following:

-  **Delete:** Click on this button to delete the selected images.
-  **Rotate counterclockwise:** Click on this button to rotate the selected images in a counterclockwise direction.
-  **Rotate clockwise:** Click on this button to rotate the selected images in a clockwise direction.

-  **Share to Facebook:** Click this button to open the Facebook website and proceed with login or access.
-  **Share to Instagram:** Click this button to open the Instagram website and proceed with login or access.
-  **Share to Threads:** Click this button to open the Threads website and proceed with login or access.
-  **Share to flickr:** Click this button to open the flickr website and proceed with login or access.
-  **Share to Google Drive:** Click this button to open the Google Drive website and proceed with login or access.
-  **Share to X:** Click this button to open the X website and proceed with login or access.
-  **Help & Tools:** Click on this button to open a context menu with the following items:
 - [Help]: Select this item to launch the on-line help file.
 - [Preference]: Select this item to open the [\[Preference\]](#) dialog.
 - [About]: Select this item to open the program information dialog.





The [Edit] Screen

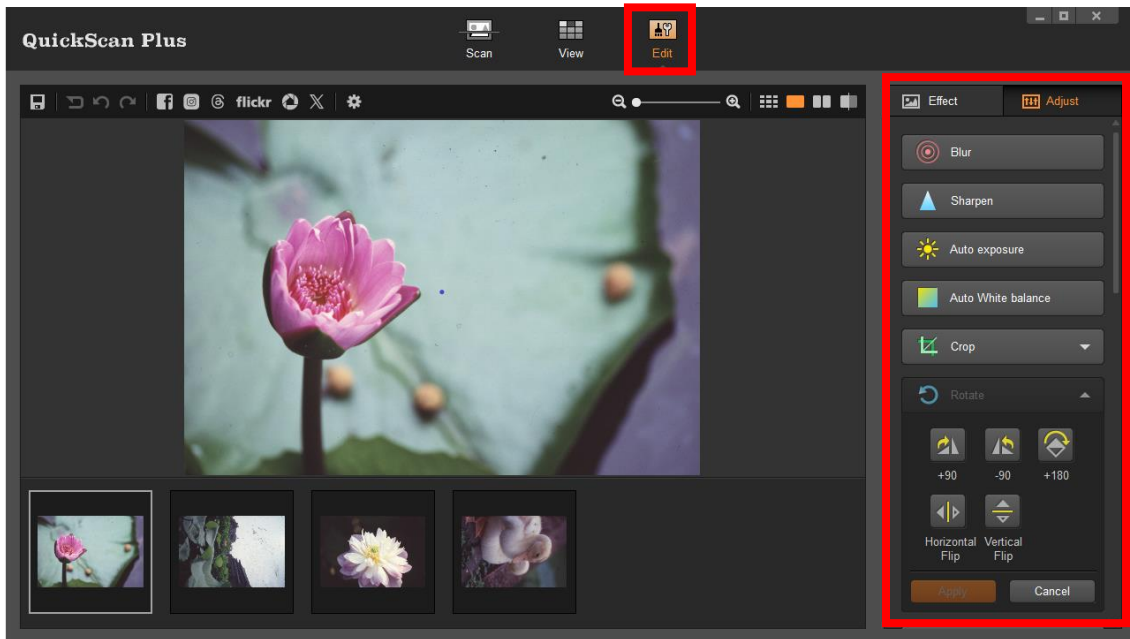





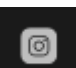

The **Edit** screen is where you can apply various filter effects and make more detailed adjustments to your images.

Click on the [**Edit**] button above the frames to switch to the [**Edit**] screen to apply various filter effects and make more detailed adjustments to your images.

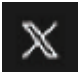
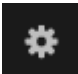

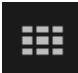
Function buttons on the toolbar are as following:

-  **Save:** Click on this button to save any changes you have made to the selected images.
-  **Reset:** Click on this button to reset the selected image to their original state.
-  **Undo:** Click on this button to undo the last effect or adjustment.
-  **Redo:** Click on this button to redo the last effect or adjustment.
-  **Share to Facebook:** Click this button to open the Facebook website and proceed with login or access.
-  **Share to Instagram:** Click this button to open the Instagram website and proceed with login or access.

-  **Share to Threads:** Click this button to open the Threads website and proceed with login or access.
-  **Share to flickr:** Click this button to open the flickr website and proceed with login or access.
-  **Share to Google Drive:** Click this button to open the Google Drive website and proceed with login or access.
-  **Share to X:** Click this button to open the X website and proceed with login or access.
-  **Help & Tools:** Click on this button to open a context menu with the following items:
 - [Help]: Select this item to launch the on-line help file.
 - [Preference]: Select this item to open the [\[Preference\]](#) dialog.
 - [About]: Select this item to open the program information dialog.
-  **Zoom out:** Click this button to zoom out of the currently selected image. You can also use mouse wheel down to perform the same action.
-  **Zoom in:** Click this button to zoom in on the currently selected image. You can also use mouse wheel up to perform the same action.
-  **Edit multiple:** Click on this button to switch to the multi-view mode.
-  **Edit single:** Click on this button to switch to the single-view mode.
-  **Dual-view:** Click on this button to switch to the dual-view mode.
-  **Midline:** Click on this button to switch to the midline-view mode.

[Preference] Settings

Click on  button and select [Preference] to open the [Preference] settings dialog.

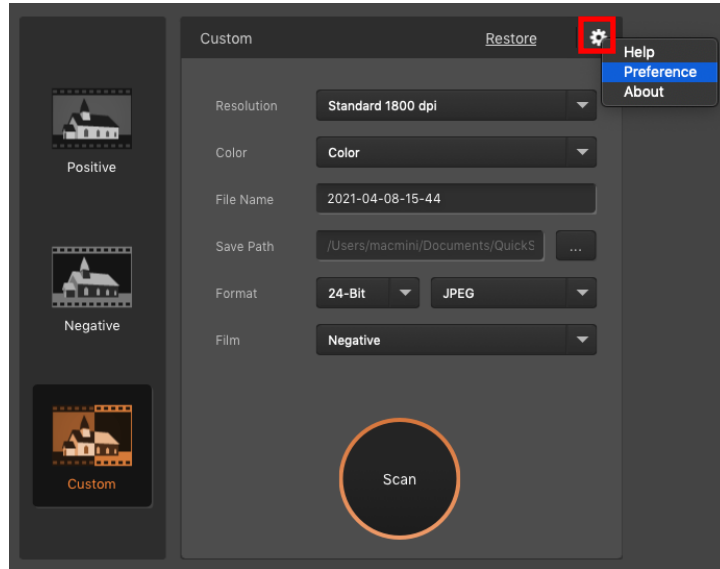

You may also find this  button on [View] screen and [Edit] screen.

[View] screen

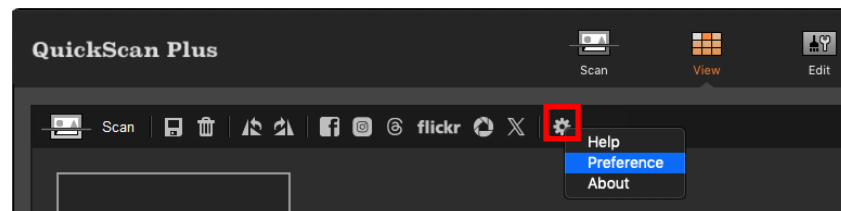

[Edit] screen

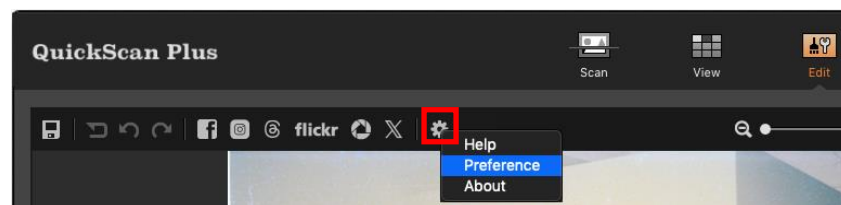

Attention

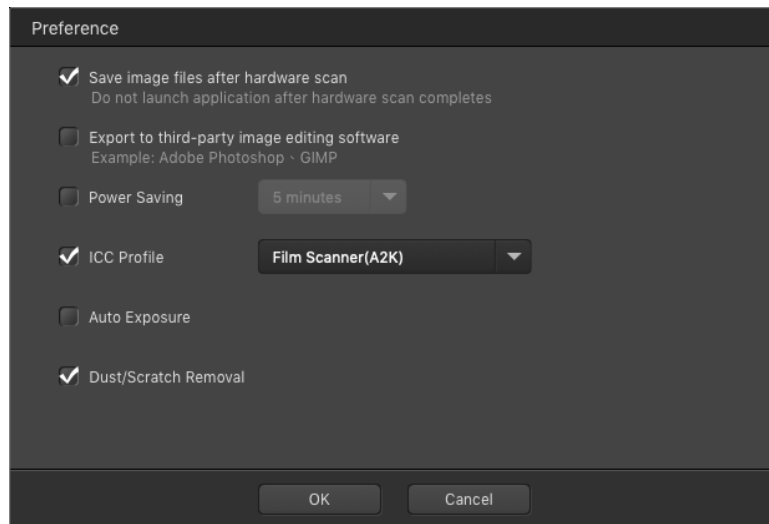

- **[Save image files after hardware scan]:** Activate this checkbox, you may press **[QuickScan]** button on the scanner panel to perform **[Custom]** scan directly. Please adjust **[Custom]** mode scan settings, especially the **[Film]** type setting before scanning.
- **[Export to third-party image editing software]:** Activate this checkbox to export the scanned images to third-party image editing software for further editing. The scanned images will be opened directly on third-party image editing software.

Note: The negative film scanned images will be exported to third-party image editing software without any image processing.

If you activate this checkbox, the main window will appear as following:

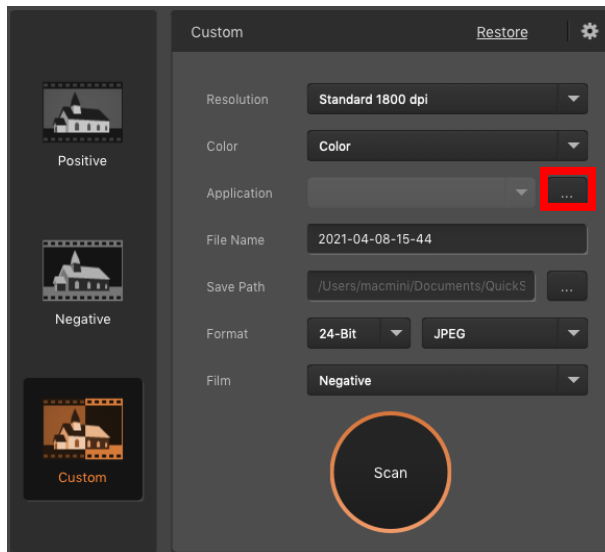

Attention

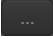
Click the  button to add desired applications, for example: Photoshop, GIMP. You may add up to 5 applications.

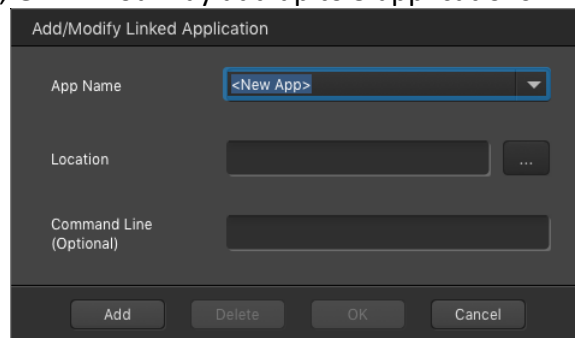

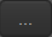
- **[App Name]:** Enter the application name.
- **[App Location]:** Click on the  button to browse to the desired program folder and select the executable file (*.exe) of the desired application.
- **[Command Line (Optional)]:** It is recommended that you leave this field blank if you will not use or are unsure of the command line.

- **[Power Saving]:** Activate this checkbox and select a value from the drop-down list to set when the scanner will enter power saving mode. Simply press on any of the scanner 's physical buttons to wake it.
- **[ICC Profile]:** Activate this checkbox and select a profile from the drop-down list to set device output color standard.
- **[Auto Exposure]:** Activate this checkbox to perform auto exposure.
- **[Dust/Scratch Removal]:** Activate this checkbox to remove scratch/dust. This function is only for the infrared built-in model.

SilverFast Software

Your scanner comes with the advanced and feature rich scanning application SilverFast, it's an optional bundled software for you to install on your system. You may get familiar first with your OF 8300i, then choose to install the SilverFast software.

Attention

- It takes about **10 mins** to install SilverFast software.
- You have to create and login with a **MySilverFast account**.
- Please make sure there is **internet connection** while you're installing SilverFast software.

- [Request for SilverFast License](#)
- [Installing SilverFast Software](#)
- [Scan with the SilverFast application](#)

Request for SilverFast License

1. Visit the website www.silverfast.com/activation-plustek and follow the instructions. You will need your scanner 15-digit hardware serial number.

Request a free *SilverFast* license
for your **plustek** scanner.



• OpticFilm 8300i



• OpticFilm 120 Pro

Information on your Plustek scanner

Please give us some information on your Plustek scanner:

1 Please select your scanner model

2 Please enter Hardware serial number

3



(You can find this serial number on the activation flyer and on the back of your scanner.)

*The webpage content may subject to change without prior notifications.

- 1 Select your scanner model.
- 2 Enter the scanner serial number.
- 3 Click the [Check] button.

2. Enter the necessary information to create a MySilverFast account. **You have to login to the SilverFast software with this MySilverFast account later.**

Request a free *SilverFast* license for your **plustek** scanner.

Please register at MySilverFast to receive your free SilverFast license

Do you already have an account? [Log in here](#)

Please make sure that your hardware serial number is correct and then fill out this form to set up a MySilverFast account. You can manage and download the software in your MySilverFast user account.

Hardware Serial Number: [Edit Hardware Serial Number](#)

First Name	Last Name
------------	-----------

Company (optional)

Please select your country.

Login data for MySilverFast and SilverFast 9:
Note: The access data you enter here is identical to those for your software.

Email Address
Password
Confirm your Password

[Show password](#)

***The webpage content may subject to change without prior notifications.**

3. If the registration is completed, you will receive an email to inform you that the license has already been added to your MySilverFast account.

License added to your MySilverFast Account Inbox x

 **LaserSoft Imaging** <my@silverfast.de>
to me ▾

MySilverFast 

Dear SilverFast Customer [REDACTED],

congratulations on your new SilverFast software. Your new SilverFast license has been added to your [MySilverFast Account](#) and will be available on your computer when you open SilverFast 9 the next time.

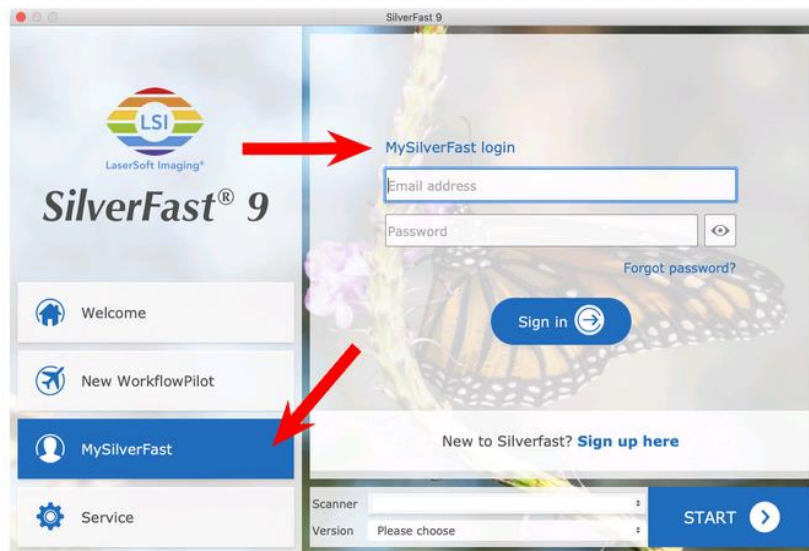

You probably already know that SilverFast 9 works on the basis of a MySilverFast-Account instead of a serial number. On the [MySilverFast-Portal](#) you can manage your licenses and download the software. SilverFast 9 is activated automatically when you log into your MySilverFast-Account in the MySilverFast-Tab of the SilverFast 9 Welcome Screen on your computer.

If you have any questions on MySilverFast, please check our [MySilverFast-Guide for help](#).

Enjoy your new SilverFast 9 software!

With best wishes for brilliant images

Your SilverFast Team

LaserSoft Imaging AG, Luisenweg 6-8, 24105 Kiel, Germany, Phone: +49 (0)431-56009-0

www.SilverFast.com | www.PrinTao8.com | www.Picture-Plugins.com

Installing SilverFast Software

You can install SilverFast from your MySilverFast portal (page 30) or from USB stick:

1. Insert the Setup / Application USB stick into your computer.
2. Install the **SilverFast** software by the following path:
Mac OS X: **OPTICFILM > Mac > SilverFast > SF-Installer.dmg**
Windows OS: **OPTICFILM > Windows > SilverFast > SF-Installer.exe**
3. Follow the on-screen instructions.



4. After the installation finishes, click on [Done] to exit the installer.

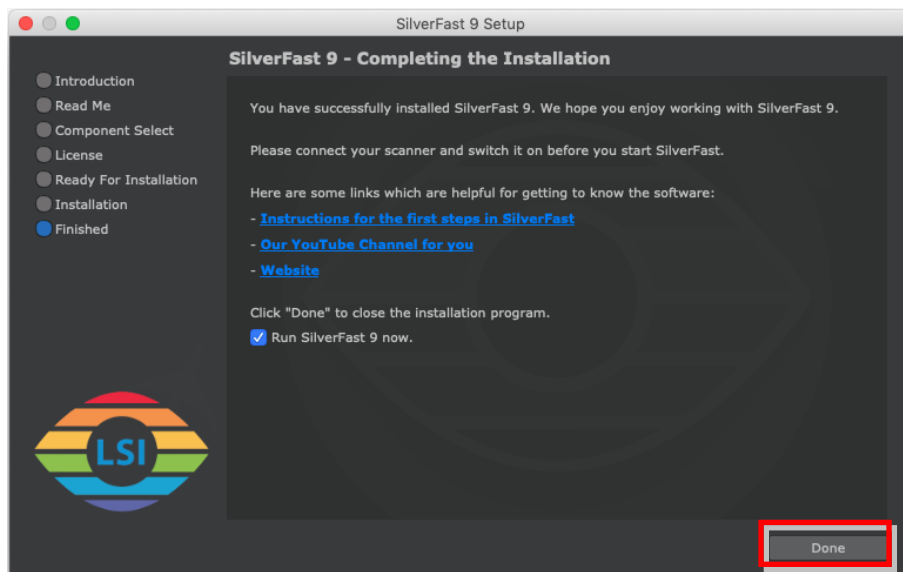

You may download the SilverFast software from your MySilverFast account.

1. Log in to your [MySilverFast portal](#) and click [**Manage licenses**]

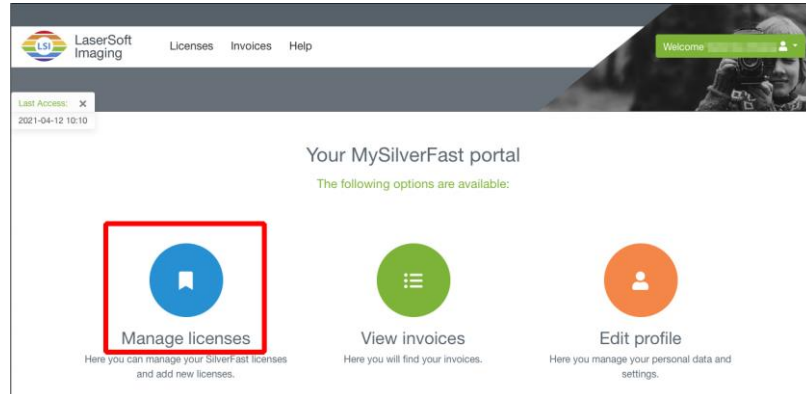

2. Click [**Download**] button to download the SilverFast software.

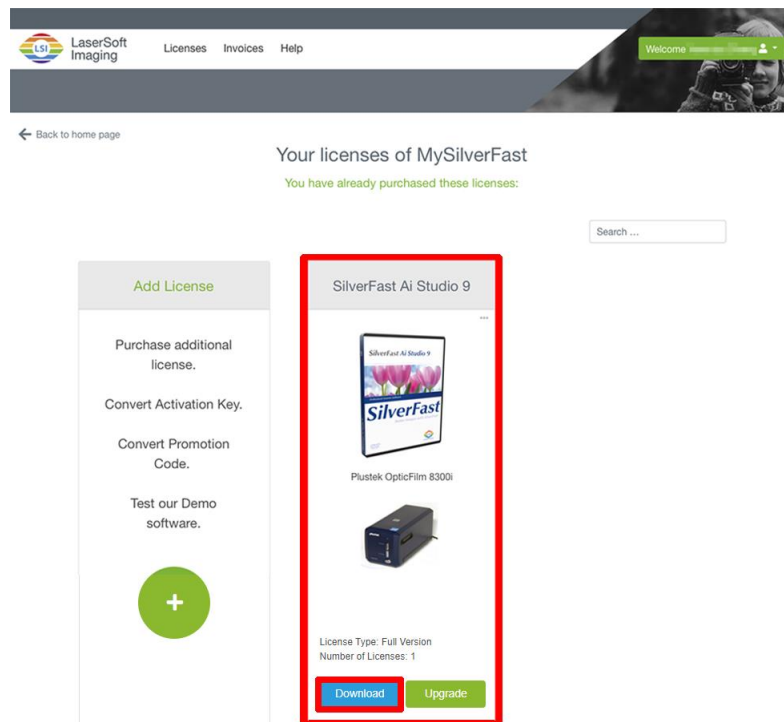

3. When the download is completed, run the installer and follow the on-screen instructions. After the installation finishes, click on [**Done**] to exit the installer.

Attention

Scan with the SilverFast application

Launch the SilverFast launcher using the SilverFast shortcut on the Desktop. **Login to the SilverFast software with your MySilverFast account**, then click on [Start] to launch the program.

Attention	Please make sure there is internet connection while login to the SilverFast software.
------------------	--

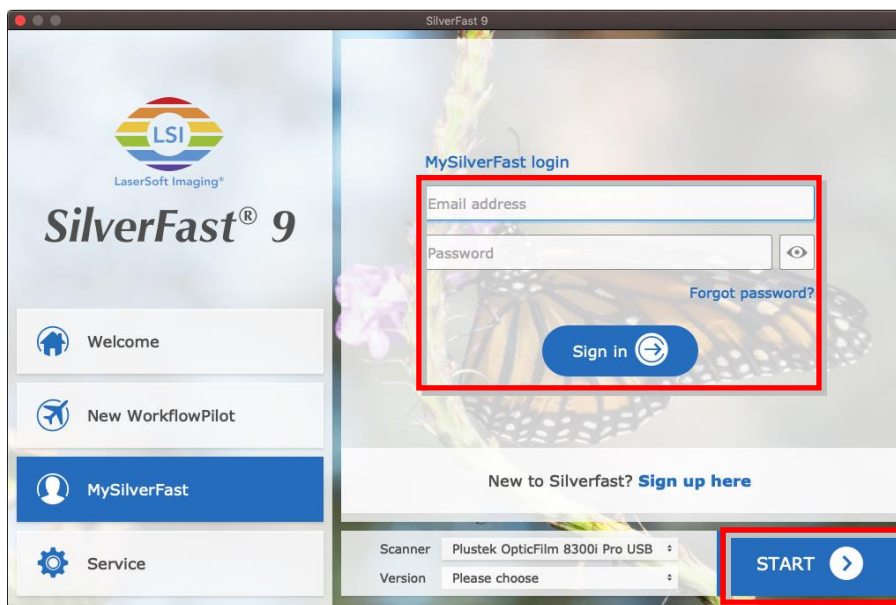

Adjust the scan settings. Please refer to the SilverFast manual for more information about available scan settings.

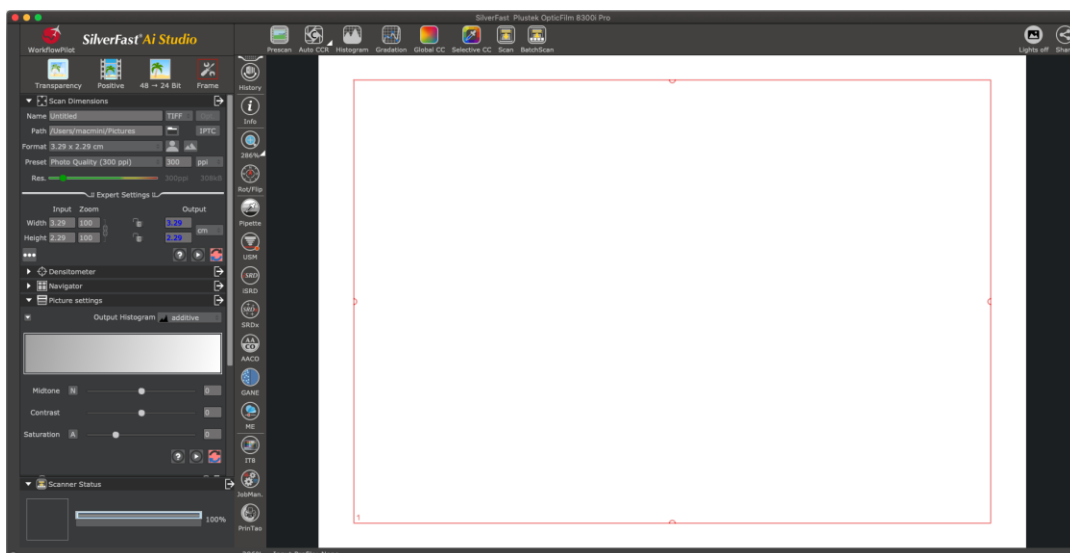

Operating the Scanner

There are different ways to operate the scanner:

- 1 Using SilverFast Launcher by pressing [**IntelliScan**] button. This stand alone program allows you to perform advanced scanning features. For further information, please refer to SilverFast User's Manual.
- 2 Using QuickScan Plus Launcher by pressing [**QuickScan**] button. The QuickScan Plus program is automatically installed as your scanner software.

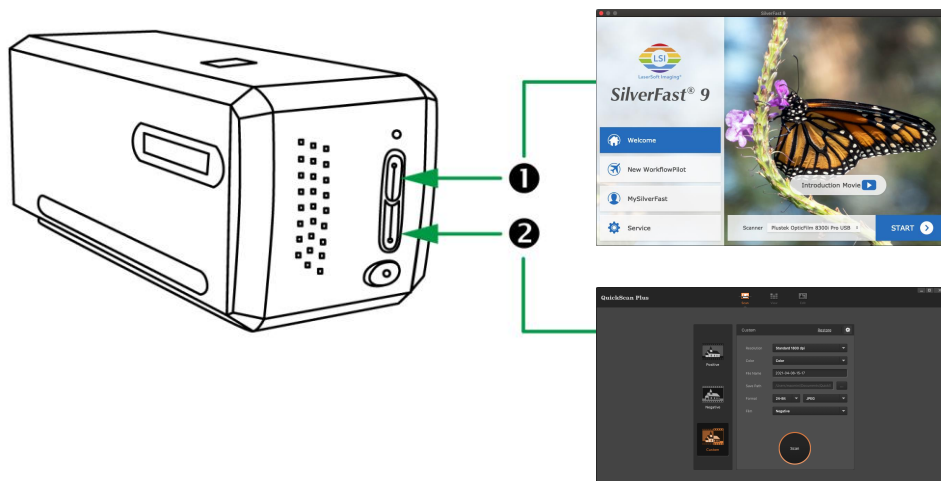

- [1 Using \[IntelliScan\] Button](#)
- [2 Using \[QuickScan\] Button](#)

① Using [IntelliScan] Button

The [IntelliScan] button enables you to activate bundled SilverFast, which performs advanced scan features, such as Dust and Scratch Removal, Grain and Noise Elimination, Negative Optimization...etc.

Attention

- This button is only available when the SilverFast software is installed on your computer.
- For detailed settings and features about SilverFast, please refer to SilverFast User's Manual.

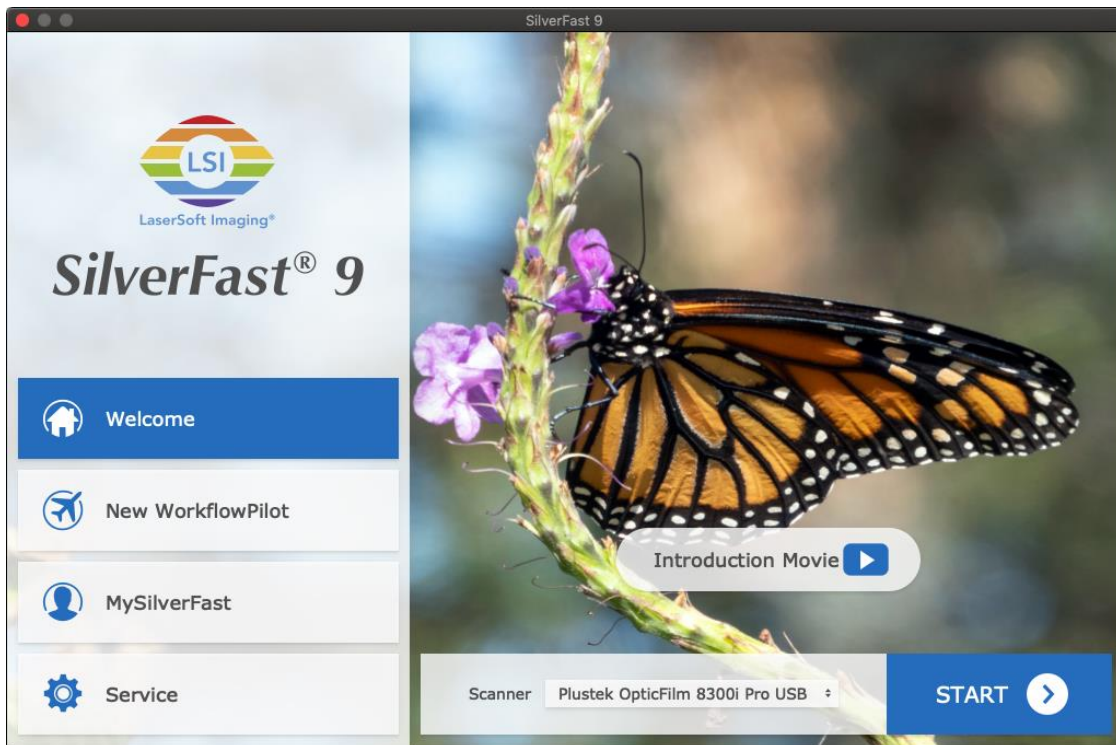

② Using [QuickScan] Button

The [QuickScan] button enables you to launch QuickScan Plus software. If the [Save image files after hardware scan] option is checked in the [Preference] settings dialog, this [QuickScan] button can conveniently scan images and save them automatically to the album. Simply press the [QuickScan] button on the front of your scanner and the scanner will start scanning your transparencies or negatives with [Custom] scan mode.

Before performing your first scan via the [QuickScan] button, you are recommended to configure the QuickScan Plus settings to your needs and preferences first.

Attention

Please refer to the QuickScan Plus on-line help for more information about available scan settings.

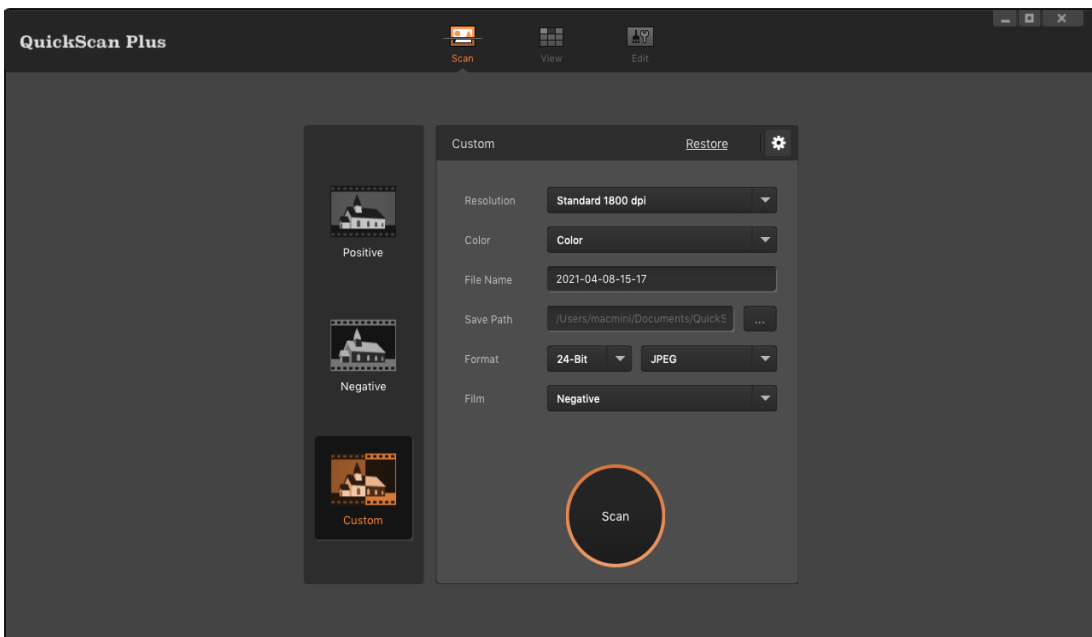

Appendix A: Troubleshooting

Scanner Connection

The first step to take when troubleshooting connection problems with your scanner is to check all physical connections.

Manually Installing the Software

For Windows OS: If you are facing difficulty in installing the scanner driver, please try manually installing the software.

1. Please open [Start] > [Control Panel] > [System] > [Hardware] > [Device Manager]. In the [Device Manager] window, right-click on this scanner under [Other devices] and select [Update Driver Software] from the pop-up menu.

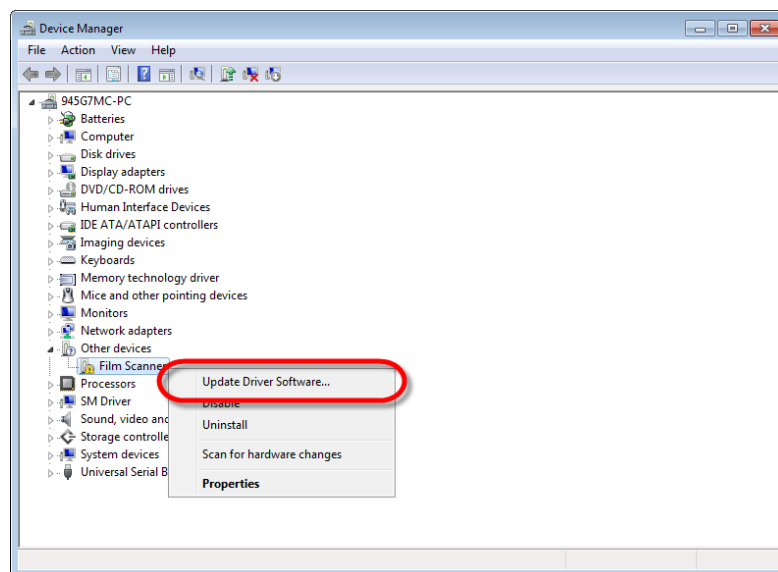

Attention

2. Click [Browse my computer for driver software] in the window that appears, and click the [Browse] button. In the [Browse For Folder] window, select the folder that contains this scanner's driver and click the [OK] button to return to the previous screen. Click the [Next] button and click [Install this driver software anyway] if the [Windows Security] window appears.
3. Browse your USB stick and manually run the [Setup.exe] file from OPTICFILM > Windows > Plustek OpticFilm 8300i. Click on the [Yes] button if the [User Account Control] dialog pops up. Follow the on-screen instructions to install all software that your new USB scanner requires.

Scanning Problems

Most problems are easily solved, and some of the most common questions and their recommended solutions are listed below.

***Always make sure that you are using the latest software of Plustek and SilverFast.**

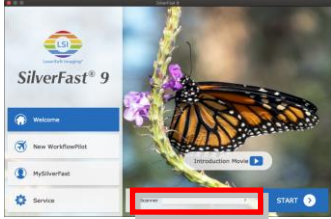
Symptom	Cause & Solution
<p>The Scanner source is blank</p> 	<ul style="list-style-type: none"> The scanner is not detected by the OS. Please refer to the solutions of the following “The scanner cannot be found”.
<p>The scanner cannot be found</p>	<ul style="list-style-type: none"> The USB cables are not connected properly Make sure that the cables are connected tightly and to the proper port. The USB cable might be too long Please use the USB cable that comes with your scanner. The scanner’s power cord is not connected properly Make sure that the AC adapter is connected to an outlet. If the scanner is connected to a Surge Protector, make sure that the Surge Protector is turned on. The scanner is not power on. Press the Power button to turn the scanner ON. Windows didn’t detect the scanner <ol style="list-style-type: none"> Please open [Start] > [Control Panel] > [System] > [Hardware] > [Device Manager]. Please check if your scanner is properly listed under [Imaging Devices]. If it is not listed there or the device icon has an exclamation mark, please refer to “Manually Installing the Software” to install the device drivers.

<p>The scanned image looks grainy on the screen</p>	<ul style="list-style-type: none"> • Your video mode is not set to show more than 256 colors We recommend that you set your video mode to 16 bits per pixel (65536 colors) or higher. Please consult your video card, computer or Windows documentation to change the video mode.
<p>The scanner scans very slowly</p>	<ul style="list-style-type: none"> • You are running other applications in the background Close all the other applications that are running in the background. • You are scanning at a high resolution (DPI) Reduce the resolution.
<p>The image looks good in the software that came with the scanner but it doesn't look good when I export the image to another program</p>	<ul style="list-style-type: none"> • Different imaging programs use different Monitor Gamma settings Change the Monitor Gamma settings in either of the programs so that they match. Please consult the help files for each program to find out how to adjust the Monitor Gamma.
<p>The image looks good on screen but very dark when printed</p>	<ul style="list-style-type: none"> • The Monitor Gamma Settings or the scanner brightness settings are not set properly 1) Change the Monitor Gamma to a value between 1.0 and 1.5. Please consult your help file for information on how to adjust the Monitor Gamma. 2) Adjust the brightness control in the TWAIN window before scanning. • The printer brightness setting is not set properly Adjust the brightness in the printer. Some printers allow you to change the brightness settings. Please consult your printer documentation.
<p>There is a grinding or rattling noise at the beginning of each scan</p>	<ul style="list-style-type: none"> • The scanner engages the gears and it initializes itself before scanning This noise is normal to the operation of the scanner.

<p>A “Disk is full” error is displayed when I click on the scan button</p>	<ul style="list-style-type: none"> • Your computer is running low in resources. Your computer hard disk drive does not have enough space to process the image. This may be because you are scanning at too high of a resolution Obtain a larger hard disk or rescan at a lower resolution.
<p>A “Disk I/O error” message is displayed</p>	<ul style="list-style-type: none"> • This error is caused if the hard disk drive does not have enough space available to process the image Make some space available in the hard disk drive by deleting any programs or files that you do not need • Your hard disk drive might be heavily fragmented or it might contain some bad sectors Run the Scan Disk utility that came with your Windows computer. Please consult your computer documentation or the Windows help files on how to run the Scan Disk Utility

Appendix B: Specifications²

OpticFilm 8300i Ai	
Image Sensor	CCD
Light Source	LED
Hardware Resolution	7200 dpi
Scan Modes	Color: 48-bit input, 24/48-bit output Grayscale: 16-bit input, 8/16-bit output
Dynamic Range	3.6
Infrared	Built-in
Scanning Speed	3600 dpi: Approx. 20 sec & 40 sec with IR scanning 7200 dpi: Approx. 40 sec & 120 sec with IR scanning
Scanning Area (W x L)	36.8 mm x 25.4 mm (1.45" x 1") Remark: 35mm film
IT8 Target	Bundled
Action Button	IntelliScan, QuickScan
Power Supply	15 Vdc / 1.2 A
Interface	USB 2.0 Type B
Net Weight	1.6 Kgs (3.5 Lbs)
Dimensions (W x D x H)	120 x 272 x 119 mm (4.73" x 10.7" x 4.7")
OS	Windows 7 X64/ 8 X64/ 10 X64/ 11 Mac 10.13.x and later
Hardware Requirements	Windows PC & Mac Intel i5 CPU or faster 4 GB RAM main memory (8 GB RAM recommended) 20 GB free space on the hard disk drive Internet connection

² Hardware specifications may change at any time without prior notice.

OpticFilm 8300i SE	
Image Sensor	CCD
Light Source	LED
Hardware Resolution	7200 dpi
Scan Modes	Color: 48-bit input, 24/48-bit output Grayscale: 16-bit input, 8/16-bit output
Dynamic Range	3.6
Infrared	Built-in
Scanning Speed	3600 dpi: Approx. 20 sec & 40 sec with IR scanning 7200 dpi: Approx. 40 sec & 120 sec with IR scanning
Scanning Area (W x L)	36.8 mm x 25.4 mm (1.45" x 1") Remark: 35mm film
Action Button	IntelliScan, QuickScan
Power Supply	15 Vdc / 1.2 A
Interface	USB 2.0 Type B
Net Weight	1.6 Kgs (3.5 Lbs)
Dimensions (W x D x H)	120 x 272 x 119 mm (4.73" x 10.7" x 4.7")
OS	Windows 7 X64/ 8 X64/ 10 X64/ 11 Mac 10.13.x and later
Hardware Requirements	Windows PC & Mac Intel i5 CPU or faster 4 GB RAM main memory (8 GB RAM recommended) 20 GB free space on the hard disk drive Internet connection

Appendix C:

Customer Service and Warranty

If you encounter problems with your scanner, please review the installation instructions and troubleshooting suggestions contained in this guide.

Visit our website www.plustek.com for more customer service information. To avoid delays, please have the following information available:

- **Scanner name and model number**
- **Scanner serial number (located at rear of scanner near port connectors)**
- **A detailed description of the problem**
- **Your computer manufacturer and its model number**
- **The speed of your CPU**
- **Your current operating system and BIOS (optional)**
- **Name of software package(s), version or release number and manufacturer of the software**
- **Other USB devices installed**

Service & Support Information (For EU country only)

Where appropriate, the period of availability of spare parts and the possibilities of upgrading products information. Please ask local distributors and suppliers for spare parts information and product upgrade information.

Information requested by relevant Implementing Measure. Please ask local distributors and suppliers for the related information of Implementing Measure test report.

Do not dispose anything of products before you ask local distributors and suppliers to get correct information for decreases of environmental impact with right methods and procedures.

If you want to disposals the product and/or an accessory, please ask local distributors and suppliers to get the contact information of nearest disposal manufactures.

If you have any maintenance inquiry, please ask local distributors and suppliers to get the contact information of nearest maintenance center in order to extend the product usage life time.

If you want to maintain and clearance the product, please ask local distributors and suppliers to get the right information of nearest stores.

Statement of Limited Warranty

This Statement of Limited Warranty applies only to the options you originally purchase for your use, and not for resale, from an authorized reseller.

The manufacturer warranty includes all parts and labor, and is not valid without the receipt of original purchase. To obtain warranty service, you may contact the authorized dealer or distributor, or visit our website to check out the available service information, or send a request via E-mail for further help.

If you transfer this product to another user, warranty service is available to that user for the remainder of the warranty period. You should give your proof of purchase and this statement to that user.

We warrant that this machine will be in good working order and will conform to its functional descriptions in the documentation provided. Upon provision of proof of purchase, replacement parts assume the remaining warranty of the parts they replace.

Before presenting this product for warranty service, you must remove all programmes, data and removable storage media. Products returned without guides and software will be replaced without guides and software.

This Limited Warranty service does not provide for carry-in exchange when the problem results from accident, disaster, vandalism, misuse, abuse, unsuitable environment, programme modification, another machine or non-vendor modification for this product.

If this product is an optional feature, this Limited Warranty applies only when the feature is used in a machine for which it was designed.

If you have any questions about your Limited Warranty, contact the approved retailer from whom you bought the product or the manufacturer.

THIS LIMITED WARRANTY REPLACES ALL OTHER WARRANTIES, EXPRESS OR IMPLIED, INCLUDING, BUT NOT LIMITED TO, THE IMPLIED WARRANTIES OF MERCHANTABILITY AND FITNESS FOR A PARTICULAR PURPOSE. HOWEVER, SOME LAWS DO NOT ALLOW THE EXCLUSION OF IMPLIED WARRANTIES. IF THESE LAWS APPLY, THEN ALL EXPRESS AND IMPLIED WARRANTIES ARE LIMITED IN DURATION TO THE WARRANTY PERIOD. NO OTHER WARRANTIES APPLY AFTER THAT PERIOD.

Some jurisdictions do not allow limitations on how long an implied warranty lasts, so the above limitation may not apply.

Under no circumstances are we liable for any of the following:

- Third party claims against you for losses or damages.
- Loss of, or damage to, your records or data; or
- Economic consequential damages (including lost profits or savings) or incidental damages, even if we are informed of their possibility.

Some jurisdictions do not allow the exclusion or limitations of incidental or consequential damages, so the above limitation or exclusion may not apply to you.

This Limited Warranty gives you specific legal rights, and you may also have other rights that vary from jurisdiction to jurisdiction.

To obtain the warranty service, you may:

- contact the authorized dealer or distributor.
- visit our website to check out the up-to-date service.
- send a request via E-mail for further help.

FCC Radio Frequency Statement

This equipment has been tested and found to comply with the limits for a Class B digital device, pursuant to part 15 of the FCC rules. These limits are designed to provide reasonable protection against harmful interference in a residential installation.

This equipment generates, uses and can radiate radio frequency energy and, if not installed and used in accordance with the instructions, may cause harmful interference to radio communications. However, there is no guarantee that interference will not occur in a particular television reception (which can be determined by turning the equipment off and on), the user is encouraged to try to correct the interference by one or more of the following measures:

- Reorient or relocate the receiving antenna.
- Increase the separation between the equipment and receiver.
- Connect the equipment to an outlet on a circuit different from that which the receiver is connected.
- Shielded interconnect cables and shielded power cord which are supplied with this equipment must be employed with this equipment to ensure compliance with the pertinent RF emission limits governing this device.
- Consult the dealer or an experienced radio/TV technician for help if the conditions persist.
- Changes or modifications not expressly approved by the manufacturer or authorized service center could void the user's authority to operate this equipment.



1 Unpack and Connect

- Auspacken und anschließen
- Desempaque y conecte

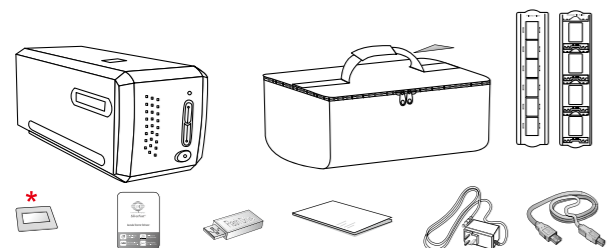

* OpticFilm 8300i Ai only
 * Nur für OpticFilm 8300i Ai
 * Sólo lo para OpticFilm 8300i Ai

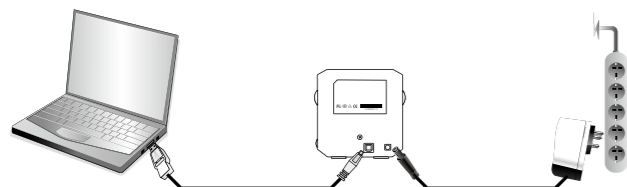

2 Installing Scanner Driver

- Scanner Treiber installieren
- Instalando el controlador del escáner

Install the scanner driver by the following path:
 Installieren Sie den Scannertreiber über den folgenden Pfad:
 Instale el controlador del escáner mediante la siguiente ruta:

Mac OS X: OPTICFILM > Mac > Plustek OpticFilm 8300i > Setup.dmg
 Windows OS: OPTICFILM > Windows > Plustek OpticFilm 8300i > Setup.exe

Attention

You may download the latest version driver from our official website plustek.com/of8300i

Sie können die neueste Version des Treibers von unserer offiziellen Webseite plustek.com/of8300i.

Puede descargar la última versión del controlador desde nuestro sitio web oficial plustek.com/of8300i.

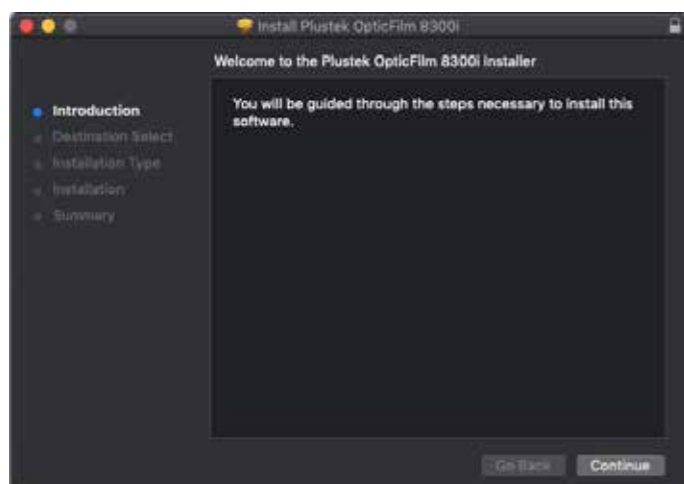

3 Insert the Film Holder

- Filmhalter einschieben
- Insertando el sujeta películas

- Mounted Film Holder
- Halter für gerahmte Dias
- Sujeta Diapositivas Montadas

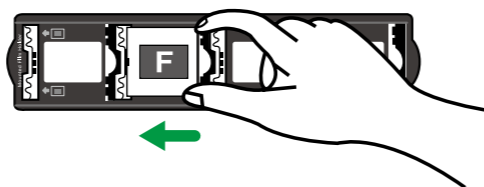

- Strip Film Holder
- Filmstreifenhalter
- Sujeta Películas

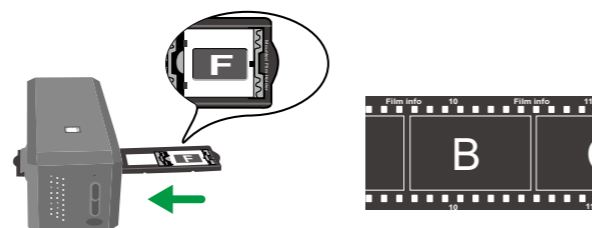
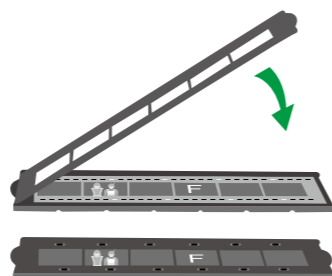

Attention

- The film holder should be able to be inserted into the scanner smoothly. Do not push the film holder hard.
- Always keep this side up for correct scan results.
- Der Filmhalter muss vorsichtig und ohne festes Drücken in den Scanner eingeschoben werden.
- Zum ordnungsgemäßen Scannen muss diese Seite immer nach oben zeigen.
- El sujeta películas se debería insertar en el escáner con suavidad. No apriete el sujeta películas con dureza.
- Mantener siempre este lado hacia arriba para unos resultados de escaneado correctos.

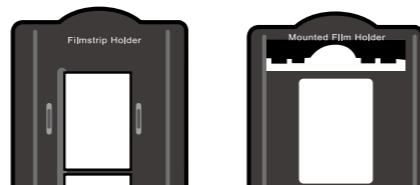

4 Scan with QuickScan Plus

- Scannen mit der QuickScan Plus
- Digitalizar con la QuickScan Plus

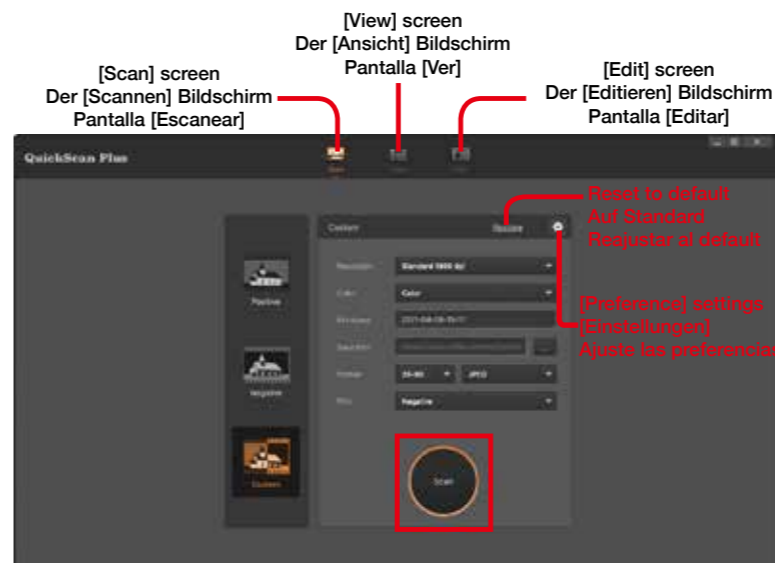

Attention Please refer to the User Guide for detailed information. Detaillierte Informationen finden Sie im Benutzerhandbuch. Consultar la Guía del usuario para obtener información detallada.

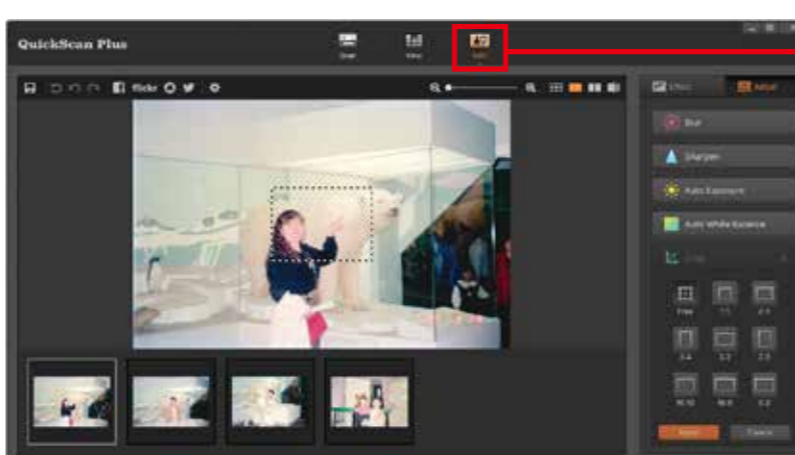

Adjust scan settings, click [Scan] button to start your scanning job.

Passen Sie die Scaneinstellungen an, klicken Sie auf die Schaltfläche [Scannen], um Ihren Scanauftrag zu starten.

Ajustar la configuración de escaneo, haga clic el botón [Digitalizar] para comenzar el trabajo de escaneo.

You may click [Scan] button to scan more images.

Sie können auf die Schaltfläche [Scannen] klicken, um weitere Bilder zu scannen.

Puede hacer clic en el botón [Digitalizar] para escanear más imágenes.

Click on the [Edit] button to edit scanned images.

Klicken Sie auf die Schaltfläche [Editieren], um gescannte Bilder zu bearbeiten

Haga clic en el botón [Editar] para editar las imágenes escaneadas.

Technical Support

- Technischer Kundendienst
- Soporte técnico

USA/CA
 +1 714-670-7713
 9am to 5:30pm, Pacific Time, Monday through Friday
 For detailed information, please visit product website.

United Kingdom
 0125-674-1513
 9am-16pm, Monday through Friday
 For detailed information, please visit product website.

Germany
 +49 (0)4102 - 8913 - 130
 Mo. - Do. von 09:00 - 12:30 Uhr und 13:00 - 17:00 Uhr, sowie Fr.: 09:00 - 12:30 Uhr und 13:00 - 15:00 Uhr.
 Für detaillierte Informationen besuchen Sie bitte unsere Produktwebseite

Attention

- It takes about 10 mins to install SilverFast software.
- You have to create and login with a **MySilverFast account**.
- Please make sure there is **internet connection**.
- Die Installation der SilverFast Software dauert etwa **10 Minuten**.
- Sie müssen ein **MySilverFast Konto** erstellen und sich mit diesem anmelden.
- Bitte stellen Sie sicher, dass eine **Internetverbindung** besteht, während Sie die SilverFast Software installieren.
- Lleva unos **10 minutos** para instalar el software SilverFast.
- Es necesario crear una cuenta de **MySilverFast** y acceder a ella.
- Por favor, asegúrese de que hay **conexión a Internet** mientras instala el software SilverFast.

1. Visit the website www.silverfast.com/activation-plustek to request license.
1. Rufen Sie die Webseite www.silverfast.com/activation-plustek auf und folgen Sie den Anweisungen.
1. Visite la página web www.silverfast.com/activation-plustek y siga las instrucciones.



2. Enter the necessary information to create a MySilverFast account.
2. Geben Sie die die notwendigen Informationen ein, um ein MySilverFast Konto zu erstellen.
2. Ingrese la información necesaria para crear una cuenta MySilverFast.

Request a free **SilverFast** license for your **plustek** scanner.

Please register at MySilverFast to receive your free SilverFast license

Do you already have an account? [Log in here](#)

Please make sure that your hardware serial number is correct and then fill out this form to set up a MySilverFast account. You can manage and download the software in your MySilverFast user account.

Hardware Serial Number: [Edit Hardware Serial Number](#)

First Name Last Name

Company (optional)

Please select your country:

Login data for MySilverFast and SilverFast 9:

Note: The access data you enter here is identical to those for your software.

Email Address

Password

Confirm your Password

[Show password](#)

3. You will receive an email to inform you that the license has already been added to your MySilverFast account.
3. Wenn die Registrierung abgeschlossen ist, erhalten Sie eine E-Mail, die Sie darüber informiert, dass die Lizenz bereits zu Ihrem MySilverFast Konto hinzugefügt wurde.
3. Si se ha completado el registro, recibirá un correo electrónico para informarle de que la licencia ya se ha añadido a su cuenta de MySilverFast.

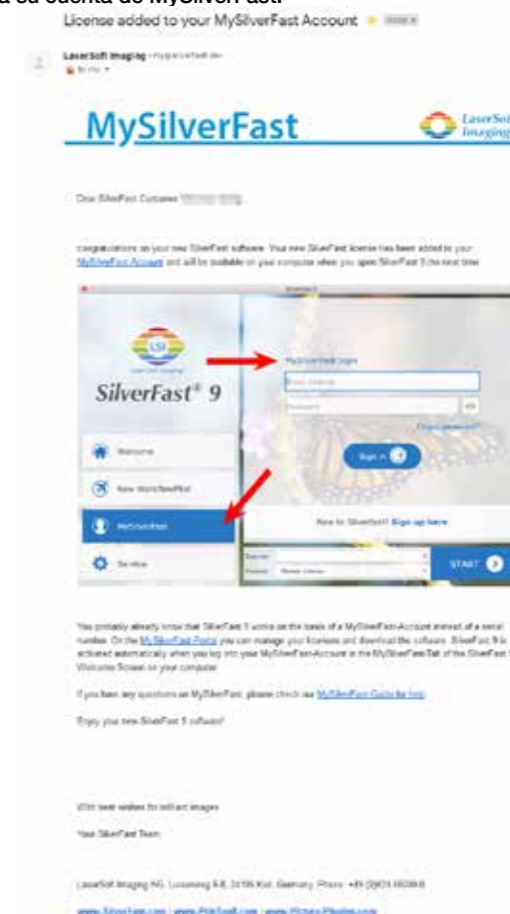

SilverFast Installation

- SilverFast installieren
- Instalando SilverFast

You can install SilverFast from your **MySilverFast portal** or from **USB stick**: Sie können SilverFast von Ihrem **MySilverFast portal** oder von einem **USB-Stick** installieren: Se puede instalar SilverFast desde su **MySilverFast portal** o desde una **memoria USB**:

Mac OS



Windows OS



Operating the Scanner

- Umgang mit dem Scanner
- Utilizar el escáner

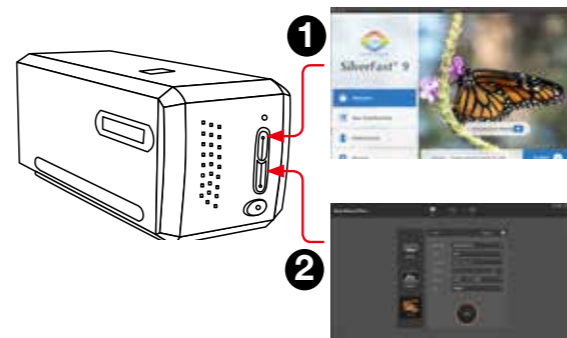

- 1 [IntelliScan] button: Launch SilverFast software
- 2 [QuickScan] button: Launch QuickScan Plus software
- 1 [IntelliScan]-Taste: Benutzung des SilverFast Launchers
- 2 [QuickScan]-Taste: Benutzung des QuickScan Plus Launchers
- 1 Botón [IntelliScan]: Usando el Ejecutable SilverFast
- 2 Botón [QuickScan]: Usando el Ejecutable QuickScan Plus

FAQ

1. Why can't I start the SilverFast software?
Check if the Image Source is blank, if it is blank:
a. Make sure the USB cable and power cord are connected properly.
b. Check if your scanner is properly listed under [Imaging Devices] in [Device Manager].
2. How to do the SilverFast software reset?
a. Click [Service Dialog] in the SilverFast welcome screen.
b. Select [Software reset] resets this software to the factory settings. (All saved settings will be lost as well.)
3. Is the iSRD function not available on B/W film?
iSRD can be used with conventional colour negatives (developed using the C41 process), colour slides (developed using the E6 process) and paper proofs. Due to the silver content in conventional black and white negatives and slides, these can't be retouched using iSRD.
1. Warum kann ich die SilverFast-Software nicht starten?
Überprüfen Sie, ob die Bildquelle leer ist, wenn sie leer ist:
a. Stellen Sie sicher, dass das USB-Kabel und das Netzkabel richtig angeschlossen sind.
b. Überprüfen Sie, ob Ihr Scanner unter [Bildverarbeitungsgeräte] im [Geräte-Manager] richtig aufgeführt ist.
2. Wie können die Einstellungen von SilverFast vollständig zurückgesetzt werden?
a. Klicken Sie im SilverFast-Willkommensbildschirm auf [Service].
b. Wählen Sie [Software-Reset], um diese Software auf die Werkseinstellungen zurückzusetzen. (Alle gespeicherten Einstellungen gehen ebenfalls verloren.)
3. Ist iSRD (Infrarotskan) geeignet für Schwarzweißfilm?
Nein, iSRD sollte nur bei Farbnegativen (entwickelt nach C-41-Prozess) oder bei Farbdias (entwickelt nach E-6-Prozess) angewendet werden. Der Silberanteil in der Emulsion handelsüblicher Schwarzweißfilme führt zu einer Streuung der Infrarotstrahlen, weshalb sich im Scanergebnis Artefakte bilden können. Wir empfehlen daher Schwarzweißfilm nicht mit iSRD, sondern mit SRDx zu scannen.
1. ¿Por qué no puedo iniciar el software SilverFast? Compruebe si el origen del imagen está en blanco, si está en blanco:
a. Asegúrese de que el cable USB y el cable de alimentación estén conectados correctamente.
b. si. Compruebe si su escáner se encuentra en la lista correcta en [Dispositivos de imágenes] en [Administrador de dispositivos].
2. ¿Cómo restablecer el software SilverFast?
a. Haga clic en [Diálogo de servicio] en la pantalla de bienvenida de SilverFast.
b. si. Seleccione [Restablecer software] restablece este software a la configuración de fábrica. (Todos los ajustes guardados también se perderán).
3. ¿La función iSRD no está disponible en película B / W?
iSRD se puede usar con negativos de color convencionales (desarrollados usando el proceso C41), diapositivas de color (desarrolladas usando el proceso E6) y pruebas en papel. Debido al contenido de plata en negativos y diapositivas en blanco y negro convencionales, estos no se pueden retocar con iSRD.