

# RALLY CAMERA

Setup Guide | Guide d'installation

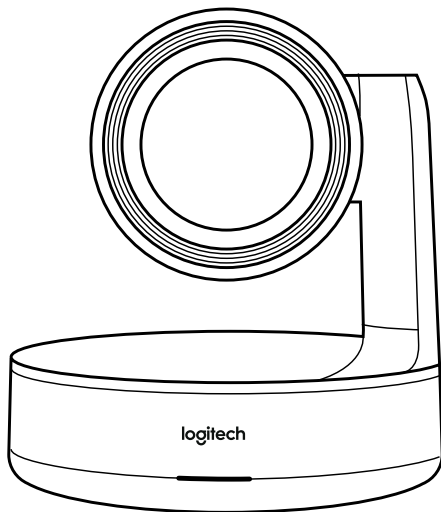

**logitech®**

English . . . . .	3
Français . . . . .	10
Español. . . . .	17
Português . . . . .	24

## WHAT'S IN THE BOX

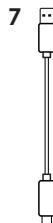
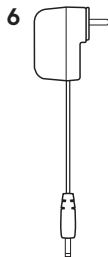
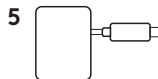
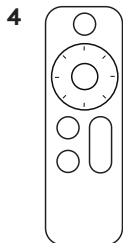
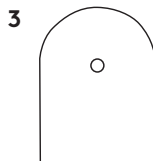
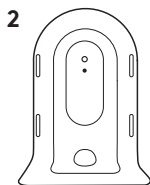
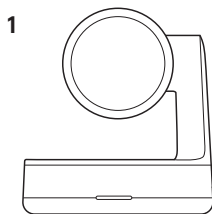

- 1. Camera
- 2. Camera Mount
- 3. Power Splitter Case
- 4. Remote

- 5. Power Splitter
- 6. Power Adapter
- 7. USB Cable
- 8. Documentation

# WHAT'S WHAT

## CAMERA

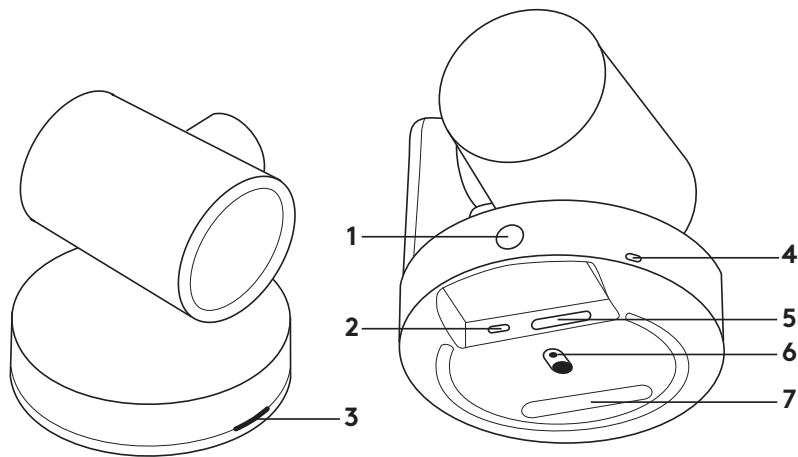

- 1. Remote Pairing Button
- 2. USB
- 3. Status LED

- 4. Security Slot
- 5. MIPI
- 6. Tripod Thread
- 7. Expansion Slot

## REMOTE

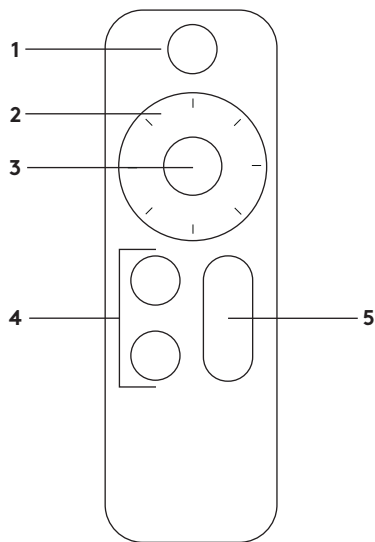

**1.** Video Mute

**2.** Pan/Tilt

**3.** Camera Home

**4.** Camera Presets

**5.** Zoom In/Out

## CONNECT YOUR CAMERA

Connecting Rally Camera is the same whether you plan on using a dedicated computer in the room, or your team members bring a laptop to the room to run the meeting.

1. Plug the power splitter USB pigtail into the USB port of the camera.

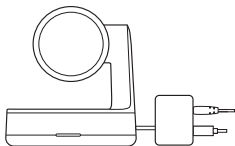

2. Connect the power adapter from the power splitter to a wall outlet.

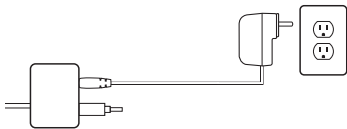

3. Connect the USB cable from the power splitter to your computer.

4. The status LED will flash when the camera is connecting.  
Once complete, the camera head will rotate.

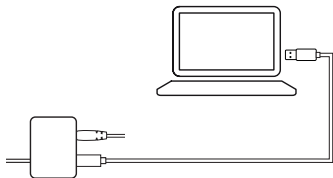

5. If issues persist, consult [www.logitech.com/support/rallycamera](http://www.logitech.com/support/rallycamera) or call technical support.

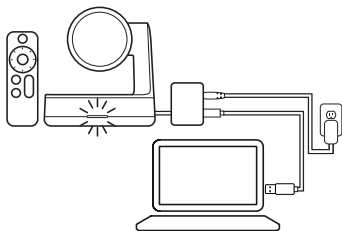

## MOUNT YOUR CAMERA

We offer a number of options to mount your Rally Camera. For video calls, we recommend placing the camera as close to eye level as possible. Best results typically come from mounting below the TV.

1. Place on a table or shelf near the TV.
2. Mount on the wall:
  - a. Attach wall mount to the wall. Please use the appropriate screw type for your wall type.

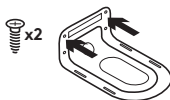

- b. Insert the power splitter into the power splitter case and route cables as shown.

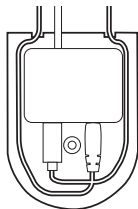

- c. Thread the USB pigtail through the hole in the bottom of the mount and connect to the camera.

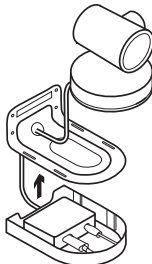

- d. Latch the power splitter case to the mount.



- e. Secure the camera to the mount via the tripod screw.
3. Mount to the TV: An optional TV mount bracket is available at [www.logitech.com](http://www.logitech.com).

## STARTING THE VIDEO CALL

To start a video call/capture session, start your application of choice and select the Rally Camera. The status LED will illuminate when video is streamed.

## PAN AND TILT

Press once for incremental movement or press and hold for continuous pan and tilt.

**Caution:** Manually rotating camera head may damage the device.

## CAMERA PRESETS

Set up to 2 preset positions. Once in the desired position, save a preset by pressing and holding the button for 3 seconds. Return to the desired position at any time by pressing the button once

## HOME

Home will be the position the camera moves to when the camera is started. Save a new Home position by holding the button for 10 seconds.

## CAMERA SETTINGS APPLICATION

Use this program to control the camera pan, tilt, zoom, focus, and image quality (like brightness and contrast). The software can be downloaded from [www.logitech.com/support/rallycamera](http://www.logitech.com/support/rallycamera)

## RIGHTSIGHT

RightSight automatically moves the camera and adjusts the zoom to comfortably frame meeting participants. RightSight is available on Windows 10 and macOS 10.14+. To enable or disable RightSight, download the Logitech Sync application. Pressing the pan, tilt or zoom buttons on the remote will disable RightSight. Pressing the home button will restart RightSight.



## PAIRING THE REMOTE

Your camera and remote control are paired at the factory. However, if you need to pair a remote to the camera (such as when replacing a lost remote) do the following:

1. Press and hold button on the back of the camera until LED flashes blue.
2. Press and hold the Video Mute button on the remote for 10 seconds to place it in pairing mode.
3. Once the remote and camera are paired the LED will stop flashing
4. If the pairing fails, the LED will keep flashing. Start from step 2 and repeat.

## FOR MORE INFORMATION

You can find additional information on Rally including:

- FAQs
- Firmware Upgrades
- Software Downloads
- Support Community
- Warranty Information
- Replacement Parts
- And more at  
**[www.logitech.com/support/rallycamera](http://www.logitech.com/support/rallycamera)**