



---

## *Video Tripod*

---

WITH FLUID HEAD

---

MANUAL



Congratulations on your Takama 3-Section Aluminum Video Tripod with Damping Fluid Video Head!

Step into a world of cinematic excellence and creative freedom with the Takama 3-Section Aluminum Video Tripod with Damping Fluid Video Head. This manual is your guide to unlocking its full potential. Whether you're an aspiring filmmaker, a seasoned videographer, or a photography enthusiast, we've tailored this guide to enhance your skills and elevate your craft. From setup to advanced techniques, we'll explore every facet of this exceptional tool, offering unparalleled stability and creative possibilities. Welcome to a cinematic journey like no other!

In this section, we'll delve into the specifications that make up the core of your Takama 3-Section Aluminum Video Tripod with Damping Fluid Video Head. Understanding the composition and quality of the materials used in your equipment is essential to maximize its performance and longevity.

### ***Δ Takama Tripod:***

Max height	1.7 m
Folded length	0.87 m
Max tube	18 mm
Bowl diameter	75 mm
Net weight	3.6 kg
Max load	10 kg
Material	Aluminum

### ***Δ Head:***

Material	Aluminum
Rotation	360°
Color	Black
Grip length	35 cm
Net weight	0.95 kg
Loading weight	10 kg
Bowl diameter	75 mm

It is a reliable companion for capturing stable and smooth video footage. In this section, we will guide you through the process of securely **using your Takama Tripod.**

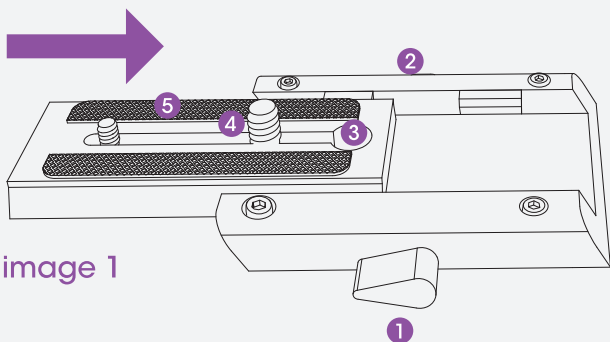

image 1

- |                       |                         |
|-----------------------|-------------------------|
| 1. Plate locking knob | 4. 1/4 and 3/8 screw    |
| 2. Plate safety lock  | 5. Anti-slip rubber pad |
| 3. Screw loading plug |                         |

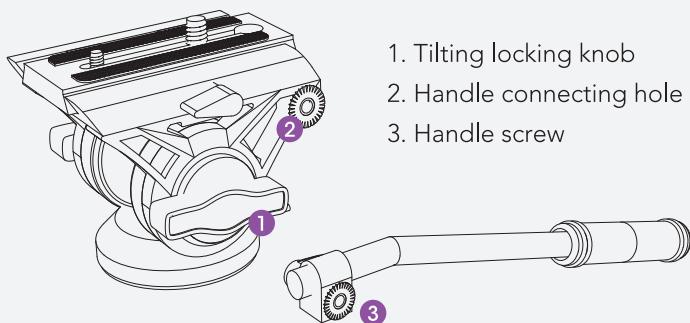

image 2

- |                           |
|---------------------------|
| 1. Tilting locking knob   |
| 2. Handle connecting hole |
| 3. Handle screw           |

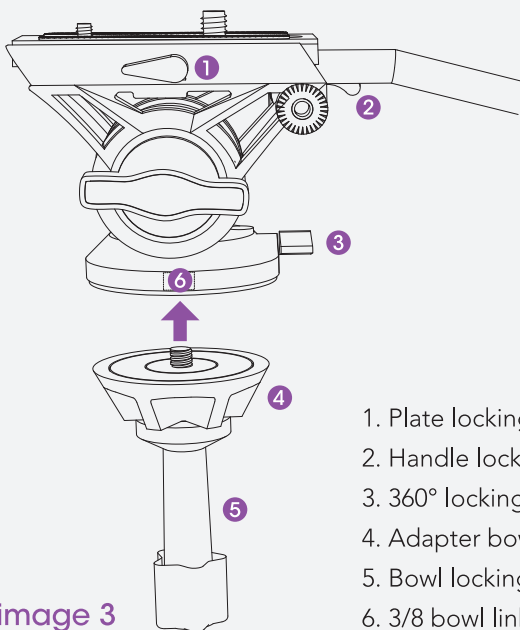
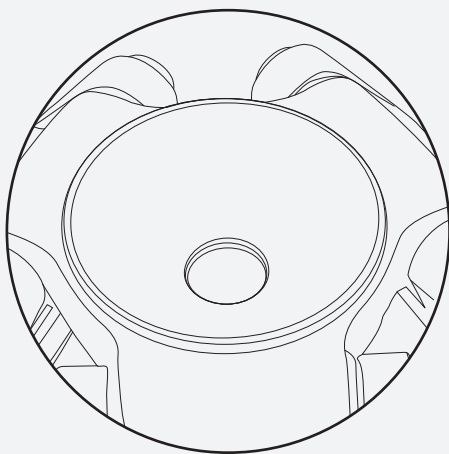

image 3



### Step 1:

Before you begin, ensure your camera is powered off and that any accessories like straps or lens caps are removed for convenience.

### Step 2:

The Takama tripod comes equipped with a camera mounting plate featuring a standard 1/4" and 3/8" screw with a locking knob, safety lock and anti-slip rubber pad. This plate is essential for securely attaching your camera. (see image 1 for reference)

### Step 3:

Numerous tripods feature this component. Observe the handle equipped with a handle screw, which can be fastened to the handle connecting hole, creating a unified and user-friendly assembly. This allows for easy adjustments once your camera is in place. (see image 2 for reference)

### Step 4:

This is the right time to connect the adapter bowl with the bowl locking handle to the bowl linking hole. Make sure it's firmly locked in place using the 360° locking knob. (see image 3 for reference)

### Step 5:

In addition, you may see a 75 mm bowl for attaching a fluid head. (see image 4 for reference)

### Step 6: Test for Stability

Delicately test your camera's stability by tilting it up, down, left, and right. Confirm that the tripod effectively holds your camera in position.

After securely setting up your Takama Tripod and attaching your camera to the Takama 3-Section Aluminum Video Tripod with Damping Fluid Video Head, you're ready to establish a stable foundation for professional video recording. Now, let's delve into further aspects of your Takama Tripod to help you make the most of its capabilities.

## Extending the legs

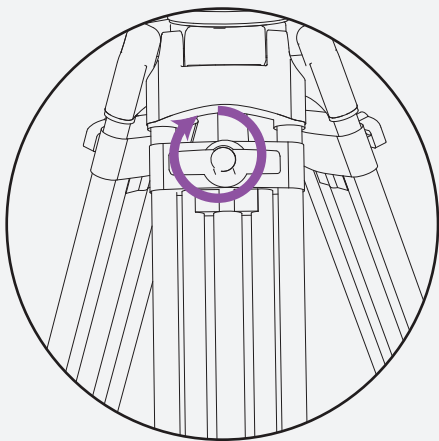

- A.** To ensure stability and prevent uneven leg extension. First, extend the tripod legs that can support over 15kg to your desired length before spreading them apart. To extend a leg, loosen its lock that you will see on the feet of the Tripod (lock just like on the photo), extend the leg to the desired length, and then securely tighten the handle locking button. Always focus on one leg lock at a time. Once all legs are set to the same length, you can spread them apart. To enhance stability further, consider locking the leg spreader by giving it a rotational twist.
- B.** Before placing any equipment on the tripod, it's a good practice to double-check that all leg locks are firmly tightened for added safety.

Using the Takama 3-Section Aluminum Video Tripod with Damping Fluid Video Head effectively can significantly improve the quality of your video footage. Here are some **tips** on how to make the most out of this tripod:

### **Familiarize Yourself with the Equipment:**

Before your shoot, spend some time getting to know the tripod and its features. Read the user manual to understand how to properly set up and adjust the tripod.

### **Check for Stability:**

Always ensure that the tripod is on a stable surface. Adjust the leg angles and lengths to achieve a stable and level base. Use the built-in bubble level to confirm that your setup is level.

### **Secure Your Camera:**

Attach your camera securely to the fluid head's quick-release plate. Make sure it's fastened tightly to prevent any wobbling or potential accidents.

### **Balance the Camera:**

Ensure that your camera is well-balanced on the head. This involves adjusting the camera's position on the quick-release plate so that it doesn't tip forward or backward when you release the tilt lock.

### **Use the Fluid Head Smoothly:**

The damping fluid head is designed for smooth panning and tilting movements. When making these adjustments, use slow and controlled motions for professional-looking shots. Don't rush the movements, and practice to achieve fluidity in your camera movements.

### **Lock and Unlock Properly:**

Remember to lock the pan and tilt controls when you've achieved the desired framing. This prevents any unintentional camera movements during recording. Conversely, unlock them when you need to reposition the camera.

By following these tips and practicing with the Takama 3-Section Aluminum Video Tripod with Damping Fluid Video Head, you can capture smoother and more professional video footage for your projects.

Unlock Your Creative Vision with Precision and Stability - Elevate Your Photography with Takama!

## *One Year TAKAMA Limited Warranty*

Takama warrants to the original purchaser that your Takama product shall be free from defects in material and workmanship for the period of one (1) year from the date of purchase (or delivery as may be required in certain jurisdictions), or thirty (30) days after replacement, whichever comes later.

Takama's entire liability and your exclusive remedy for any breach of warranty shall be, at Takama's option, to repair or replace the hardware, provided that the hardware is returned to the point of purchase or such other place as Takama may direct with a copy of the sales receipt or dated itemized receipt. Takama may, at its option, replace your product, offer to provide a functionally equivalent product or repair any product with new, refurbished, or used parts as long as such parts are in compliance with the product's technical specifications. Any replacement hardware product will be warranted for the remainder of the original warranty period or thirty (30) days, whichever is longer, or for any additional period of time that may be applicable in your jurisdiction. If the product has been discontinued, the warranty provider reserves the right to replace it with a model of equivalent quality and function.

This warranty does not cover problems or damage resulting from accident, abuse, misapplication, or any unauthorized repair, modification or disassembly, improper operation or maintenance, normal wear, and tear, or usage not in accordance with product instructions or connection to an improper voltage supply, use of consumables, such as replacement batteries, not supplied by Takama, except where such restriction is prohibited by applicable law.

Except where prohibited by applicable law, this warranty is nontransferable and is limited to the original purchaser and the country in which the product was purchased. This warranty gives you specific legal rights, and you may also have other rights, including a longer warranty duration that may vary under local laws.

To start a warranty claim, contact the Takama Customer Service Department to obtain a return merchandise authorization ("RMA") number, and return the defective product to Takama, along with the RMA number and proof of purchase.



Question about our product line?

Need Product Support?

We are proud of our products and celebrate our customers. We are with you, from product selection to everyday use. Be secure with your purchase and reach us as you need.

📞 212-647-9300

✉ brands@adorama.com

📍 Adorama Brands,  
42 West 18th Street,  
New York, NY 10011

You can always contact us at BRANDS@ADORAMA.COM for personal technical support. Our website contains a wide range of Support and FAQ pages with valuable technical assistance.

Takama is a registered trademark of ADORAMA CAMERA.

© 2023 Adorama Camera, Corp.

All Rights Reserved.



TAKAMA

---

*Video Tripod*

---

WITH FLUID HEAD

---

TAKV4000

