

Ace 750 Quick Start Guide

Ace 750 is a lightweight, compact, HDMI wireless video system with built-in antennas designed to be used with mirrorless cameras, camcorders, action cameras, and A/V workflows. It sends uncompressed zero-delay, 4Kp30, HDR video and audio with up to 750 feet (230m) of range. Ace 750 is cross-compatible with Bolt 4K and Bolt 6 in 5GHz and 6GHz modes and fully complies with FCC and CE frequency usage and power output guidelines.

Table of Contents

1. [WHAT'S INCLUDED](#)
2. [PHYSICAL PROPERTIES](#)
3. [POWER AND CONNECT](#)
4. [PAIRING](#)
5. [BOLT APP](#)
6. [OTHER RESOURCES](#)

What's Included

- Ace 750 Transmitter/Receiver
- 1x Light Stand Adapter
- 1x Hot Shoe Adapter
- 1x PSU 18W AC Adapter 7-28V DC (Int) - 6ft Cable
- 2x Ultra Thin HDMI Male Type A (Full) - HDMI Male Type A (Full) 18in Cable
- 1x Barrel to PowerTap - 18in Cable

Physical Properties

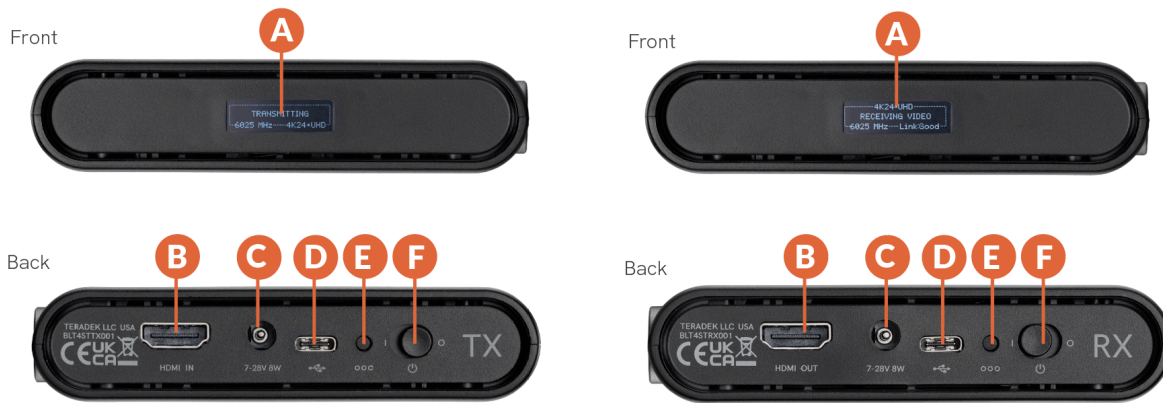

- | | | |
|----------------------|-------------------------|---------------------|
| A: OLED display | C: 7-28V DC power input | E: Bluetooth button |
| B: HDMI input/output | D: Type-C USB port | F: On/Off switch |

Power and Connect

1. Connect the output from your video source to the HDMI input on the transmitter. Connect the HDMI output from the Ace 750 receiver to the monitor's video input.

2. Connect power to both the Spark 4K transmitter (USB-C) and receiver (USB-C/DC adapter), then move the power switches on both the transmitter and receiver to the ON (I) position. Video appears within a few seconds.

Pairing/Unpairing

Ace 750 devices purchased as a set (TX and RX), are paired by default, requiring no additional configuration. Ace 750 devices purchased separately must be paired using the **Bolt Manager**, or the **Bolt App**. To pair your transmitter with multiple receivers, you will also need to use either the Bolt Manager or the Bolt App. **NOTE: Before starting either pairing process, ensure that both the transmitter and receiver have the same firmware version and have Bluetooth enabled.**

PAIRING VIA BOLT APP

Pair:

1. Open the Bolt App from your iOS or Android device, then tap the **Pairing** button.
2. Select the transmitter you wish to pair, then tap the **Next** button.
3. Select the receiver(s) you wish to pair with the transmitter, then tap the **Pair!** button. The Bolt App will indicate when the pairing process is complete.

To Unpair:

1. Open the Bolt App from your iOS or Android device, then tap the TX settings button (3 dots) on the top right corner of the screen.
2. Enter the **Pairing** menu, select the receiver(s) you wish to unpair, and then tap the **Unpair** button.



PAIRING TIPS

If you're having trouble getting units to pair, we recommend keeping the transmitter and receiver six feet apart when pairing. Keep all other RF devices nearby turned off or out of range to ensure the transmitter and receiver are only detecting each other. To eliminate any chance of interference, perform the Wired Pairing process via Bolt Manager.

WIRED PAIRING VIA BOLT MANAGER

To Pair:

1. Connect both the transmitter and receiver(s) to your computer (Windows/Mac) via USB.
2. Open Bolt Manager, select the **Pairing** tab, then tap the **Wired Pairing** button.
3. Select the devices you want to pair, then click the **Pair Devices** button. Bolt Manager will indicate whether or not Pairing is successful.

To Unpair:

1. Connect the transmitter to your computer (Windows/Mac) via USB.
2. Open Bolt Manager, select the **Pairing** tab, then tap the **Unpair All** button.

Bolt App

Download and use the Bolt App to remotely manage and monitor every parameter of Ace 750 including pairing, frequency selection, and 3D LUTs.

Transmitter Status Display

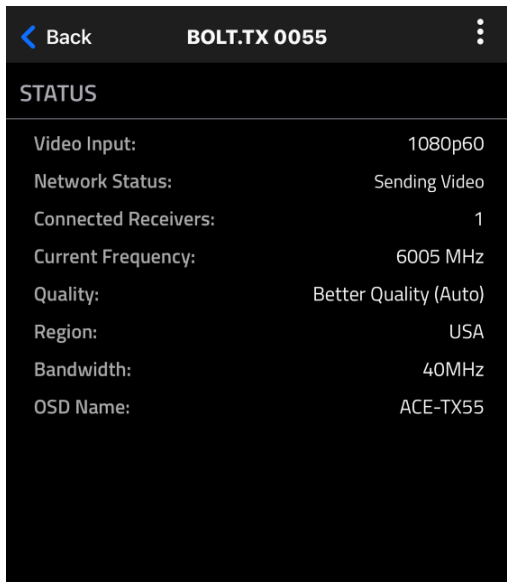

- **Settings** - Tap the settings button on the top-right corner of the display to customize the receiver's settings:
 - **Wireless Setting (Band)** - Select either the **5GHz** or **6GHz** wireless frequency.
 - **Pairing** - Select a transmitter within the same network to pair
 - **TX OSD Name** - Change how your TX name is displayed. **NOTE: You must re-pair the units to view the updated name.**
 - **System Info** - Displays Device Info (name, type, serial number, etc), Firmware Version Info, the **Advanced Settings** tab, and the **Restart System** tab:
 - **Advanced Settings:**
 - Debug Info
 - Firmware Upgrade
 - Command Tool
 - Logs
- **Status** - Displays the current status of:
 - Video Input

- Network Status
- Connected Receivers
- Current Frequency
- Quality
- Region
- Bandwidth
- OSD name

Receiver Status Display

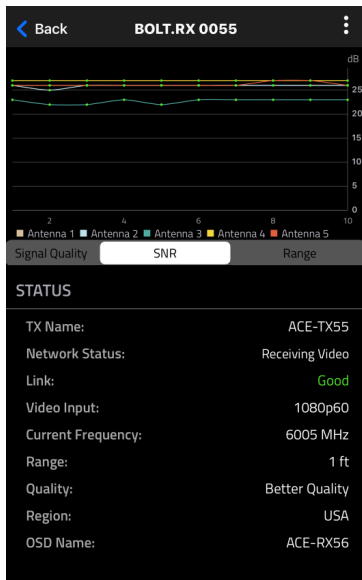

- **Settings** - Tap the settings button on the top-right corner of the display to customize the receiver's settings:
 - **Wireless Setting (Band)** - Select either the **5GHz** or **6GHz** wireless frequency.
 - **Pairing** - Select a transmitter within the same network to pair
 - **RX OSD Name** - Change how your RX name is displayed. **NOTE: You must re-pair the units to view the updated name.**
 - **System Info** - Displays Device Info (name, type, serial number, etc), Firmware Version Info, the **Advanced Settings** tab, and the **Restart System** tab
 - **Advanced Settings:**
 - Debug Info
 - Firmware Upgrade
 - Command Tool
 - Logs
 - **Device Registration**
- **Signal Quality** - Determine the quality and reliability of the signal being received.

- **SNR (Signal to Noise Ratio)** - Compare the signal power level to the noise power level from the attached antennas.
- **Range Analyzer** - Displays the transmission distance between the transmitter and receiver.
- **Status** - Displays the current status of:
 - TX Name
 - Network Status
 - Link
 - Video Input
 - Current Frequency
 - Range
 - Quality
 - Region
 - OSD name

Other Resources

- **TECHNICAL SPECIFICATIONS:** <https://guide.teradek.com/a/1777167-ace-750-tx-and-rx-system>