



LUMIN

USER MANUAL

Contents

Welcome to Lumin	3
System Requirements	4
What's in the Box	5
Getting Started	6
Game Streaming Setup	7
Video Conference Setup	9
USB-C PD (Power Delivery)	11
Using the Hub Features	12
Using the Lumin as a Webcam	13
Using Skype	13
Using Microsoft Teams	14
Using Google Meet	15
Using Zoom	16
Setting up Open Broadcaster Software (OBS)	18
Help	21
Safety Information	22
Support	22
Legal	23
Copyright and Intellectual Property	23
Limited Product Warranty	23
Limitation of Liability	23
Terms and Conditions	23

Welcome to Lumin

Lumin by ZILR takes the hassle of streaming and puts it into a simple hub.

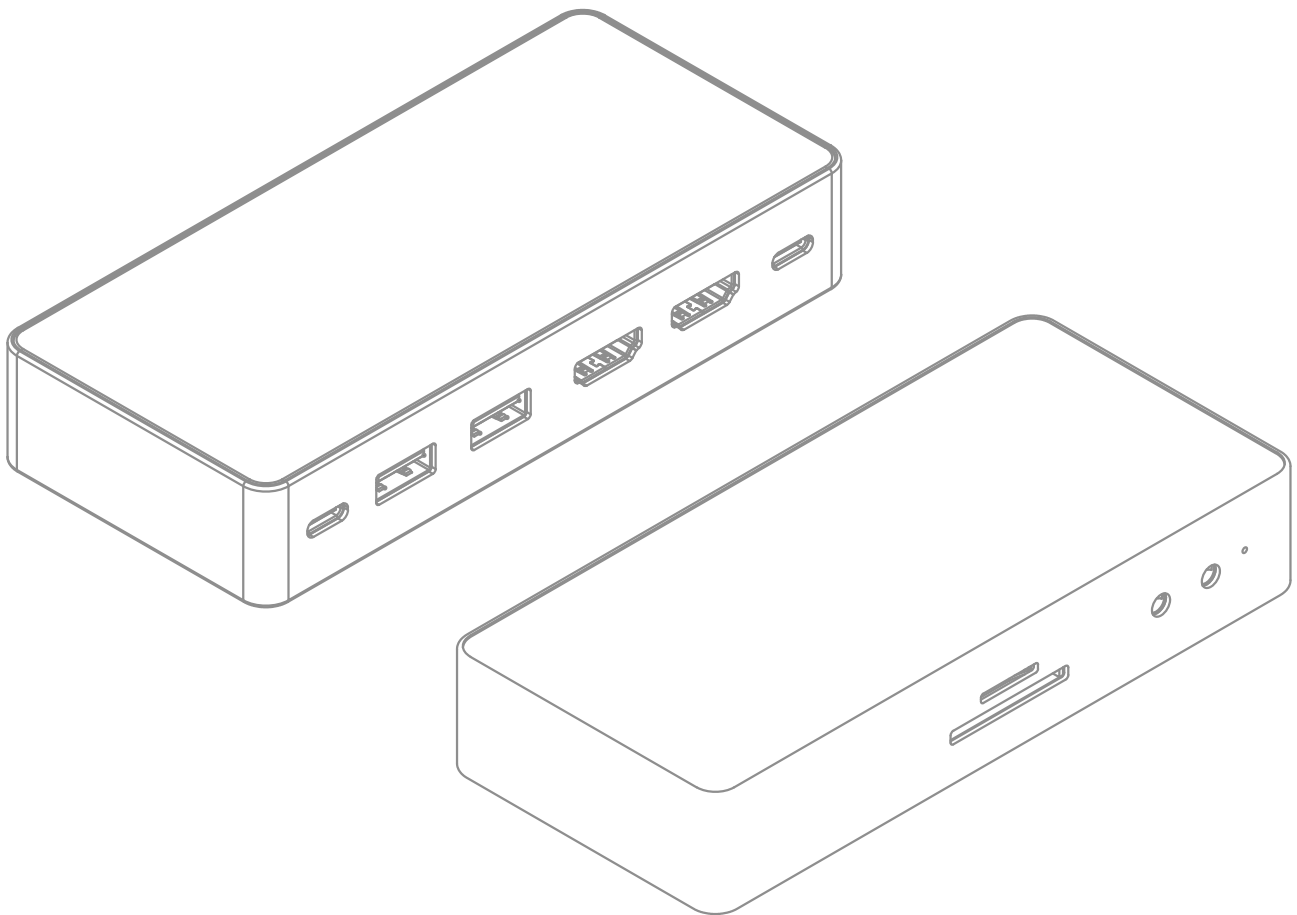

System Requirements

WINDOWS

OS

Windows 10 (64-bit) or later, built-in USB 3.0 port or USB-C port

CPU

6th generation Intel Core i5 CPU (i5-6xxx) / AMD Ryzen 7 (or better)

GPU

NVIDIA GeForce GTX 10xx (or better)

RAM

4 GB RAM (8 GB recommended)

MAC

OS

macOS 10.13 High Sierra or later, built-in USB 3.0 port or USB-C port

CPU

Apple M1 or Intel i5-4xxx quad-core or better

GPU

Apple M1, AMD or NVIDIA

RAM

4 GB RAM (8 GB recommended)

NOTE No software drivers are required use the Lumin.

What's in the Box

The following items are included in the box when you purchase the Lumin:

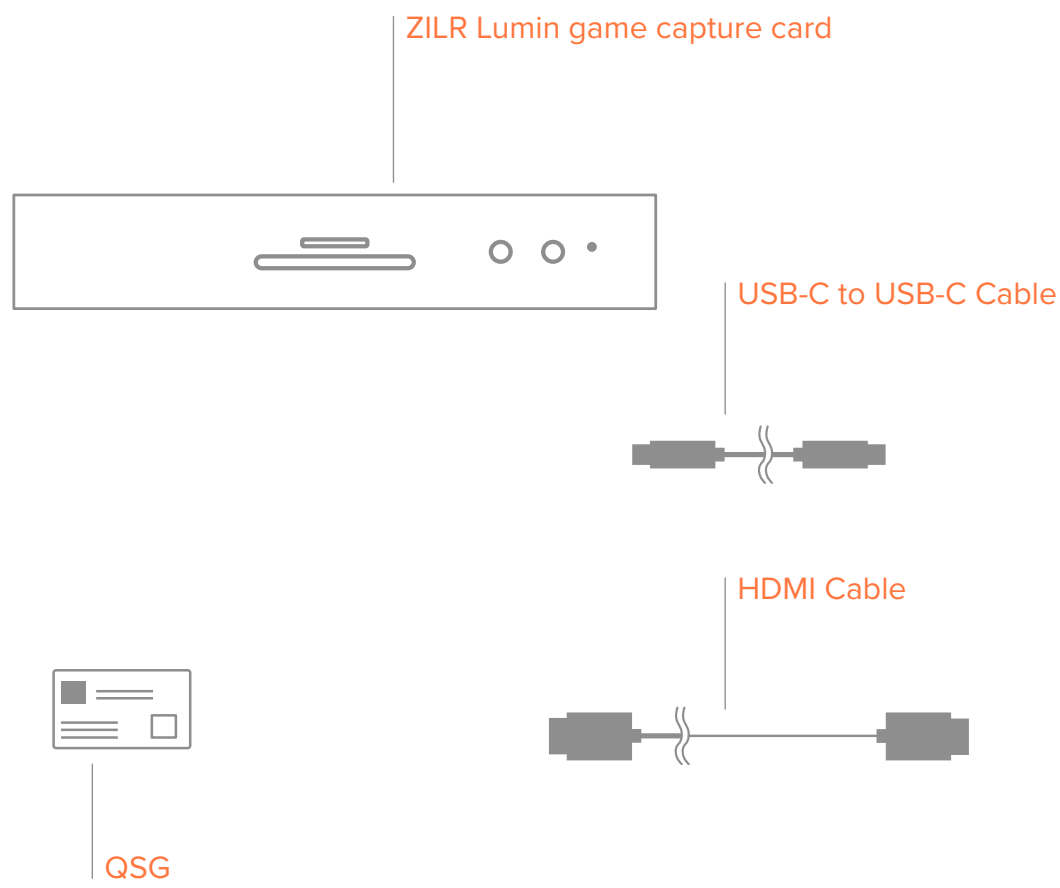

Getting Started

FRONT



REAR



FRONT

1. SD Card / Micro SD Card Reader
2. 3.5 mm Mic /Line In port
3. 3.5 mm Headphone port
4. LED power indicator

REAR

5. USB 3.0 Type-C PD port (power)
6. USB 3.0 Type-A port
7. HDMI IN port
8. HDMI OUT port
9. USB 3.0 Type-C port (data)

Game Streaming Setup

- 1 Connect the included HDMI cable from the **HDMI OUT** port of your gaming console or PC into the **HDMI IN** port of the Lumin.

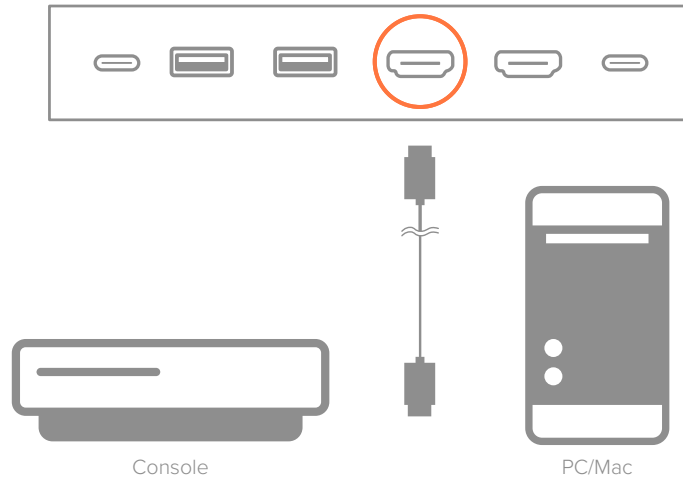

- 2 Connect a second HDMI cable from the **HDMI IN** port of your PC gaming monitor or HDTV to the **HDMI OUT** port of the Lumin to enable HDMI pass-through.

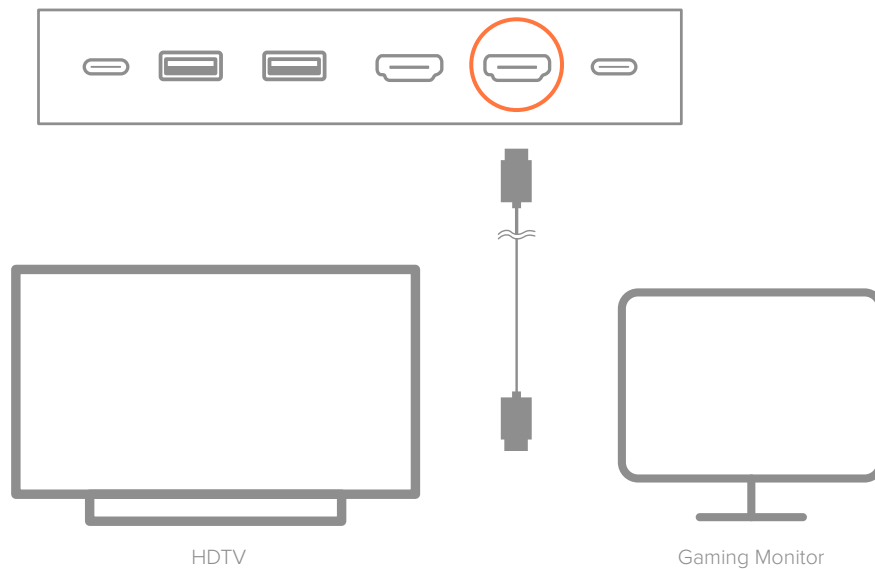

- ③ Use the included USB-C cable to connect from the **USB-C** port on the Lumin to a **USB-C** port on your PC/Mac. A USB-C to USB-A cable may also be used for computers with USB 3.0 ports.

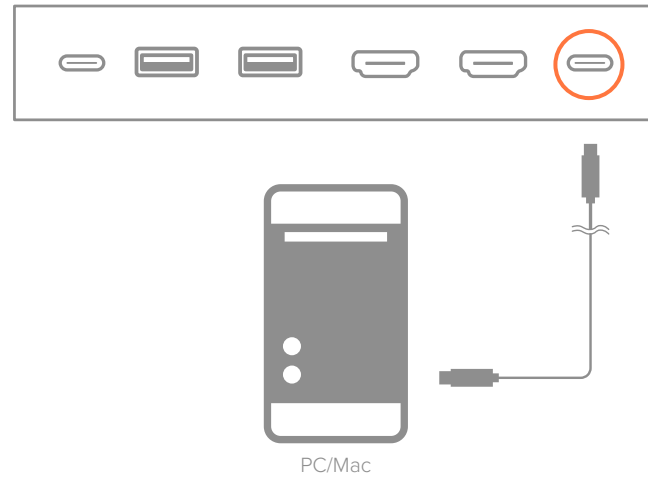

NOTE USB 3.0 Type-C to USB 3.0 Type-A cable sold separately.

- ④ Optionally, you may add audio to the stream by connecting a microphone to the **3.5 mm microphone** port on the front or via **USB 3.0** on the rear of Lumin.

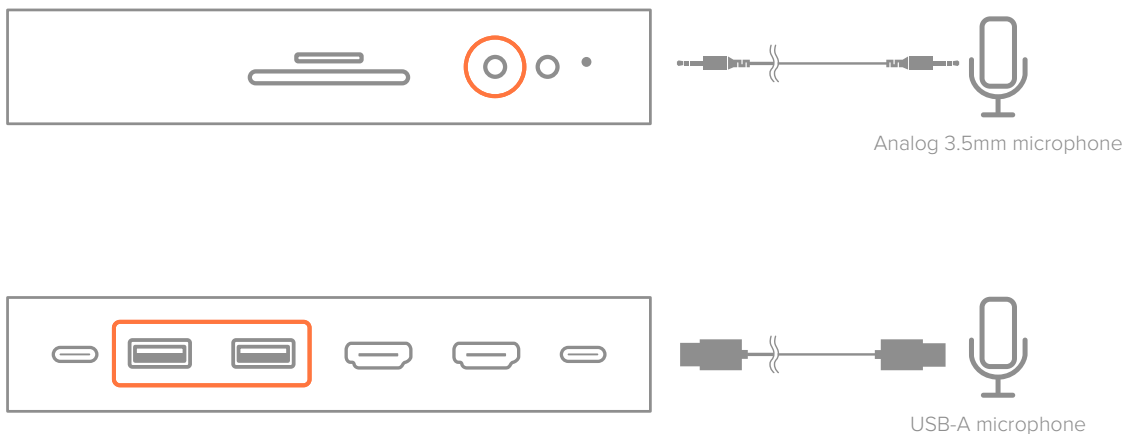

- ⑤ To monitor audio, connect headphones to **3.5mm headphone** port. When using your streaming software, select **ZILR Lumin** as the audio output.



Video Conference Setup

- 1 Connect the included HDMI cable from the **HDMI OUT** port of your mirrorless camera into the **HDMI IN** port of the Lumin.

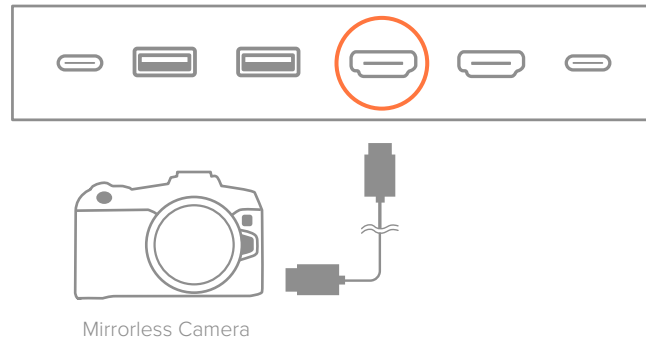

NOTE Depending on your camera, you may require either a HDMI to HDMI cable, HDMI to HDMI Mini cable or HDMI to HDMI Micro cable. ZILR has a range of these cables to suit each HDMI type. Cables sold separately.

- 2 Use the included **USB-C** cable to connect from the **USB-C** port on the Lumin to a USB-C port on your PC/Mac. In the conference software device settings for video/camera, select **ZILR Lumin** as the video source.

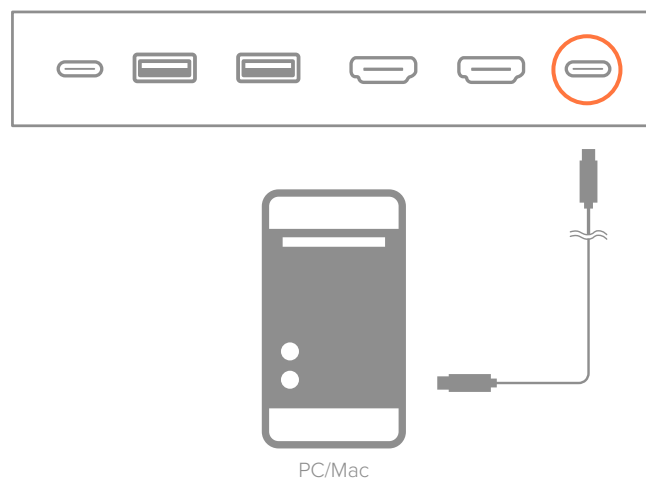

- ③ Optionally, you may add audio to the conference by connecting a microphone to the **3.5 mm microphone** port on the front or via **USB 3.0** on the rear. You may also use the audio from the mirrorless camera as a source. In the microphone device settings in your conference software, select **ZILR Lumin Line/Mic** when using the **3.5mm microphone** port or **ZILR Lumin** if using the microphone from the mirrorless camera.

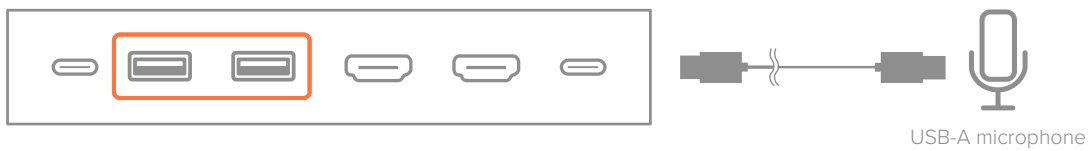
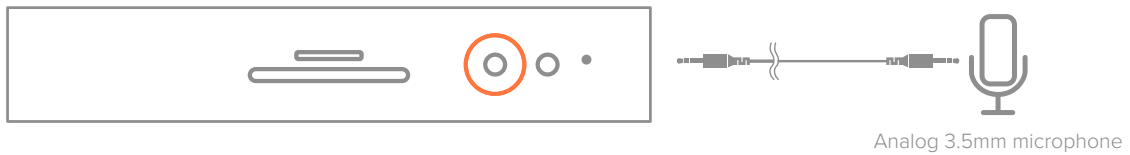

- ④ To monitor audio, connect headphones to **3.5mm headphone** port. When using your conference software, select **ZILR Lumin** as the audio output.



USB-C PD (Power Delivery)

USB-C PD can be used to provide fast charging to your mobile, or if connecting to a USB-C AC Wall Adaptor, supply power to your laptop that support PD for up to 87W.

USB-C PD Charging for laptops

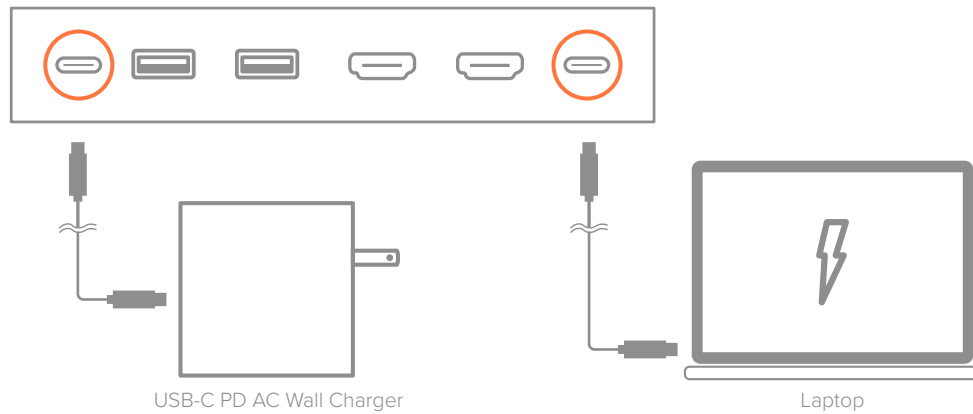

USB-C PD Charging for phones or tablets

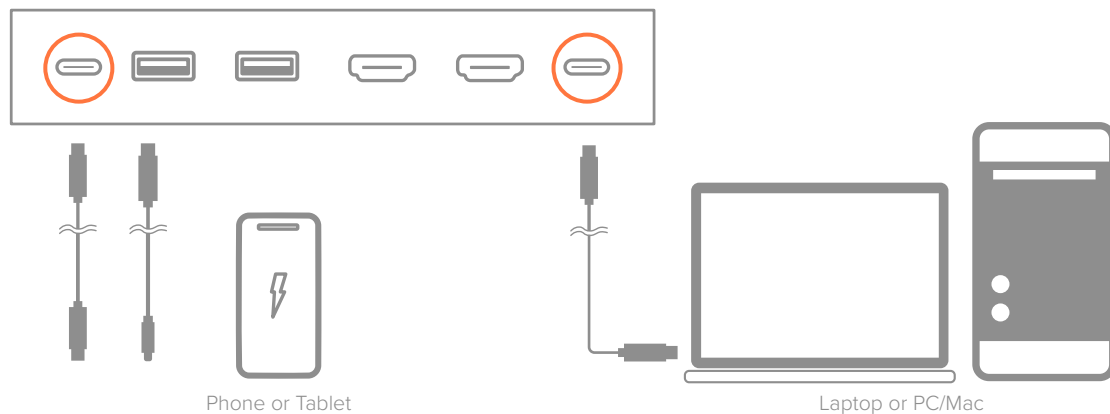

NOTE USB 3.0 Type-C to USB 3.0 Type-C, USB 3.0 Type-C to USB 3.0 to Lightning and USB-C AC Wall Adaptor sold separately.

Using the Hub Features

Included on the Lumin is two USB 3.0 ports which allows you to connect to a variety of USB 2.0 or USB 3.0 devices such as web cameras, USB microphones, hard drives, flash drives, printer etc. Some devices may require additional software, please see the device manufactures user manual for more details.

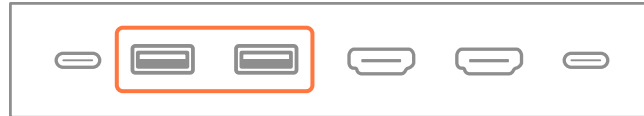

The front of the Lumin is a card reader for importing photos/video from your camera or data from other sources stored on the card.

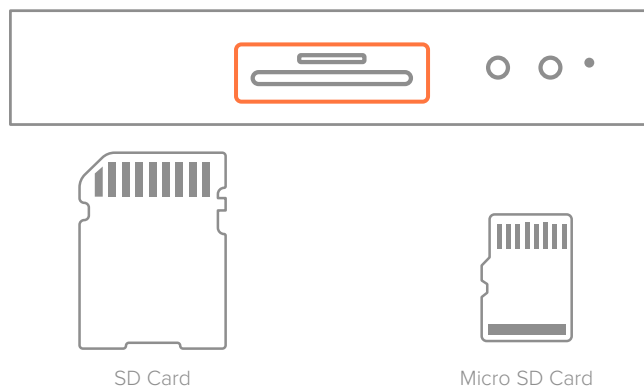

Using the Lumin as a Webcam

The Lumin can be used as a webcam by connecting your Mirrorless Camera into the **HDMI IN** port. This will enable high quality video compared to standard Webcams.

Software such as Zoom, Skype, Microsoft Teams and Google Meet will automatically be able to use the Lumin without additional drivers.

Using the Lumin with this apps requires the right source to be selected.

Using Skype

1. Download Skype and open the application.
2. Once signed in, from Skype's menu bar, open the **video and audio settings**.
3. Click on the **Camera** menu and select **ZILR Lumin** from the list. You will see the video appear in the preview window if connected to the Lumin's **HDMI IN**.

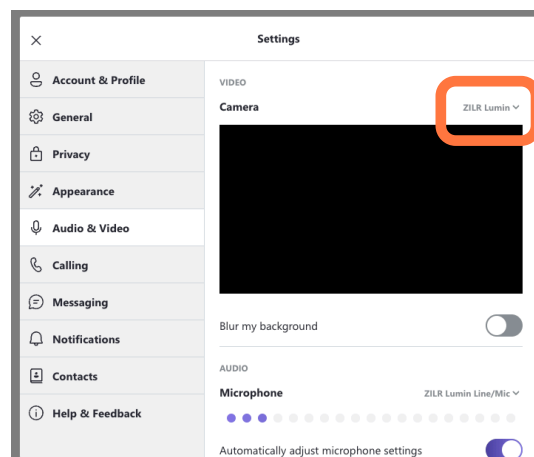

4. From the **Microphone** menu, select **ZILR Lumin** from the list if you are using the audio from the **HDMI IN**, or if you are using a microphone connected to 3.5mm microphone port on select **ZILR Lumin Line/Mic**. When you speak, you will see the audio meters move up and down. This will mean that the audio is working as intended.

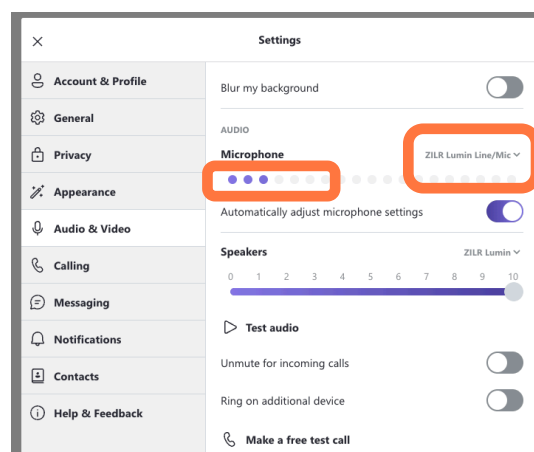

5. To use headphones to hear your meeting. Connect headphones to the **3.5mm headphone** port on the Lumin, then under the **Speakers** menu, select **ZILR Lumin**. Press the **Test audio** button to hear sound playing through the headphones to ensure it's setup correctly.

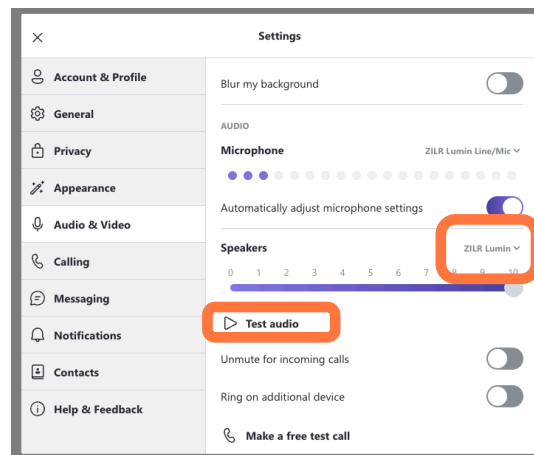

You are now ready to use your Lumin for online meetings in Skype.

Using Microsoft Teams

1. Download Microsoft Teams and open the application or access via a web browser.
2. Once signed into your Microsoft account, open **settings** and select **Devices** from the side list.
3. For the **Speakers** menu, if using to headphones connected to the Lumin, select **ZILR Lumin** from the list.
4. If you are using a a microphone connected to the Lumin **3.5mm microphone** port, select **ZILR Lumin Line/Mic** from the list. If you are use a audio/mic from a HDMI source, select **ZILR Lumin**.

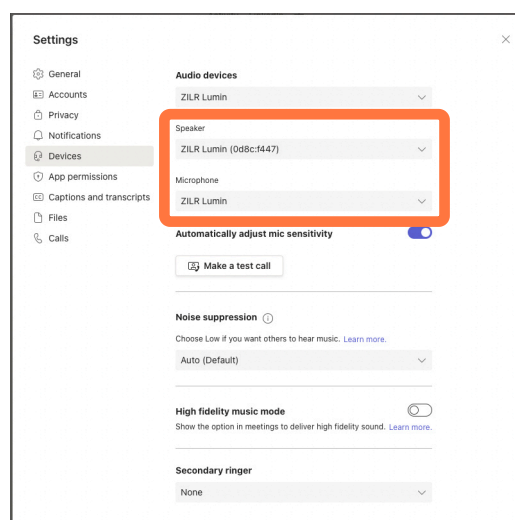

5. To use the HDMI source, under the **Camera** list, select **ZILR Lumin**. If there is a device connected and turned on, you will see the preview from the window.

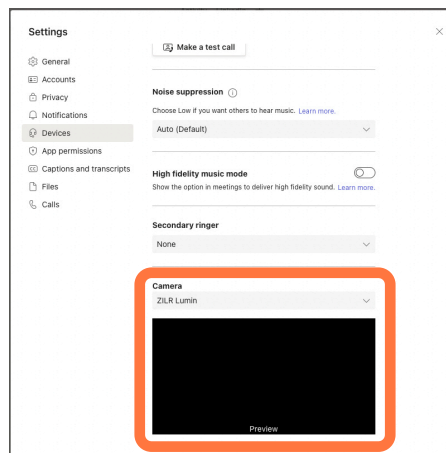

You are now ready to use your Lumin for online meetings in Microsoft Teams.

Using Google Meet

1. Open the Google Meet from a web browser.
2. Once signed into your Google account if required, open **Check your audio and video** settings.

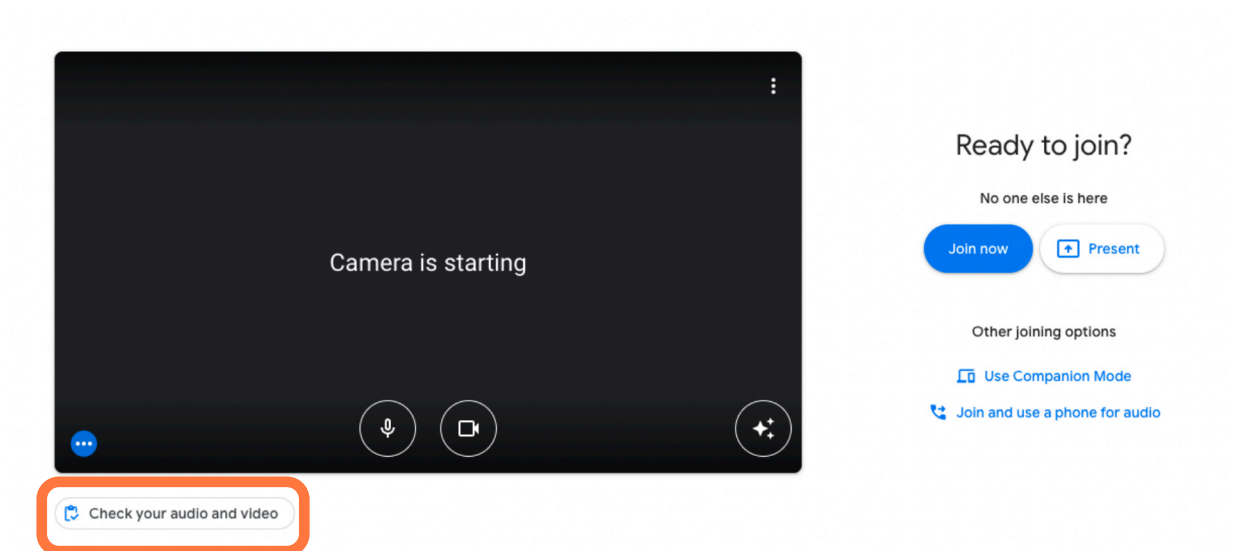

3. Once the settings window is open, you will be able to select your video, audio and speakers. Under the **Camera** list, select **ZILR Lumin (device id)**. On the **Microphone** list for the **3.5mm microphone** port, select **ZILR Lumin Line/Mic (device id)** or for the microphone from a HDMI device select **ZILR Lumin**. If you would like to use headphones connected to the **3.5mm headphone** port on the Lumin, select **ZILR Lumin** from the Speakers list.

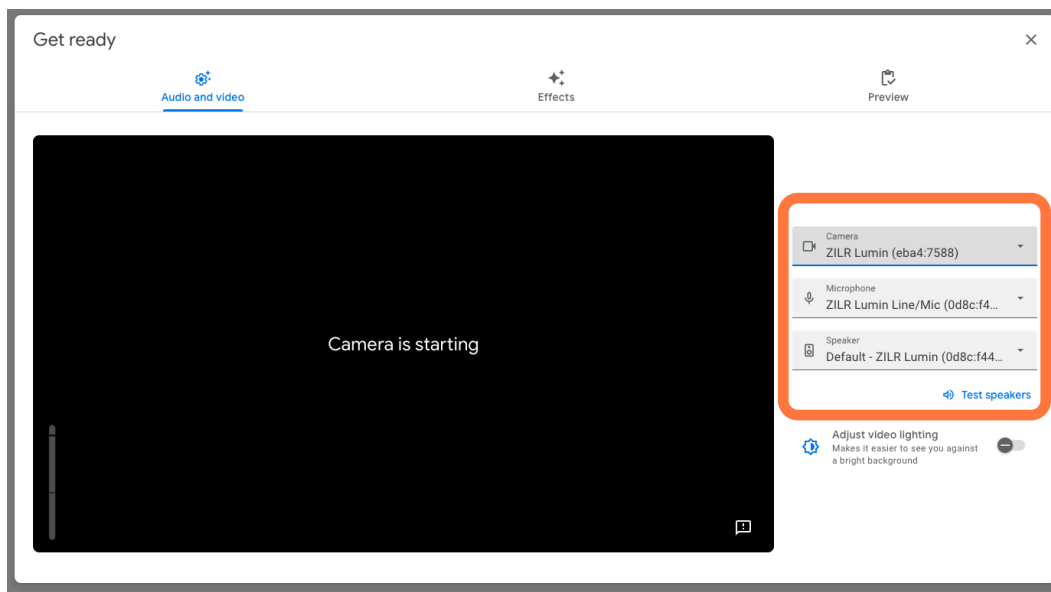

You are now ready to use your Lumin for online meetings in Google Meet.

Using Zoom

1. Download the Zoom client and open the application.
2. Open **Settings** or **Preferences**.
3. From side list, select the **Video**. Under the **Camera** list, select **ZILR Lumin**. If your HDMI device is turned on and connected, you will see a preview in the window.

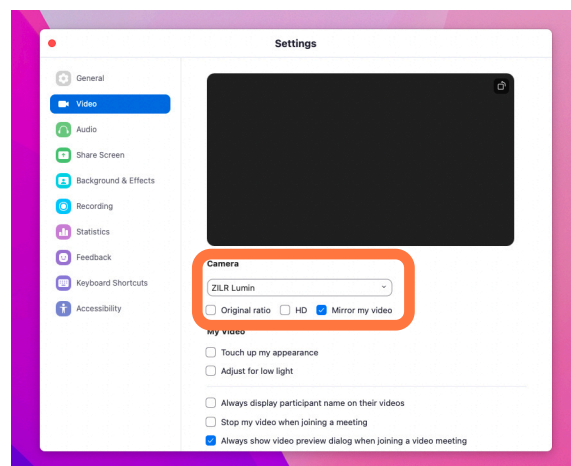

4. On the side list, select **Audio** to access the audio settings.
5. If using headphones connected to the **3.5mm microphone** port, under the **Speakers** menu, select **ZILR Lumin**. To use the microphone on your HDMI device, select **ZILR Lumin**. Press the **Test Speakers** button to hear if sound output is working correctly. The Output Level will move up and down if audio is playing.

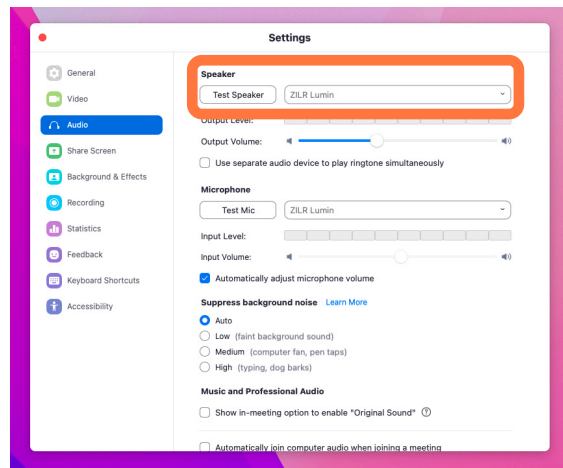

6. If you are using a microphone connected to the Lumin **3.5mm microphone** port, select **ZILR Lumin Line/Mic** from the **Microphone** list. If you wish to use the audio/mic from a HDMI source, select **ZILR Lumin**. The Input Level will move up and down if the microphone is working.

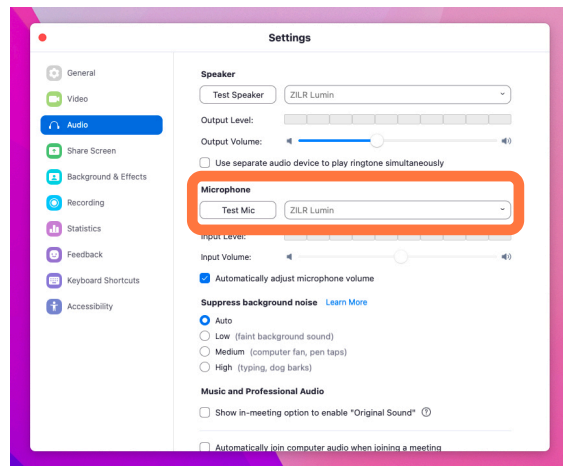

You are now ready to use your Lumin for online meetings in Zoom.

Setting up Open Broadcaster Software (OBS)

Open Boardcaster Software is an open source project that is free to download on Windows, Mac and Linux.

Visit <https://obsproject.com> to download the latest version on the software.

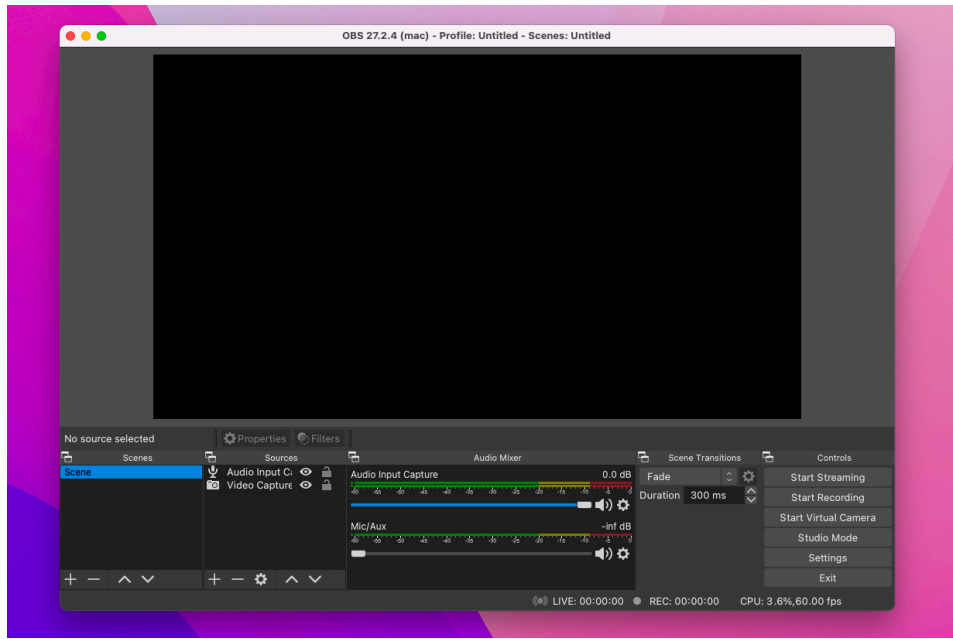

OBS application running on macOS

Testing and recording your stream

1. Once installed on your computer, open the OBS app.
2. For new users, it's recommended to run the auto-configuration. To do so, run the **Auto-Configuration Wizard** from the Tools menu.
3. Set up your audio devices by double clicking on **Audio Input Capture** from the Sources list. If there is none, click on the + button on from the Sources section.

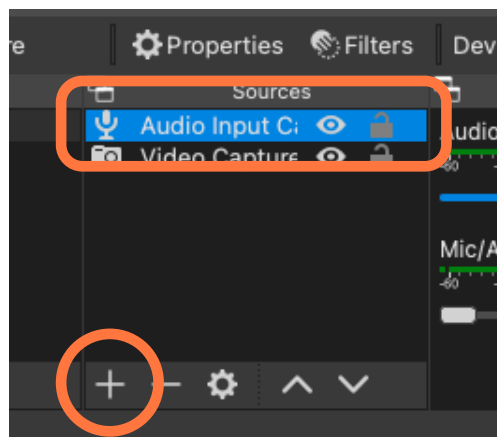

- From the Audio Input Capture properties dialogue, select **ZILR Lumin** if capturing audio from the **HDMI IN**. To capture audio from the **3.5mm microphone** port, select **ZILR Lumin Line/Mic**. If you have a USB-A microphone connected to the Lumin, select that device from the list.

NOTE You can capture from multiple audio sources and use the Mixing capabilities of OBS to set the levels.

- To capture from the **HDMI IN** source, double click on the **Video Capture Device** from the Source list. If there are no Video Capture Device listed, click on the **+** button to add a new one.
- From the Video Capture Device properties dialogue select **ZILR Lumin**. If you have a HDMI device turned on and connected, you will see the video input displayed. It is recommended to have it turned on to test that the video input is working before closing this dialogue.
- To adjust the levels of the audio inputs. Drag the volume slider up or down and you will see the dB level adjust.

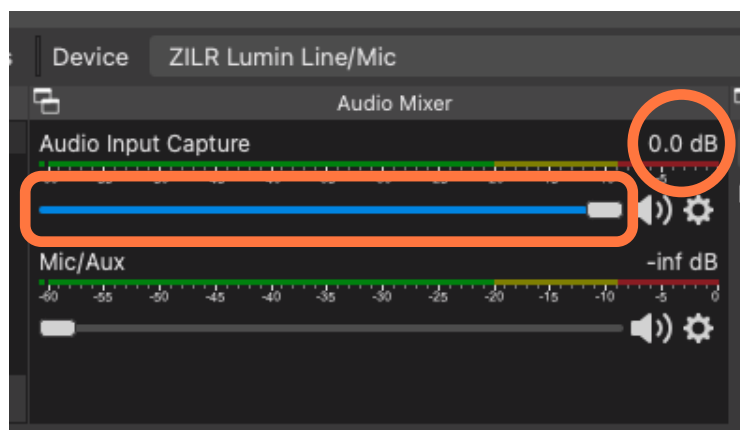

NOTE We recommending having headphones connected to either the ZILR Lumin 3.5mm headphone port or a 3.5mm port on your computer to monitor your audio. If using the Lumin, you may have to select it from your operating system.

- Test record the stream by clicking on **Start Recording** from the Controls section.

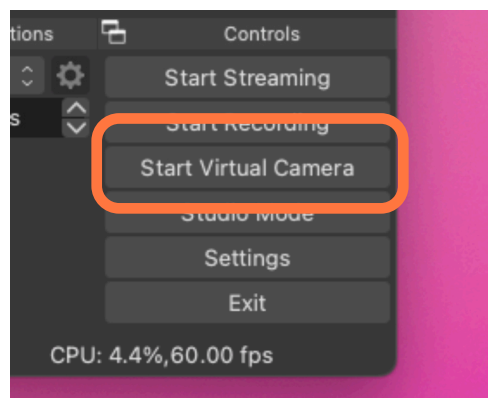

9. Press **Stop Recording**, after a few seconds.
10. Open the recorded file to ensure that all video and audio inputs have recorded correctly. Each operating system will store the recorded files in different locations. To see where your OS has recorded the files, click on the **Settings** button on the Controls sections.

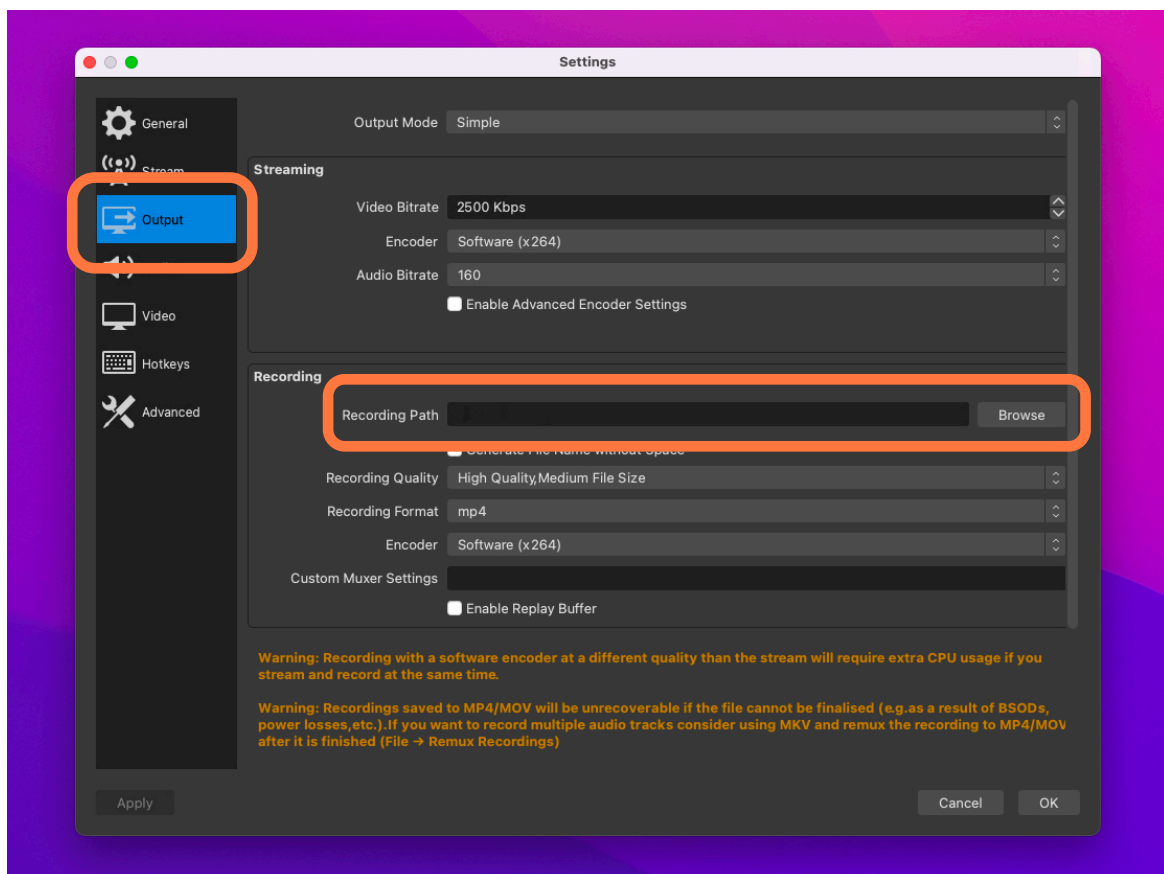
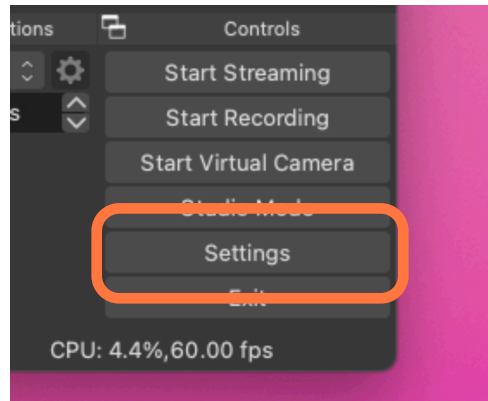

If the recorded video works correctly with the audio levels, continue on with the capture. If the levels aren't correct, re-adjust them in the **Audio Mixer** section and test again with another recording.

From more advanced topics including Streaming and running in Studio mode, see the OBS wiki:

<https://obsproject.com/wiki/>

Other recommendations

We recommend to turn off and mute the Mix/Aux channel as you might hear noise. To do this, use the slider on the **Audio Mixer Sources** and slide all the way down under it reads as **INF**.

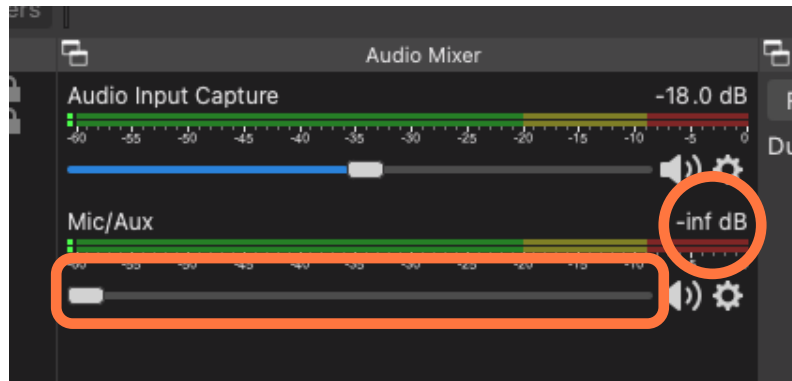

It is also recommended if using a microphone to turn off the monitoring so you don't hear your own voice. You may turn on and off monitoring when testing the sound levels for your mix.

To turn off monitoring, click on the Cog in Audio Mixer and selection **Advanced Audio Properties**.

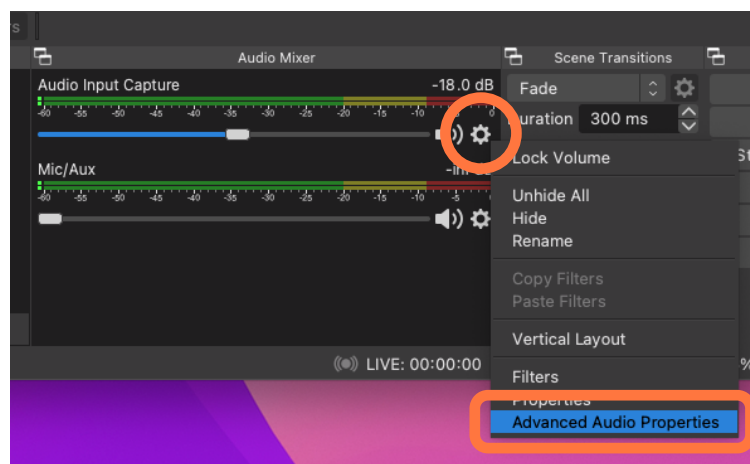

Under **Audio Monitoring**, select **Monitor Off** for any sound sources you don't wish to hear while recording. The sound from that source will still record, however you just won't be able to hear it while recording/streaming.

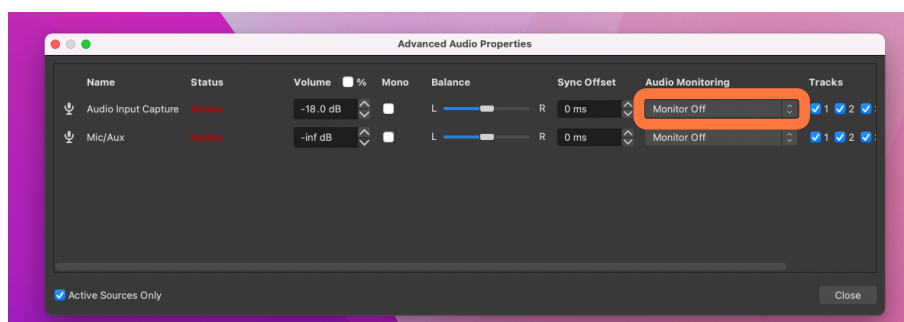

Help

Safety Information

- While using this product, place on a stable surface to ensure that it doesn't fall causing damage.
- Using this device outside the intended use or in a manner that is risky will void the warranty.
- Attempting to fix, modify or take the device apart will void your warranty.
- Don't use this device in extreme weather conditions, near water or moist areas, near heat or hot surfaces or anything that will cause fire or water damage.
- Ensure that all plugs are connected securely while using the device.
- When using on AC mains, ensure that the device is grounded and all cables and connectors aren't damaged or frayed.
- Inspect the device and all plugs and connectors before operation.
- Disconnecting cables while using the device without safely disconnecting from the operation system may result in data loss. Please consult any 3rd party manufacturer's documentation when using in combination with this device.
- Do not place heavy objects on top of this device.
- Do not force cables into the input connectors or the wrong cable type.
- Ensure that any cables connected aren't stretched, pinched or can be walked on.
- This equipment is suitable for use in tropical locations with an ambient temperature of up to 40°C/104°F. Not use in below 0°C/32°F.

Support

Please contact us should you require help or require more information. Contact us below:

<https://www.zilr.pro/support/>

Legal

Copyright and Intellectual Property

© Copyright 2022 ZILR Pty Ltd. All rights reserved. HDMI is a registered trademark of HDMI Licensing LLC in the United States and other countries. All other brand names, trademarks and registered trademarks are the property of their respective owners.

Limited Product Warranty

Warranty covers defects in material and craftsmanship only from the date of purchase for a period of 12 months.

For more information and how to obtain a service under the warranty period, please visit:

<https://www.zilr.pro/support/warranty-information/>

Limitation of Liability

In no event shall ZILR Pty Ltd, nor its directors, employees, partners, agents, suppliers, or affiliates, be liable for any indirect, incidental, special, consequential or punitive damages, including without limitation, loss of profits, data, use, goodwill, or other intangible losses, resulting from (i) your access to or use of or inability to access or use the Service; (ii) any conduct or content of any third party on the Service; (iii) any content obtained from the Service; and (iv) unauthorized access, use or alteration of your transmissions or content, whether based on warranty, contract, tort (including negligence) or any other legal theory, whether or not we have been informed of the possibility of such damage, and even if a remedy set forth herein is found to have failed of its essential purpose.

Terms and Conditions

ZILR Pty Ltd reserve the right, at our sole discretion, to modify or replace these Terms at any time. For the latest Terms and Conditions, please visit;

<https://www.zilr.pro/legal/terms/terms-conditions.html>